



BOND

COLLECTIVE

612 SOUTH BROADWAY

CHANNEL

DAN & DELUCA

HERMED

Jones Lang LaSalle Brokerage, Inc.





BOND

COLLECTIVE

In the heart of the Broadway Theatre District, Bond Collective at 612 South Broadway encompasses the best of the historical Los Angeles and its bright future. The preserved 1930s exterior is juxtaposed by its sleek modern aesthetic offering a contemporary, flexible workplace available on a month-to-month membership or long-term lease basis. Equipped with stunning common areas, elegant furnishings and five-star hospitality style management, Bond Collective is an upscale and relaxed environment that will propel creativity and ideas for the next generation of entrepreneurs and teams of large enterprise firms alike. Just steps away from some of LA's best restaurants and bars, and neighboring some of entertainment's most exciting companies, Bond Collective is the shining star of Broadway.

PROJECT HIGHLIGHTS

A flexible office space within a
1930s art-deco landmark



Located in the
Broadway Theatre
District



Iconic building with
modern interior and
upgraded building
systems



High ceilings



Lots of windows



Exposed brick



Great natural light



Flexible lease terms,
demising options,
and scalability up to
+/-60,000 SF



Move-in ready with
high-end furniture
and finishes

EXAMPLE OFFICE



EXAMPLE TENANT LOUNGE



EXAMPLE TENANT LOUNGE



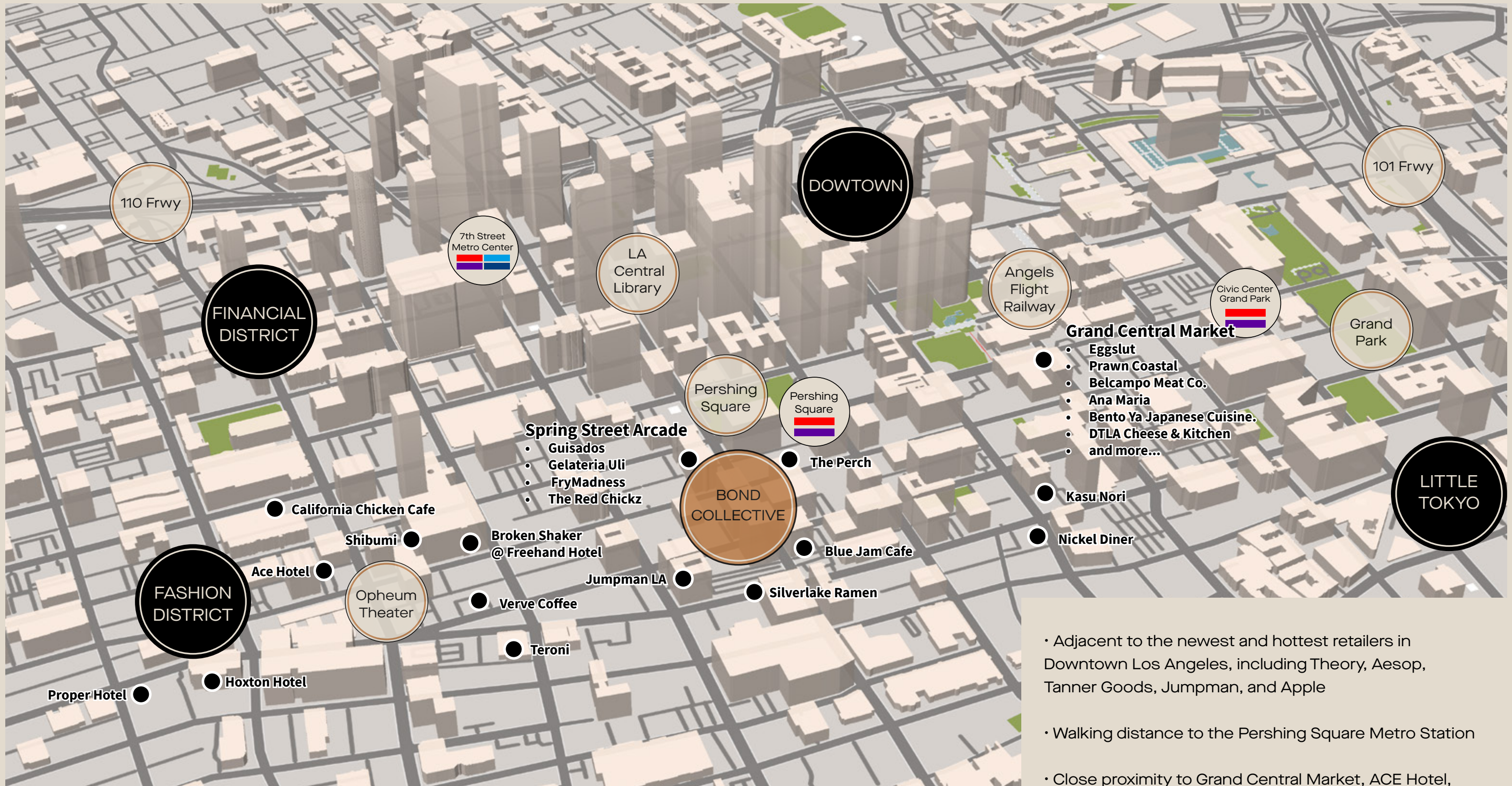

THOUGHTFULLY AMENITIZED

- Adjacent to the newest and hottest retailers in Downtown Los Angeles, including Theory, Aesop, Tanner Goods, Jumpman, and Apple
- Walking distance to the Pershing Square Metro Station
- Close proximity to Grand Central Market, ACE Hotel, Freehand Hotel
- Two blocks from the newest 5-star, boutique hotel, Hoxton and Proper Hotels

FLOOR PLANS

2nd floor

Floor features:

- Main reception and lounge area
- Open pantry with coffee and beverage service
- Host and event space
- Open desk co-working
- Board room and conference rooms
- One - 23 seat suite
- One - 25 seat suite

 View the **Virtual Tour**

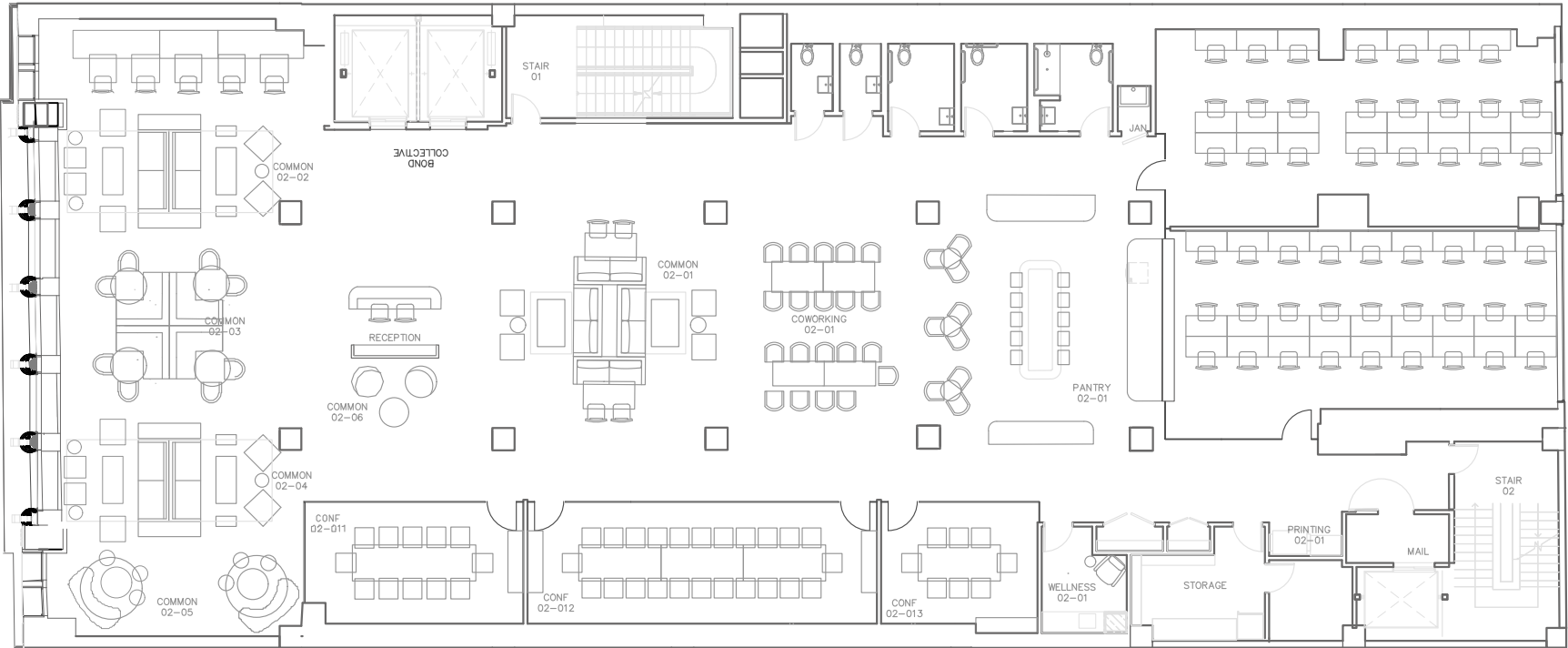

4th floor

Floor features:

- Lounge, kitchen and conference rooms
- Private phone rooms and 10 focus rooms
- Three suites with 15 seats or more
- Nine suites with 4 to 8 seats
- Twelve 2 person suites
- Full floor availability

 View the **Virtual Tour**

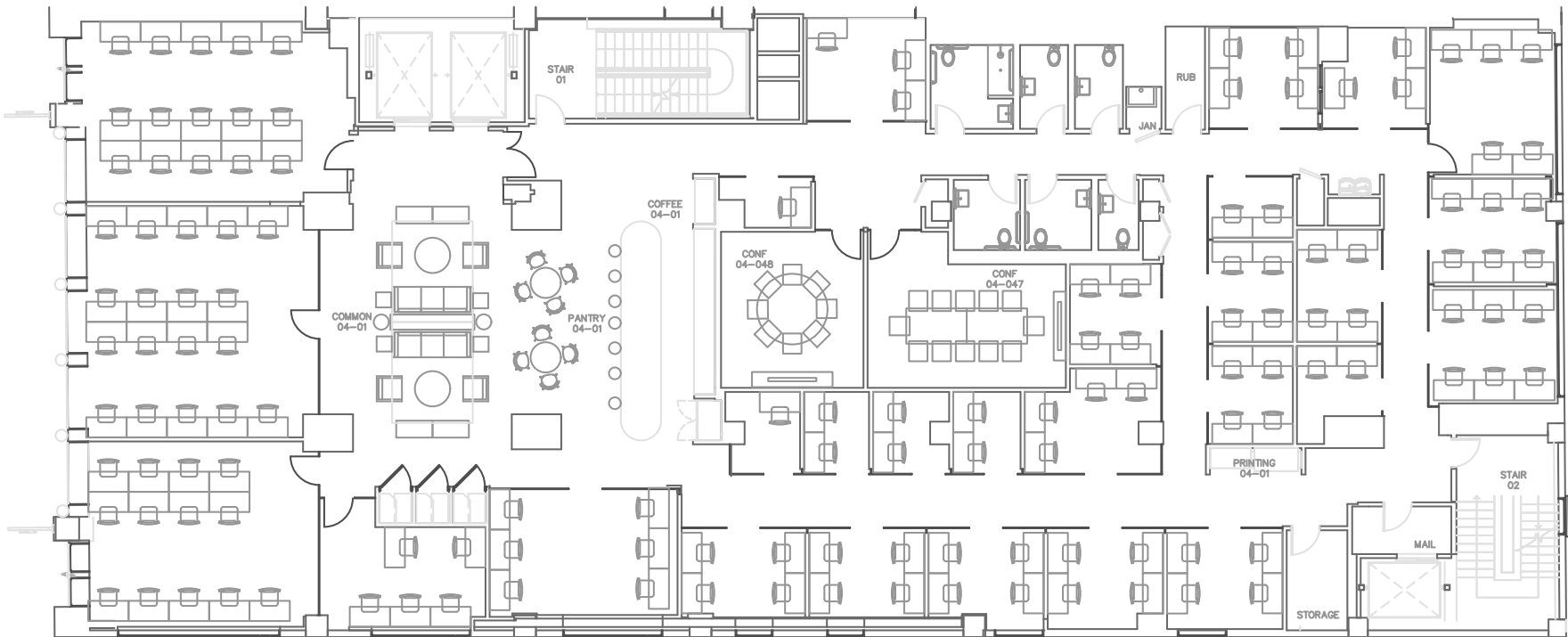

FLOOR PLANS

5th floor

Floor features:

- Lounge, kitchen and conference rooms
- Private phone rooms and 10 focus rooms
- Three suites with 15 seats or more
- Nine suites with 4 to 8 seats
- Twelve 2 person suites
- Full floor availability

 View the **Virtual Tour**

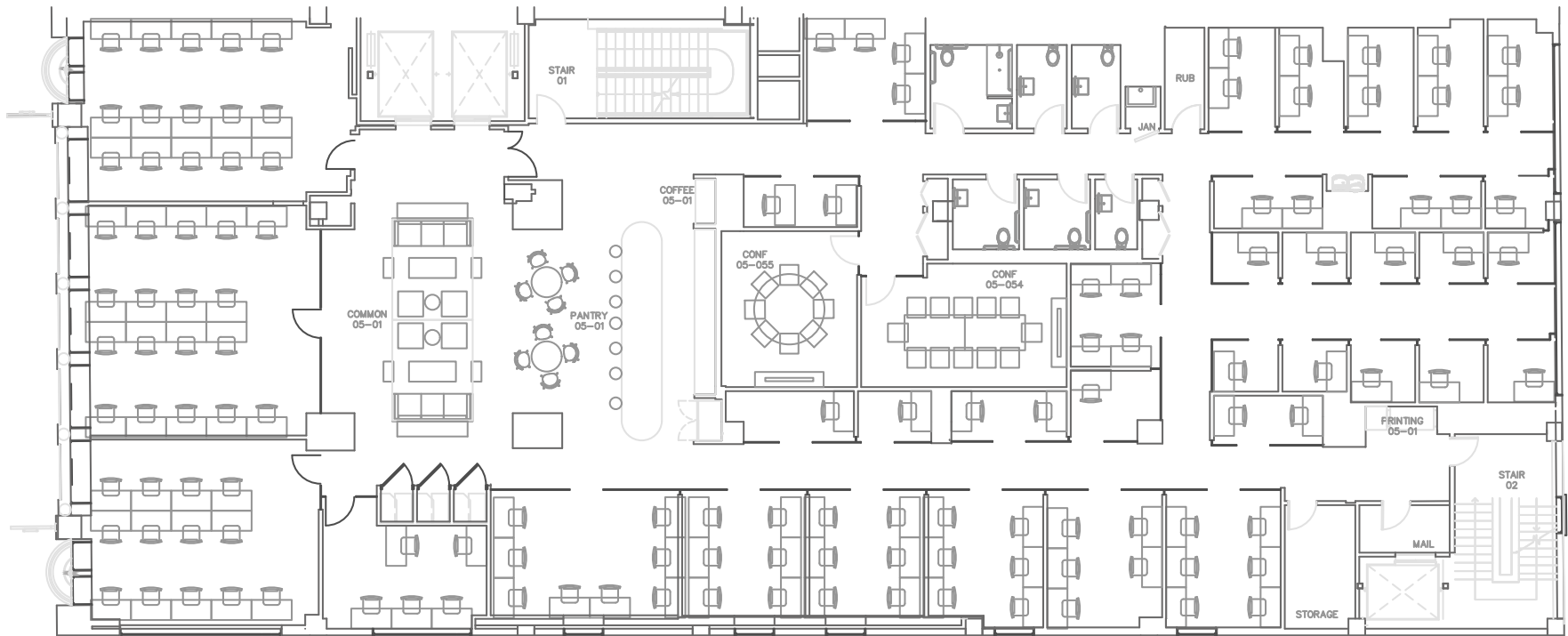

6th floor

Floor features:

- Lounge, kitchen and conference rooms
- Private phone rooms and 10 focus rooms
- Three suites with 15 seats or more
- Nine suites with 4 to 8 seats
- Twelve 2 person suites
- Full floor availability

 View the **Virtual Tour**

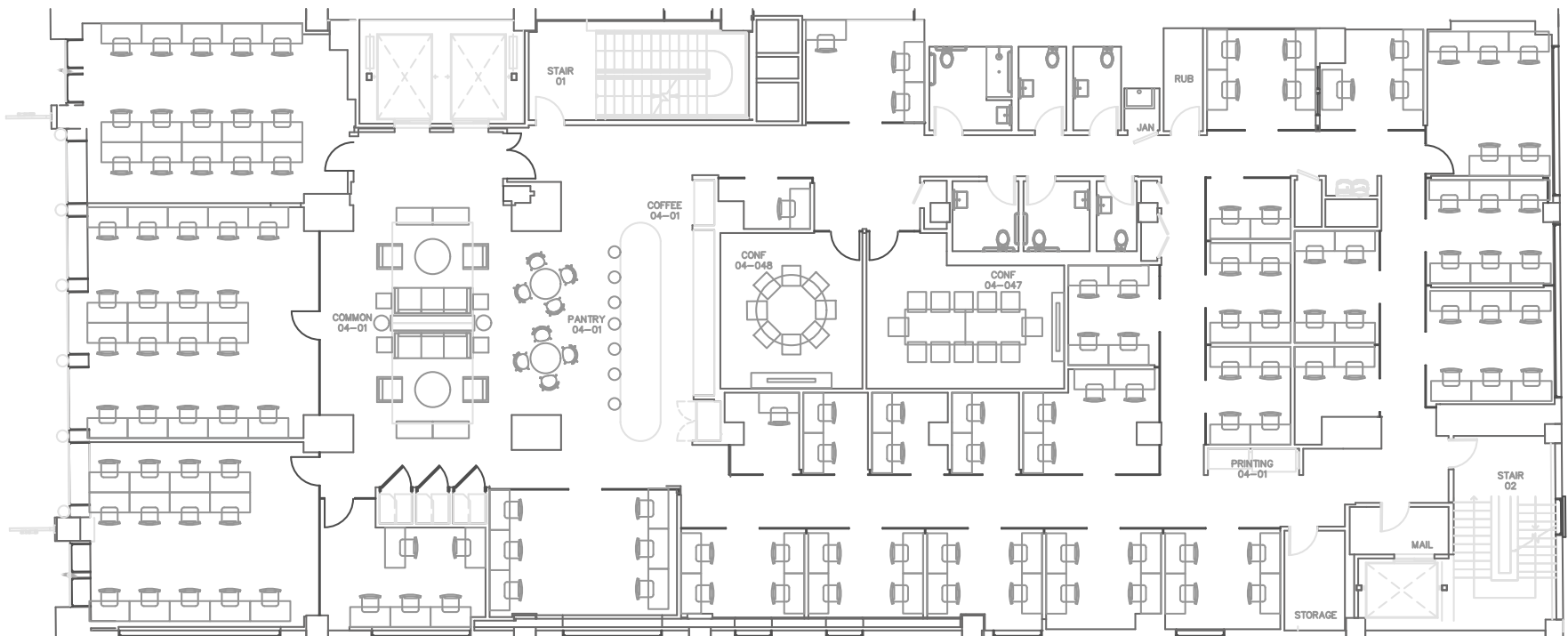

MEMBERSHIP OPTIONS

Coworking

FROM \$300 PER MONTH

Dedicated Desks

FROM \$400 PER MONTH

Private Offices

FROM \$900 PER MONTH

Amenities include:

- Conference Rooms for 2 or 20+
- Custom Build-Outs
- Private Meeting & Phone Booths
- Mail and Package Handling
- Fast, Reliable WiFi and Ethernet Connections
- Unlimited Black and White Printing
- Amenitized Showers with Towel Service
- Fresh Fruit, Snacks, and Weekly Breakfast
- Complimentary Spa Water, Craft Beer, and Coffee
- Mothers' Room
- Day Passes Available
- Secure Bike Storage
- Conference Rooms Available on a Per Hour Basis
- Exclusive Discounts and National Partnerships
- Pet-friendly Locations and Common Areas
- Access to Other Portfolio Locations



BOND

COLLECTIVE

FOR LEASING INFORMATION

James Malone

Executive Vice President
james.malone@am.jll.com
+1 213 239 6021
RE license #01281488

Dana Vargas

Vice President
dana.vargas@am.jll.com
+1 213 239 6121
RE license #01943620



Jones Lang LaSalle Brokerage, Inc. License #01856260. Copyright © Jones Lang LaSalle IP, Inc. 2021 All rights reserved. All information contained herein is from sources deemed reliable; however, no representation or warranty is made to the accuracy thereof.

