



FMC Tower

2929 Walnut Street
Philadelphia, PA 19104



6,545 SF
available for sublease

Property highlights

- Sublease available on the 11th floor
- Term length flexible
- Trophy building
- KOZ Benefits thru December 2025

Amenities

 Fitness facility

 Covered parking

 LEED-based sustainable design

 Quick access to Amtrak's 30th Street Station

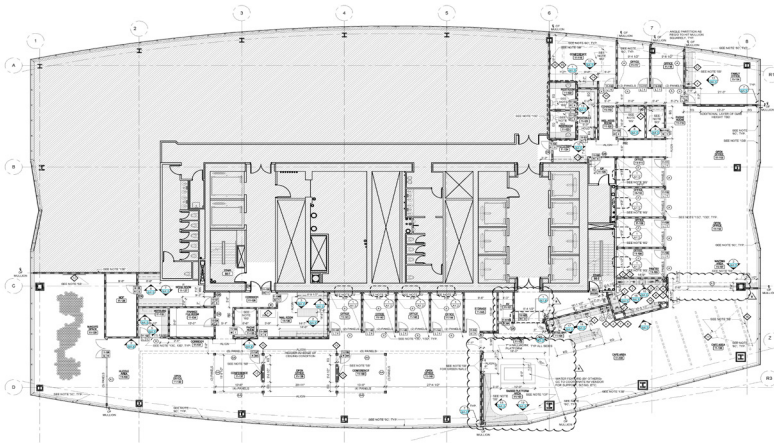

Contact

John Leubecker
Senior Vice President
+1 215 988 5529
john.leubecker@am.jll.com

Ashley Parrillo
Associate Vice President
+1 215 399 1820
ashley.parrillo@am.jll.com



Although information has been obtained from sources deemed reliable, JLL does not make any guarantees, warranties or representations, express or implied, as to the completeness or accuracy as to the information contained herein. Any projections, opinions, assumptions or estimates used are for example only. There may be differences between projected and actual results, and those differences may be material. JLL does not accept any liability for any loss or damage suffered by any party resulting from reliance on this information. If the recipient of this information has signed a confidentiality agreement with JLL regarding this matter, this information is subject to the terms of that agreement. ©2021. Jones Lang LaSalle IP, Inc. All rights reserved.