

BNY Mellon Center



HIGHEST SPACE AVAILABLE IN THE CITY
41,520 rsf contiguous

Jason Stewart
jason.stewart@am.jll.com

Jeff Adams
jeff.adams@am.jll.com



TENANT
CONFERENCE
CENTER



SAMPLE
TENANT
BUILDOUTS

BUILDING HIGHLIGHTS

- > Highest available contiguous floors in the city - 41,520 RSF
- > Brand new tenant conference center with modern AV technology
- > Unmatched 360° views of Pittsburgh
- > Mellon Green, a .75 acre outdoor green space with fountain and seating
- > Building retail including Citizens Bank, The Carlton Restaurant, Eadies Market, Crazy Mocha, and AT&T
- > Full-service cafeteria for breakfast and lunch
- > Direct and integral access to Grant Street T-Stop
- > 24 hour security personnel
- > On-site integral parking
- > Convenient downtown location

FLOOR PLANS

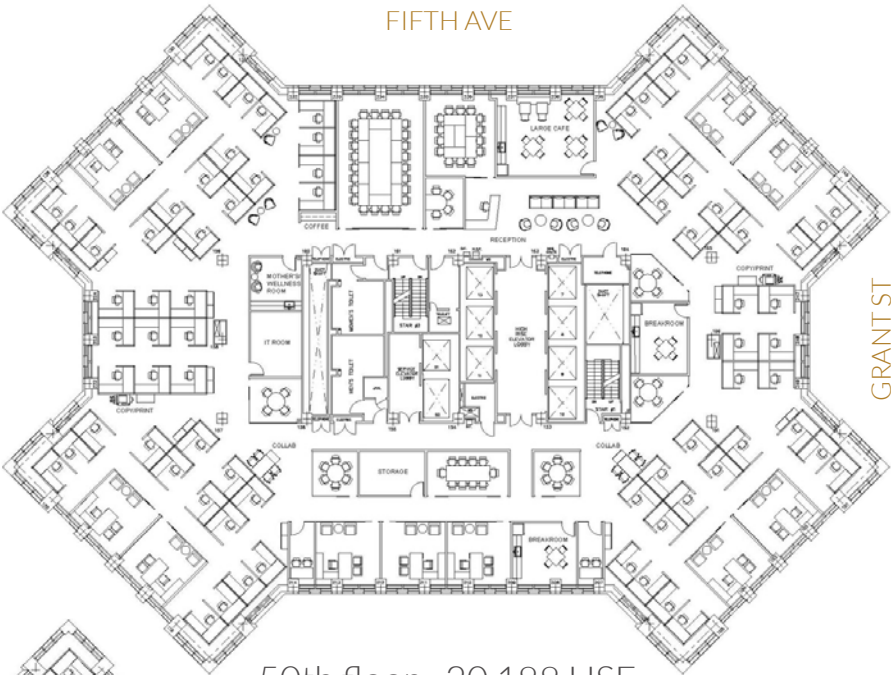

50th floor - 20,188 USF

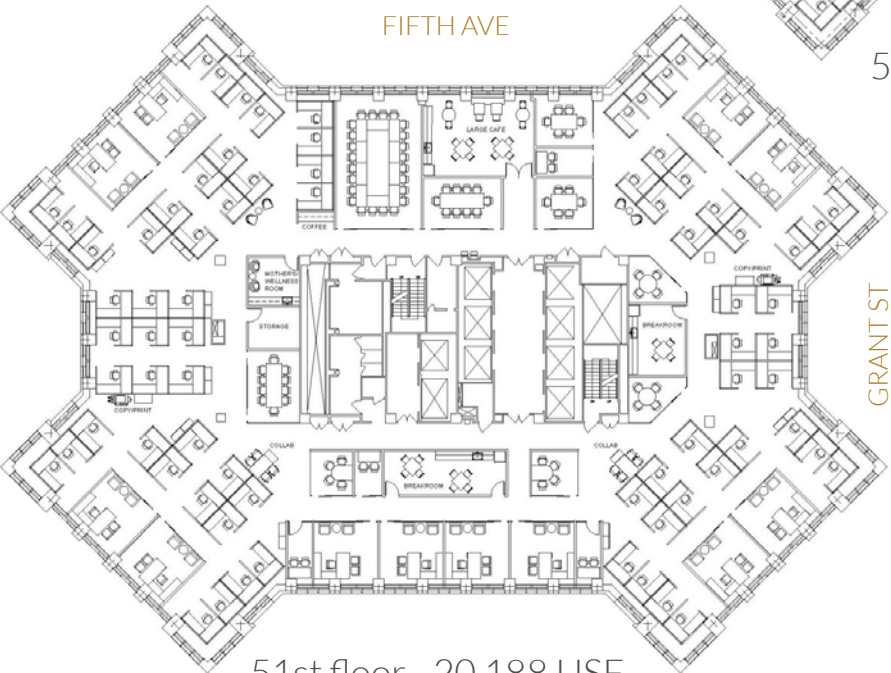

51st floor - 20,188 USF



AMERICA'S MOST LIVABLE CITY

Pittsburgh is a great place to work, and a downtown address is more desirable than it has been in decades. Some of the appeal is traditional. Successful new businesses have historically viewed a prestige location as evidence that they've "made it," while established firms rely on public transit and other urban services to meet the needs of their larger employee groups.

Pittsburgh's downtown core is more vibrant and more attractive than it has been in years. Parks have been renovated. Green space has been added. A wide range of new residency options create a true live-where-you-work opportunity for the first time in memory. The city is transformed. And the occupants of BNY Mellon Center enjoy their up-close view of Pittsburgh's new cityscape.

Jason Stewart
jason.stewart@am.jll.com

Jeff Adams
jeff.adams@am.jll.com

