

FOR LEASE

±17,600 SF industrial office/warehouse
Freehill Business Center
12850 Fuqua St | Houston, TX 77034



For Lease

±17,600 SF industrial office/warehouse
Freehill Business Center
12850 Fuqua St. | Houston, TX 77034

Site Features:

- Total: ±17,600 SF
- Office: ±1,951 SF
- Configuration: Rear Load
- Clear Height: 27'
- Column Spacing: 40' x 55'
- Truck Court Depth: 120'
- 4 Dock-High Loading Doors/ 2 Ramps
- Ample Employee Parking
- Excellent Access to I-45 & Beltway 8
- Strong, Diversified Workforce Nearby
- Lease Rate: Contact Brokers

Existing Site Plan

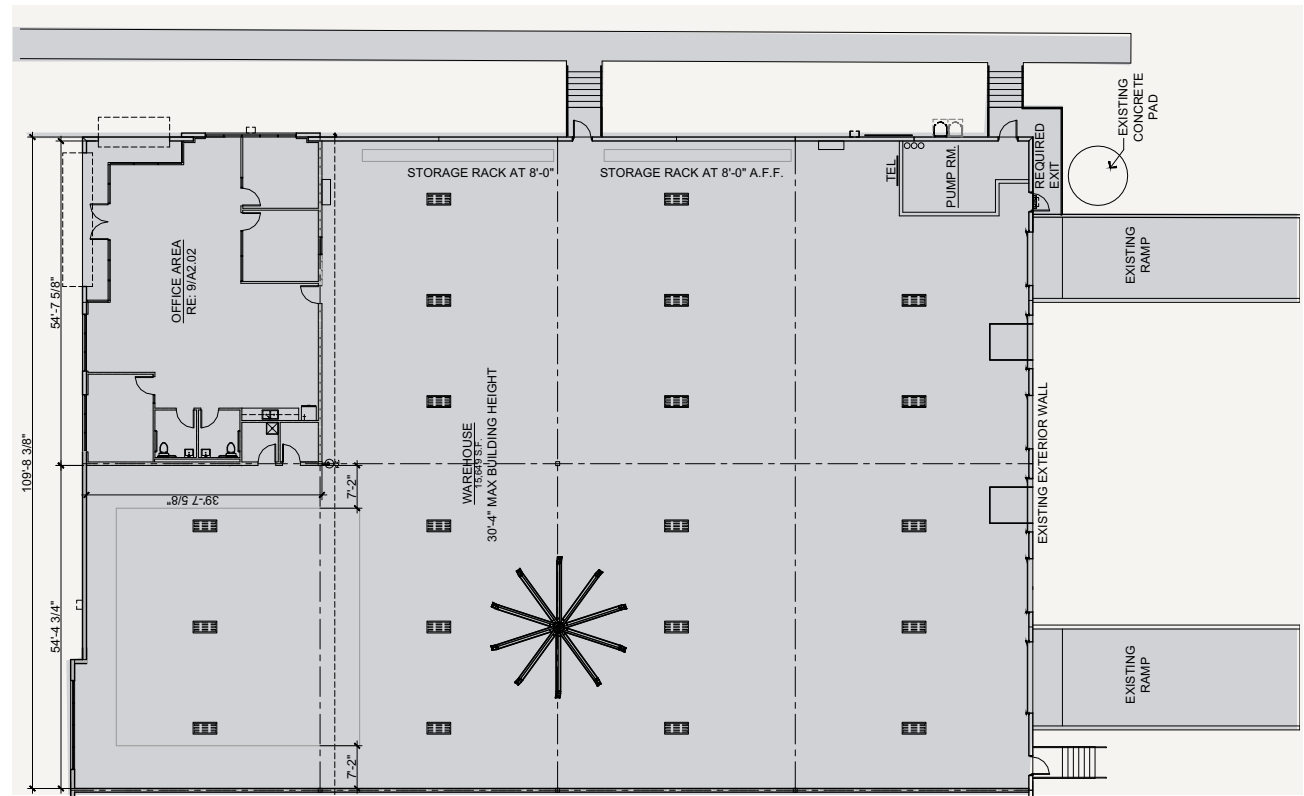

Although information has been obtained from sources deemed reliable, JLL does not make any guarantees, warranties or representations, express or implied, as to the completeness or accuracy as to the information contained herein. Any projections, opinions, assumptions or estimates used are for example only. There may be differences between projected and actual results, and those differences may be material. JLL does not accept any liability for any loss or damage suffered by any party resulting from reliance on this information. If the recipient of this information has signed a confidentiality agreement with JLL regarding this matter, this information is subject to the terms of that agreement. ©2021 Jones Lang LaSalle IP, Inc. All rights reserved.

Joseph Berwick
+1 713 425 5842
joseph.berwick@am.jll.com

Eliza Klein
+1 713 425 1816
eliza.klein@am.jll.com





Although information has been obtained from sources deemed reliable, JLL does not make any guarantees, warranties or representations, express or implied, as to the completeness or accuracy as to the information contained herein. Any projections, opinions, assumptions or estimates used are for example only. There may be differences between projected and actual results, and those differences may be material. JLL does not accept any liability for any loss or damage suffered by any party resulting from reliance on this information. If the recipient of this information has signed a confidentiality agreement with JLL regarding this matter, this information is subject to the terms of that agreement. ©2021 Jones Lang LaSalle IP, Inc. All rights reserved.

Joseph Berwick
+1 713 425 5842
joseph.berwick@am.jll.com

Eliza Klein
+1 713 425 1816
eliza.klein@am.jll.com



SUPERIOR REGIONAL CONNECTIVITY

DRIVE TIME SUMMARY

Metro	Distance	Travel Time	Population
ATX	181 mi	2.9 hrs	2.30MM
SA	212 mi	3.2 hrs	2.55MM
DAL	255 mi	3.9 hrs	7.75MM

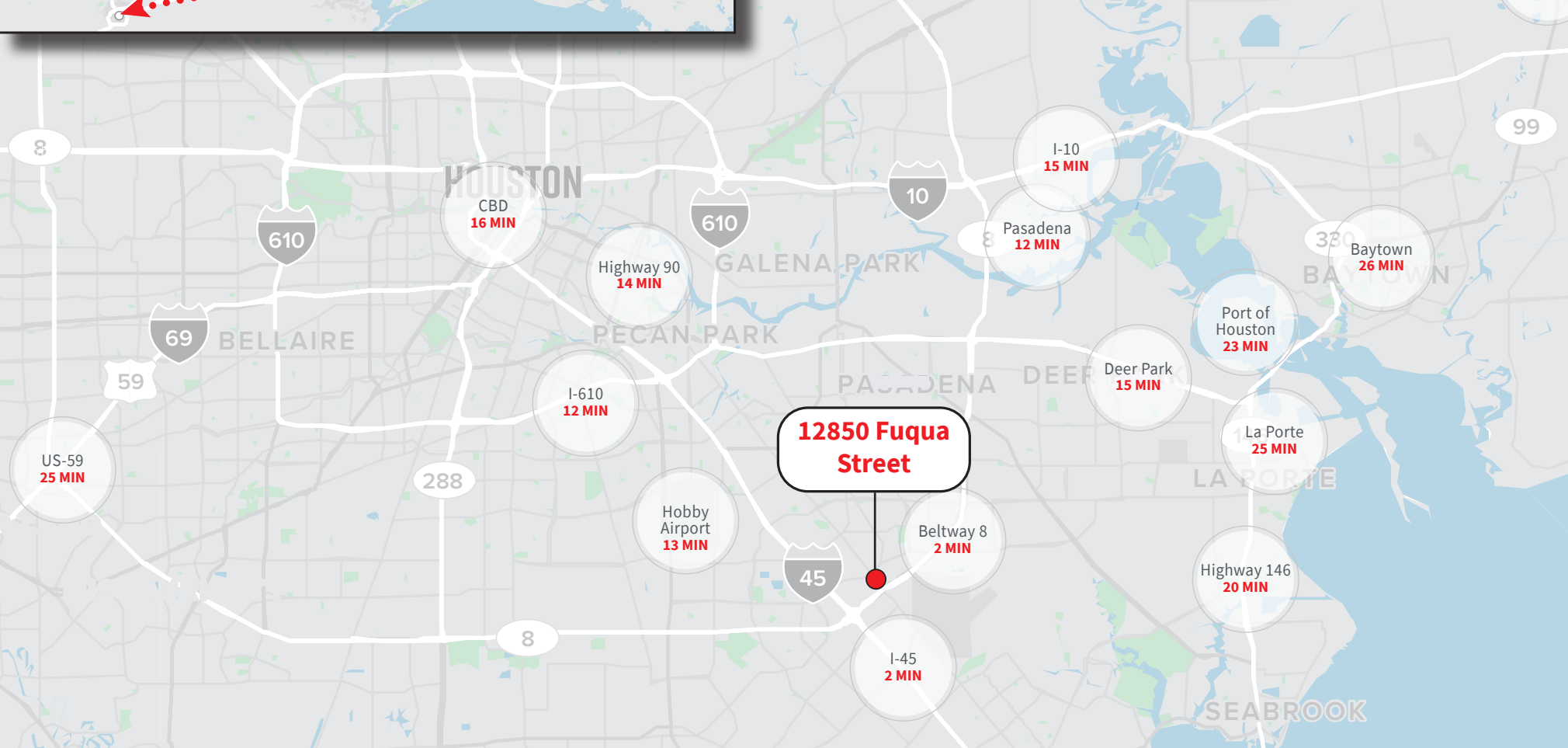
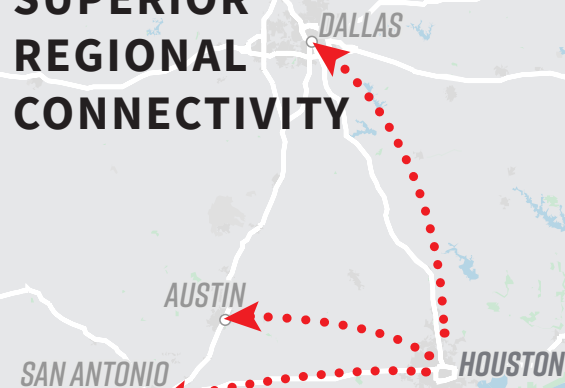

Although information has been obtained from sources deemed reliable, JLL does not make any guarantees, warranties or representations, express or implied, as to the completeness or accuracy as to the information contained herein. Any projections, opinions, assumptions or estimates used are for example only. There may be differences between projected and actual results, and those differences may be material. JLL does not accept any liability for any loss or damage suffered by any party resulting from reliance on this information. If the recipient of this information has signed a confidentiality agreement with JLL regarding this matter, this information is subject to the terms of that agreement. ©2021 Jones Lang LaSalle IP, Inc. All rights reserved.

Joseph Berwick
+1 713 425 5842
joseph.berwick@am.jll.com

Eliza Klein
+1 713 425 1816
eliza.klein@am.jll.com

