



# For Lease

## 10,073 sf space now available

- 9,253 sf office build-out
- \$11.50 PSF NNN
- 1 dock-high loading door
- Building exteriors: heavy exposed aggregate, precast concrete panels with extensive 9' and 12' glass lines
- Immediate access to K-10 / I-435 at Renner Boulevard and 119th Street
- Conveniently located at the southwest corner of College Boulevard and Renner

## College & Renner Corporate Center 11144 Renner Boulevard - Bldg B Lenexa, Kansas

**Kevin Wilkerson**

+1 913 469 4601

[kevin.wilkerson@am.jll.com](mailto:kevin.wilkerson@am.jll.com)

**Phil Algrim, SIOR**

+1 913 469 4605

[phil.algrim@am.jll.com](mailto:phil.algrim@am.jll.com)

**Erik Lund**

+1 913 469 4609

[erik.lund@am.jll.com](mailto:erik.lund@am.jll.com)



## Floor Plan

College & Renner Corporate Center

11144 Renner Boulevard - Bldg B

Lenexa, Kansas

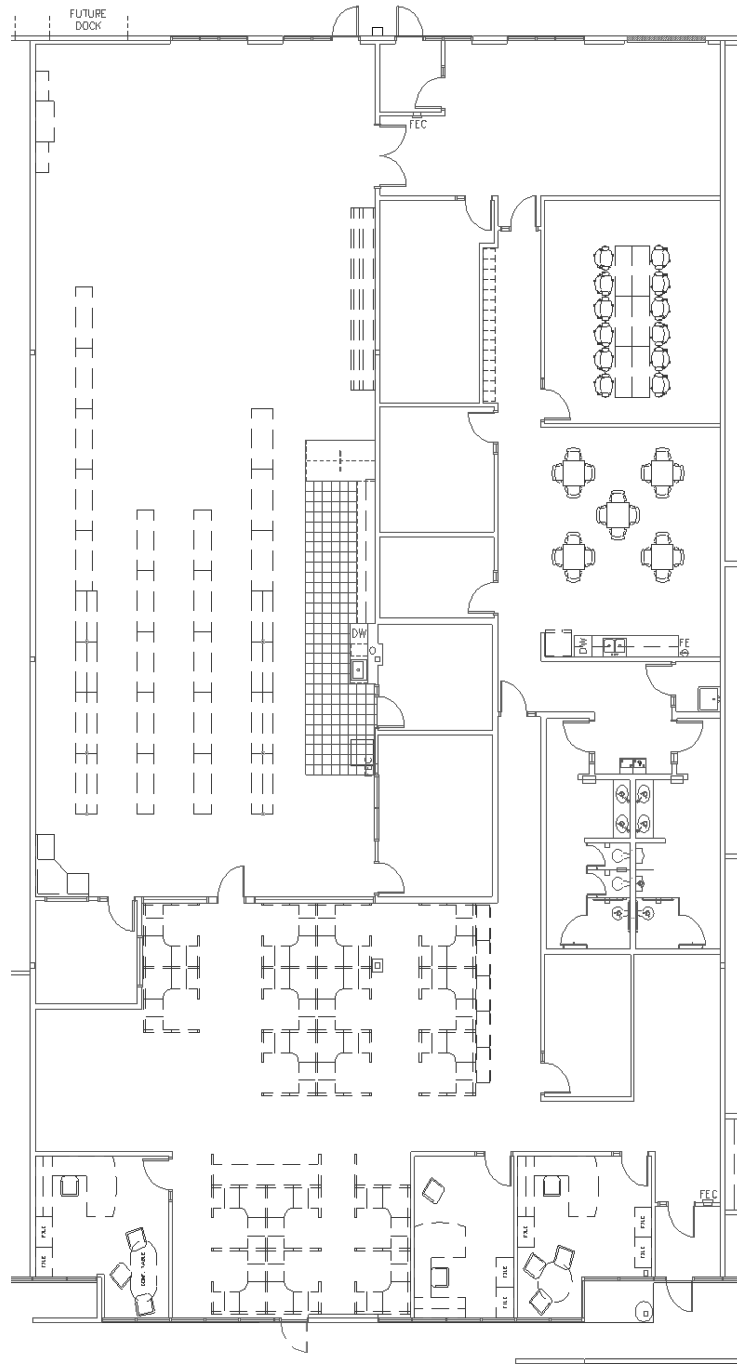

Although information has been obtained from sources deemed reliable, neither Owner nor JLL makes any guarantees, warranties or representations, express or implied, as to the completeness or accuracy as to the information contained herein. Any projections, opinions, assumptions or estimates used are for example only. There may be differences between projected and actual results, and those differences may be material. The Property may be withdrawn without notice. Neither Owner nor JLL accepts any liability for any loss or damage suffered by any party resulting from reliance on this information. If the recipient of this information has signed a confidentiality agreement regarding this matter, this information is subject to the terms of that agreement. ©2019 Jones Lang LaSalle IP, Inc. All rights reserved.

>>Check local legal requirements on the legal Connect page and paste additional requirements here, replacing this line and make black<<

