

685 THIRD AVENUE

GRAND CENTRAL RETAIL



LOCATION

Third Avenue
East side, between
43rd & 44th Streets

GROUND FRONTAGE STATUS

483 sf
Approx. 15'
Vacant

POSSESSION

Immediate

COMMENTS

- No branded coffee tenants
- High-traffic retail location at the base of a 650,000 sf Class A office building
- Steps from Grand Central Terminal
- Access to 4 5 6 7 S subway and Metro-North

NEIGHBORING RETAIL

Luke's Lobster
Chipotle
Naya Express
Le Pain Quotidien
Chop't
Inday

45M

Area Subway Ridership
2019 MTA

279K

Daytime Population
1/2 mile radius

45M+

SF of Premier
office space

27

Hotels
in the immediate area



Matthew Schuss
+212 812 5938
matthew.schuss@jll.com

Patrick A. Smith
+212 812 5888
patricka.smith@jll.com

AREA RETAIL



GROUND FLOOR

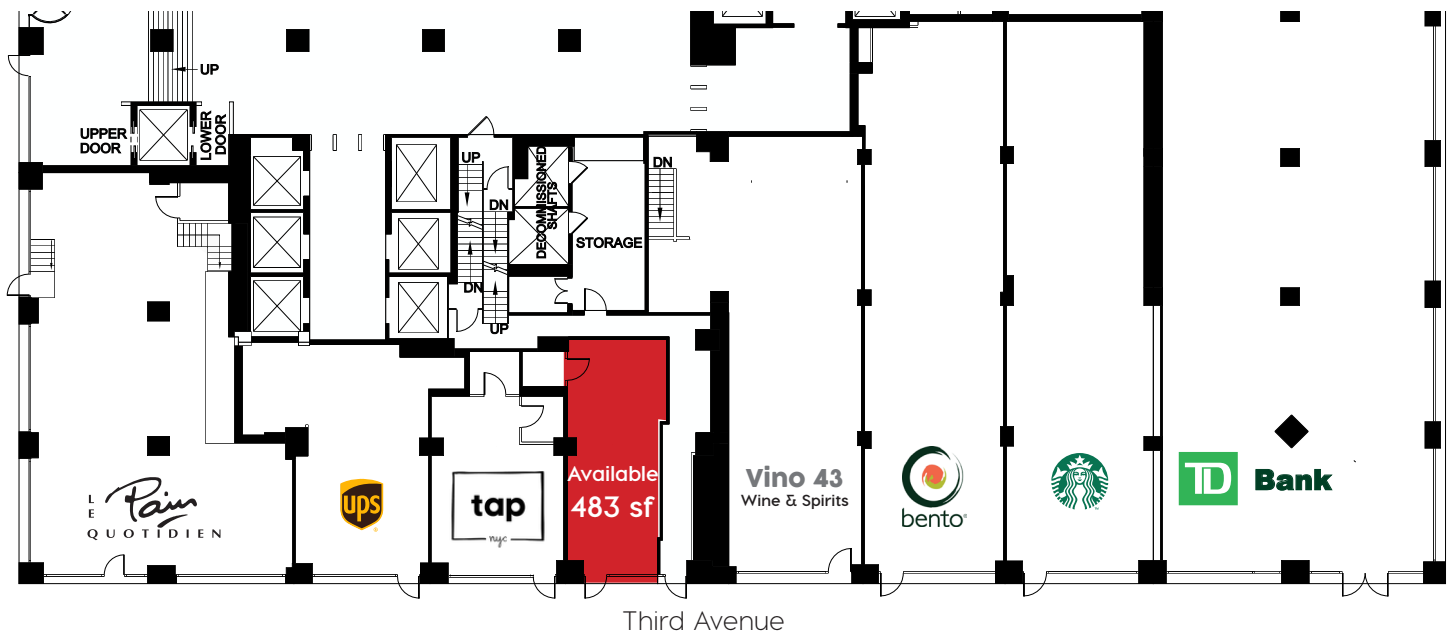

Third Avenue



Jones Lang LaSalle Brokerage, Inc. | 330 Madison Avenue New York, NY 10017

DISCLAIMER

Although information has been obtained from sources deemed reliable, neither Owner nor JLL makes any guarantees, warranties or representations, express or implied, as to the completeness or accuracy as to the information contained herein. Any projections, opinions, assumptions or estimates used are for example only. There may be differences between projected and actual results, and those differences may be material. The Property may be withdrawn without notice. Neither Owner nor JLL accepts any liability for any loss or damage suffered by any party resulting from reliance on this information. If the recipient of this information has signed a confidentiality agreement regarding this matter, this information is subject to the terms of that agreement. ©2023 Jones Lang LaSalle IP, Inc. All rights reserved.

