



For Sublease

A-Grade office space now available

- 16,179 SF of move-in ready space
- Full or partial space available
- Perfect for tech & other high growth companies looking for creative office with a flexible term
- On-site parking and great proximity to transit, 2 blocks to streetcar and 5 blocks to MAX.
- Shared outdoor deck, with sweeping city views
- Sublease term through May, 2023 with longer terms available
- New, fully updated kitchen
- Fitness center on site
- Call brokers for rates

Jones Lang LaSalle Brokerage, Inc.

1615 SE 3rd Avenue,
Portland OR

Niall Travers
+1 503 937 2177
niall.travers@am.jll.com

Alec Torkelson
+1 503 616 1120
alec.torkelson@am.jll.com

Candace Lounsbury
+1 503 937 2131
Candace.Lounsbury@am.jll.com





THE SPACE

Open floorplan with a mix of collaborative spaces, conference and training rooms with 17' high ceilings and sweeping city views.

Amenity-rich neighborhood, with coffee and sandwich shops in building.

Located in historic Industrial District in the hub of Portland's urban renewal area.



BIKERS
PARADISE



LEED
BUILDING



1/1000
PARKING

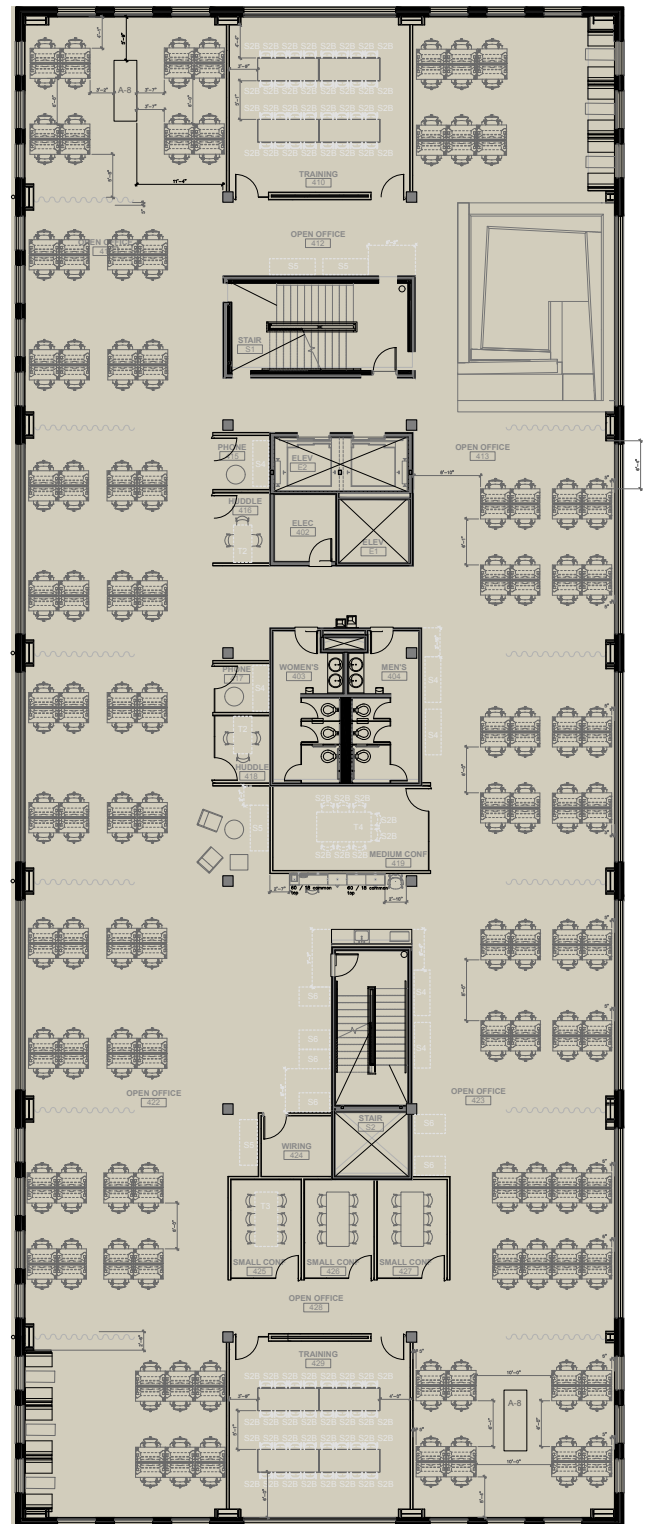

3rd Floor:
~16,179 SF