



*brightline*

FORT LAUDERDALE

# RETAIL FOR LEASE



*brightline*

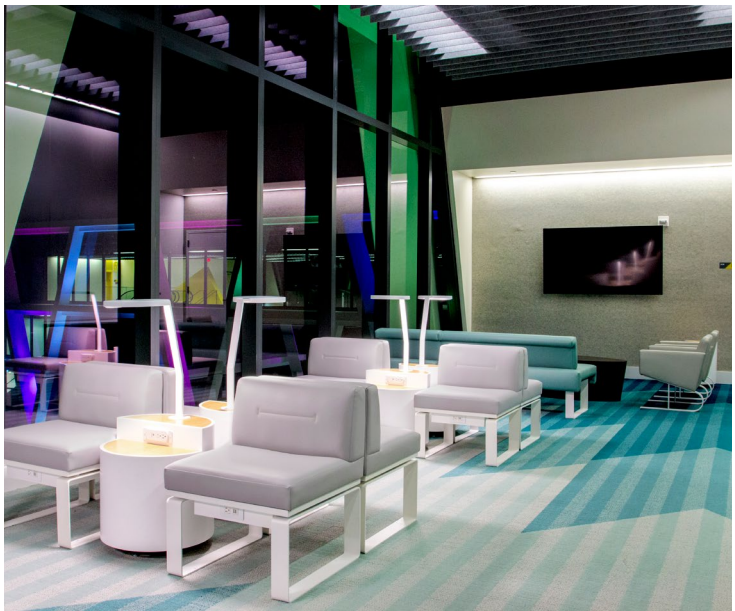

## BRIGHTLINE FORT LAUDERDALE

Located adjacent to the Central Business District, The Brightline Fort Lauderdale station provides access to the Museum of Discovery and Science, the Broward Center for the Performing Arts, NSU Art Museum For Lauderdale, FATVillage Arts District and more. This station also connects to additional transportation options to take you to the beaches, shopping, arts and the parks Fort Lauderdale is known for.

# GREATER FORT LAUDERDALE

3 MILES DEMOGRAPHICS



**149,239**  
Population



**\$88,945**  
Average Household Income



**41.8**  
Median Age



**202,696**  
Daytime Population



**36M+**

domestic and international travelers passed through FLL in 2018.

# SITE PLAN



**ZACH WINKLER**

**+ 1 (305) 704 1333**

[zach.winkler@am.jll.com](mailto:zach.winkler@am.jll.com)

**RAFAEL ROMERO, CCIM**

**+1 (305) 704 1403**

[rafael.romero@am.jll.com](mailto:rafael.romero@am.jll.com)

**KATIE FERNANDEZ-ESPINOSA**

**+1 (305) 960 8421**

[katie.fernandez-espinoza@am.jll.com](mailto:katie.fernandez-espinoza@am.jll.com)

