

SUITE 1550
10,401 RSF

SUITE 1500
11,137 RSF

SUITE 1501

SUITE 1502

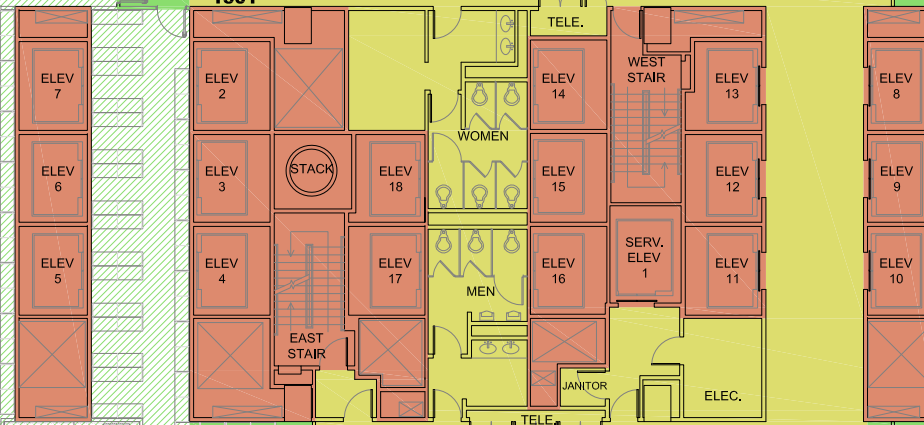

Proposed 07/25/22
15th Floor

401 N. Michigan Ave
Chicago, Illinois

- TENANT
- FLOOR COMMON
- BUILDING COMMON
- MAJOR VERTICAL PENETRATION



THE INFORMATION CONTAINED IN THE CADD DATABASE (ARCHIVES), OR AS SHOWN ON THIS DOCUMENT, WAS COMPRISED FROM INFORMATION PROVIDED BY ZELLER REALTY GROUP. NEITHER SDI PRESENCE, LLC, NOR ZELLER REALTY GROUP WARRANTS THE ACCURACY OF THE EXISTING CONDITIONS PORTRAYED IN THE DATABASE, OR ON THIS DOCUMENT. IT IS RECOMMENDED THAT PRIOR TO INITIATING ANY REVISIONS TO THIS DOCUMENT OR TO THE ACCOMPANYING CADD DATABASE, ALL PARTIES UTILIZING THIS INFORMATION RETAIN AN ARCHITECT AND/OR ENGINEER TO VERIFY THE EXISTING CONDITIONS.

401 N. Michigan, Chicago IL

Proposed Tenant Lease Information

Suite No.	Tenant Name	Occupant Storage	Calculated USF	Leased RSF	Add On Factor	Future RSF	Vacant RSF	(Variance)	Commence Date	Term Date
Suite 1500	Remaning	0.00	9,371.29		1.1884	11,137	11,137	0		N/A
Suite 1501	Remaning	0.00	52.20		1.1884	62	62	(0)		N/A
Suite 1502	Remaning	0.00	83.74		1.1884	100	100	0		N/A
Suite 1550	Proposed	0.00	8,752.39		1.1884	10,401	10,401	(0)		N/A
Total		0.00	18,259.61	0	1.1884	21,700	21,700	0		

Notes:	
--------	--

Issue Date:	7/25/2022
-------------	-----------