



±11,400 s.f. hangar **FOR SALE**



1500
Sally Ride Drive
Concord, California

Offering

JLL is please to offer for sale a rare opportunity to purchase a private aircraft hangar (on a long term ground lease) at Buchanan Field Airport in Concord, CA. 1500 Sally Ride Drive is a ±11,400 SF building with ±7,400 SF hangar bay and ±4,000 SF two-story office, including a lobby, three conference rooms, kitchen, break room, storage, bathrooms and showers. There is also an additional ±700 SF workshop with roll up door adjacent to the hangar.

Property specifications

Building size	±11,400 SF
Lot Size	0.86 Acres
Hangar Bay	±7,400 SF (100' wide x 74' deep)
Office Space	±4,000 SF (two-story)
Hangar Door	19' tall x 65' wide
Loading Door	1 grade-level
Parking	8 spaces + additional parking behind security gate
Power	400 amp; 240 volt
Ground Lease	thru June 20, 2046 (current monthly rent of \$2,514.88)
Built	1996
Additional Features	Private key-code controlled access gate; HVAC throughout office and warehouse areas; sprinklers; skylights; LED lighting

FIRST FLOOR

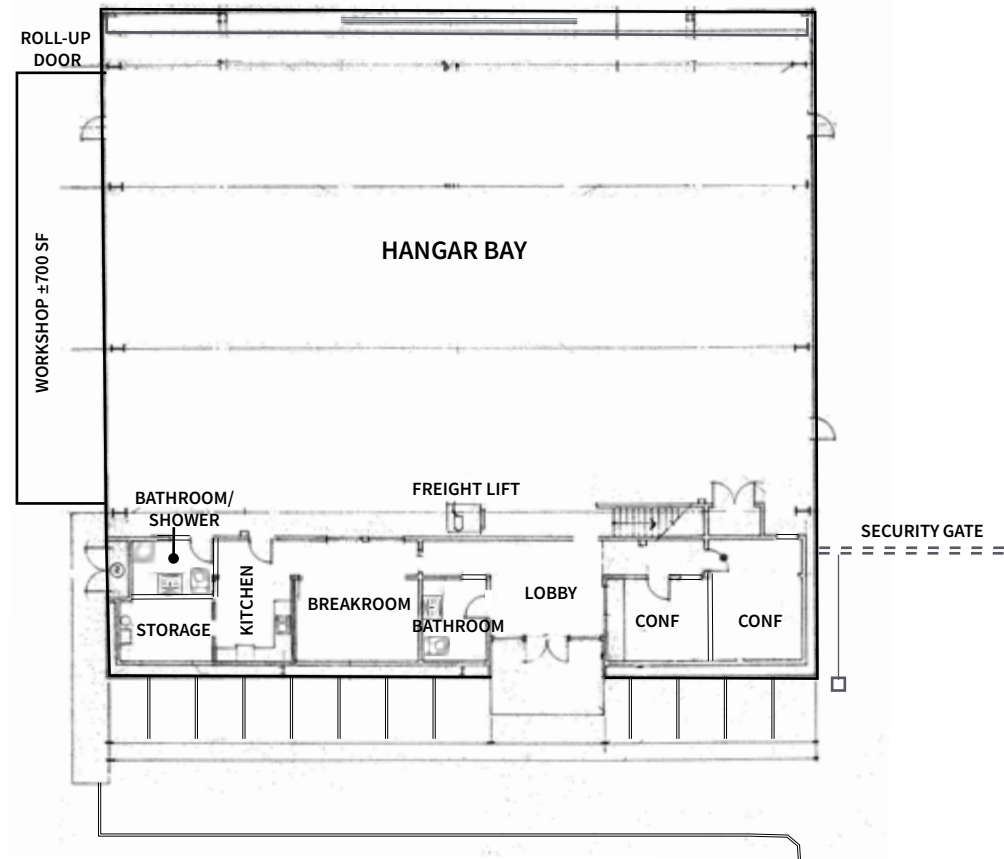

SECOND FLOOR



Location

Drive Times

Airports

Buchanan Field Airport	on site
Oakland Intl Airport	30 miles 30 minutes
San Francisco Intl Airport	40 miles 45 minutes

Ports

Port of Oakland	23 miles 26 minutes
Port of Benicia	10 miles 16 minutes

Freeways

Hwy 4	2.7 miles 5 minutes
Hwy 242	3 miles 6 minutes
Hwy 680	2.7 miles 6 minutes

Buchanan Field

1500 Sally Ride Drive is located within the Buchanan Field Airport, a county-owned public-use airport in Contra Costa County in Concord, CA.

Buchanan Field is strategically located in the triangle of I-680 and Hwys 242 & 4, providing excellent access to the entire East Bay and all of the SF Bay Area.

The Airport is home to numerous aviation related businesses, a daily public charter service operated by JetSuiteX connecting Concord with Burbank (LA), and Las Vegas, hangar rentals, flight clubs, fixed base operations (FBO), and is surrounded by dining, lodging, transportation and entertainment amenities in the city of Concord.

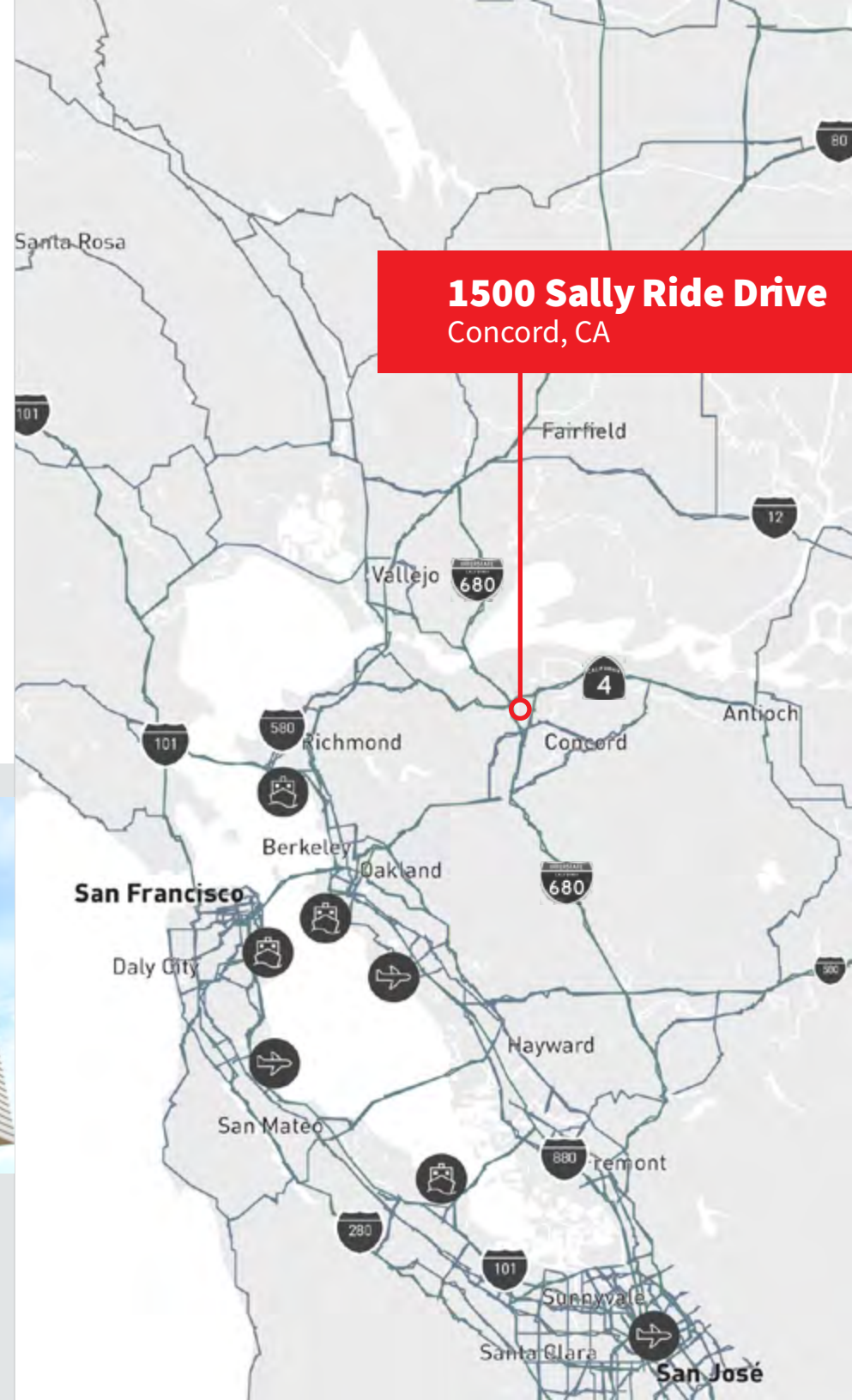

1500 Sally Ride Drive
Concord, CA

Site photos



Site photos

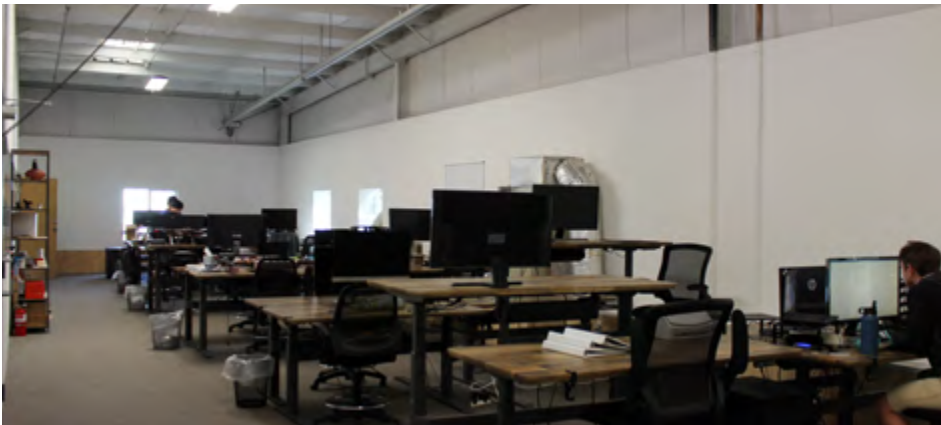

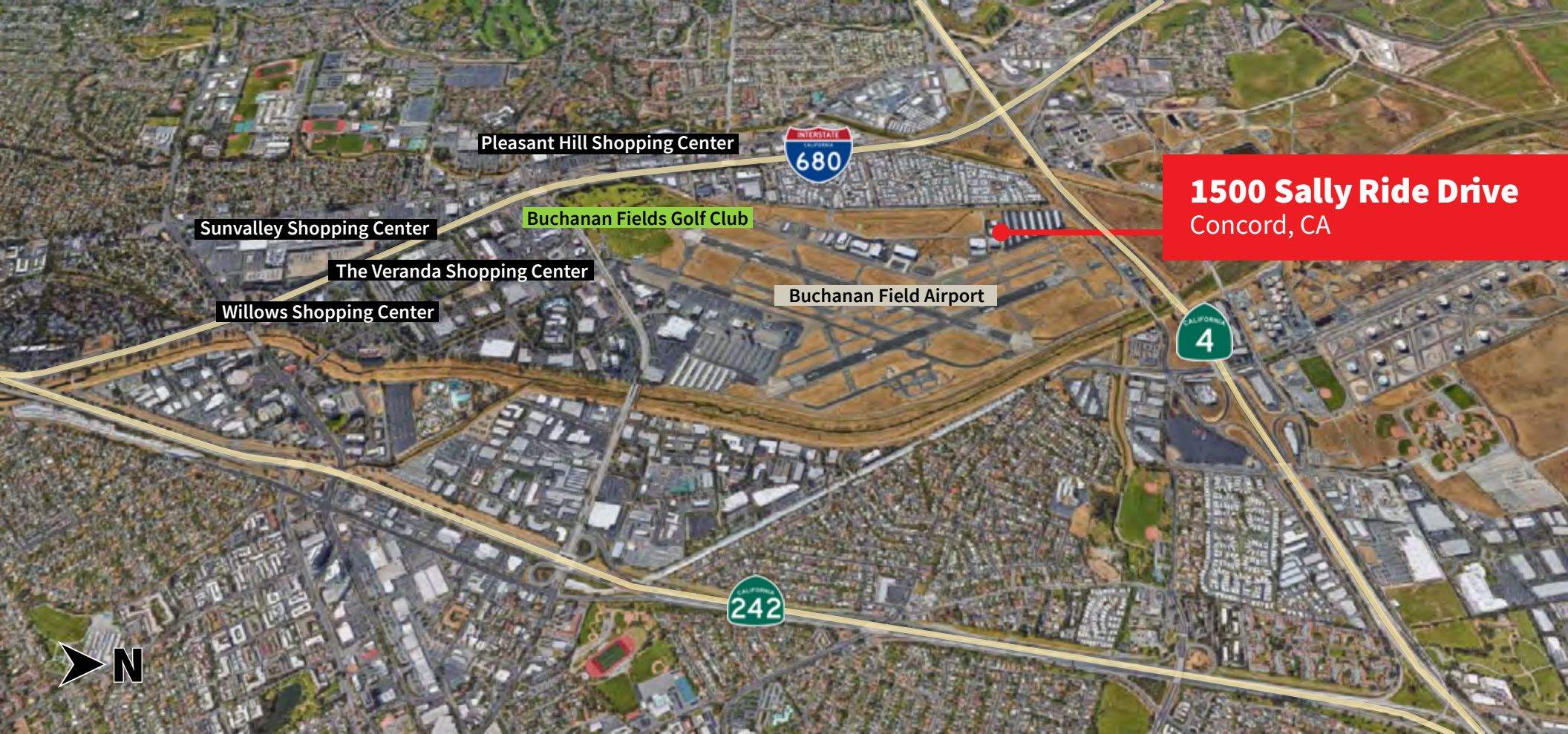

1500 Sally Ride Drive
Concord, CA

Contact

Matt Bracco
Sr. Managing Director
RE License # 01185434
+1 925 948 1305
matt.bracco@am.jll.com

Chris Burns
Vice President
RE License # 01880060
+1 925 948 1308
christopher.burns@am.jll.com