

MILLROCK EAST
6510 Millrock Drive
Salt Lake City, UT

Plug & Play Sublease
7,319 - 29,242 RSF
available now

Space Details

SPACE AVAILABLE
7,319 RSF
OPTION A

21,923 RSF
OPTION B

29,242 RSF
FULL THIRD FLOOR

PLUG & PLAY SUBLEASE
\$27.50 FSG
REDUCED LEASE RATE

4/1,000
PARKING RATIO

FLEXIBLE
TERM

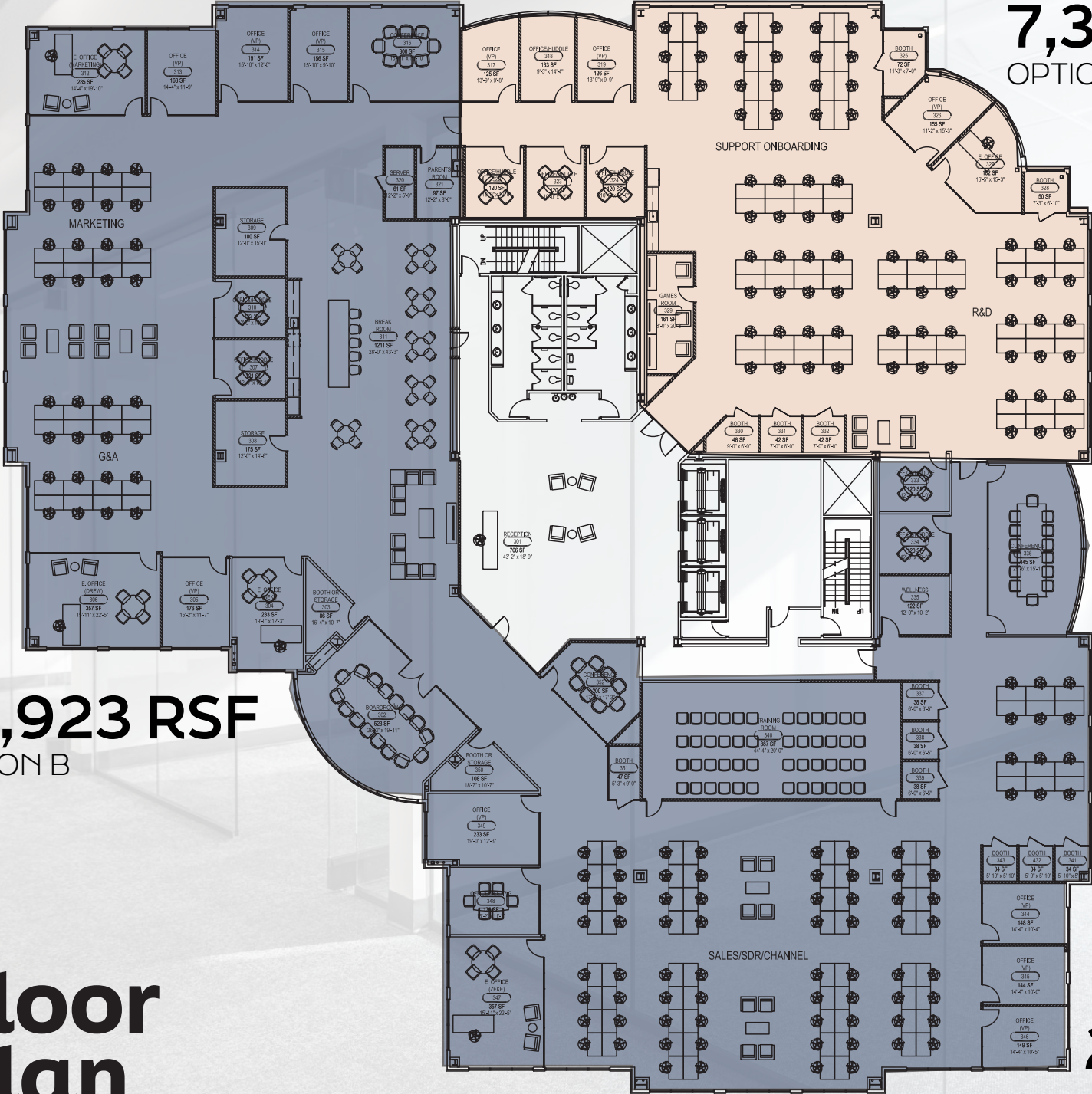

7,319 RSF
OPTION A

21,923 RSF
OPTION B

Floor Plan

29,242 RSF
FULL THIRD FLOOR



Building Amenities



Fitness Center



Panoramic Mountain Views



Outdoor Deck



Tenant Lounge and Event Facilities



Ample & Covered Parking



Highly Desirable & Accessible Location



Close Proximity to Restaurants, Banks & Shopping

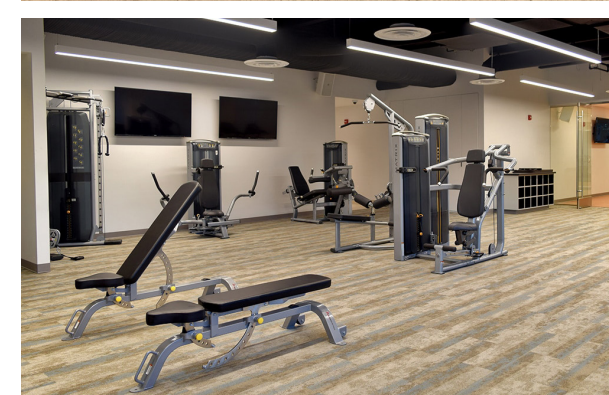
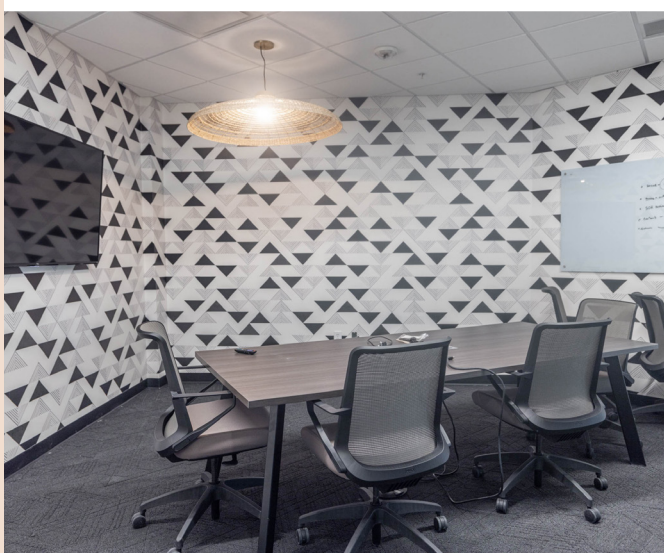

Strategically located on the prestigious
East Bench of Salt Lake City

Situated just below the Wasatch
Mountains with quick access to
Snowbird, Brighton and Alta ski resorts

Immediate access to I-215 makes
Downtown Salt Lake City and the
Salt Lake International Airport only a
20 minute drive

Amenities

1. Market Street Grill
2. Mountain America
3. Zions Bank
4. The Happy Sumo
5. Bout Time
6. Residence Inn
7. Spitz
8. Hyatt Place
9. Starbucks
10. Bandits' Grill & Bar



DAVID NIXON
+ 1 801 456 9518
david.nixon@jll.com

JILLIAN JOHNSON
+ 1 801 456 9517
jillian.johnson@jll.com

Jones Lang LaSalle Brokerage, Inc.

©2022 Jones Lang LaSalle LP, Inc. All rights reserved. All information contained herein is from sources deemed reliable; however, no representation or warranty is made to the accuracy thereof.