



301 HOWARD

2,100 Square Feet of Retail Space Available

South Financial District
San Francisco

THE MARKET SOUTH FiDi



Transbay Terminal

The new \$4.5 billion-dollar Transbay Terminal has opened, record setting leases have been signed and thousands of new residential units are set to deliver.

- Extending south of Mission Street from Second to Beale Streets, the Transit Center connects eight Bay Area counties through 11 transportation systems: AC Transit, BART, Caltrain, Golden Gate Transit, Greyhound, Muni, SamTrans, WestCAT Lynx, Amtrak, Paratransit and California's future High Speed Rail from San Francisco to Los Angeles/Anaheim.
- The Transit Center features "City Park," a public 5.4-acre rooftop park. The 1,400 foot long elevated park features a wide range of activities and amenities, including an outdoor amphitheater, gardens, trails, open grass areas, and children's play space, as well as a restaurant and cafe.



South Financial District

South FiDi is an ideal central location that houses multiple transportation options allowing people direct access to the Ferry, Bart, Muni and Transbay Terminal.

- Michelin starred restaurants sit side by side to many notable corporate headquarters.
- Few submarkets have seen more growth than the South Financial District.
- 129,756 total employees within a 10-minute walk time of the space.

South FiDi Area Map

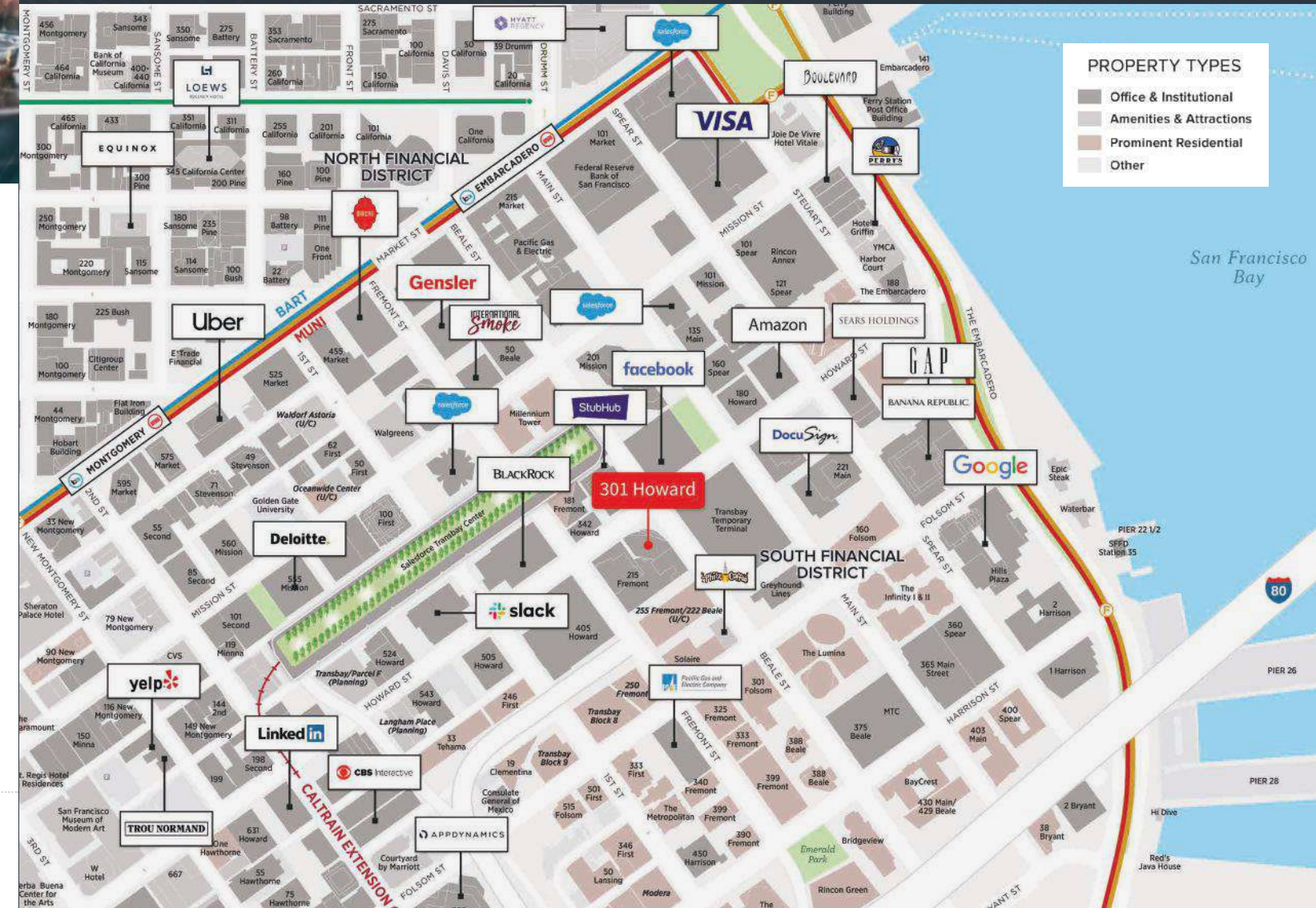

THE SPACE

Key Facts

- Located at the Southeast corner of Howard Street and Beale Street, the ground floor remodel of 301 Howard offers best in class space for premium food and beverage uses and retailers
- 2,100-square-foot space with double high ceilings, glass storefront, and an abundance of sunlight
- Situated across from the Transbay Terminal and 750,000-square-foot Class A Park Tower office building
- The space offers an unrivaled combination of pedestrian traffic, public transportation and population density
- Shell delivery available
- Type 1 venting installed

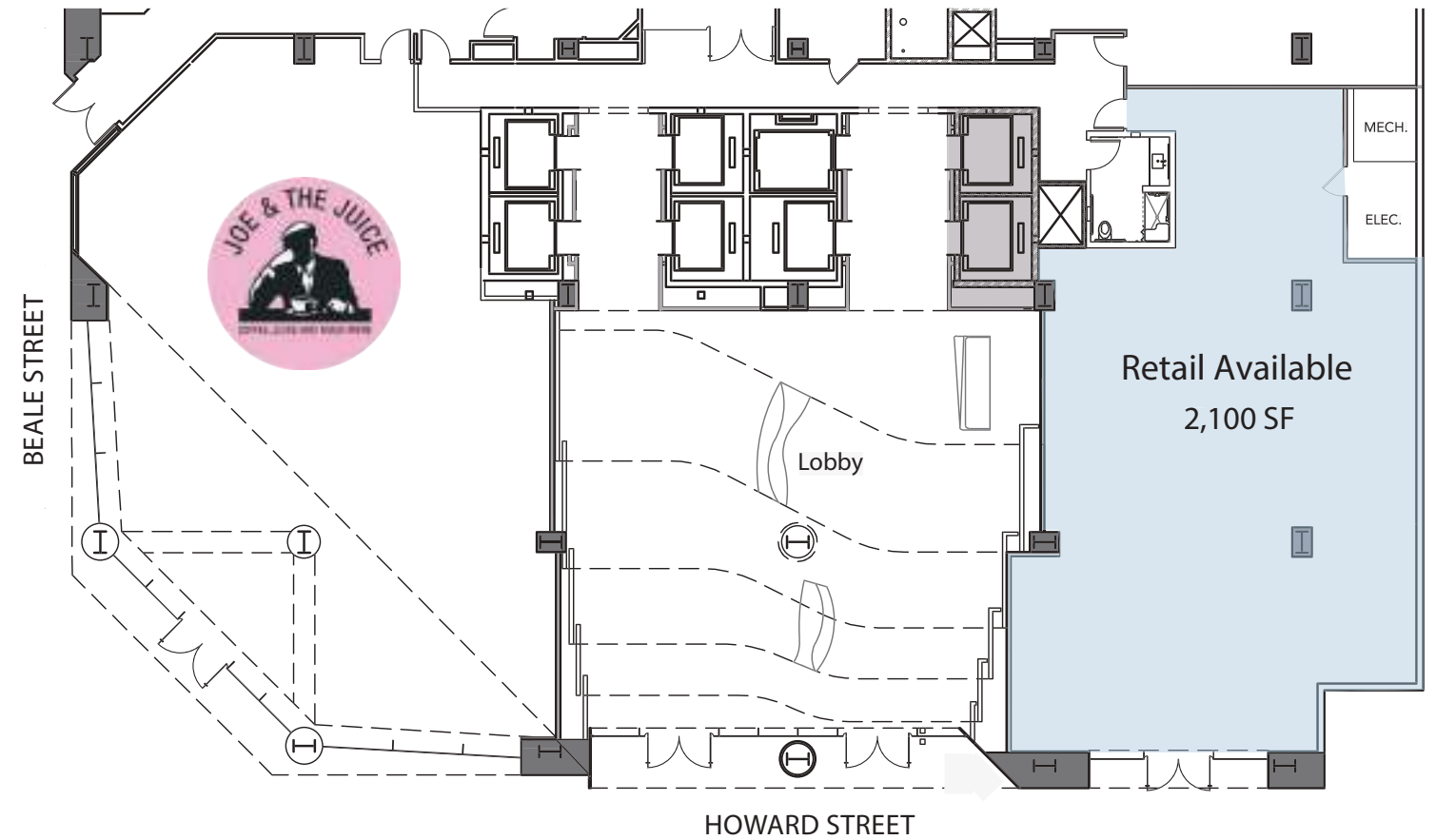



AREA DEMOGRAPHICS **SOUTH** **FiDi**



13,239

Population
(10-minute walk time)



\$137,383

Median Household Income
(10-minute walk time)



129,756

Total Employees
(10-minute walk time)



6,778

Total Businesses
(10-minute walk time)



301 HOWARD

Ben Lazzareschi
Managing Director
JLL Retail Brokerage Services
+1 415 228 3070
ben.lazzareschi@am.jll.com
RE Lic # 01414579

Laura Tinetti
Senior Vice President
JLL Retail Brokerage Services
+1 415 228 3072
laura.tinetti@am.jll.com
RE Lic # 01358500

David Kessler
Associate
JLL Retail Brokerage Services
+1 925 478 0386
david.kessler@am.jll.com
RE Lic #02112097

jll.com