



*For Sublease*

1,100 SF Retail Space Available

2743 E. Coast Highway, Corona Del Mar, CA 92625

Justin McMahon  
Vice President  
License # 01721162  
Tel +1 949 885 2968  
[justin.mcmahon@am.jll.com](mailto:justin.mcmahon@am.jll.com)  
[us.jll.com/retail](http://us.jll.com/retail)



# Property Highlights

2743 E. Coast Highway, Corona Del Mar, CA 92625

- Approximately 1,100 SF
- Sublease through 5/31/2026 with an additional 5 year option to extend
- Located on Pacific Coast Highway in the upscale beach community of Corona del Mar
- Abundant on-site parking
- Excellent demographics
- Co-Tenant with a high-volume Bruegger's!
- Close to Fashion Island
- Dense office population nearby
- Excellent signage on Pacific Coast Highway
- High pedestrian traffic area
- 52,000 cars pass this site per day





## AREA RETAILERS



Gulfstream



## DEMOGRAPHICS

	1 mile ▼	3 miles ▼	5 miles ▼
	<b>11,360</b> Total Population	<b>63,677</b> Total Population	<b>204,143</b> Total Population
	<b>5,725</b> No. of Households	<b>29,724</b> No. of Households	<b>79,688</b> No. of Households
	<b>\$242,153</b> Ave. HH Income	<b>\$234,735</b> Ave. HH Income	<b>\$171,428</b> Ave. HH Income
	<b>\$2.28 M</b> Median Home Value	<b>\$2.12 M</b> Median Home Value	<b>\$1.54 M</b> Median Home Value



# Site Plan

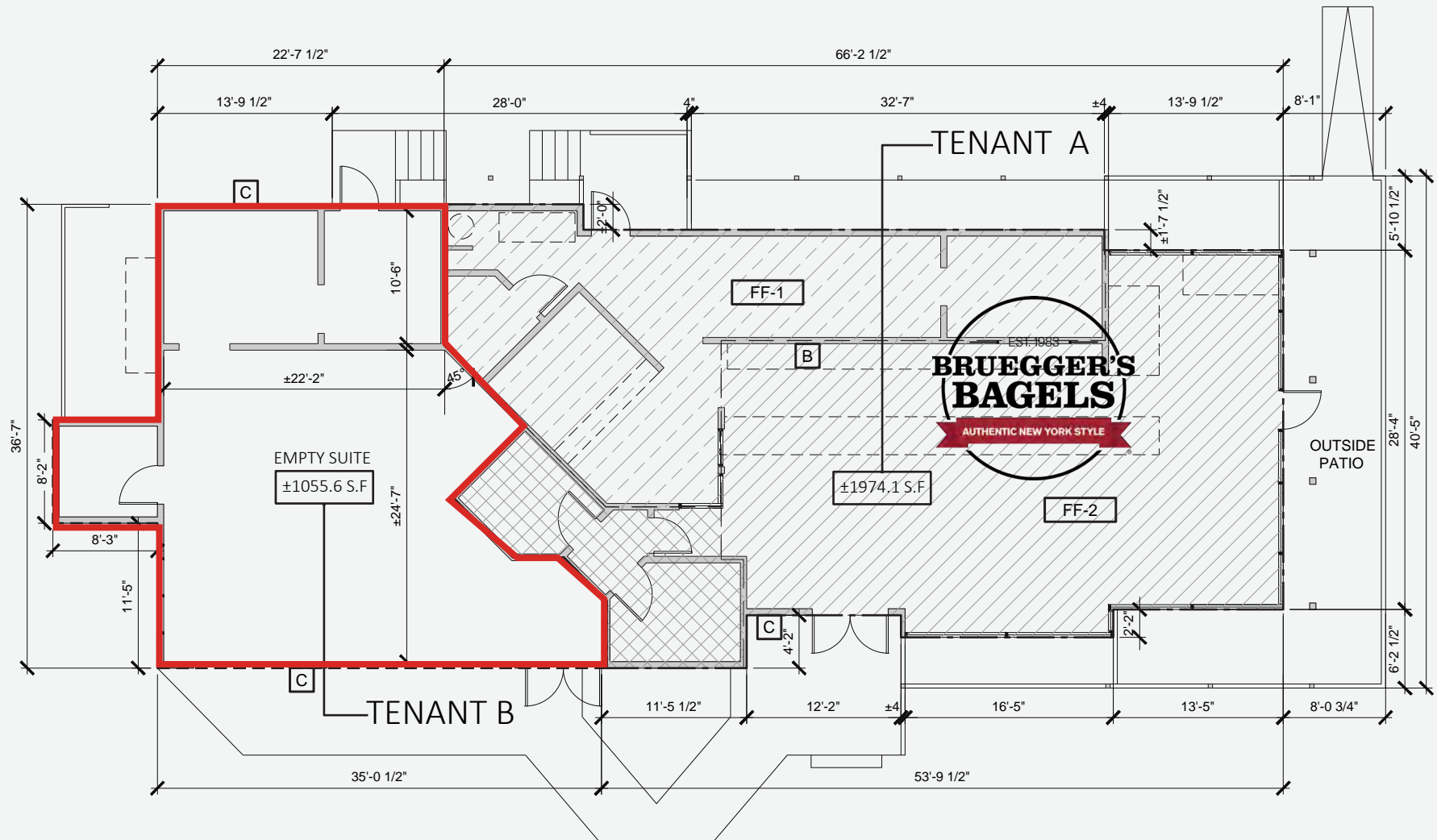



# Amenity Aerial







*Achieve  
Ambitions*

[us.jll.com/retail](https://us.jll.com/retail)

Justin McMahon  
Vice President  
License # 01721162  
Tel +1 949 885 2968  
[justin.mcmahon@am.jll.com](mailto:justin.mcmahon@am.jll.com)