



For Lease

Educational Cooperative Center at Gatelot Elementary School

65 Gatelot Avenue, Ronkonkoma, NY

65 Gatelot Avenue, Ronkonkoma, NY

Possible Divisions

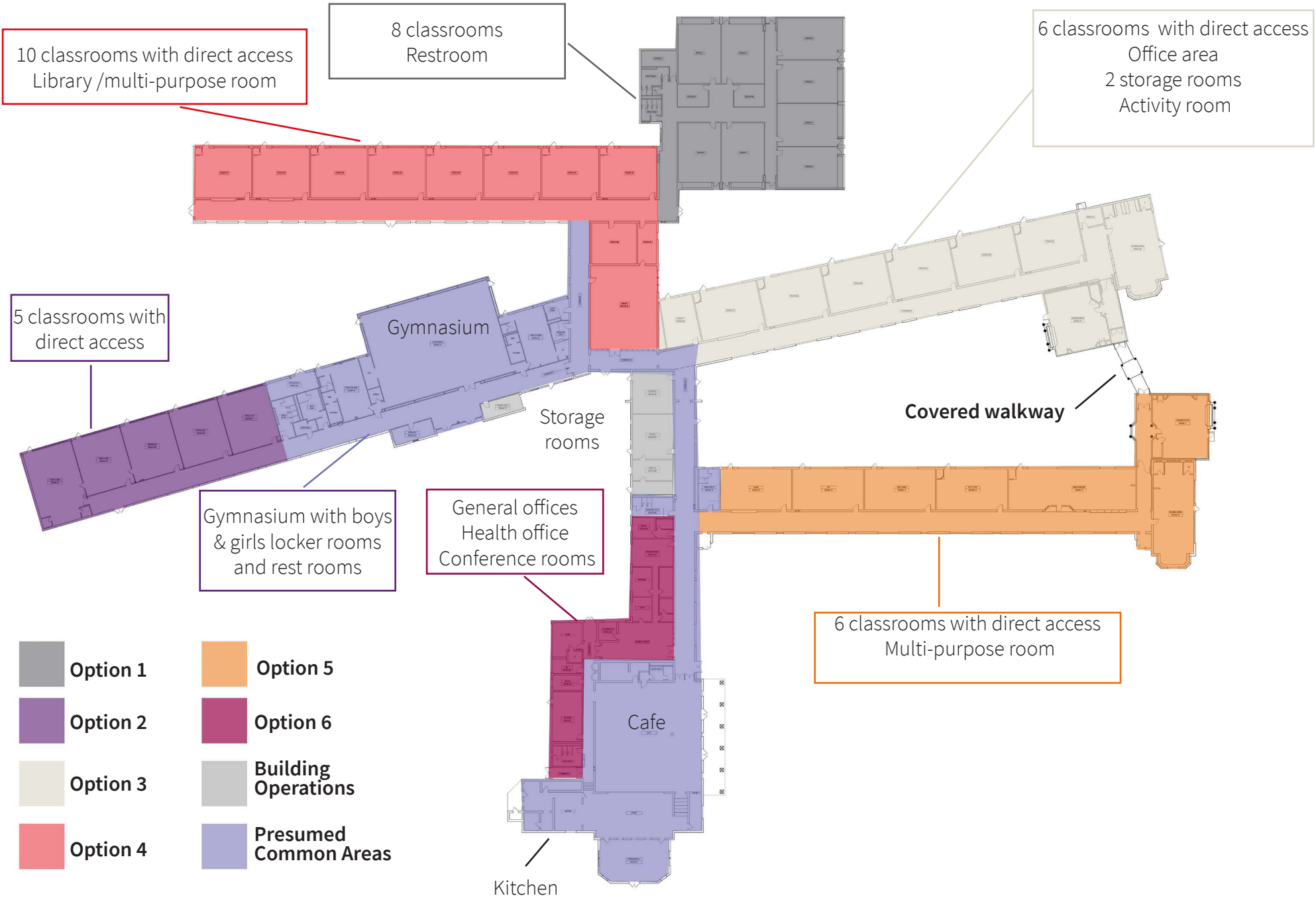

Building Features

Overview

Building size: 83,495 SF (divisible)

Plot size: 15.1 acres

Zoning: Community service

Pricing details: Please call for additional information

- Multiple updated playgrounds and sport fields surround the exterior of the building
- Abundant parking in front and rear of building
- Two main entrances, one with a drop off circle
- Main offices with fingerprint scanning system, PA system
- CCTV security system
- Voice over IP telephone system
- Additional Industrial freezer and refrigeration systems
- Portable serving line
- Loading dock
- Multi-purpose room: auditorium with adjoining rehearsal space/mobile cafeteria with adjacent commercial kitchen
- Wheel chair lift
- Classrooms with dedicated bathrooms
- Dual fired burners (natural gas & oil)
- Air conditioned server room
- Computer room
- Library
- Gymnasium with accordion partition plus boys & girls locker rooms with showers

www.educationalassetsli.com





65 Gatelot Avenue | Ronkonkoma, NY

Contacts

Ray Ruiz

Licensed Real Estate Broker
+1 631 962 2890
ray.ruiz@am.jll.com

Marianne Dugan

Licensed Real Estate Salesperson
+1 631 962 2891
marianne.dugan@am.jll.com

John A. Nielsen

Licensed Real Estate Salesperson
+1 631 962 7382
johna.nielsen@am.jll.com

Jones Lang LaSalle Brokerage, Inc.

Although information has been obtained from sources deemed reliable, neither Owner nor JLL makes any guarantees, warranties or representations, express or implied, as to the completeness or accuracy as to the information contained herein. Any projections, opinions, assumptions or estimates used are for example only. There may be differences between projected and actual results, and those differences may be material. The Property may be withdrawn without notice. Neither Owner nor JLL accepts any liability for any loss or damage suffered by any party resulting from reliance on this information. If the recipient of this information has signed a confidentiality agreement regarding this matter, this information is subject to the terms of that agreement. © 2020 Jones Lang LaSalle IP, Inc. All rights reserved.