

FOR SUBLEASE

FULL FLOOR OF **PLUG AND PLAY OFFICE** AVAILABLE

# 11330 OLIVE BOULEVARD

CREVE COEUR, MO 63141



SPACE

# HIGHLIGHTS

- + Plug and play ready with furniture available
- + Brand new modern build out including:
  - » Various collaboration areas
  - » Conference rooms
  - » Large gathering areas
  - » Kitchen and break spaces
  - » Open seating areas
- + Sublease term through May 31, 2030
- + **Lease rate:** Call broker for pricing



## FULL FLOOR AVAILABILITY

5TH

FLOOR

AVAILABLE 7/1/24

±29,644

RSF

## BRAND NEW BUILD OUT







## BUILDING FEATURES



Fitness center



Updated cafe & outdoor patio



Vehicle charging stations



Building renovations underway



4/1,000 SF parking ratio



Back-up generator



## FEATURES FULL PANTRY/GRAB & GO MARKET

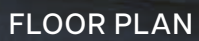

# 5TH FLOOR

AVAILABLE 7/1/24





184

INDIVIDUAL  
WORKSTATIONS

4

FOCUS  
ROOMS

9

CONFERENCE  
ROOMS

1

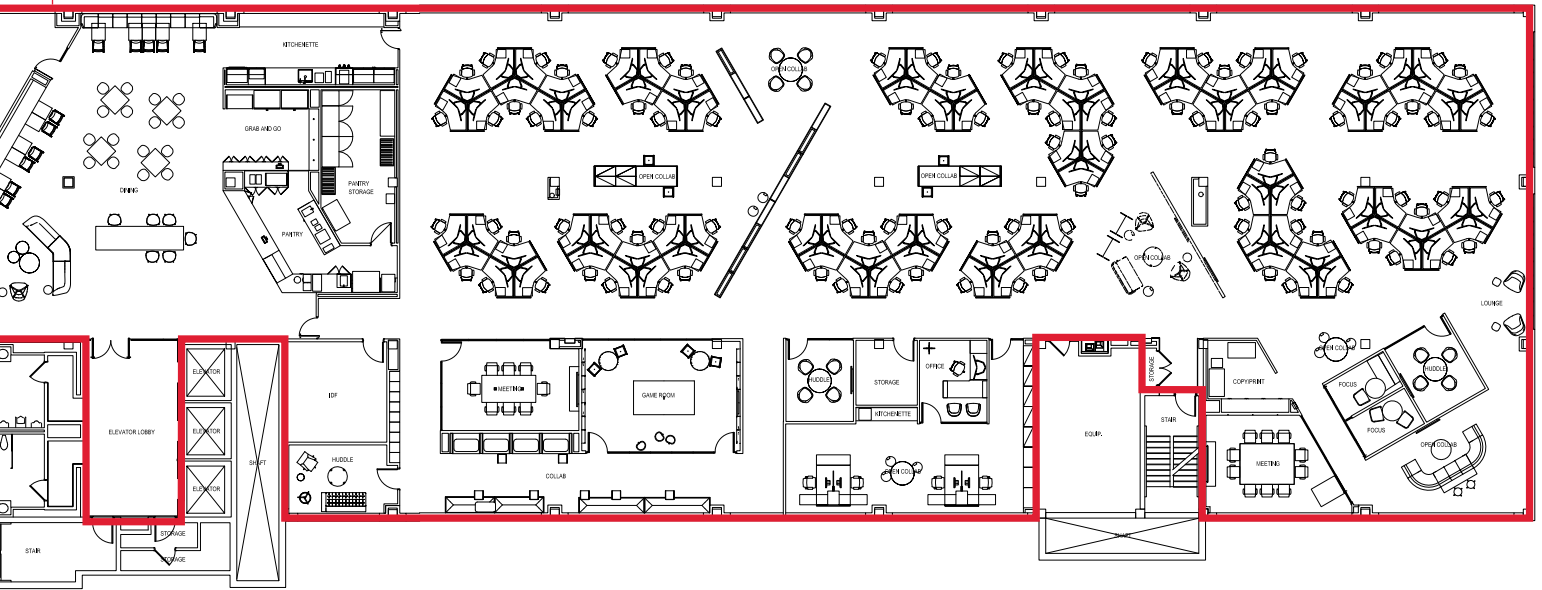
GAME  
ROOM

AREA

# AMENITIES

# DEMOGRAPHICS

ESRI 2021 FORECAST



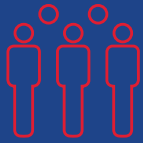

## POPULATION

5 Miles	171,012
10 Miles	806,870
15 Miles	1,516,480



## HOUSEHOLDS

5 Miles	72,894
10 Miles	343,155
15 Miles	630,639

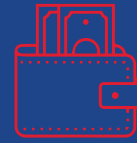

## AVG HH INCOME

5 Miles	\$136,439
10 Miles	\$116,214
15 Miles	\$105,595

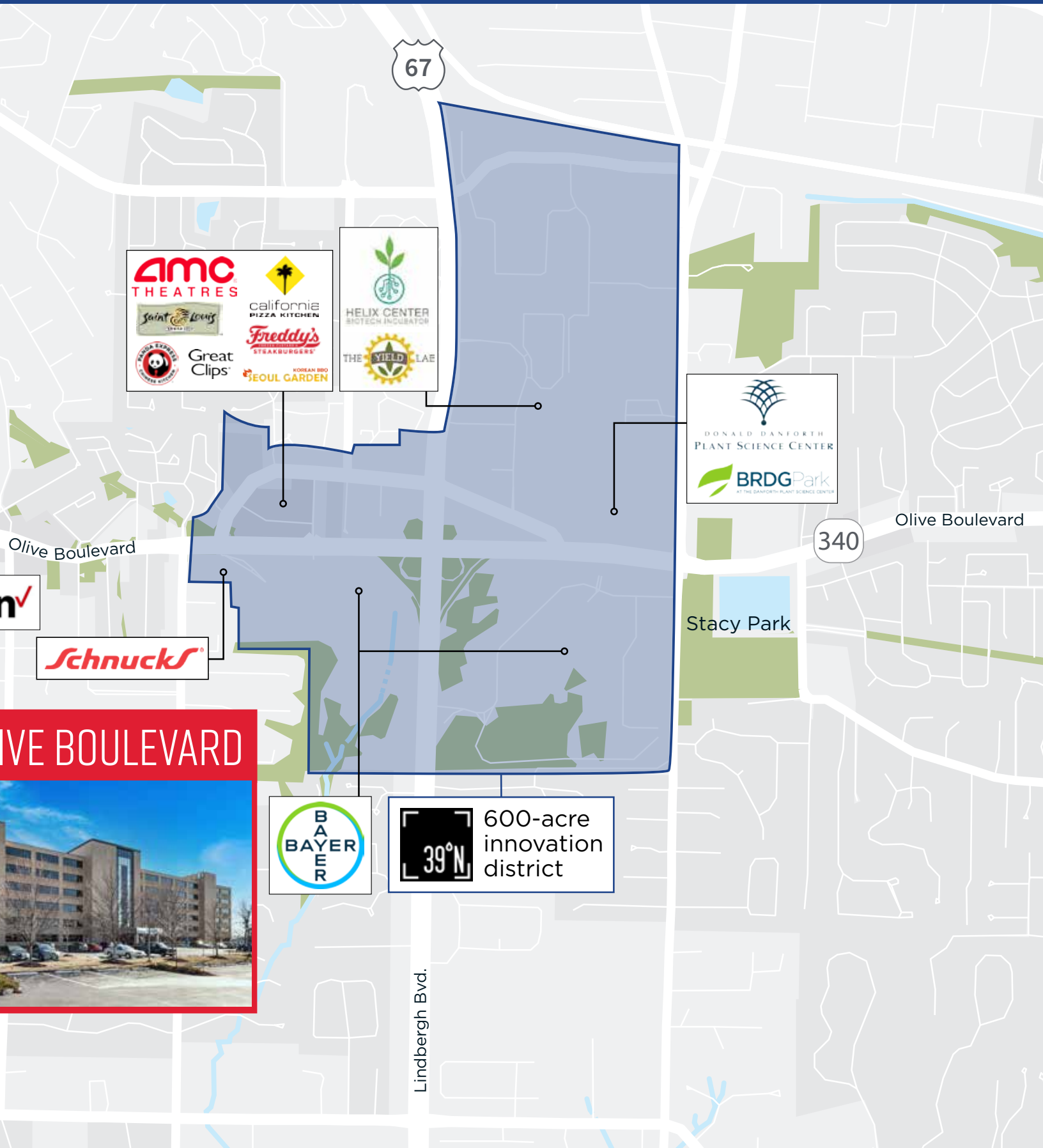





# 11330 OLIVE BOULEVARD

CREVE COEUR, MO 63141

## CONTACT

**David Steinbach**

+1 314 261 7369

david.steinbach@am.jll.com

Jones Lang LaSalle Americas, Inc.,  
a licensed real estate broker in 48 states

jll.com/st-louis  
+1 314 338 2080

DISCLAIMER Although information has been obtained from sources deemed reliable, neither Owner nor JLL makes any guarantees, warranties or representations, express or implied, as to the completeness or accuracy as to the information contained herein. Any projections, opinions, assumptions or estimates used are for example only. There may be differences between projected and actual results, and those differences may be material. The Property may be withdrawn without notice. Neither Owner nor JLL accepts any liability for any loss or damage suffered by any party resulting from reliance on this information. If the recipient of this information has signed a confidentiality agreement regarding this matter, this information is subject to the terms of that agreement. ©2022. Jones Lang LaSalle IP, Inc. All rights reserved.