

# For Sale/Lease

176 Otto Circle | Sacramento, CA 95822



## PROPERTY HIGHLIGHTS

- Building Size:  $\pm 5,100$  SF
- Warehouse:  $\pm 4,220$  SF
- Office:  $\pm 880$  SF (Two privates, HVAC throughout)
- Zoning: M - 1S, City of Sacramento
- Parcel Size:  $\pm 13,247$  SF
- Grade Level Doors: (1) 12' x 14' & (1) 8' x 10'
- One (1) exterior dock wall
- 220 v / 3 phase power
- PG&E Gas
- Electrical Distribution Throughout
- Clear Height: 15' - 16'
- Mezzanine Area:  $\pm 880$  SF
- Insulated Roof Deck

**Sean Merold, SIOR**  
Managing Director  
RE License # 01803204  
T +1 916 491 4313  
sean.merold@am.jll.com

**Howard Hughes**  
Senior Vice President  
RE License # 01026782  
T +1 916 491 4335  
howard.hughes@am.jll.com

**Mike Zimmerman, SIOR**  
Managing Director  
RE License # 01514055  
T +1 916 491 4312  
mike.zimmerman@am.jll.com

### DISCLAIMER

The material herein is intended as a guide only, no liability for negligence or otherwise is assumed for the material contained herein by Jones Lang LaSalle, its principal or its servants or its agents. No material contained herein shall form the basis of or be part of any agreement and no warranty is given or implied as to the accuracy of the whole or any part of the material. Prospective purchasers/tenants should not rely on the material but should make their own enquiries and satisfy themselves of all aspects of the material. Any liability by Jones Lang LaSalle, its principal, its servants or its agents in any way connected with the brochure, whether or not such liability results from or involves negligence, will not exceed \$1000.00.  
©2021. Jones Lang LaSalle IP, Inc. All rights reserved. Jones Lang LaSalle Brokerage, Inc. Real Estate License #01856260





## SITE PLAN

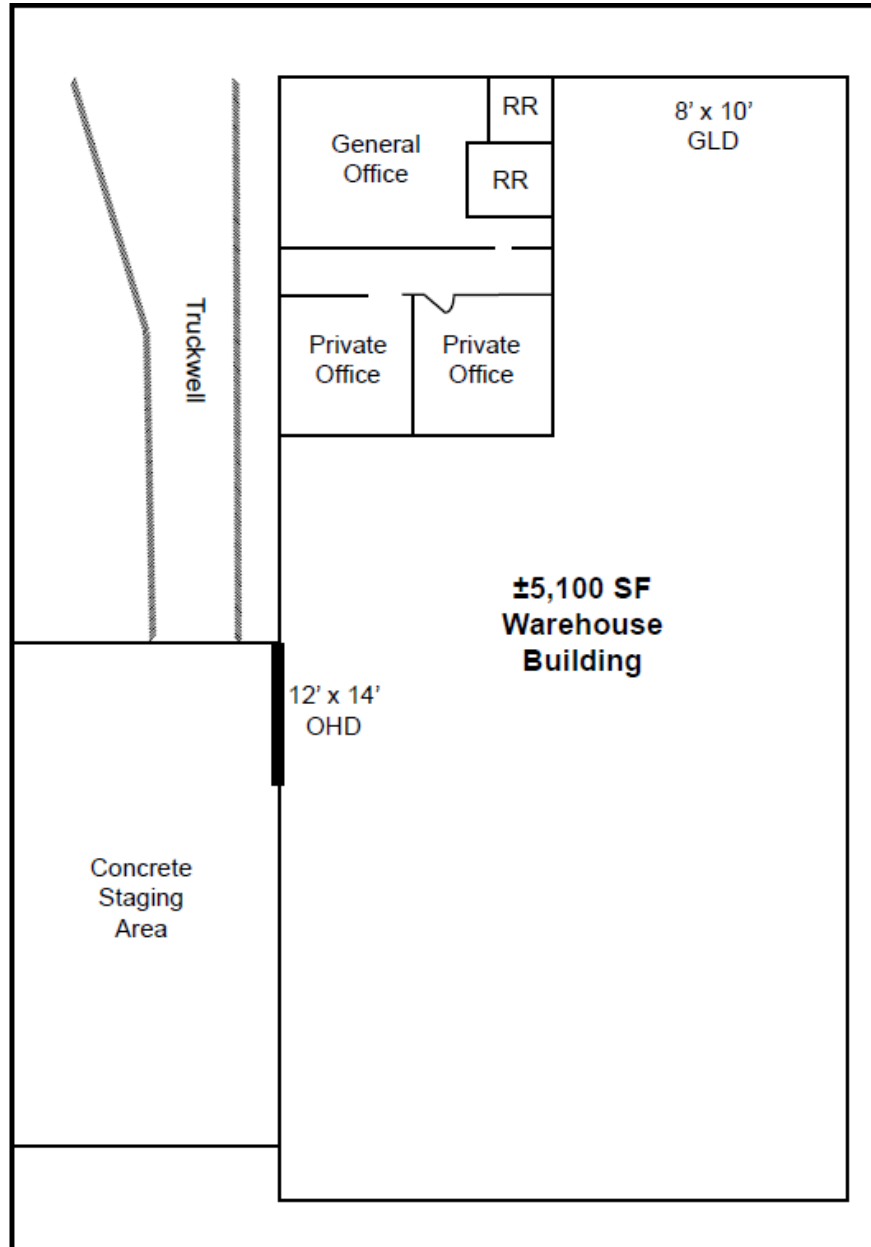

Floor Plan Not to Scale

**Sean Merold, SIOR**  
Managing Director  
RE License # 01803204  
T +1 916 491 4313  
sean.merold@am.jll.com

**Howard Hughes**  
Senior Vice President  
RE License # 01026782  
T +1 916 491 4335  
howard.hughes@am.jll.com

**Mike Zimmerman, SIOR**  
Managing Director  
RE License # 01514055  
T +1 916 491 4312  
mike.zimmerman@am.jll.com

### DISCLAIMER

The material herein is intended as a guide only, no liability for negligence or otherwise is assumed for the material contained herein by Jones Lang LaSalle, its principal or its servants or its agents. No material contained herein shall form the basis of or be part of any agreement and no warranty is given or implied as to the accuracy of the whole or any part of the material. Prospective purchasers/tenants should not rely on the material but should make their own enquiries and satisfy themselves of all aspects of the material. Any liability by Jones Lang LaSalle, its principal, its servants or its agents in any way connected with the brochure, whether or not such liability results from or involves negligence, will not exceed \$1000.00.  
©2021. Jones Lang LaSalle IP, Inc. All rights reserved. Jones Lang LaSalle Brokerage, Inc. Real Estate License #01856260





**AERIAL**

---



**Sean Merold, SIOR**  
Managing Director  
RE License # 01803204  
T +1 916 491 4313  
sean.merold@am.jll.com

**Howard Hughes**  
Senior Vice President  
RE License # 01026782  
T +1 916 491 4335  
howard.hughes@am.jll.com

**Mike Zimmerman, SIOR**  
Managing Director  
RE License # 01514055  
T +1 916 491 4312  
mike.zimmerman@am.jll.com

**DISCLAIMER**

The material herein is intended as a guide only, no liability for negligence or otherwise is assumed for the material contained herein by Jones Lang LaSalle, its principal or its servants or its agents. No material contained herein shall form the basis of or be part of any agreement and no warranty is given or implied as to the accuracy of the whole or any part of the material. Prospective purchasers/tenants should not rely on the material but should make their own enquiries and satisfy themselves of all aspects of the material. Any liability by Jones Lang LaSalle, its principal, its servants or its agents in any way connected with the brochure, whether or not such liability results from or involves negligence, will not exceed \$1000.00.  
©2021. Jones Lang LaSalle IP, Inc. All rights reserved. Jones Lang LaSalle Brokerage, Inc. Real Estate License #01856260

