



For Sale

Former Walgreens Available For Sale

- Located within a dense retail corridor of Naperville
- 66 free surface spaces are available
- Ideal for retail, restaurant, service and medical users
- +/- 14,490 SF/ 1,810 acre parcel
- 212' on Amersale Dr
- Somewhat Walkable (56) Some Transit (38)

**688 Amersale Dr
Naperville, IL 60563**

Matt Ramsey

312.228.2348

Matt.Ramsey@am.jll.com

SVP, Brokerage

Anthony Genovese

312.228.3252

anthony.genovese@am.jll.com

Associate, Brokerage

jllretail.com

DISCLAIMER

© 2018 Jones Lang LaSalle IP, Inc. All rights reserved. All information contained herein is from sources deemed reliable; however, no representation or warranty is made to the accuracy thereof.



Demos

1 Miles

Estimated Population 14,170
Average Household Income \$101,912

3 Miles

Estimated Population 74,910
Average Household Income \$90,123

5 Miles

Estimated Population 173,277
Average Household Income \$119,370

*All numbers are taken from ESRI

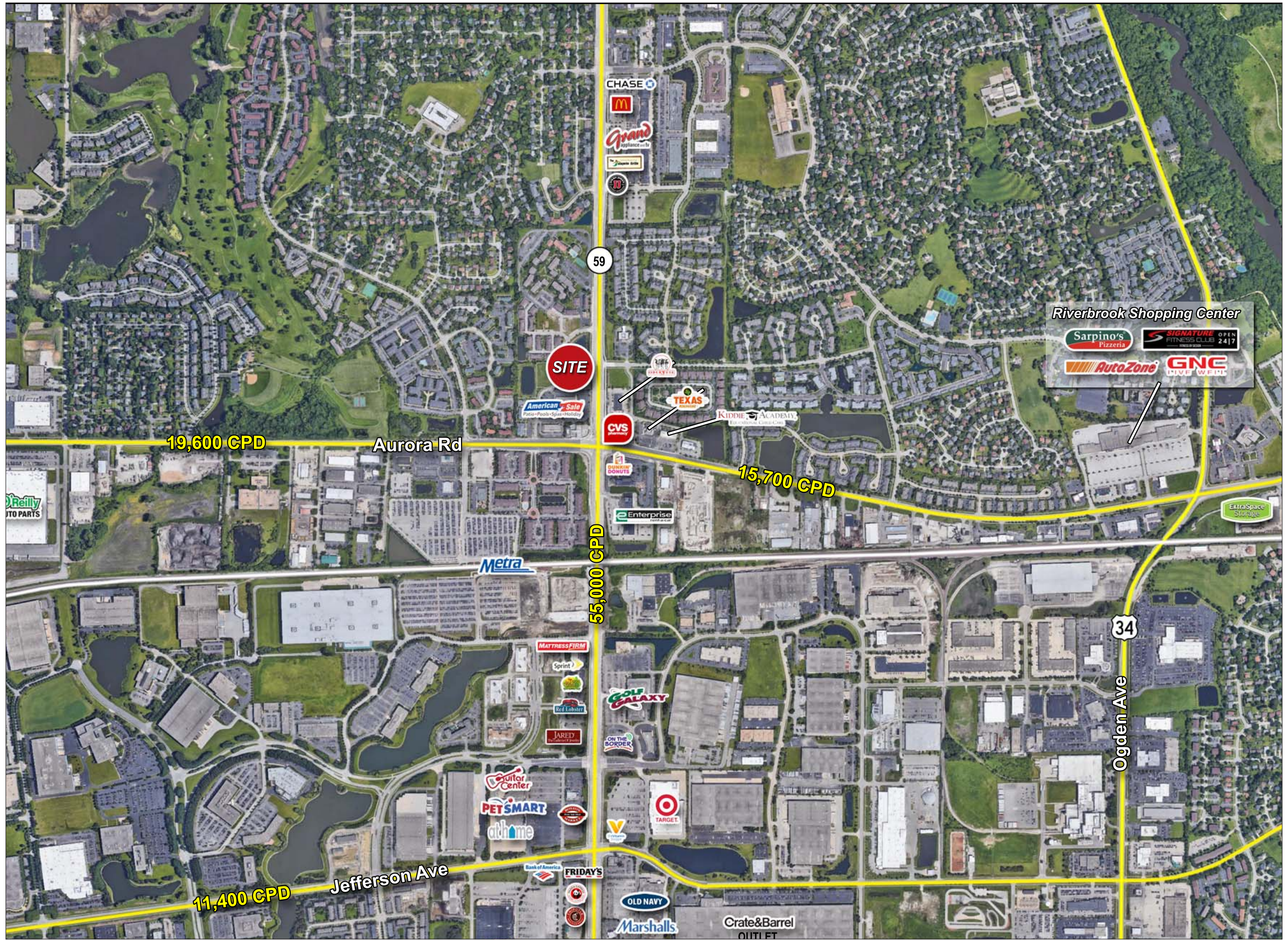

Site Plan

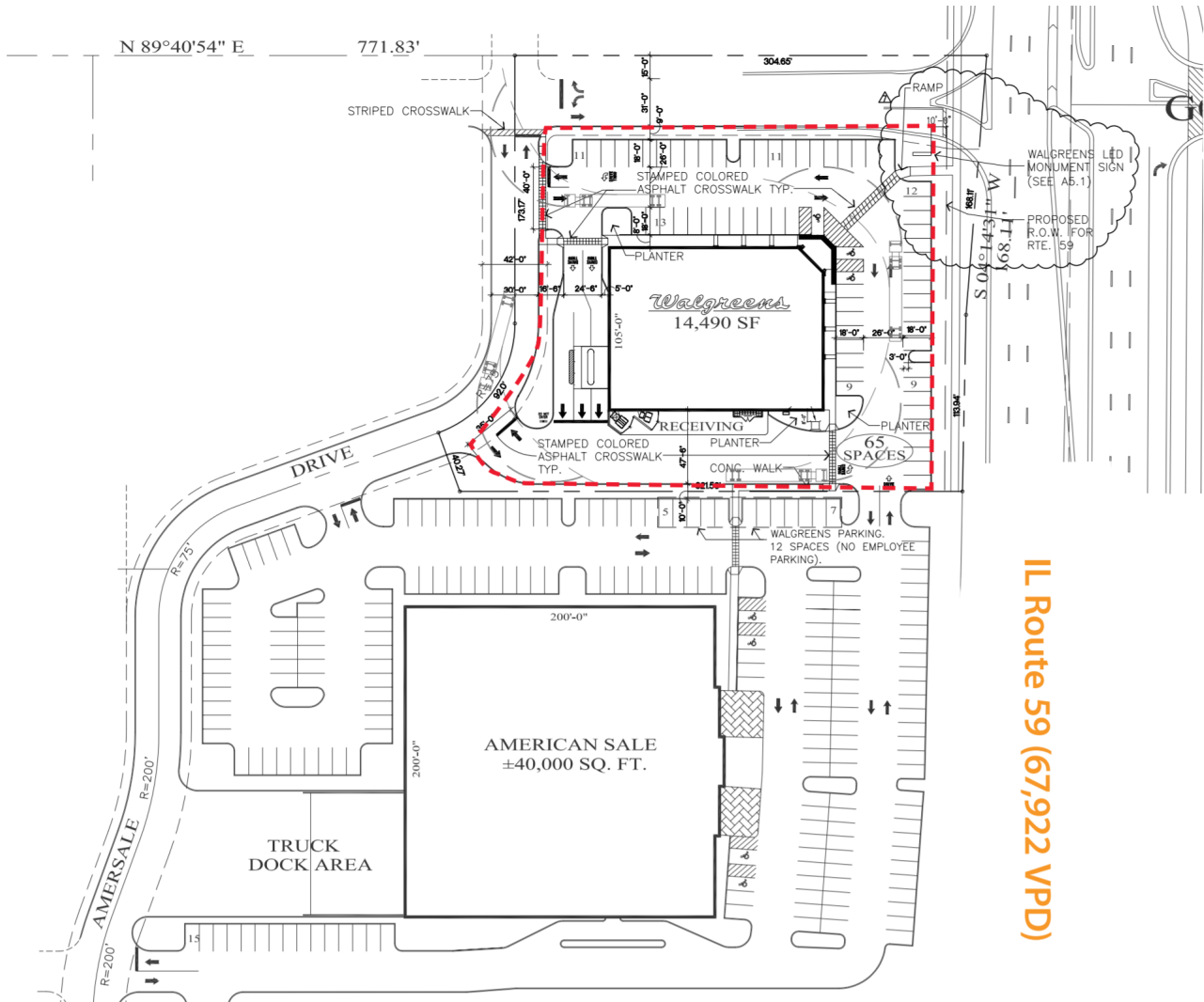

IL Route 59 (67,922 VPD)

DISCLAIMER

© 2018 Jones Lang LaSalle IP, Inc. All rights reserved. All information contained herein is from sources deemed reliable; however, no representation or warranty is made to the accuracy thereof.

