



For Lease

Prime Federal Hill office space for lease

Highlights

- 41,100 contiguous square feet available immediately
- Free parking
- Easy access to I-95, 295, The Baltimore Beltway, Port Covington, Federal Hill and The Inner Harbor
- Proximate to multiple amenities and restaurants (including Hersh's, Minnow, Homeslyce, Rye Street Tavern, Nick's Fishhouse, Sobo Market, Iron Rooster, Baba's Mediterranean Kitchen, Chipotle, Starbuck's, Rowhouse Grille and more.)
- High ceilings
- Exposed brick

**1800 Johnson Street
Baltimore, MD 21230**

Tony Gross

Senior Vice President

+1 443 931 3333

tony.gross@am.jll.com

Peter Jackson

Associate

+1 443 931 3329

peterm.jackson@am.jll.com

3rd Floor plan

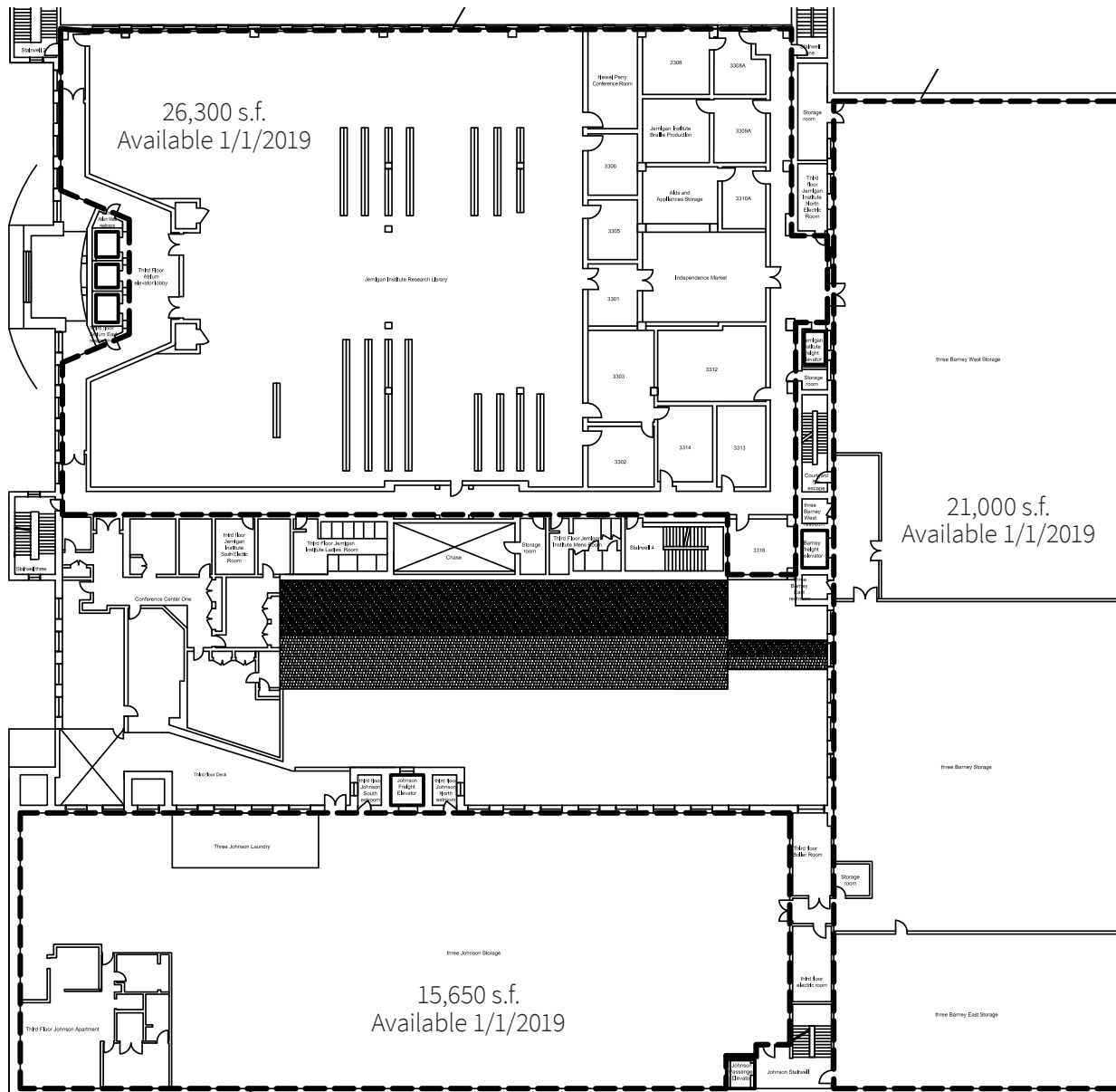

Map

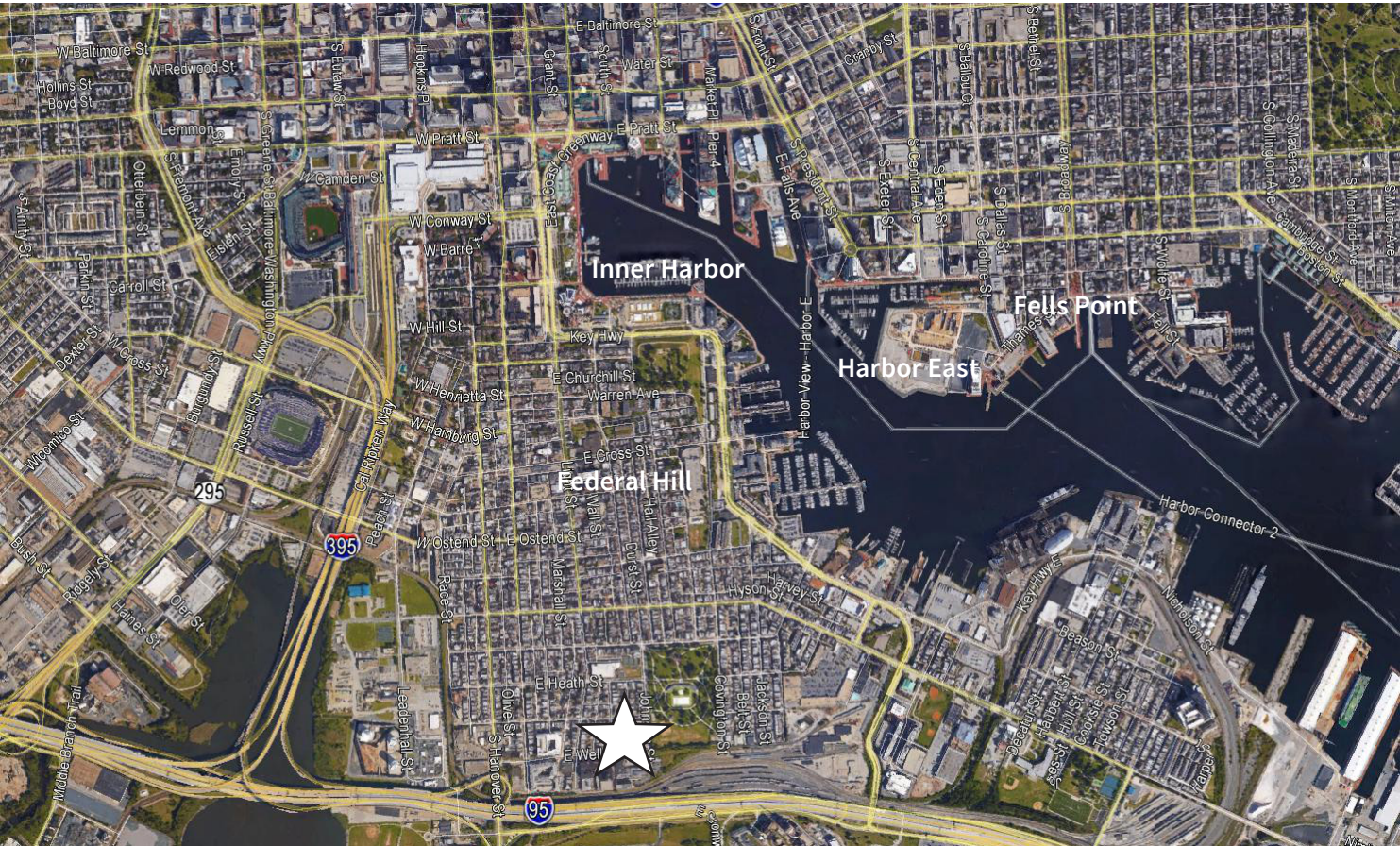

Building exterior



Although information has been obtained from sources deemed reliable, Owner, Jones Lang LaSalle, and/or their representatives, brokers or agents make no guarantees as to the accuracy of the information contained herein, and offer the Property without express or implied warranties of any kind. The Property may be withdrawn without notice. If the recipient of this information has signed a confidentiality agreement regarding this matter, this information is subject to the terms of that agreement. ©2017. Jones Lang LaSalle. All rights reserved.