

100
MONTGOMERY

RETAIL FOR LEASE: 505 - 1,350 SF

Authentic. Timeless. Classic.

Best in Class.

Known as the Equitable Life Building, 100 Montgomery is 354 feet tall with 25 floors situated in the financial district at Montgomery Street and Sutter Street. Built in 1955, the property is distinguished by classic white marble against an aluminum art deco window framing.



Highlights

- Space available - 505 - 1,350 SF
- Option to combine multiple spaces
- Best in market pedestrian counts within the financial district
- Excellent space volume and ceiling height
- Clean, modern storefront design
- Vibrant signage and branding presentation to street
- One block from Montgomery Street BART station with second highest station use rates in system
- Walking distance to Market St

Neighborhood

- Hotel 4,756 Proximate Rooms
- Office +/- 12MM SF of Class A Office
- Employee +/- 85,000 Daytime Employees
- BART +/-41,940 people exit per day
- Ferry +/- 10,000 rides per day

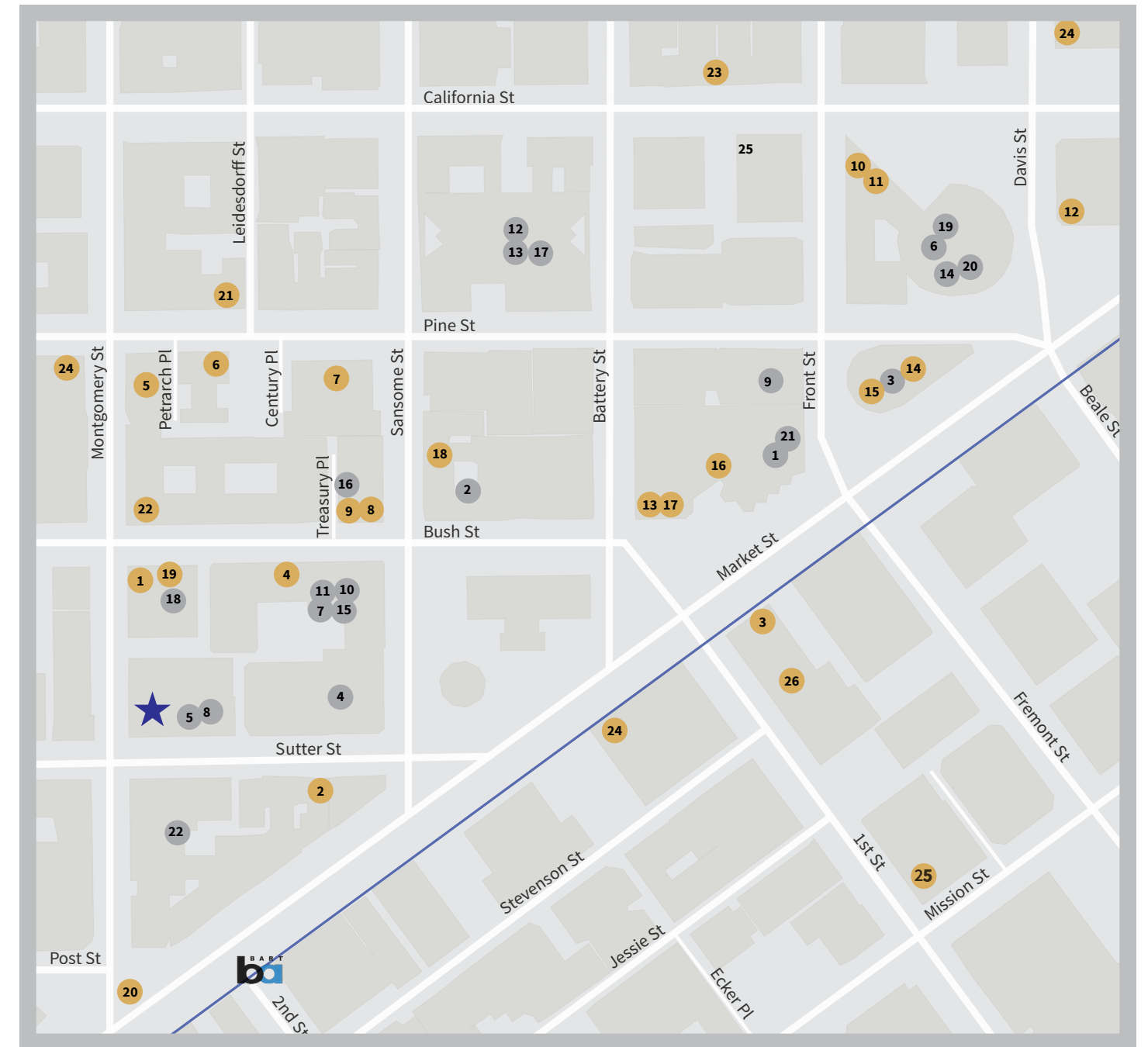

OFFICE

- 1 First Republic Bank
- 2 Expedia/Hotwire
- 3 First Republic Bank
- 4 ContextLogic (Wish)
- 5 Next15
- 6 Winston & Strawn
- 7 Lithium Technologies
- 8 Solution Set
- 9 First Republic Bank
- 10 Blue Shield of California
- 11 Benefit Cosmetics
- 12 Marsh USA (Mercer)
- 13 Texas Pacific Group

- 14 Cooley LLP
- 15 Design Within Reach
- 16 Pacific Exchange Inc.
- 17 Piper Jaffray
- 18 Bank of the West
- 19 Merrill Lynch
- 20 Sapient Computers
- 21 Covington & Burling
- 22 WeWork

RETAIL

- 1 Workshop Cafe
- 2 Per Diem
- 3 Starbucks
- 4 Target
- 5 Flagship Crossfit
- 6 Juice Shop
- 7 Equinox Pine St
- 8 Blue Bottle Coffee
- 9 The Treasury
- 10 Pabu Izakaya
- 11 The Ramen Bar
- 12 eatsa
- 13 Peet's Coffee

- 14 Sushirrito
- 15 Subway
- 16 Philz Coffee
- 17 Jamba Juice
- 18 Mixt
- 19 Coffee Cultures
- 20 Dosa Brothers
- 21 Credo
- 22 illy caffe
- 23 Tadich
- 24 Joe and the Juice
- 25 Oasis Grill
- 26 Focaccia Market Bakery

Site Plan (Option 1)

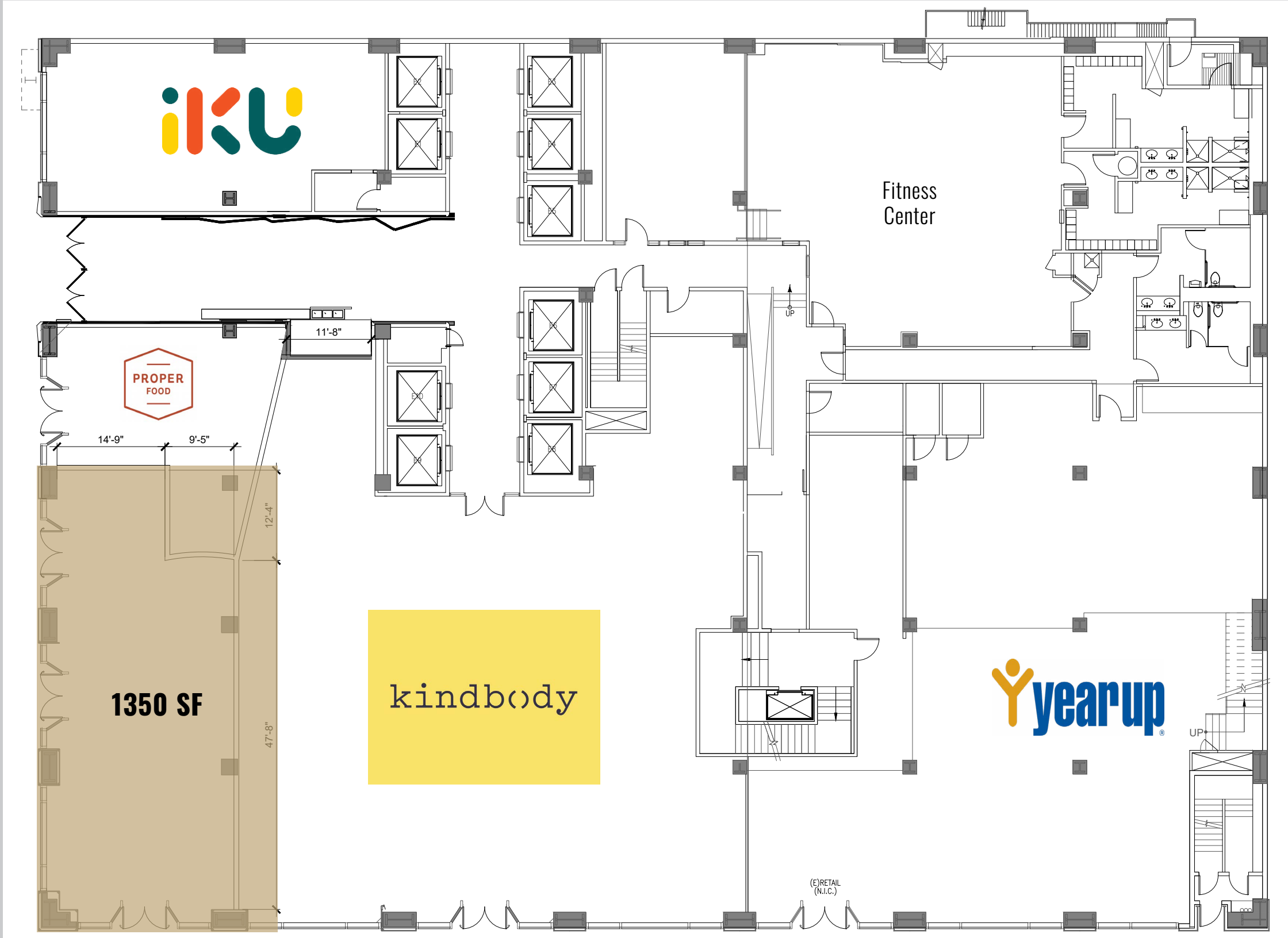

Site Plan (Option 2)

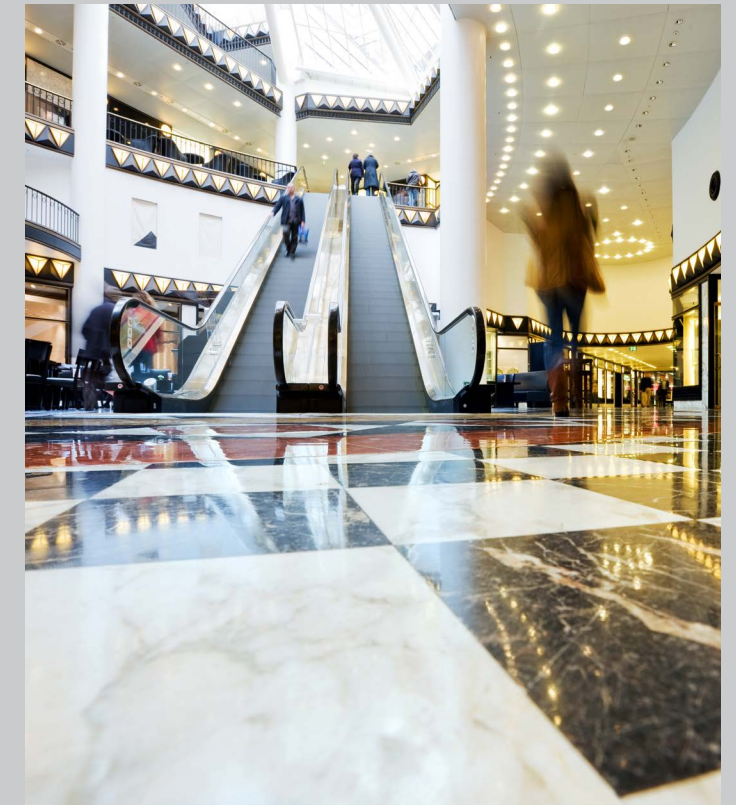
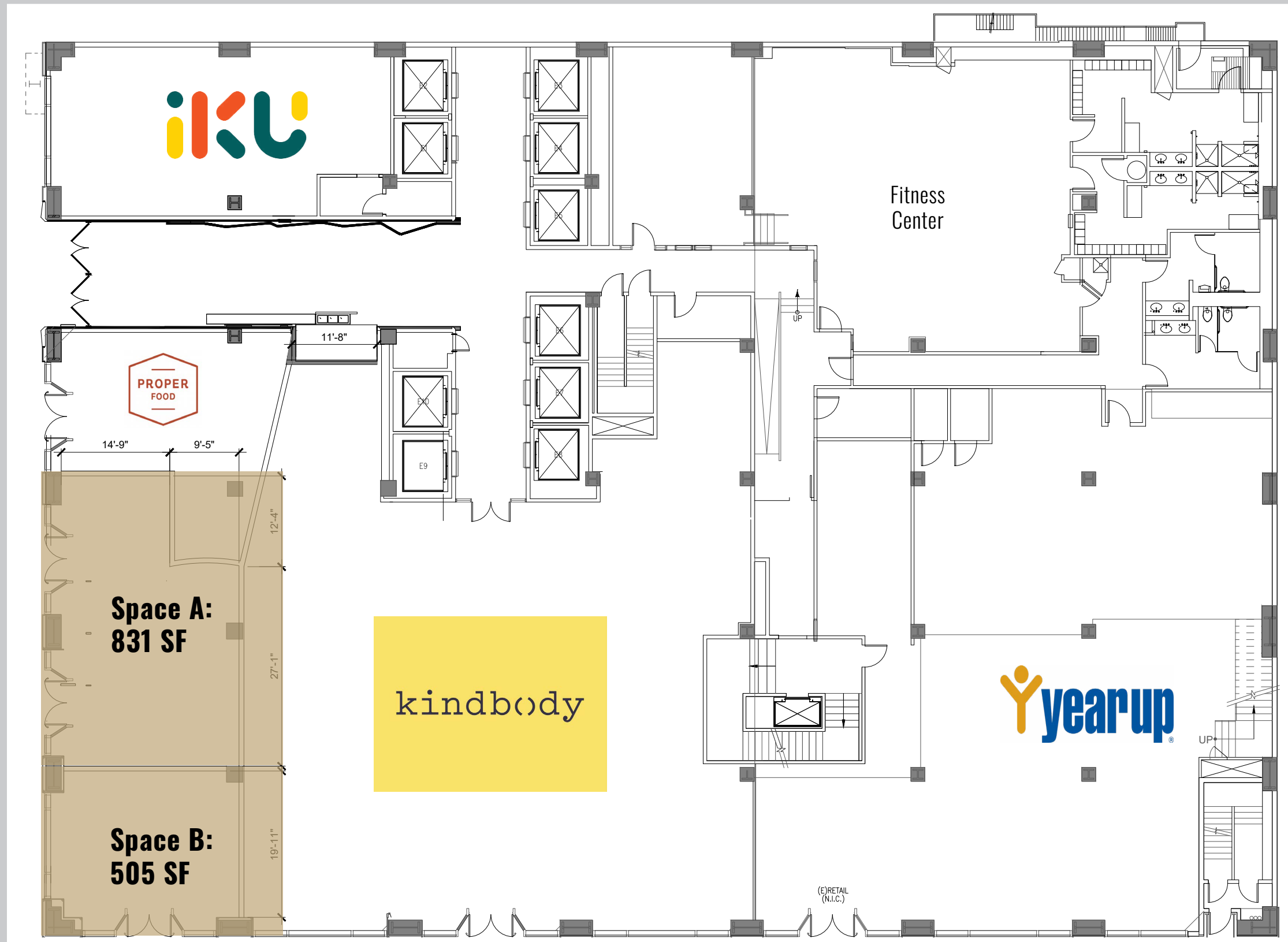



Ben Lazzareschi
Managing Director
JLL Retail Brokerage Services
+1 415 228 3070
ben.lazzareschi@am.jll.com
RE Lic # 01414579

David Kessler
Associate
JLL Retail Brokerage Services
+1 925 478 0386
david.kessler@am.jll.com
RE Lic # 02112097

Justin Choi
Associate
JLL Retail Brokerage Services
+1 925 858 6041
justin.choi@am.jll.com
RE Lic # 02107928

