

# 1401 K STREET NW

Washington, DC



For more information,  
please contact:

Andy Corno  
+1 202 719 6137  
andy.corno@jll.com

Thomas Jackman  
+1 202 719 5624  
thomas.jackman@jll.com

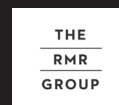

# RETAIL SPACE FOR LEASE

- ◇ 10,297 SF (5,024 SF ground floor / 5,273 SF on lower level)
  - ◇ High profile hard corner with venting
- ◇ 943 SF cafe space
  - ◇ Inline space directly to right of lobby entrance along 14th St.
- ◇ 2,058 SF lower level space
  - ◇ With street access
- ◇ Bustling 14th and K Streets intersection, with clear visibility from Franklin Square
- ◇ 1 block from McPherson Square metro, with an average of 13,889 riders per day

## SURROUNDING RETAIL



## POPULATION

.5 mi

**15,798**

## AVERAGE HH INCOME

.5 mi

**\$128,993**

## HOUSEHOLDS

.5 mi

10,244

## EMPLOYEES

.5 mi

**138,647**



# THE OPPORTUNITY

Entrance  
to Lower  
Level

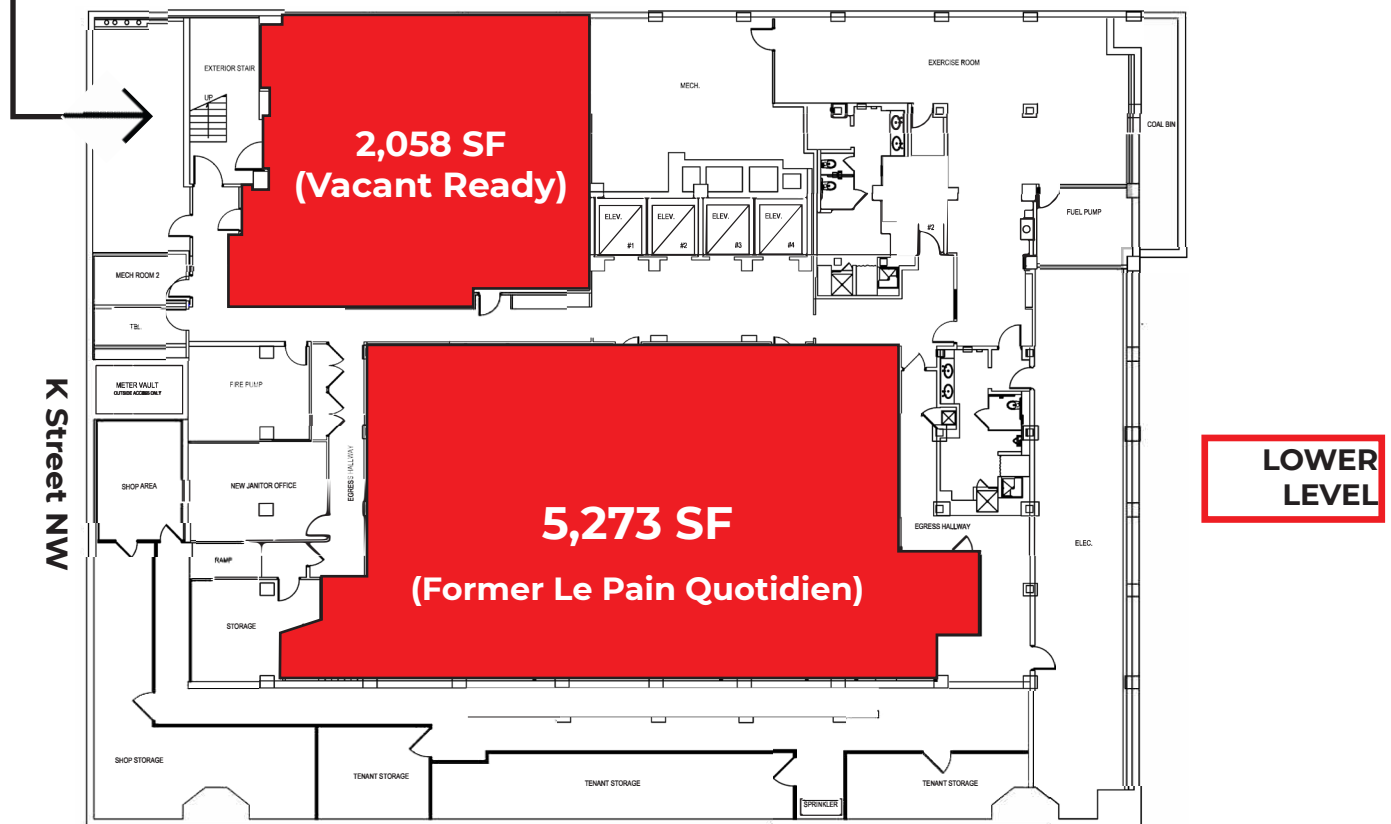
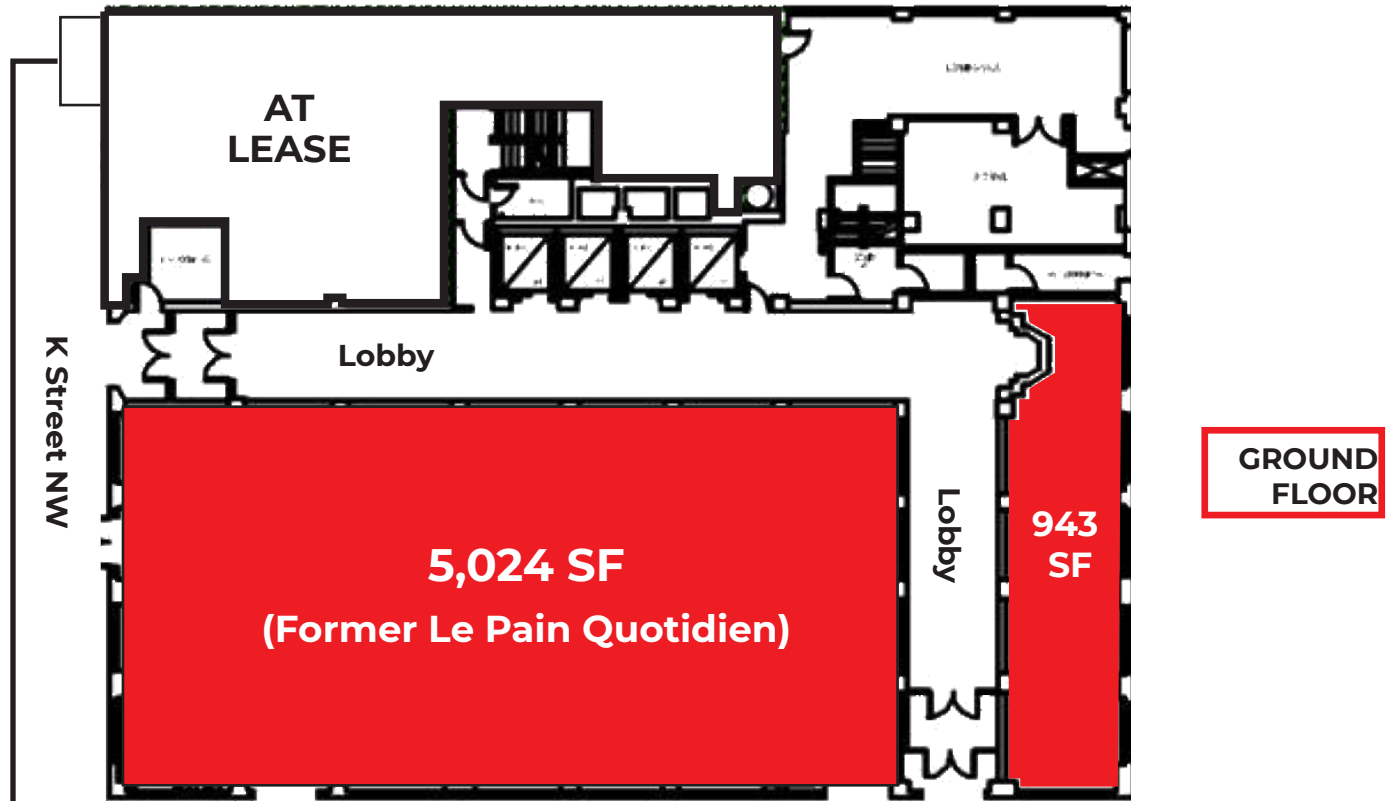



# 1401 K STREET NW

Washington, DC

---

**For more information,  
please contact:**

Andy Corno  
+1 202 719 6137  
[andy.corno@jll.com](mailto:andy.corno@jll.com)

Thomas Jackman  
+1 202 719 5624  
[thomas.jackman@jll.com](mailto:thomas.jackman@jll.com)

THE  
RMR  
GROUP

