

TRACE

RETAIL SPACE AVAILABLE NOW

Auspicious Peachtree Street in the Heart of Midtown



782 PEACHTREE STREET NE ATLANTA

WORLD TOP M

4,000+ HOTEL ROOMS

150+ RESTAURANTS & SHOPPING EXPERIENCES

70,000 DAYTIME WORKER POPULATION

6.1 M ANNUAL VISITORS

4 TOP RANKED INSTITUTIONS IN CLOSE PROXIMITY: Georgia Tech, Emory, SCAD, and Georgia State University

11+ SIGNATURE EVENTS ANNUALLY, DRAWING 1.2 MILLION PARTICIPANTS



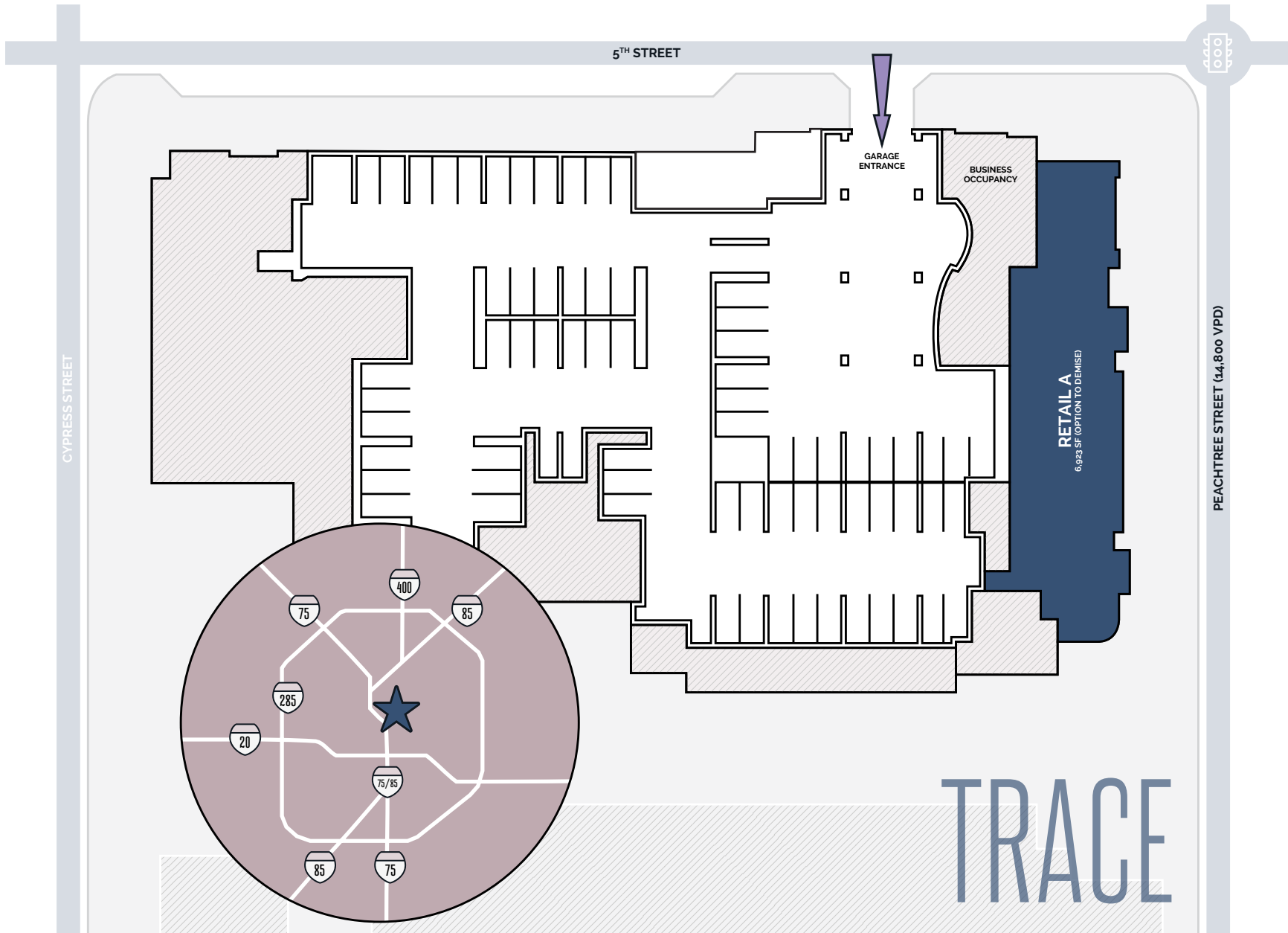

5TH STREET

CYPRESS STREET

444
000
100

GARAGE
ENTRANCE

BUSINESS
OCCUPANCY

RETAILA
6,923 SF (OPTION TO DEMISE)

PEACHTREE STREET (14,800 VPD)

TRACE

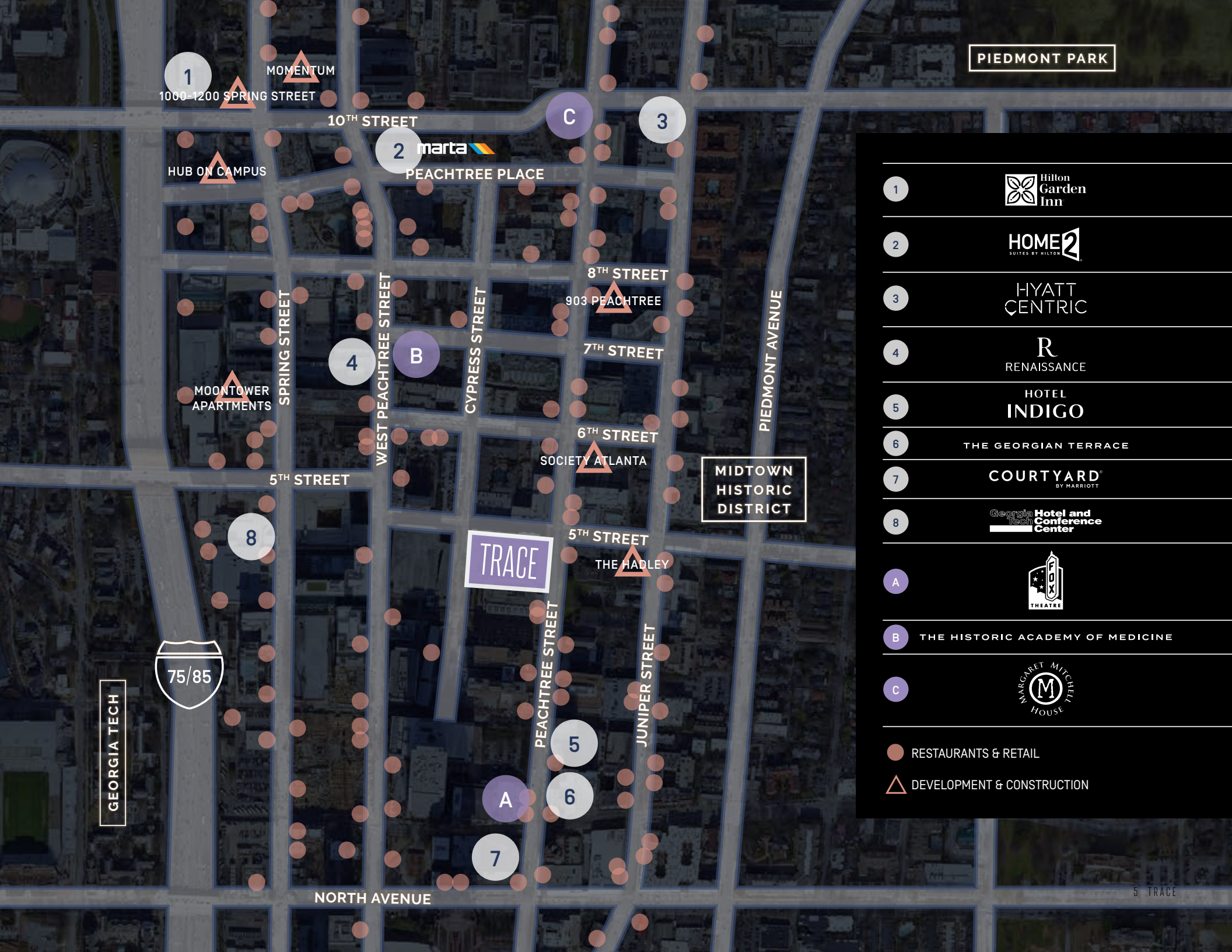

PIEDMONT PARK

1
1000-1200 SPRING STREET

MOMENTUM

10TH STREET

C

3

HUB ON CAMPUS

2 **marta**

PEACHTREE PLACE

8TH STREET

903 PEACHTREE

7TH STREET

4

B

SPRING STREET

WEST PEACHTREE STREET

CYPRESS STREET

PIEDMONT AVENUE

MOONTOWER APARTMENTS

6TH STREET

SOCIETY ATLANTA

MIDTOWN HISTORIC DISTRICT

5TH STREET

5TH STREET

TRACE

THE HADLEY

8

75/85

GEORGIA TECH

PEACHTREE STREET

JUNIPER STREET

5

A

6

7

NORTH AVENUE



THE GEORGIAN TERRACE



THE HISTORIC ACADEMY OF MEDICINE



1

2

3

4

5

6

7

8

A

B

C

● RESTAURANTS & RETAIL

▲ DEVELOPMENT & CONSTRUCTION



290 UNITS OF RESIDENTIAL

8,000+ SQUARE FEET OF RETAIL OPPORTUNITY

4 LEVELS OF PARKING

TRACE is just steps away from the **GEORGIA TECH** campus and located directly on iconic **PEACHTREE STREET** in the heart of **MIDTOWN**, this multifamily and retail building provides access to historic **PIEDMONT PARK** which boasts 128 acres of green space for the urbanized neighborhood. This community invites young professionals and students the opportunity for intown living with green space and density at their back door.



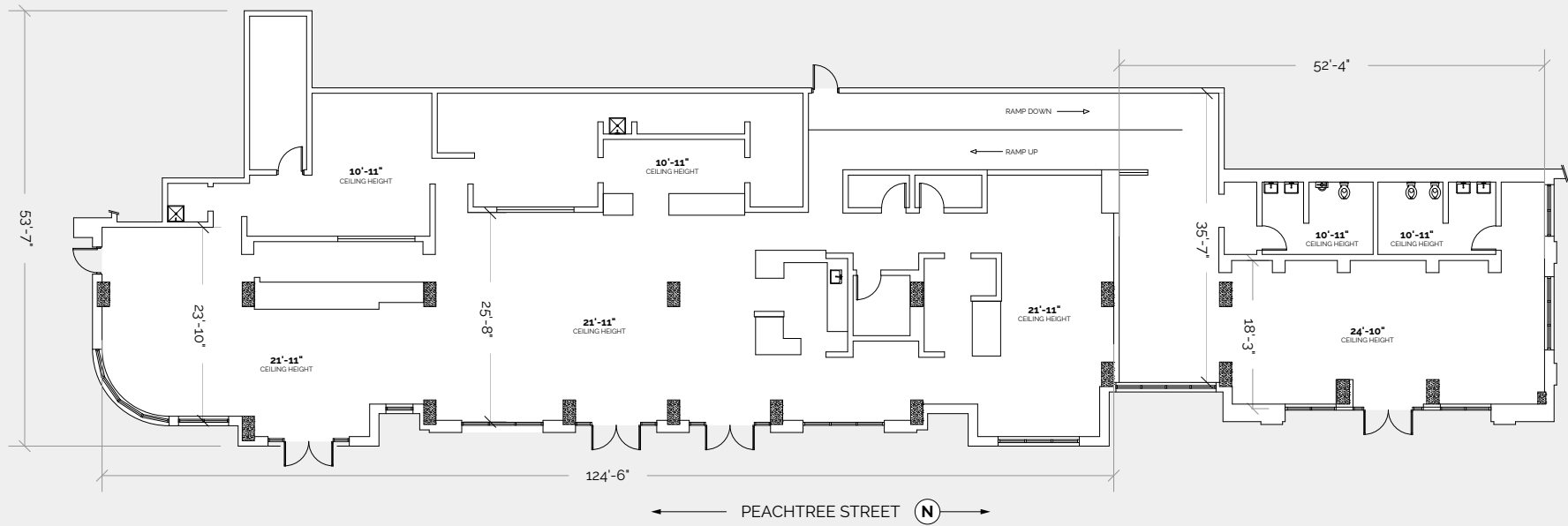

 GO TO VIRTUAL TOUR

RETAIL A

ANSI/BOMA Z65.5-202 Retail Standard GLA = 6,923 SF with option to demise



For more information, please contact:

Coleman Morris

Coleman.Morris@am.jll.com

404-995-2409

Iggy de Quesada

678-516-2096

us.jll.com

©2019 Jones Lang LaSalle IP, Inc. All rights reserved. All information contained herein is from sources deemed reliable; however, no representation or warranty is made to the accuracy thereof.