



## The shortest path to work.

Brought to you by Bridge Commercial Real Estate, **Abridge provides highly curated, flexible-term office space.** Get to work more quickly and efficiently without sacrificing the quality of brand or workspace.

# ABRIDGE

Private bespoke suites surround a shared common hub offering robust features including:



Contemporary Ergonomic Furniture



High-Speed Secure IT



Premium Beverage Offerings



Regular Cleaning Service



Access Control To Your Space



Multiple Conferencing Rooms



Common Area Lounge/ Breakroom



Ability to Brand Your Space



Brokers Protected



Immediate Occupancy

**ABRIDGE AMENITIES**

- Dedicated on-floor AV / IT enabled meeting and conference space
- High-speed internet access with dedicated bandwidth and robust security options available
- Office lounge and kitchen area
- Premium beverage offerings including local coffees, tea and water service
- Cleaning services in both common areas and private suites

**TOWER 1320 AMENITIES**

- Tenant training center seating up to 51 people
- Fitness center complete with lockers and showers
- Direct access to SH 114 with exceptional convenience to SH 161 and 1635
- 10 minutes east of DFW Airport
- Within five minutes of Irving Convention Center, over 160 restaurants and retailers, two DART light-rail stations

**BESPOKE SUITES AVAILABLE FOR COMPANIES FROM 23 TO 185 PEOPLE**

**ABRIDGE @ TOWER 1320**

<b>Suite A</b>	42 desks + 4 offices
<b>Suite B</b>	24 desks + 4 offices
<b>Suite C</b>	22 desks + 4 offices
<b>Suite D</b>	28 desks + 3 offices
<b>Suite E</b>	20 desks + 3 offices
<b>Suite F</b>	28 desks + 3 offices

Ready to **ABRIDGE.**

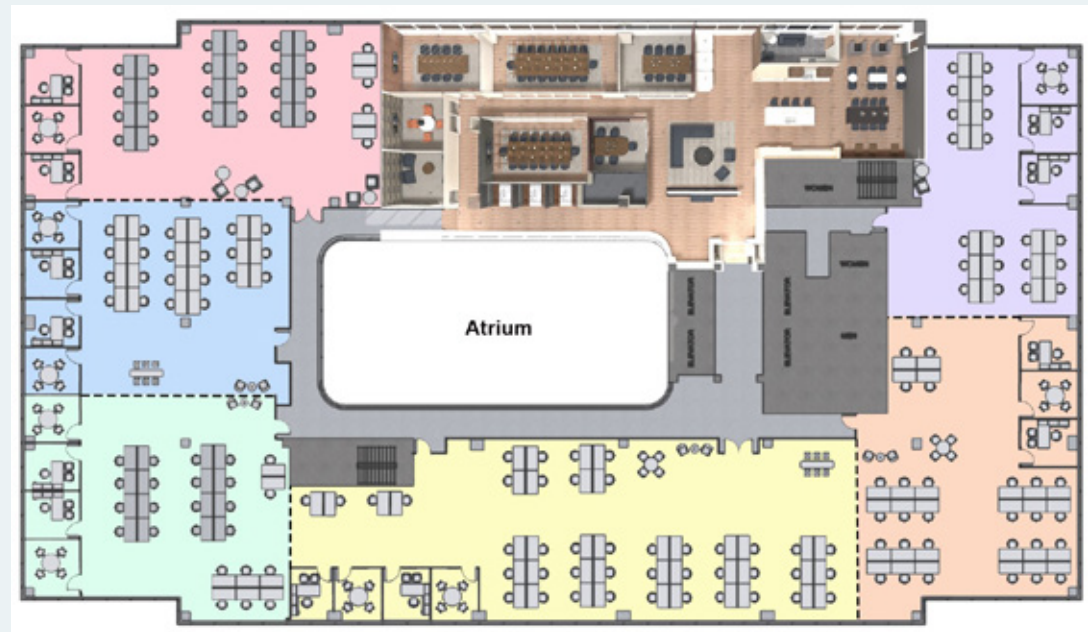

*Abridge space options shown can be combined to meet your individual requirements*

**FOR LEASING INFORMATION, PLEASE CONTACT:**

Jeff Wood | [jeff.wood@am.jll.com](mailto:jeff.wood@am.jll.com) | 214.438.3959

**TOWER 1320**

1320 Greenway Drive  
 Irving, Texas 75038  
[tower1320.com](http://tower1320.com)

**ABRIDGE**