



For Lease

Grand Stable & Carriage Building | 421 SW 2nd Ave, Portland, OR

- 4,776 RSF open creative office/showroom
- \$22.50 FSG
- Showers & bike parking
- High & exposed ceilings
- Exposed brick & beam with skylights
- Close to amenities, restaurants, food carts & transit
- Additional office/showroom space in the basement of up to 5,000 RSF
- Storage opportunities available

Eric Haskins

Licensed in OR

+1 503 972 8611

eric.haskins@am.jll.com

Alec Torkelson

Licensed in OR & WA

+1 503 937 2106

alec.torkelson@am.jll.com

Jones Lang LaSalle Brokerage, Inc.



First Floor

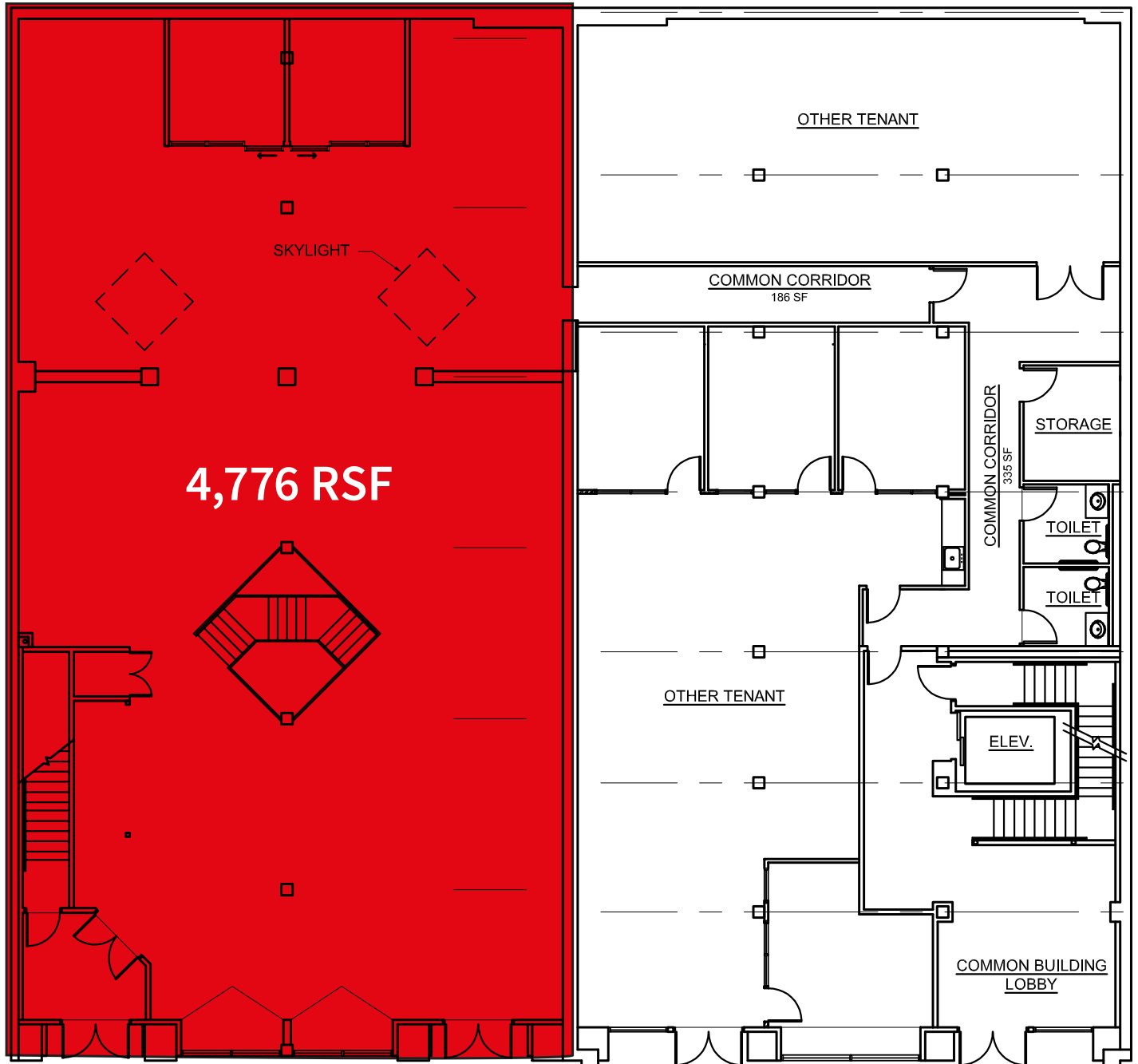

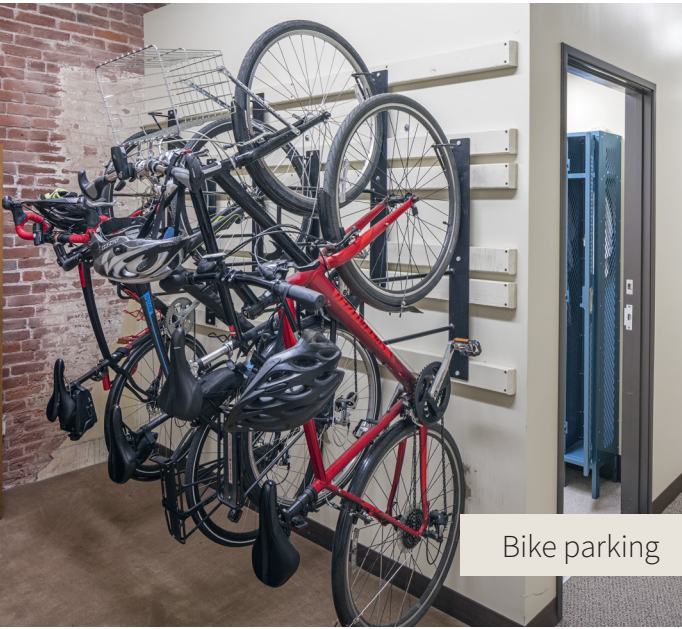

Bike parking



Open office with direct access to basement space

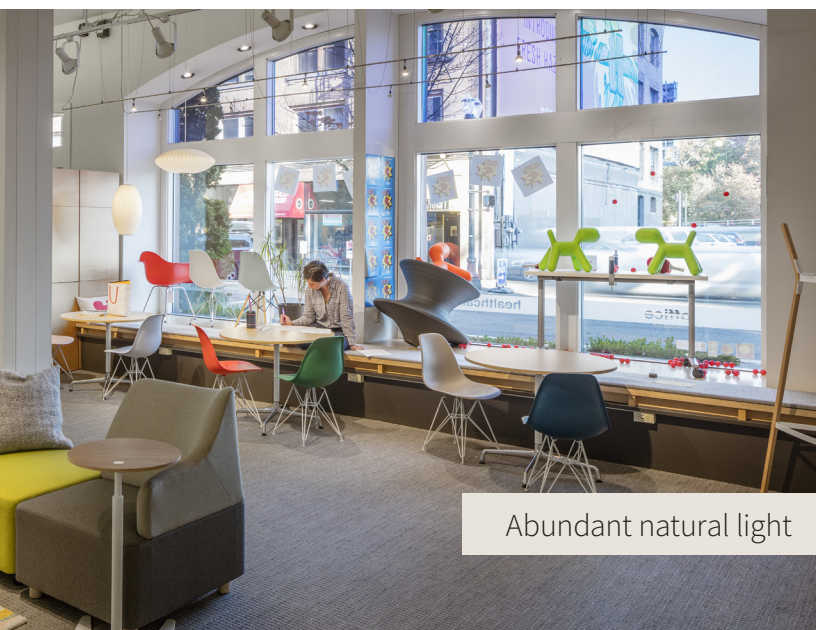

Abundant natural light



Conference room

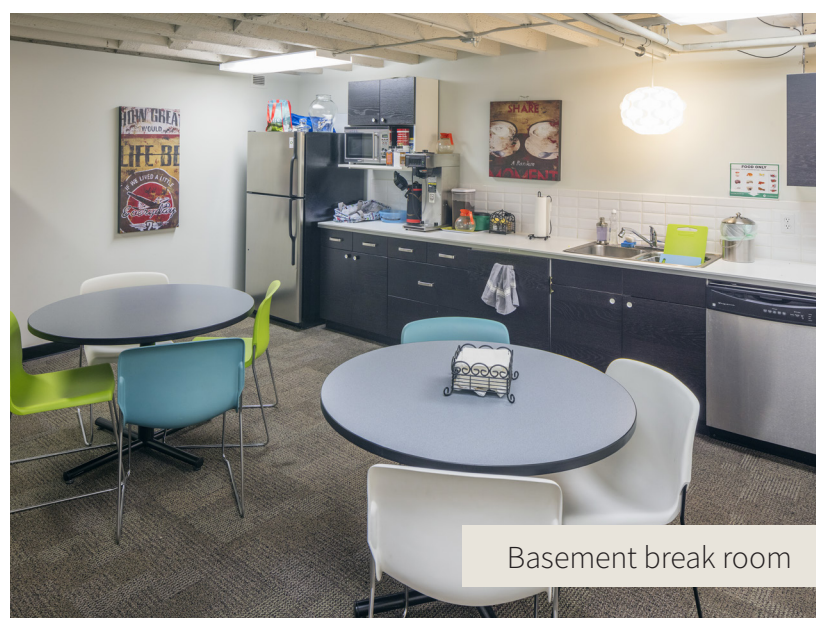

Basement break room

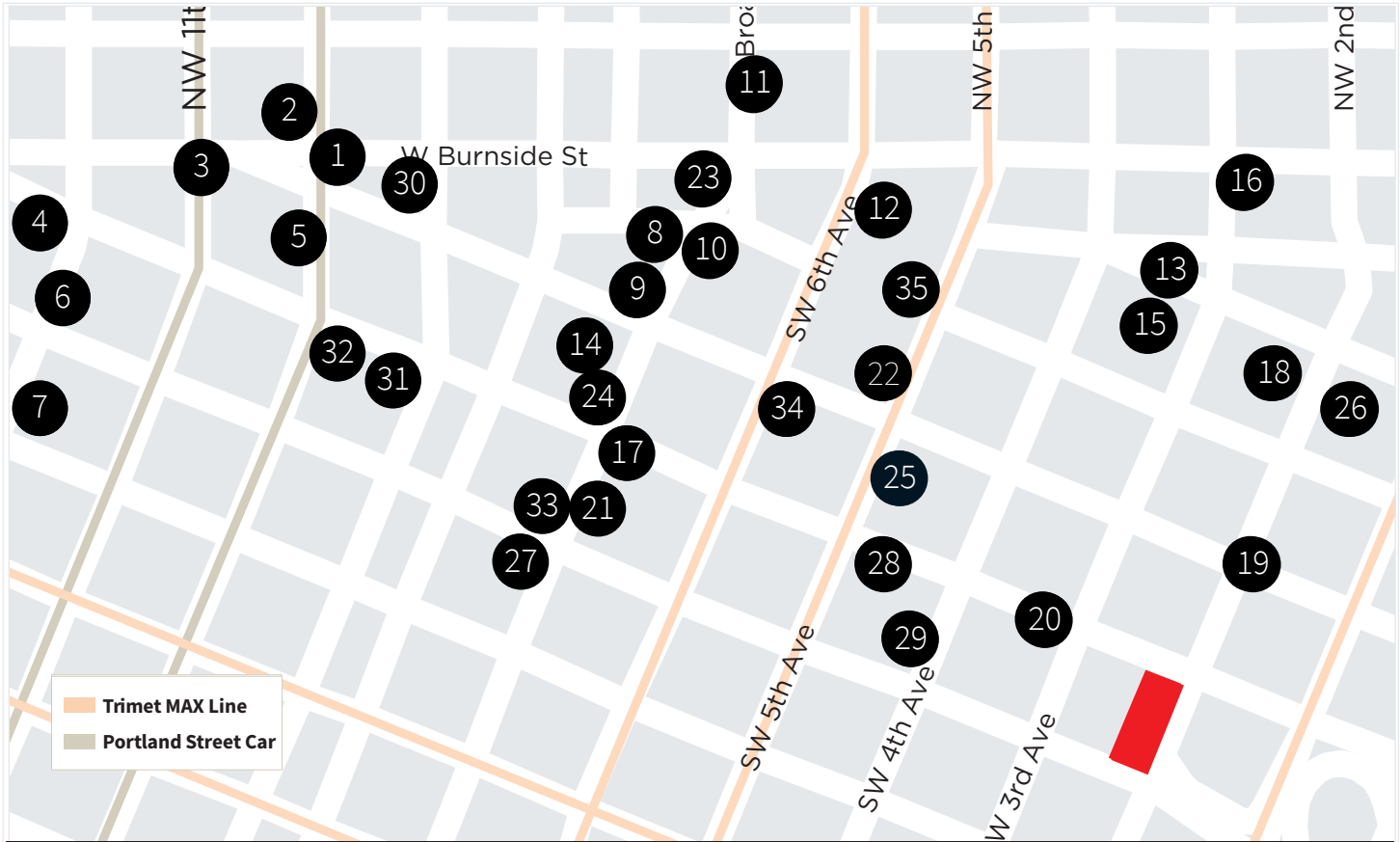

Nearby amenities

- | | | | |
|---------------------------|-------------------------|---------------------------|----------------------------------|
| 1. Sizzle Pie | 10. Saucebox | 19. Portland Burger | 28. Sushi Sakura |
| 2. Powell's City of Books | 11. Sushi Ichiban | 20. Huber's Cafe | 29. Red Star Tavern |
| 3. Buffalo Exchange | 12. Portland City Grill | 21. Imperial | 30. Thai Peacock |
| 4. Jake's Crawfish | 13. Mother's Bistro | 22. Starbucks | 31. Pepe Le Moko |
| 5. Living Room Theater | 14. The Benson | 23. The Alchemist Cantina | 32. Stumptown Coffee |
| 6. Cheryl's on 12th | 15. Embassy Suites | 24. El Gaucho | 33. Portland Marriot City Center |
| 7. Tasty N' Alder | 16. Voodoo Doughnuts | 25. 5th Ave Foot Cart Pod | 34. The Original Dinerant |
| 8. Bailey's Taproom | 17. Hotel Lucia | 26. Pine Street Market | 35. US Bank Tower Food Court |
| 9. The Independent | 18. E-San Thai | 27. St. Honore Bakery | |



For leasing information:

ERIC HASKINS

Licensed in OR
+1 503 972 8611

eric.haskins@am.jll.com

ALEC TORKELSON

Licensed in OR
+1 503 937 2106

alec.torkelson@am.jll.com

Jones Lang LaSalle Brokerage, Inc.
1120 NW Couch Street, Suite 500, Portland, OR 97209
www.jll.com