



For Lease

Rare retail and office space available

- 1st floor: 841 s.f. retail space
- 5th floor: 2,236 s.f. office space
- Newly renovated, granite-faced lobby and completely new elevators
- Easy access to Septa Regional Rail
- Abundant parking within 1/2 block
- Steps from the Fashion Outlets of Philadelphia
- Exceptional location: only two blocks from Route 676 and I-95

801 Arch Street Philadelphia, PA

Joshua Sloan

+1 215 988 5554

joshua.sloan@am.jll.com

David Healy

+1 215 988 5555

david.healy@am.jll.com

Alex Breitmayer

+1 215 399 1813

alex.breitmayer@am.jll.com



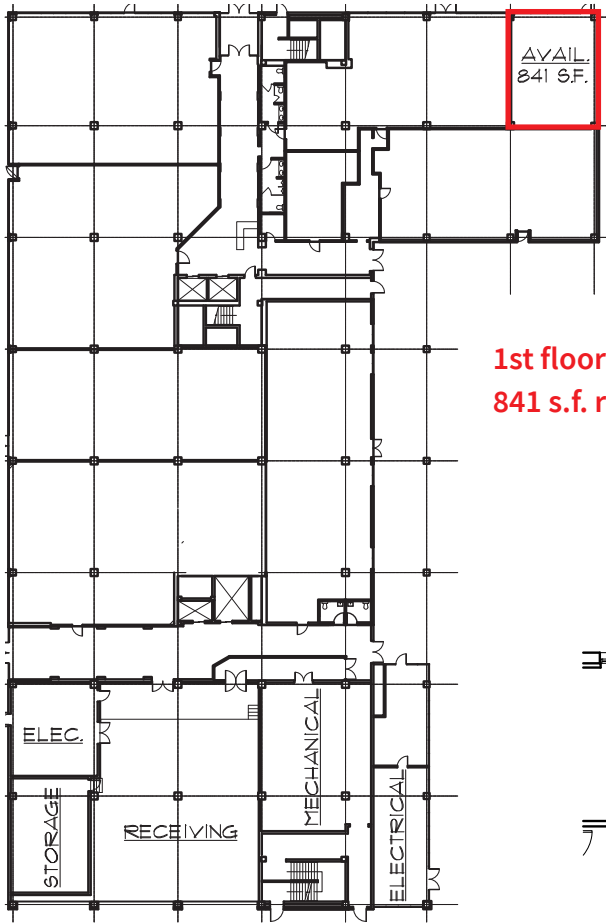

**1st floor plan:
841 s.f. retail**

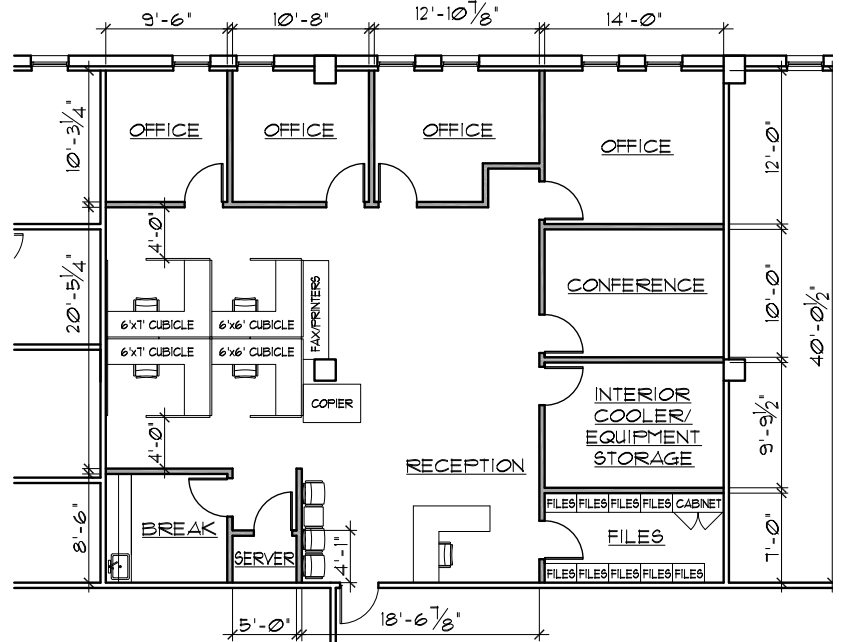

**5th floor plan:
2,236 s.f. office space**

801 Arch Street Philadelphia, PA

JLL | Jones Lang LaSalle Brokerage, Inc.
1650 Arch Street, Suite 2500
Philadelphia, PA 19103
+1 215 988 5500 | jll.com/philadelphia

DISCLAIMER

Although information has been obtained from sources deemed reliable, neither Owner nor JLL makes any guarantees, warranties or representations, express or implied, as to the completeness or accuracy as to the information contained herein. Any projections, opinions, assumptions or estimates used are for example only. There may be differences between projected and actual results, and those differences may be material. The Property may be withdrawn without notice. Neither Owner nor JLL accepts any liability for any loss or damage suffered by any party resulting from reliance on this information. If the recipient of this information has signed a confidentiality agreement regarding this matter, this information is subject to the terms of that agreement. ©2021. Jones Lang LaSalle IP, Inc. All rights reserved.

