

1 Remsen Avenue

Brooklyn, New York



SIZE

Ground: 7,793 sf

ASKING RENT

\$150,000 PA gross

POSSESSION

Immediate

TERM

Through 1/31/2022

FORMER DUANE READE STORE #14305

NEIGHBORS



Demographics

Radius	'19 Pop	Total HH	Avg. HHI
.25 Mile	12,467	4,750	\$55,165
.5 Mile	48,241	17,370	\$59,731
1 Mile	180,295	64,778	\$59,276

1 Remsen Avenue

Brooklyn, New York

MAP

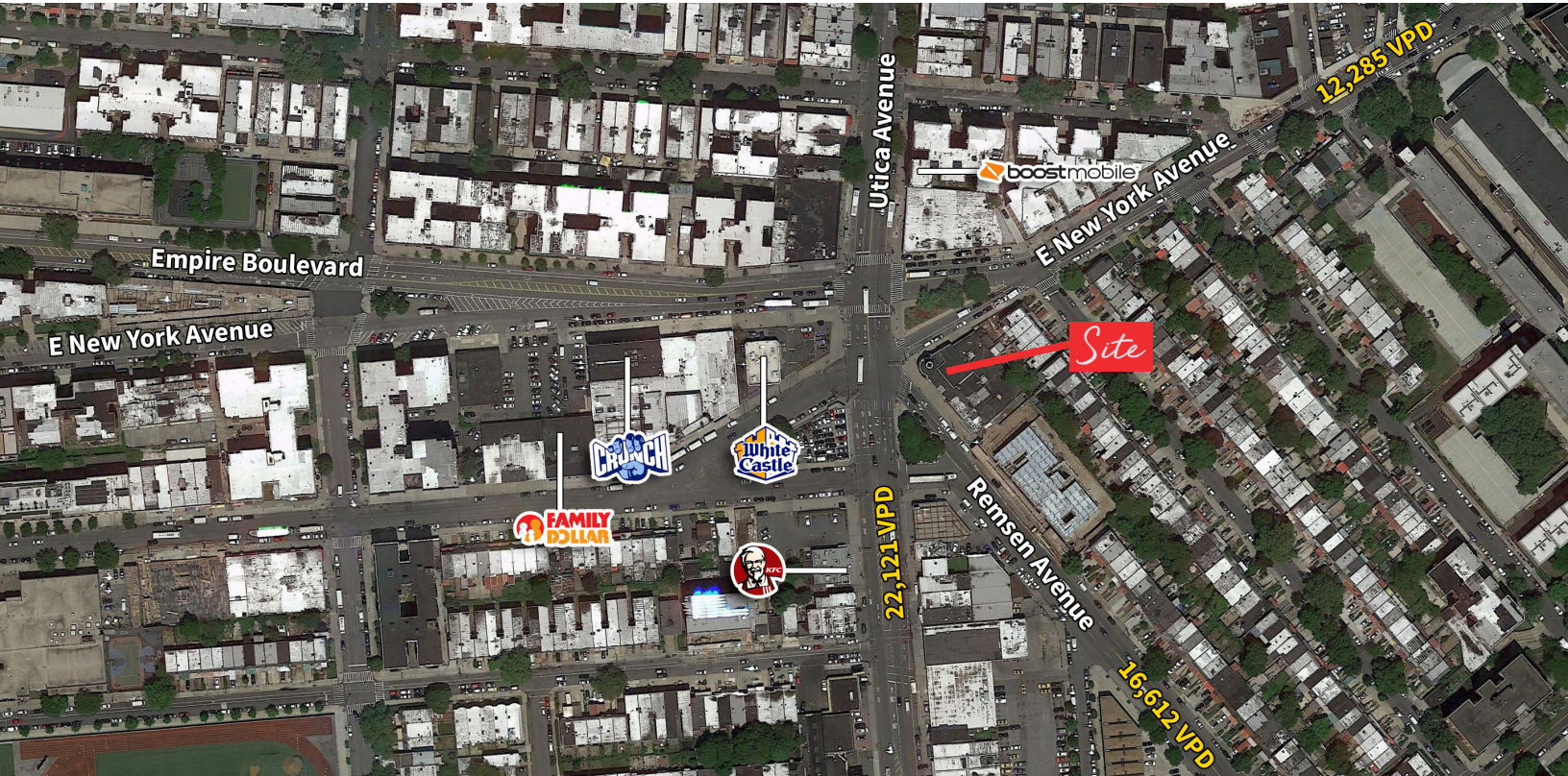

FLOOR PLAN

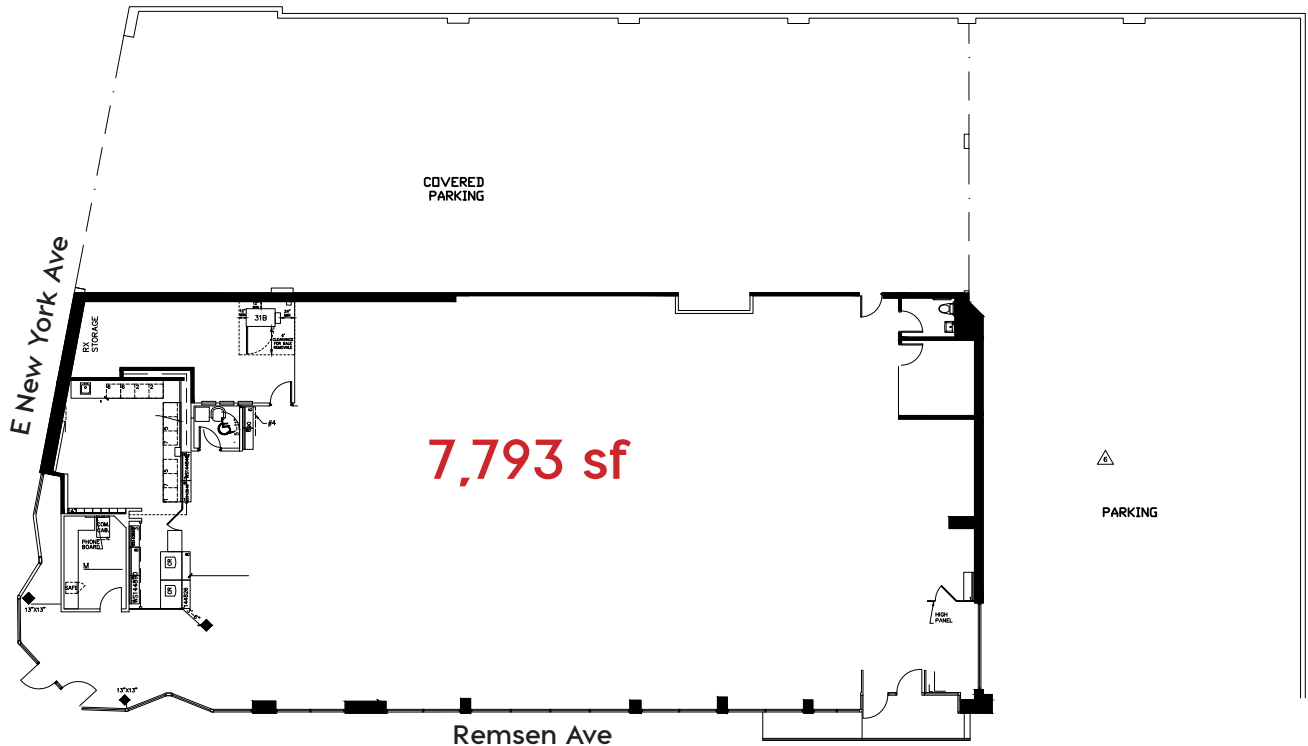

Jones Lang LaSalle Brokerage, Inc. | 330 Madison Avenue New York, NY 10017
DISCLAIMER
Although information has been obtained from sources deemed reliable, neither Owner nor JLL makes any guarantees, warranties or representations, express or implied, as to the completeness or accuracy as to the information contained herein. Any projections, opinions, assumptions or estimates used are for example only. There may be differences between projected and actual results, and those differences may be material. The Property may be withdrawn without notice. Neither Owner nor JLL accepts any liability for any loss or damage suffered by any party resulting from reliance on this information. If the recipient of this information has signed a confidentiality agreement regarding this matter, this information is subject to the terms of that agreement. ©2018 Jones Lang LaSalle IP, Inc. All rights reserved.

Michael Riley
212 812 5901
michael.riley@am.jll.com

Patrick A. Smith
212 812 5888
patricka.smith@am.jll.com