

D
DOMINION
TOWERS



600 17TH STREET | DENVER, CO



DOMINION TOWERS

Dominion Towers is a distinctive 614,000 square foot office property comprised of two octagonal shaped towers with impressive views of the 17th Street corridor, the 16th Street Mall and the spectacular Rocky Mountains. Centrally located at 17th and Welton Street in downtown Denver, Dominion Towers is within a short walking distance to numerous shops, restaurants and entertainment options on the 16th Street Mall.

FACTS AND FIGURES



Class A Office



614,000 SF

14,000-
28,000

Typical Floor
Size (SF)

1:2,000
RSF

Parking / 275 In-
Building Spaces



Built in 1982



24/7 On-site
Security



South Tower
28 Floors



North Tower
19 Floors

LEED GOLD

Dominion Towers is committed to sustainability and has implemented numerous conservation programs and green initiatives in order to reduce the building's impact on the environment.

Built your way

With floorplates ranging from 14,000 - 28,000 RSF, you'll have the flexibility to make Dominion Towers your own.

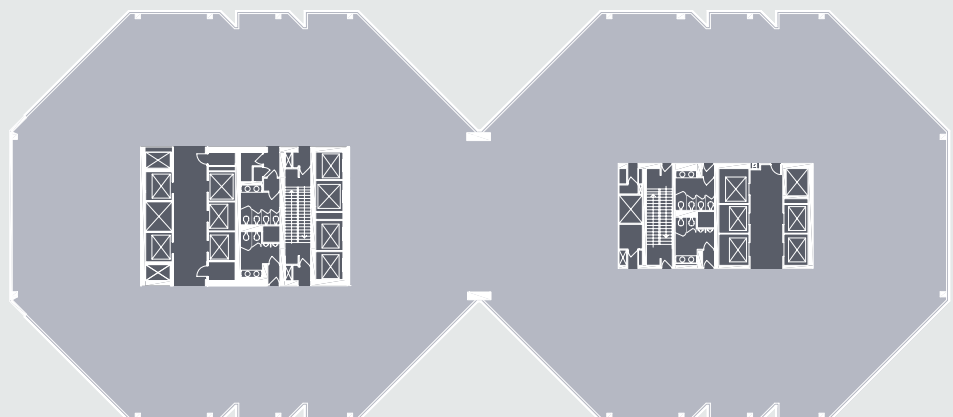

A FOCUS ON YOUR TALENT

Discover the Dominion difference



Amenities

- D SkyDeck lounge
- D Training/conference facilities with Wi-Fi/kitchenette
- D Modern fitness center with locker rooms and showers
- D Jewel box board room with video conferencing/Wi-Fi/catering kitchen lobby lounge
- D Ground floor deli
- D 2 secure bicycle storage rooms
- D Alleyway at Dominion - outdoor seating and games
- D FedEx/UPS Boxes on lobby level
- D Kombucha, sparkling water and cold-brew coffee on tap
- D Bees at Dominion Towers
- D Amazon lockers (Coming Soon)
- D Wellness room (Coming Soon)

Sustainability

- DD LEED Gold®
- DD ENERGY STAR®
- DD 2 Bicycle storage rooms
- DD Recycling/composting program
- DD Hines GREEN OFFICE program
- DD City of Denver and State of Colorado energy benchmarking
- DD Electronic recycling programs



Technology

- DD Wi-Fi in lobby, boardroom, conference center
- DD Video conferencing in board room
- DD Distributed antennae system (DAS) throughout the building
- DD Building tenant relations app (Coming Soon)
- DD Parking system with carpooling feature, allowing employees to “share” parking

Wellness

- DD Yoga on the SkyDeck
- DD Fitness classes
- DD WELL building health & safety certification (Q3 2022)

OUTDOOR SPACES

Discover the Dominion community



SkyDeck | Alleyway | Picnic Area

Get active at Dominion

- DD Tenant programs and seasonal events
- DD Skydeck with Wi-Fi, picnic areas and lounge seating
- DD Putting green
- DD Lending library
- DD New outdoor breezeway with soft seating and games including ping pong, giant Jenga, ring toss and corn hole





THE COMPELLING OPTION

Kevin Foley

+1 303 542 1550

kevin.p.foley@jll.com

Andy Willson

+1 303 217 7980

andy.willson@jll.com



Hines



Although information has been obtained from sources deemed reliable, neither Owner nor JLL makes any guarantees, warranties or representations, express or implied, as to the completeness or accuracy as to the information contained herein. Any projections, opinions, assumptions or estimates used are for example only. There may be differences between projected and actual results, and those differences may be material. The Property may be withdrawn without notice. Neither Owner nor JLL accepts any liability for any loss or damage suffered by any party resulting from reliance on this information. If the recipient of this information has signed a confidentiality agreement regarding this matter, this information is subject to the terms of that agreement. ©2022. Jones Lang LaSalle IP, Inc. All rights reserved. **The outbreak of the COVID-19 virus (novel coronavirus) since the end of January 2020 has resulted in market uncertainty and volatility. While the economic impact of a contagion disease generally arises from the uncertainty and loss of consumer confidence, its impact on real estate values is unknown at this stage.