



**REINVENTING THE **WORKPLACE.****



**GREATLAND**  
REALTY PARTNERS

**SINGERMAN**  
REAL ESTATE



## AVAILABILITY

**35,000 RSF (Floor 1)**  
LAB/FLEX/GMP  
*Available 5/1/2022*

**BUILDING 04**

**BUILDING 03**

**30,000 RSF (Floor 1)**  
OFFICE  
*Available Immediately*

**30,000 RSF - 100,000 RSF**  
LAB/OFFICE  
*Available Q2 2022*

**BUILDING 01**

**BUILDING 02**

**20,000 - 80,000 RSF**  
LAB/OFFICE  
*Available Q2 2022*

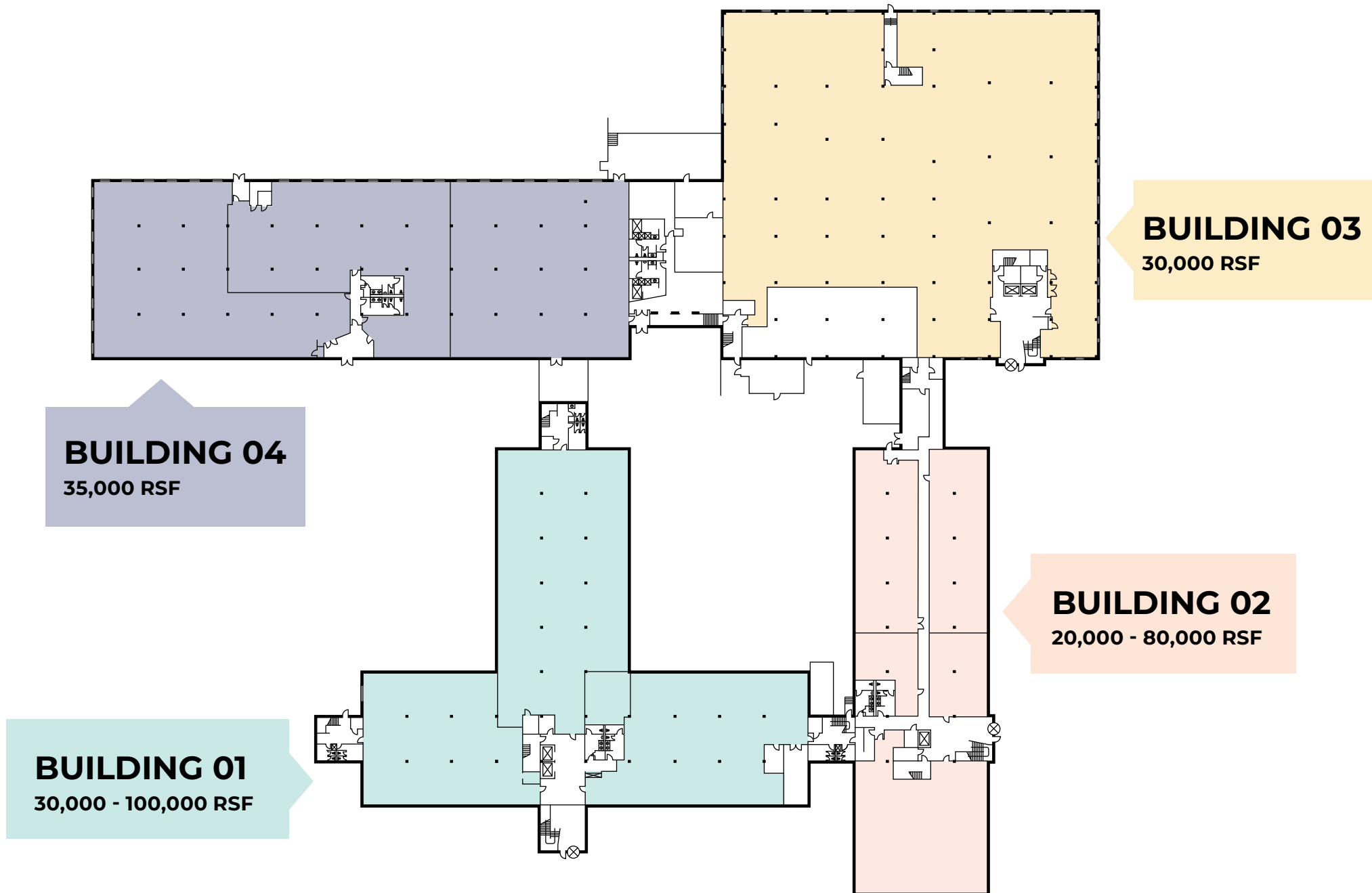

## REV HALL



New amenity center featuring multiple restaurants and a central bar area (completed 2021)

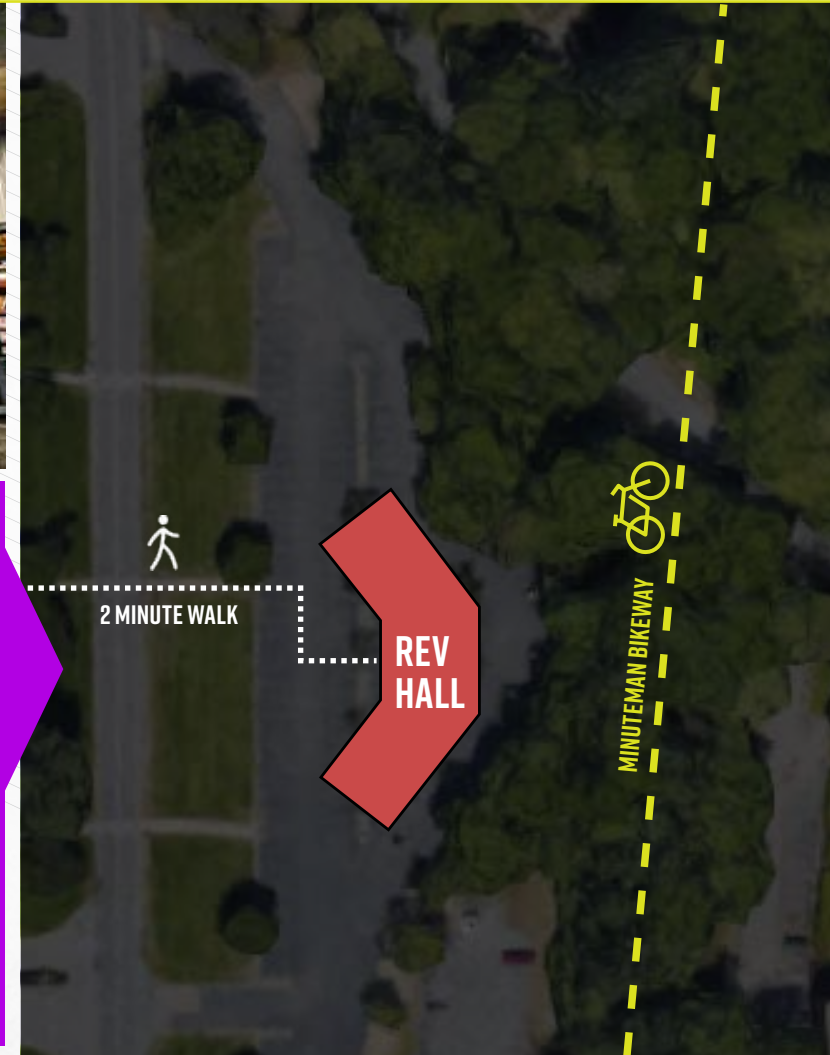
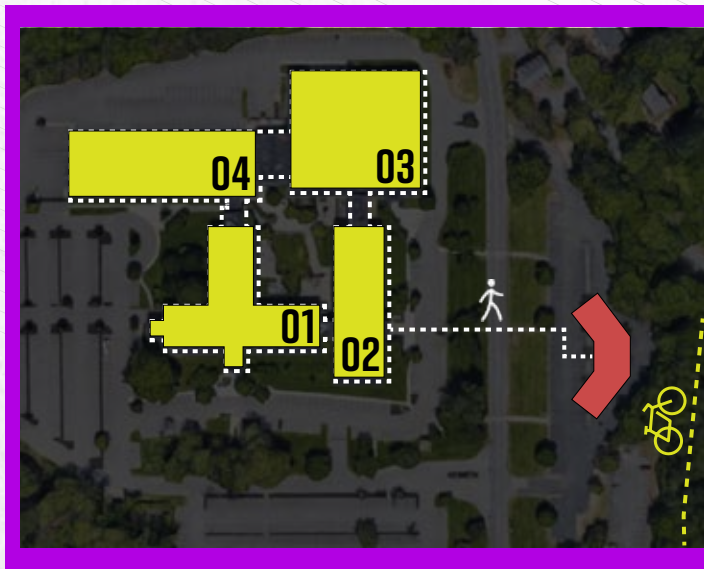

**CONTACT:** **Matthew Daniels**  
+1 617 531 4220  
matthew.daniels@am.jll.com

**Robert Coughlin**  
+1 617 316 6420  
robert.coughlin@am.jll.com

**Christopher Decembrele**  
+1 617 316 6452  
christopher.decembrele@am.jll.com

**Carly Kiernan**  
+1 617 531 4142  
carly.kiernan@am.jll.com



**GREATLAND**  
REALTY PARTNERS

**SINGERMAN**  
REAL ESTATE