

PREMIER GROUND FLOOR RETAIL IN CHERRY CREEK



ST PAUL COLLECTION

CHERRY CREEK NORTH

—
No 240

ST PAUL
COLLECTION
CHERRY CREEK NORTH

No 240



ST PAUL
COLLECTION
CHERRY CREEK NORTH
No 240

BUILDING

BUILDING NO. 240 // CLASS A MIXED-USE 6 STORIES
75,000 SQ FT OFFICE // 12,000 SQ FT RETAIL

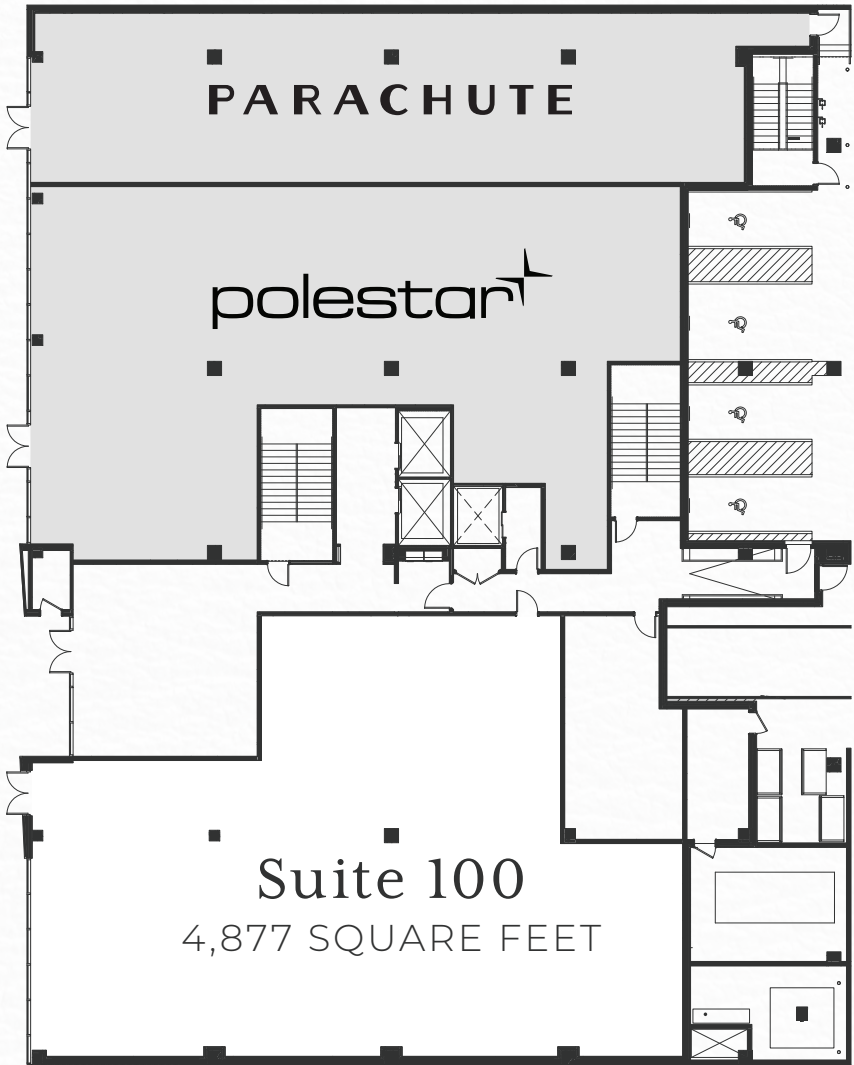

ST PAUL
COLLECTION
CHERRY CREEK NORTH
—
Nº 240



ST PAUL
COLLECTION
CHERRY CREEK NORTH

No 240

ST PAUL
COLLECTION
CHERRY CREEK NORTH

No 240

DEMOGRAPHICS

1/2 MILE	//	1 MILE	//	3 MILES	//	5 MILES
7,274		19,953		233,577		571,067
TOTAL POPULATION						
4,548		10,596		125,137		265,280
TOTAL HOUSEHOLDS						
\$175K		\$125K		\$119K		\$108K
AVERAGE HOUSEHOLD INCOME						
\$1.55M		\$2.13M		\$915K		\$730K
AVERAGE NET WORTH						
1,437		2,133		16,141		30,954
TOTAL BUSINESSES						
17,779		25,091		252,541		\$445,594
TOTAL EMPLOYEES						

AMENITY COUNTS

60	5	17	300
RESTAURANTS	HOTELS	FITNESS STUDIOS	RETAIL SHOPS
			

PREMIER GROUND FLOOR RETAIL IN CHERRY CREEK

ST PAUL COLLECTION

CHERRY CREEK NORTH

—
No 240



Sam Zaitz
+1 303 931 1201
sam.zaitz@am.jll.com

SullivanHayes
B R O K E R A G E

Julie McBrearty
+1 303 370 7476
jmcbrearty@sullivanhayes.com