



Architect's Rendering

SADDLEWOOD RETAIL CENTER

10334 STATE ROUTE 59, NAPERVILLE, IL 60564

Join DuPage Medical Group on the densely populated Naperville corridor (Rte 59 & 103rd St) (45,000 VPD)

- 3,000 SF endcap and 9,796 SF junior anchor opportunity fronting Rte 59 available. Additional small shop space available fronting 103rd St.
- A façade modernization project is scheduled for Q2 2021.
- The site sits across from Wagner Farms residential development, with 312 homes under expeditious development
- Parking lot improvement project underway. The center currently has 186 spaces.
- Site features easy access and prominent visibility with destination-driven co-tenancy.
- Ideal for retail, fitness, services, or medical/office tenancy. Inquire for greater detail on lease structures or potential BTS opportunity.



30,842

DAYTIME
POPULATION



40,935

RESIDENTIAL
POPULATION



\$182,098

AVERAGE
HOUSEHOLD INCOME



\$426,080

MEDIAN
HOME VALUE

All numbers are taken from ESRI within 3 miles.



SADDLEWOOD RETAIL CENTER

10334 STATE ROUTE 59, NAPERVILLE, IL 60564

PROPOSED SITE PLAN

103RD STREET (6,300 VPD)

HELENE AVENUE

ROUTE 59 (45,000 VPD)

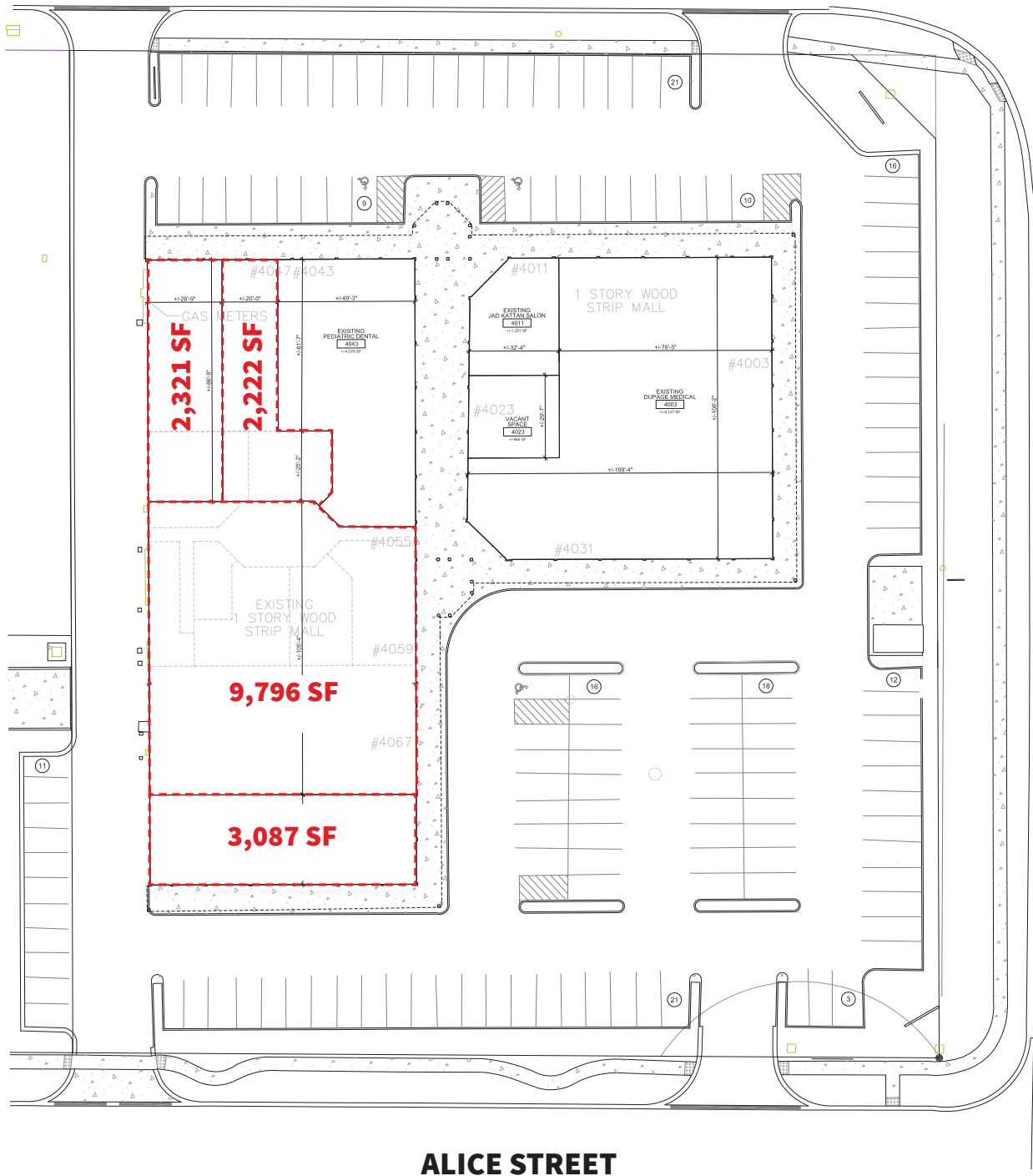

ALICE STREET

SADDLEWOOD RETAIL CENTER

10334 STATE ROUTE 59, NAPERVILLE, IL 60564

EXISTING PLAN



AVAILABLE UNITS		
#	SUITE #	SF
4	4023	966 SF
8	4071	1,520 SF
10	4063	2,030 SF
11	4059	1,003 SF
12	012	693 SF

AVAILABLE UNITS		
#	SUITE #	SF
13	108	1,295 SF
14	112	602 SF
16	105	860 SF
17	109	1,984 SF
18	4047	2,889 SF

JOSE GONZALEZ

Senior Vice President

+312 228 2155

jose.o.gonzalez@am.jll.com

JOAQUIN MANRIQUEZ

Senior Associate

+312 228 3094

joaquin.manriquez@am.jll.com