



125 East 86th Street

Northwest Corner of Lexington Avenue
Upper East Side Retail Opportunity



Available for Sublease

Space

Ground Floor 992 sf
Second Floor 9,758 sf
Total 10,750 sf

Frontage

Ground Floor: 25 feet
Second Floor: 200 feet wraparound

Term

Through 6/30/2023

Possession

Arranged

Asking Rent

\$325,000 PA gross

former Duane Reade Store #14339

Highlights

- Prime retail located on 86th Street between Park Avenue & Lexington Avenue
- Busy retail corridor in one of New York City's affluent residential neighborhoods
- Close proximity to upper Madison Avenue shopping, Museum Mile and fine dining restaurants
- Space includes vertical transportation - elevator and escalators
- Steps to 4 5 6

Neighbors



Michael Riley

+1 212 812 5901

Michael.Riley@jll.com

Patrick A. Smith

+1 212 812 5888

PatrickA.Smith@jll.com

125 East 86th Street

Ground Floor
992 SF

Second Floor
9,758 SF

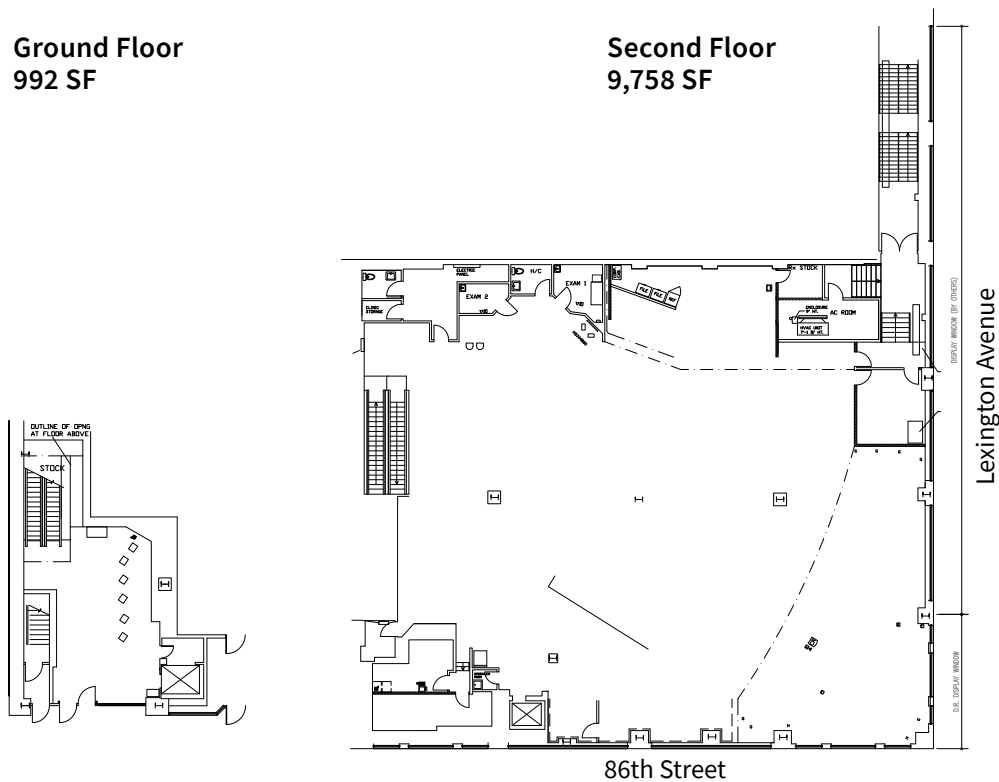

Jones Lang LaSalle Brokerage, Inc. | 330 Madison Avenue New York, NY 10017

DISCLAIMER

Although information has been obtained from sources deemed reliable, neither Owner nor JLL makes any guarantees, warranties or representations, express or implied, as to the completeness or accuracy as to the information contained herein. Any projections, opinions, assumptions or estimates used are for example only. There may be differences between projected and actual results, and those differences may be material. The Property may be withdrawn without notice. Neither Owner nor JLL accepts any liability for any loss or damage suffered by any party resulting from reliance on this information. If the recipient of this information has signed a confidentiality agreement regarding this matter, this information is subject to the terms of that agreement. ©2022 Jones Lang LaSalle IP, Inc. All rights reserved.