

# aspire

980 HOWELL MILL ROAD  
Westside Atlanta

**STREET RETAIL SPACE AVAILABLE NOW**

**LAST CHANCE TO JOIN  
THIS AMAZING LINE-UP**



10<sup>TH</sup> STREET (15,700 VPD)



GARAGE ENTRANCE

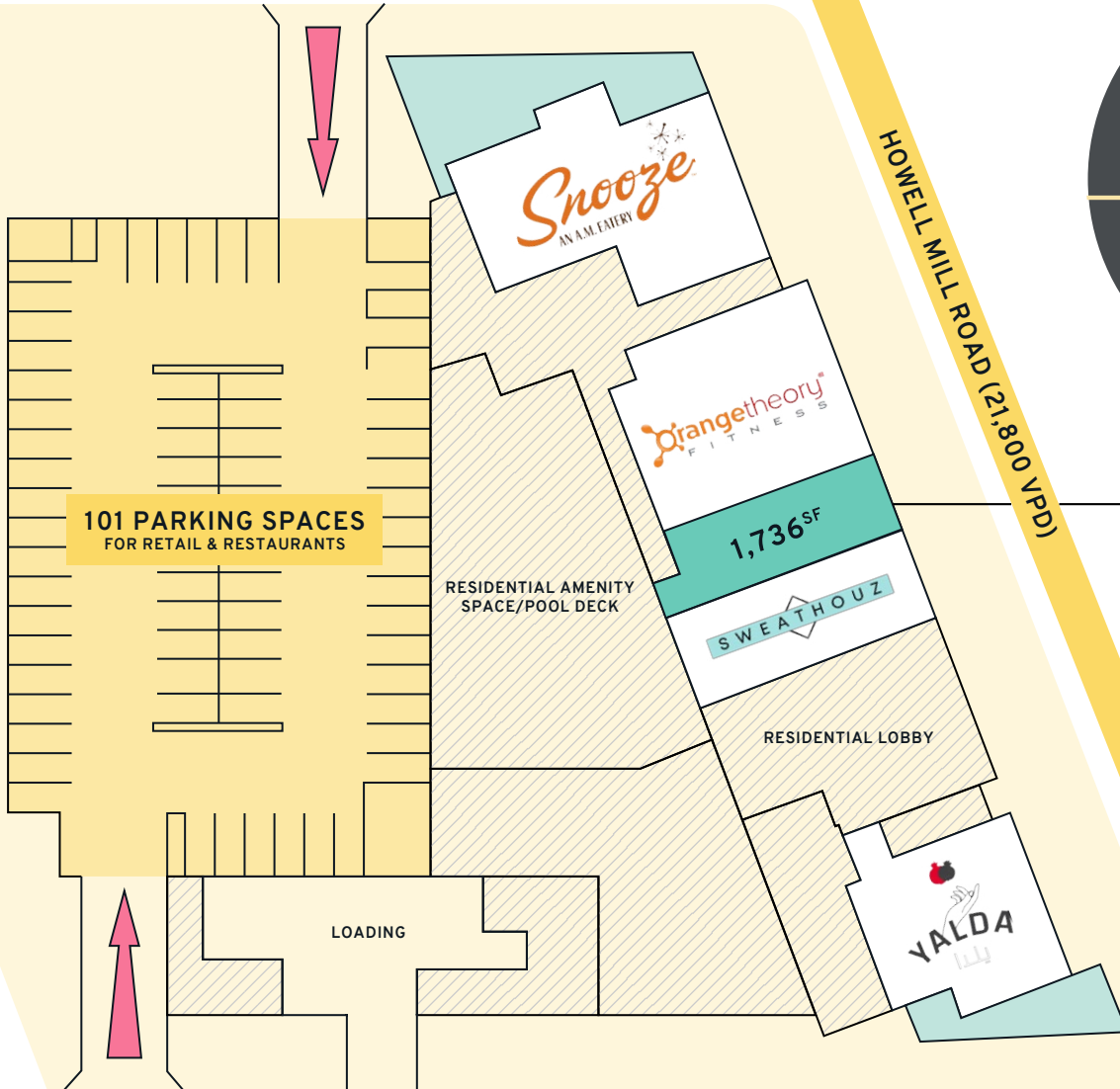

101 PARKING SPACES FOR RETAIL & RESTAURANTS

RESIDENTIAL AMENITY SPACE/POOL DECK

SWEATHOUZ

RESIDENTIAL LOBBY

VALDA

LOADING

1,736 SF

Orangetheory FITNESS

Snooze AN A.M. Eatery

HOWELL MILL ROAD (21,800 VPD)

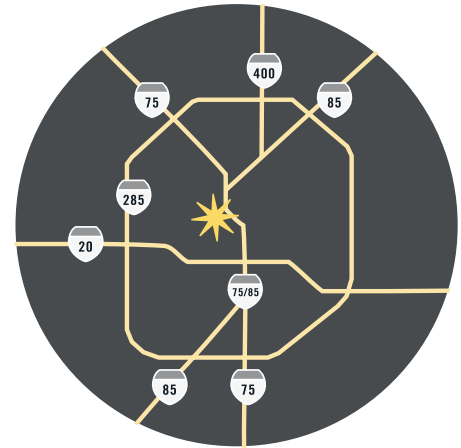

WATCH VIRTUAL TOUR OF LAST REMAINING SPACE

GARAGE ENTRANCE



9<sup>TH</sup> STREET



SID & ANN  
MASHBURN



WARBY  
PARKER

SERENA  
& LILY

BILLY REID

*free people*



Room&Board

# SHOPS

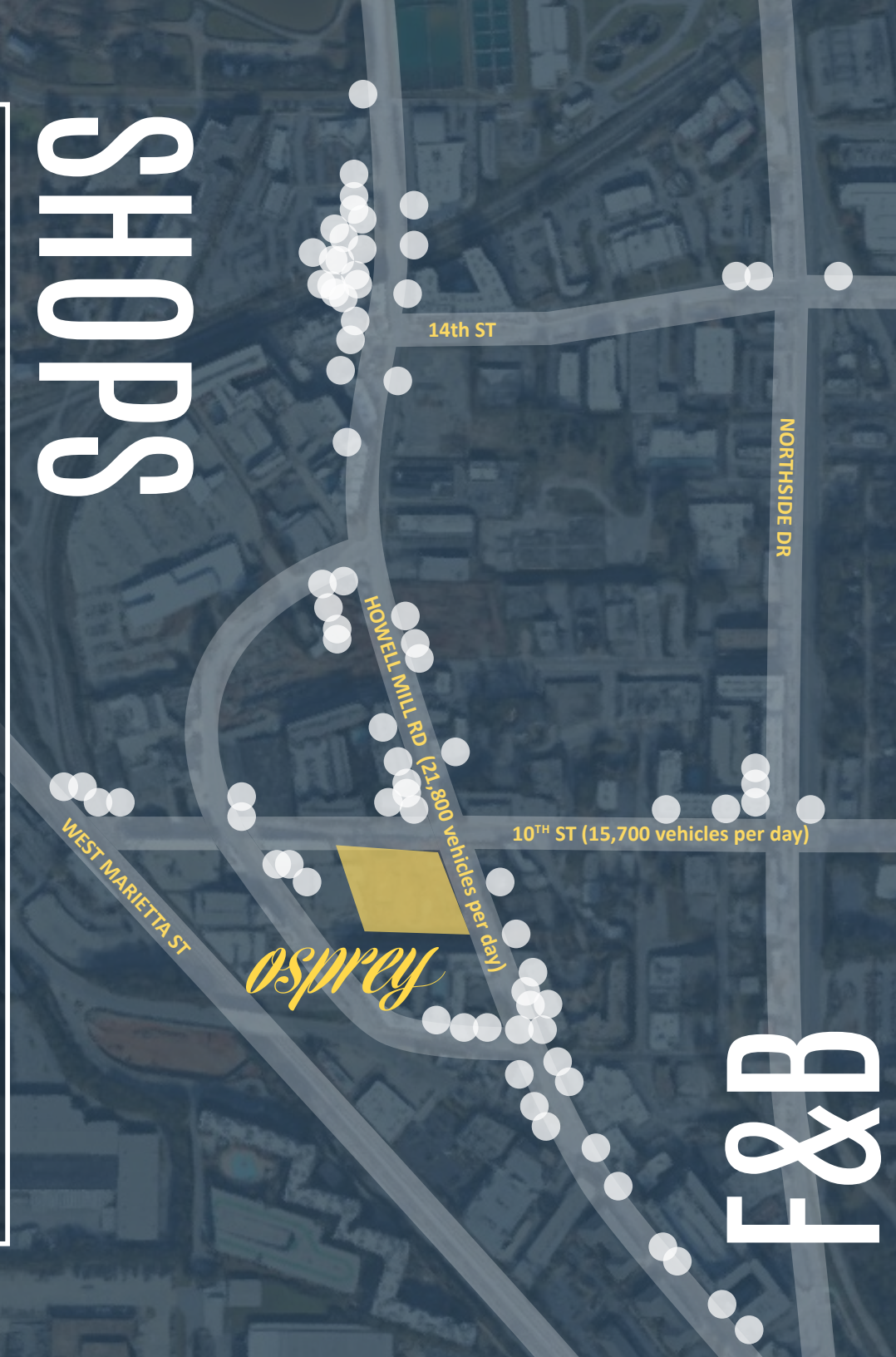

*Marcel's*

FLOWER CHILD  
HEALTHY FOOD FOR A HAPPY WORLD

MILLER + UNION

*The*  
OPTIMIST

bartaco

barcelona

*upbeet*

O-Ku

Sublime  
doughnuts

VELVET  
TACO



# F&B





# TAKE A WALK ON



**dOnuts**

**Staples**

- purist
- vanilla cream
- chocolate sea salt
- king kong
- maple glaze
- yeast/vegan

**Seasonal**

- spooky sauce
- sorbets
- humbly berry
- almond
- pinkie champagne
- apple pie
- pulled out

**cookies**

- chocolate chip
- chocolate chip





# THE *Westside*

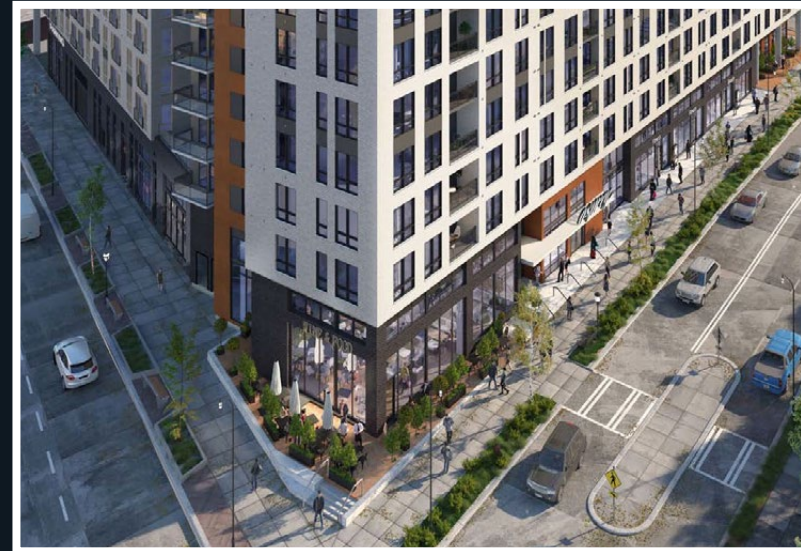



For more information, please contact:

**Coleman Morris**

Coleman.Morris@am.jll.com  
404-995-2409

**Iggy de Quesada**

Iggy.deQuesada@am.jll.com  
404-995-7443

[us.jll.com](http://us.jll.com)

©2019 Jones Lang LaSalle IP, Inc. All rights reserved. All information contained herein is from sources deemed reliable; however, no representation or warranty is made to the accuracy thereof.