

# For Lease

half-block in the North Pearl



**23,762 RSF creative / adaptive reuse space**

## 1307-1315 NW Overton St.

- 16,736 RSF
- Open ceiling with bow truss roof
- Mezzanine area with 2 gender neutral restrooms
- Floor to ceiling glass offering an abundance of natural light
- Polished concrete
- Unparalleled street level signage opportunity
- Assembly occupancy available
- Showroom opportunity

## 1325 NW 13th Ave.

- 1,532 RSF - 7,026 RSF
- Open ceiling with skylights
- Large kitchen area with plumbing
- Polished concrete
- Assembly occupancy available
- Multiple uses considered
- 1,532 RSF space: Gender neutral restroom with shower
- 5,494 RSF space: Above standard fixture count in Men's and Women's restrooms



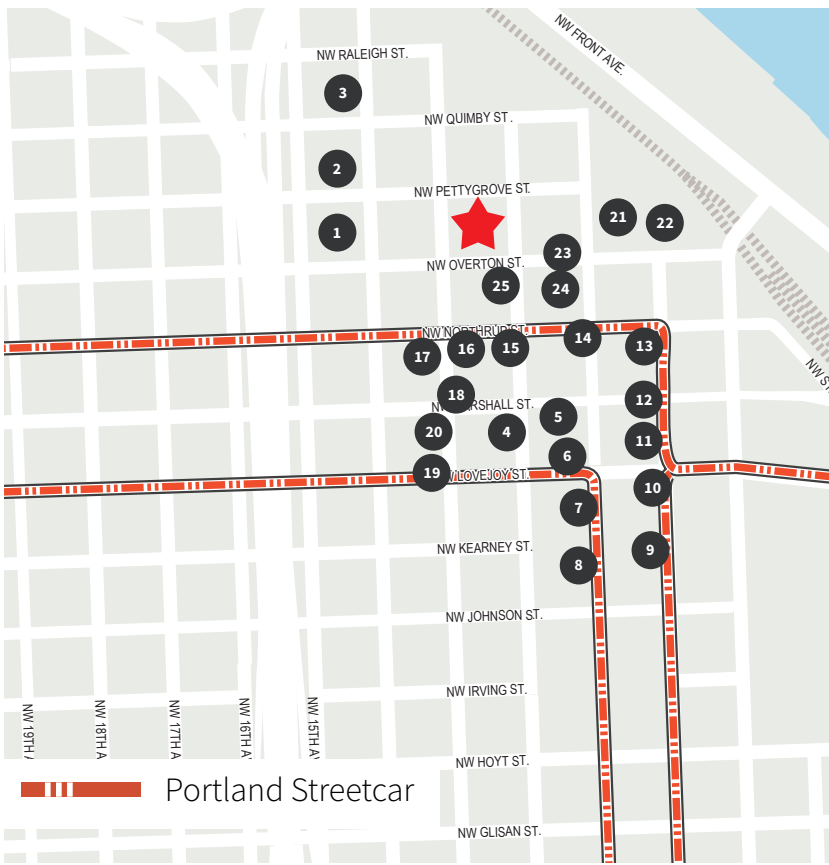

## NEARBY AMENITIES

- |                          |                           |
|--------------------------|---------------------------|
| 1 Polish Day Spa         | 14 The Fields Bar & Grill |
| 2 Planet Granite         | 15 Sisters Coffee Company |
| 3 The Old Portland       | 16 BIKETOWN               |
| 4 Chipotle Mexican Grill | 17 LA Fitness             |
| 5 Sungari Pearl          | 18 Daily Cafe             |
| 6 Starbucks              | 19 Nossa Familia Coffee   |
| 7 Wells Fargo Bank       | 20 Safeway                |
| 8 Piazza Italia          | 21 The Fields Park        |
| 9 Jamison Square         | 22 Ovation                |
| 10 Lovejoy Bakers        | 23 Pizzicato Pizza        |
| 11 Chase Bank            | 24 Carlita's              |
| 12 barre3                | 25 Kinespirit Circle      |
| 13 Tanner Springs Park   |                           |

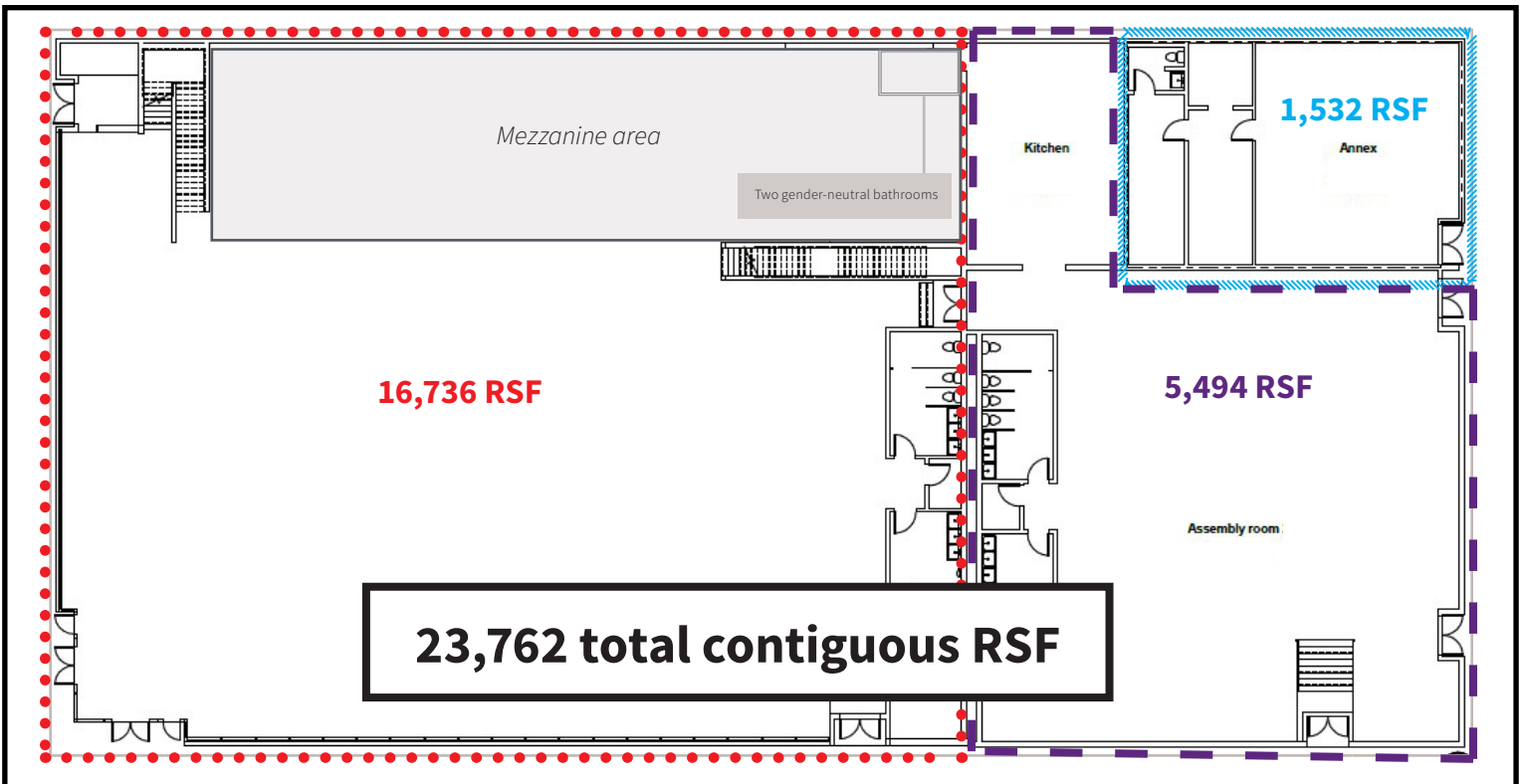

## Contact for information

**Jessica Ramey**

Licensed in OR

+1 503 972 8604

[jessica.ramey@am.jll.com](mailto:jessica.ramey@am.jll.com)

**Carter Beyl**

Licensed in OR

+1 503 522 2280

[carter.beyl@am.jll.com](mailto:carter.beyl@am.jll.com)

Jones Lang LaSalle Brokerage, Inc.

1120 NW Couch St., Suite 500

Portland, OR 97209

[www.jll.com/portland](http://www.jll.com/portland)

