



**3299 K STREET**



# GEORGETOWN LOFT OFFICE SUITES

LOFT OFFICE SUITES AVAILABLE IMMEDIATELY:

**4,380 RSF**  
3RD FLOOR  
\$38.00 - \$42.00 FS

**6,931 RSF**  
3RD FLOOR  
\$45.00 - \$48.00 FS

**16,949 RSF**  
5TH FLOOR  
\$45.00 - \$48.00 FS











3299 K STREET

FULL FLOOR OCCUPANCY | 16,949 RSF  
 14' LOFT CEILING HEIGHTS  
 PRIVATE OUTDOOR TERRACE  
 EXPOSED BRICK THROUGHOUT  
 SWEEPING VIEWS TO THE POTOMAC RIVER  
 BUILT AND READY FOR IMMEDIATE OCCUPANCY

**4TH FLOOR**  
**16,949 RSF**







4TH FLOOR LOFT AREA



4TH FLOOR OPEN AREA



4TH FLOOR KITCHEN AREA



4TH FLOOR RECEPTION





3299 K STREET

3RD FLOOR | 6,931 RSF

HIGH 14' LOFT CEILINGS

INDUSTRIAL LOOK AND FEEL

LARGE, OVERSIZED WINDOWS

OPEN LAYOUT WITH LARGE LOUNGE/KITCHEN AREA

**3RD FLOOR**  
**SUITE A: 6,931 RSF**



## THE SPACE

PARTIAL 3RD FLOOR

6,931 RSF

WIDE OPEN LAYOUT

3-4 CONFERENCE ROOMS

LARGE OPEN DINE-IN KITCHEN

UPGRADED COMMON AREAS

ACCESS TO  
BUILDING OUTDOOR TERRACE

**\$45.00 - 48.00 FS**  
**RATE PER RSF**

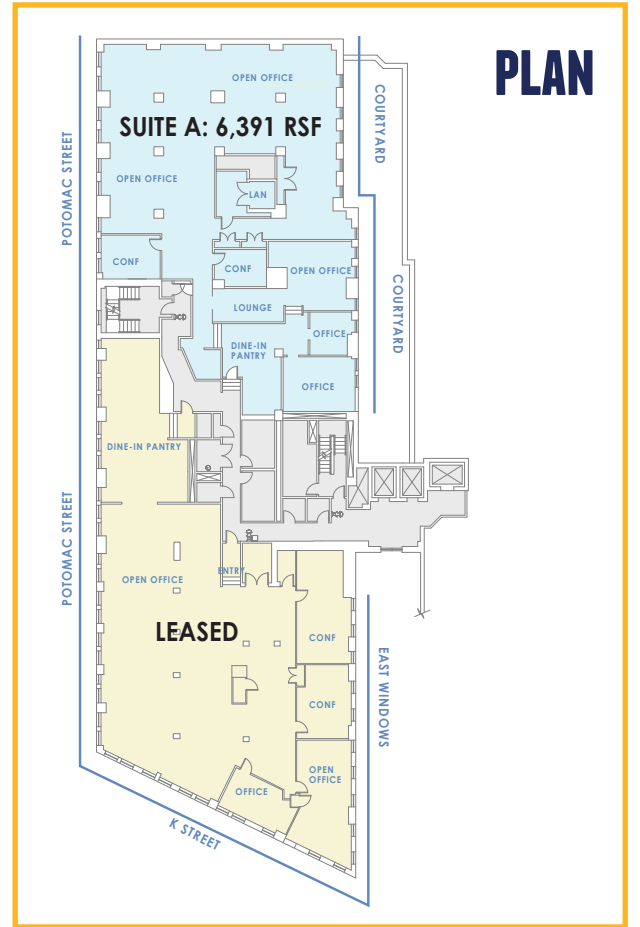

**BUILDING ROOFTOP TERRACE**





3299 K STREET

- 1ST FLOOR | 4,380 RSF
- THREE SIDES OF GLASS LINE
- OPEN LAYOUT
- RENOVATED BUILDING LOBBY
- STREET LEVEL PRESENCE
- EXTERIOR SIGNAGE AVAILABLE

**GROUND FLOOR**  
**4,380 RSF**

**\$38.00 - 42.00 FS**  
**RATE PER RSF**

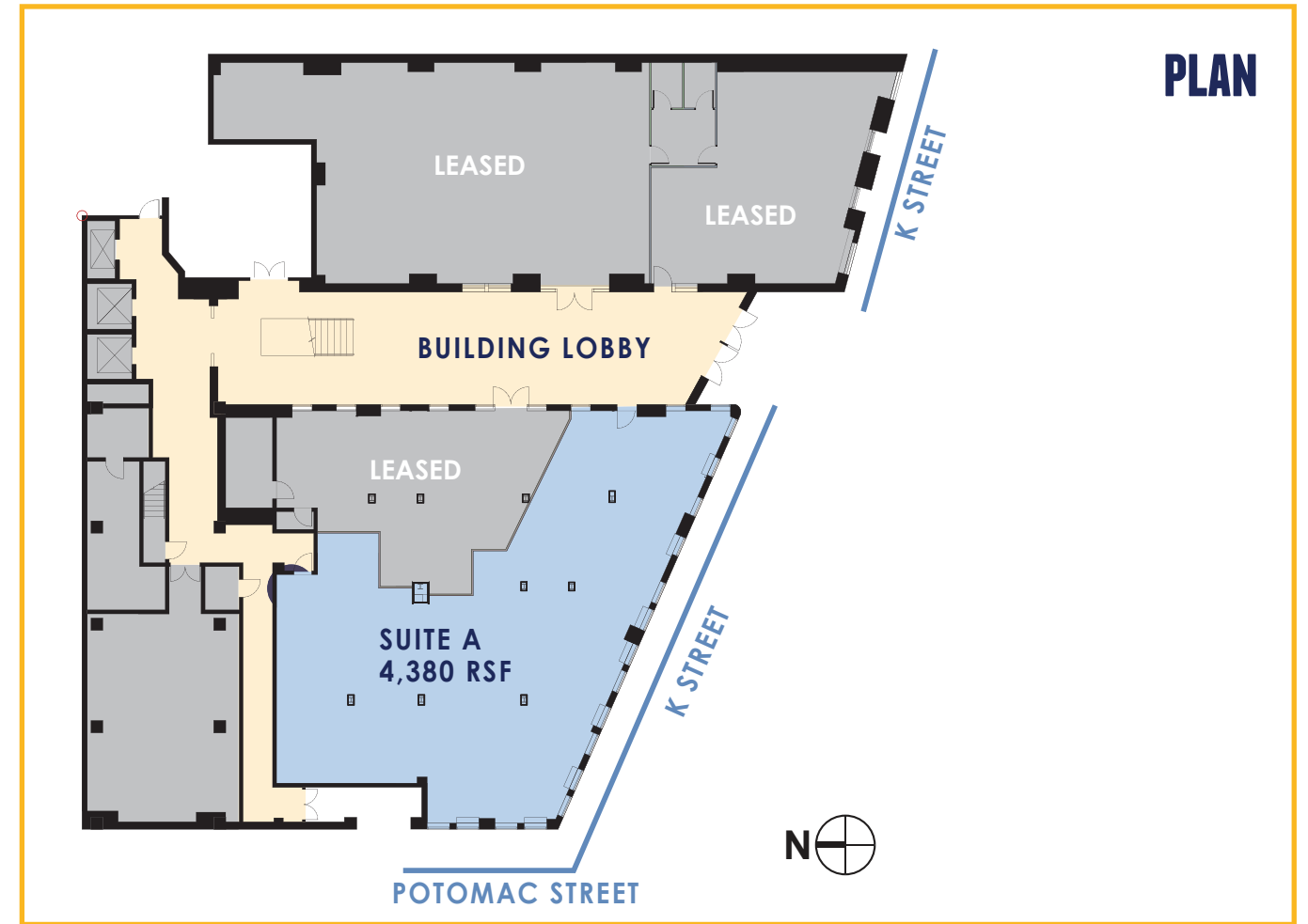





# THIS IS GEORGETOWN







**PANORAMIC  
RIVER  
VIEWS**



# CONTACT

**NATHAN BEACH**  
**MANAGING DIRECTOR | JLL**

PHONE	202.719.5680
EMAIL	<a href="mailto:NATHAN.BEACH@AM.JLL.COM">NATHAN.BEACH@AM.JLL.COM</a>
WEB	<a href="http://WWW.PAPERMILLDC.COM">WWW.PAPERMILLDC.COM</a>

