

Charging the Backpack via Solar

To charge the internal battery on solar power **may take longer** depending on weather conditions. The **Charge Indicator** will dim according to the level of solar power being absorbed.

1. Place the flat solar charger at a position that can have direct contact with sunlight, with the face of the solar cell pointed towards the sun (the best position may be the same as your local latitude). Make sure that no shadows are blocking the solar cell to ensure better power output.
2. The internal battery will begin to charge once the solar panel detects enough light. The hanging loop can be used to secure the backpack to hooks, tents, etc.

Charging Devices

Make sure there is an appropriate battery level remaining, and confirm that your electronic device is compatible with the solar panel's output voltage (DC 5V 1A) before attempting to charge a device.

1. Connect a device to the **USB Port** on the charger using an appropriate charging cable (Micro-USB cable included).

NOTE: *This is a manual charger and will overcharge a battery if permitted to operate for extended periods of time. Periodically monitor while charging, or damage to the battery, other property, or personal injury may result.*

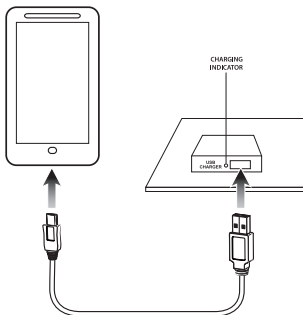

International Support

To download this User's Guide in English, Spanish, or French, or to get answers to frequently asked questions, visit the support section at:

www.iLiveElectronics.com

Para descargar este Manual del Usuario en Inglés, Español y Francés, o para obtener respuestas a preguntas frecuentes, visite la sección de apoyo en:

www.iLiveElectronics.com

Pour télécharger ce guide de l'utilisateur en Anglais, Espagnol ou Français, ou pour obtenir des réponses à des questions fréquemment posées, consultez la rubrique d'assistance sur:

www.iLiveElectronics.com

Contact Information

Website: www.iLiveElectronics.com

Email Support: prodinfo@dpiinc.com

Email Parts: partsinfo@dpiinc.com

Phone Support: 1-888-999-4215

Warranty

For Warranty Information and the most up-to-date version of this User's Guide, go to:
www.iLiveElectronics.com.



***Protect for Today
Sustain for Tomorrow***

Specifications are subject to change without notice.

Copyright © 2016 Digital Products International (DPI, Inc.)

All other trademarks appearing herein are the property of their respective owners.



Solar Backpack

User's Guide for Model IABB56-1546-01

WARNINGS

- **WARNING:** To prevent fire or shock hazards, do not expose this unit to rain or moisture.
- **WARNING :** Where the mains plug or appliance coupler is used as the disconnect device, such disconnect device shall remain readily operable.
- Lithium batteries, like all rechargeable batteries, are recyclable and should be recycled or disposed of according to state and local guidelines. They should never be disposed of in normal household waste, and they should never be incinerated, as they might explode. Contact your local government for disposal or recycling practices in your area.
- **WARNING:** This product may contain chemicals known to the State of California to cause birth defects, or other reproductive harm (California Prop 65). Wash hands after handling.
- This product meets and complies with all Federal regulations.

Features / Includes

- Built-in solar panel (5V) battery charger
- USB port for mobile device charging
- 4000 mAH power bank
- Micro-USB charging cable

Important: Do not wash this product with the electronic components still inside! They must be removed or damage and injury may result. For detailed washing instructions, see the Washing Instruction Label on the inside of the backpack..

Overview





**USB
CHARGER**

Charge Indicator Light

USB Charging Port

Use with USB charging cable to charge mobile devices.

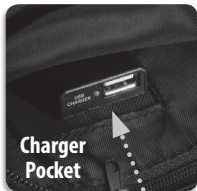

**Charger
Pocket**

USB Charger location



Interior

Install / Remove Solar Panel

SOLAR PANEL

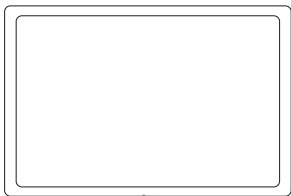

BACKPACK

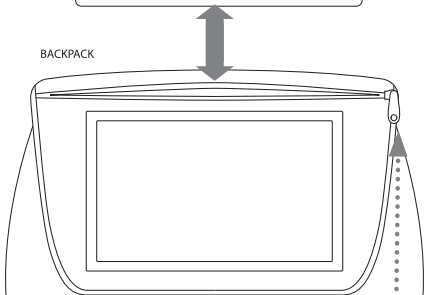

Unzip pouch to install or remove solar panel ●