

ISAAC MIZRAHI

GETTING STARTED

ENGINEERED BY HP

“Style starts
with smart.”

— ISAAC MIZRAHI



TABLE OF CONTENTS

Box contents	3
Getting started	4
Navigating the watch	10
Watch functions	12
Customizing notifications	16
Reconnecting the watch with your phone	18
Removing and replacing the strap	19
Warranty and support	20
Regulatory notices	21

BOX CONTENTS



GETTING STARTED

- 1 SET THE TIME.
 - A. Remove the plastic spacer from the crown.
 - B. Gently pull crown out to its outermost position **2**.
 - C. Rotate the crown to the correct time.
 - D. Press the crown to return it to its normal position **1**.

NOTE: If you are storing the watch make sure to pull the crown out to its outermost position **2**.



WARNING: Do not attempt to change the batteries yourself. Opening the watch case will void your warranty. Using an incorrect battery may cause the watch to overheat or catch fire.

- 2 CHARGE THE WATCH.
 1. Charge the watch for at least two hours **1, 2, 3**.

NOTE: The first time you charge the watch, the display might be blank. After you set up the watch, the charging icon ⚡ is displayed while the watch charges.

Before you charge your watch, disconnect the charger from power and thoroughly wipe the charger and watch contact pins with a soft, lint-free cloth. If needed, you may dampen the cloth with a small amount of isopropyl rubbing alcohol. Never use soap or any chemicals other than isopropyl rubbing alcohol to clean the contact pins for the watch or charger.



GETTING STARTED

3 ACTIVATE THE WATCH.

To turn on the watch, press and hold the top watch button until the Setup screen is displayed on the watch.



4 INSTALL THE PHONE APP.

The Isaac Mizrahi Smartwatch phone app connects your watch to your phone. Use the app to control the information and notifications that are displayed on your watch. You can also find updates from Isaac inside the app.

NOTE: Your phone must have either iOS 8 or later or Android 4.4 operating system or later.

- A. On your phone, go to watches.hp.com and select your watch.
- B. Download and install the Isaac Mizrahi Smartwatch app on your phone.

GETTING STARTED

5 CONNECT YOUR WATCH TO YOUR PHONE.

A. Make sure that your phone's Bluetooth® is turned on.

See your phone documentation for instructions.

NOTE: If you connect the watch to the phone using only your phone's Bluetooth settings, you cannot use the functions of your watch. You must connect the watch using the phone app to enable the phone to push notifications and other information to the watch.

B. Open the Isaac Mizrahi Smartwatch phone app on your phone, and then follow the on-screen instructions to set up your account.



C. The phone app automatically searches for nearby watches.

Press the top watch button **1** so that the Setup screen is displayed and the app can find your watch.

D. When the phone app finds your watch, select **Connect Watch**. When prompted, press the top watch button **1** again and enter the PIN displayed on your watch.

6 CONFIGURE YOUR WATCH USING THE PHONE APP.

A. In the phone app, enable notification permissions.

You must enable permissions to use the features of your watch. Notification permissions allow you to push any notifications from a third-party app, such as Facebook or Twitter, to the watch. See your phone documentation for instructions for enabling notifications.

B. In the phone app, select **Style, Watch Isaac, Activity, Notifications, My Watch, or Help**. **Notifications** also controls vibration notification settings. See "Customizing Notifications" on page 16 for more information.

You have now completed your watch setup. The rest of this guide provides more information about using your watch and customizing it using the phone app.

NAVIGATING THE WATCH

DISPLAYING THE WATCH STATUS

To display the watch status, press and hold button **2** for three seconds. The status icons disappear automatically after five seconds.

✦ **Bluetooth status icon**

Appears when Bluetooth is disconnected.

⚡ **Charging status icon**

Appears when the watch is connected to power.

🔋 **Battery status icon**

Displays remaining battery charge for the battery that powers the digital functions of your watch.



TURNING BLUETOOTH ON OR OFF

To turn Bluetooth on or off, press and release the top and bottom buttons at the same time.

NAVIGATING BETWEEN WORLD CLOCK AND ACTIVITY TRACKER

To navigate between World Clock and Activity Tracker, press button **1**. To display the time in your next selected city or view yesterday's steps in Activity Tracker, press button **2**.

DISMISSING NOTIFICATIONS

To dismiss a notification or to decline a call, press button **1**. To dismiss all notifications, press and hold the button **1**.

TURNING AIRPLANE MODE ON OR OFF

To turn airplane mode on or off, press and release the top and bottom buttons at the same time.

RESETTING TO FACTORY SETTINGS

To reset to factory settings, press and hold button **2** while pressing button **1** three times. Press button **2** to confirm.

WATCH FUNCTIONS



Incoming Call

1 (678) 555-1234

INCOMING CALL

When you have an incoming call, the caller's name is displayed if the caller is in your contacts. If the caller is not in your contacts, their phone number is displayed instead. Press button **1** to decline the call.

Messages

Aditi Mukherji
Can you pick up ▼

TEXT MESSAGE

When you receive a text message, the sender's name and message are displayed. Press button **2** to scroll, and press button **1** to dismiss the text.

Goal Achieved

5,000 Steps

ACTIVITY TRACKER

Activity Tracker keeps track of your daily steps and your progress to your daily goal. To check today's steps, press button **1**. Review yesterday's steps by pressing button **2**.

A notification is displayed when you reach your daily goal. Use the app to check your progress over the week or the month.

WATCH FUNCTIONS



New York
4:51 PM

WORLD CLOCK

World Clock syncs automatically with your phone. In the app, you can select other time zones to be displayed and change the order in which the cities are displayed on the watch. Press button **2** to scroll through your selected cities.

Event Reminder
11:00 AM
Staff Meeting

CALENDAR REMINDERS

The watch syncs with the calendar on your phone to notify you of upcoming appointments.

Press button **2** to scroll for more information, such as meeting time and location. Press button **1** to dismiss the notification.

Low Battery
Battery at 10%

DIGITAL BATTERY STATUS

When the battery that powers the digital functions of your watch has less than a 20% charge, a notification displays. When the digital watch battery has less than a 10% charge, another notification displays.

CUSTOMIZING NOTIFICATIONS

ON-SCREEN NOTIFICATIONS

To enable, disable, or change the notifications that appear on the watch screen:

1. In the app, select **Notifications**.
2. Tap the button next to the notification category to turn that notification category on or off. Tap **Edit** to enable or disable notifications from specific third-party apps.
NOTE: Most third-party apps are available in the Other category.
3. To enable notifications from a third-party app, select the checkmark next to the app name. To disable notifications from a third-party app, clear the checkmark next to the app name.

NOTIFICATION VIBRATIONS





In addition to on-screen messages, your watch vibrates to notify you of events. Notification vibrations are either high or low priority. You can change the priority of most notifications. High-priority notifications use a longer vibration than low-priority notifications.

To enable, disable, or change the priority of notification vibrations:

1. In the app, select **Notifications**.
2. Tap the button next to the notification to turn that notification on or off. Tap **Edit** to change the default vibration priority to high or low.

NOTE: You can enable a notification vibration for any third-party app. All notification vibrations not enabled by default are set automatically to low priority.

The following table describes the default vibration patterns for notifications.

NOTIFICATION	VIBRATION PATTERN	DEFAULT
Incoming call		On
Text message		On
Activity goal reached		On
Calendar reminder		On
Email		Off

KEY ● = Short pulse  = Long pulse

RECONNECTING THE WATCH WITH YOUR PHONE

If the phone and watch are disconnected, the watch displays the Bluetooth icon ✕.

To reconnect:

1. Make sure that your phone's Bluetooth is turned on. See your phone documentation for instructions.
2. Open the Isaac Mizrahi Smartwatch app on your phone.
3. Be sure that airplane mode is off, and press any button to activate pairing mode.



REMOVING AND REPLACING THE STRAP

You can purchase replacement straps for your Isaac Mizrahi Smartwatch in five colors.

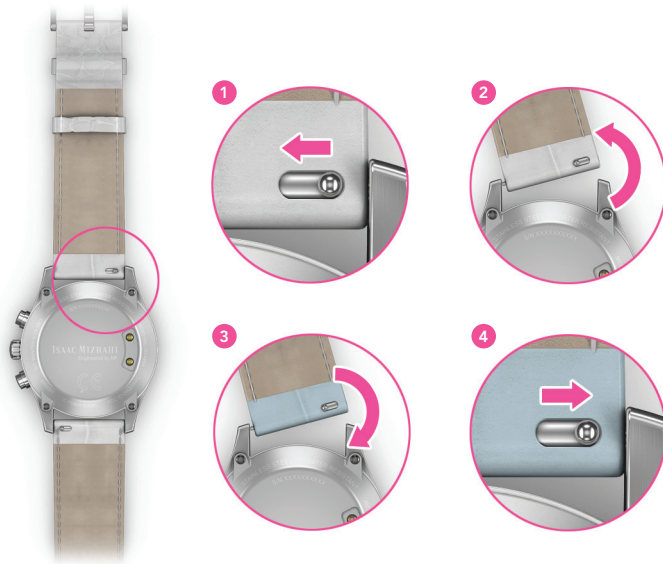

WARRANTY AND SUPPORT

For warranty and support information, go to watches.hp.com. This site contains additional online documentation as well as information about accessories and spare parts.

REGULATORY NOTICES

FEDERAL COMMUNICATIONS COMMISSION NOTICE

This equipment has been tested and found to comply with the limits for a Class B digital device, pursuant to Part 15 of the FCC Rules. These limits are designed to provide reasonable protection against harmful interference in a residential installation. This equipment generates, uses, and can radiate radio frequency energy and, if not installed and used in accordance with the instructions, may cause harmful interference to radio communications. However, there is no guarantee that interference will not occur in a particular installation.

If this equipment does cause harmful interference to radio or television reception, which can be determined by turning the equipment off and on, the user is encouraged to try to correct the interference by one or more of the following measures:

- Reorient or relocate the receiving antenna.
- Increase the separation between the equipment and receiver.
- Connect the equipment to an outlet on a circuit different from that to which the receiver is connected.
- Consult the dealer or an experienced radio or television technician for help.

This device complies with part 15 of the FCC Rules. Operation is subject to the following two conditions: (1) This device may not cause harmful interference, and (2) this device must accept any interference received, including interference that may cause undesired operation.

For questions regarding this FCC declaration, write to: HP Inc., 1501 Page Mill Road, Palo Alto, CA 94304 or call HP at 650-857-1501.

To identify your product, refer to the part, series, or model number located on the product.

MODIFICATIONS

The FCC requires the user to be notified that any changes or modifications made to this device that are not expressly approved by HP may void the user's authority to operate the equipment.

CABLES

To maintain compliance with FCC Rules and Regulations, connections to this device must be made with shielded cables having metallic RFI/EMI connector hoods.

CANADA NOTICES

This Class B digital apparatus meets all requirements of the Canadian Interference-Causing Equipment Regulations CAN ICES-3(B)/NMB-3(B). The device complies with Industry Canada license-exempt RSS standard(s). Operation is subject to the following two conditions: (1) this device may not cause interference, and (2) this device must accept any interference, including interference that may cause undesired operation of the device.

AVIS CANADIEN

Ce dispositif numérique de Classe B répond aux exigences de la réglementation du Canada relative aux équipements causant des interférences CAN ICES-3(B)/NMB-3(B). Il est conforme aux normes d'exemption de licence RSS d'Industrie Canada. Son fonctionnement est assujéti aux deux conditions suivantes : 1) Ce dispositif ne doit causer aucune interférence dangereuse, et 2) ce dispositif doit accepter toute interférence reçue, y compris les interférences pouvant provoquer un fonctionnement indésirable.

CHEMICAL SUBSTANCES

HP is committed to providing our customers with information about the chemical substances in our products as needed to comply with legal requirements such as REACH (Regulation EC No 1907/2006 of the European Parliament and the Council). A chemical information report for this product can be found at www.hp.com/go/reach.

SUSTANCIAS QUÍMICAS

HP se compromete con la tarea de brindar a nuestros clientes información acerca de los productos químicos incluidos en nuestros productos necesaria para cumplir con requisitos legales como REACH (Regulación EC N.º 1907/2006 del Parlamento Europeo y del Consejo). Podrá encontrar un informe con los datos químicos relacionados con este producto en www.hp.com/go/reach.

SUBSTANCES CHIMIQUES

HP s'engage à fournir à ses clients des informations concernant les substances chimiques contenues dans ses produits, conformément aux dispositions légales telles que REACH (Règlement CE n° 1907/2006 du Parlement Européen et du Conseil de l'Union Européenne). Un rapport d'informations sur les substances chimiques de ce produit est disponible à l'adresse www.hp.com/go/reach.

EUROPEAN UNION REGULATORY NOTICES

DECLARATION OF CONFORMITY

 Products bearing the CE marking comply with one or more of the following EU Directives as may be applicable:
R&TTE Directive 1999/5/EC; Low Voltage Directive 2006/95/EC; EMC Directive 2004/108/EC; Ecodesign Directive 2009/125/EC; RoHS Directive 2011/65/EU

Compliance with these directives is assessed using applicable European Harmonised Standards.

The full Declaration of Conformity can be found at the following web site: www.hp.eu/certificates (Search with the product model name or its Regulatory Model Number (RMN), which may be found on the regulatory label.)

The point of contact for regulatory matters is HP Deutschland GmbH, HQ-TRE, 71025, Boeblingen, Germany.

BATTERY NOTICES

The battery(ies) in this product cannot be easily replaced by users themselves. Removing or replacing the battery could affect your warranty coverage. If a battery is no longer holding a charge, contact support.

When a battery has reached the end of its useful life, do not dispose of the battery in general household waste. Follow the local laws and regulations in your area for battery disposal.

ELECTRONIC HARDWARE AND BATTERY RECYCLING

HP encourage customers to recycle used electronic hardware and rechargeable batteries. For more information about recycling programs, see the HP Web site at www.hp.com/recycle.

DISPOSAL OF WASTE EQUIPMENT BY USERS



This symbol means do not dispose of your product with your other household waste. Instead, you should protect human health and the environment by handing over your waste equipment to a designated collection point for the recycling of waste electrical and electronic equipment. For more information, please contact your household waste disposal service or go to www.hp.com/recycle.

Copyright © 2015 HP Development Company, L.P.

Bluetooth is a trademark owned by its proprietor and used by HP Inc. under license.

The information contained herein is subject to change without notice. The only warranties for HP products and services are set forth in the express warranty statements accompanying such products and services. Nothing herein should be construed as constituting an additional warranty. HP shall not be liable for technical or editorial errors or omissions contained herein.

To order a printed copy of your warranty, go to <http://www.hp.com/go/orderdocuments>. Select your country or language, and then select **Order**. Enter your information in the form provided.

First Edition: November 2015



833935-DB1