

THIS AIR CLEANER IS INTENDED FOR HOUSEHOLD USE ONLY.

**IMPORTANT SAFETY INSTRUCTIONS READ
AND SAVE THESE INSTRUCTIONS**

When using an electrical appliance, basic precautions should always be followed, including the following:

- **READ ALL INSTRUCTIONS BEFORE USING THIS APPLIANCE**
- **ALWAYS FOLLOW THESE SAFETY INSTRUCTIONS**
- **WARNING — FULLY ASSEMBLE CLEANER BEFORE OPERATING**

**WARNING — TO REDUCE THE RISK OF
FIRE, ELECTRIC SHOCK, OR INJURY TO
PERSONS, OBSERVE THE FOLLOWING:**

- Use this unit only in the manner intended by the manufacturer. If you have questions, contact the manufacturer.
- Do not expose to water or rain.
- Do not use outdoors or on wet surfaces.
- Do not expose hair, loose clothing, fingers, or body parts to openings or moving parts.
- Do not allow to be used as a toy, played with or placed where small children can reach it.
- Do not operate any fan with a damaged cord or plug. Discard fan or return to an authorized service facility for examination and/or repair.
- Do not pull or carry by cord, use cord as a handle, close door on cord, pull cord around sharp corners or edges, or expose cord to heated surfaces.
- Do not unplug by pulling on cord. Unplug by grasping the plug, not the cord.
- Do not run cord under carpeting. Do not cover cord with throw rugs, runners, or similar coverings. Do not route cord under furniture or appliances. Arrange cord away from traffic area and where it will not be tripped over.
- Unplug the appliance from the outlet before any routine cleaning or maintenance, including changing filter.
- Do not put any object into openings. Do not use with any opening blocked; keep free of dust, lint, hair, and anything that may reduce air flow.
- Use only the power adapter supplied by the manufacturer.
- Keep filter out of reach of toddlers and pets to avoid accidental ingestion.
- This appliance has no user serviceable parts.

**WARNING: TO REDUCE RISK OF PERSONAL INJURY AND
ELECTRIC SHOCK, IT SHOULD NOT BE PLAYED WITH OR
PLACED WHERE SMALL CHILDREN CAN REACH IT.**

SAVE THESE INSTRUCTIONS!

FOR CUSTOMER SERVICE, CALL
800-221-6895

THREE-YEAR LIMITED WARRANTY:

Project Air warrants that the product will perform during normal use for as long as you, the original purchaser, own the product, up to three years. If your product fails due to a manufacturing defect, please return it, with a copy of your original receipt, to Project Air at 324A Half Acre Road, Cranbury, NJ 08512, for a replacement product at no additional charge. This warranty does not cover damage caused by misuse, abuse, overheating, alteration or commercial use. Defects caused by normal wear and tear are not covered by this warranty. Except as set forth herein, Project Air provides no other warranties, express or implied, including but not limited to the warranties of merchantability, noninfringement or fitness for a particular purpose. Some states do not allow limitations on how long an implied warranty lasts, so the above limitations may not apply to you. **PROJECT AIR SHALL NOT BE LIABLE FOR ANY INCIDENTAL OR CONSEQUENTIAL DAMAGES.** Some states do not allow the exclusion or limitation of incidental or consequential damages so the above limitation or exclusion may not apply to you.

Manufactured for:
Project Air LLC
324A Half Acre Road
Cranbury, NJ 08512
Made in China
©2017
800-221-6895
www.swifferaircleaners.com



Thank you for purchasing a
ContinuousClean™
Air Cleaning System

INSTRUCTION MANUAL

- Please read these instructions carefully before using your Swiffer ContinuousClean.
- If you have general questions about using or assembling this product, please call World and Main customer service: **800-221-6895**

FEATURES

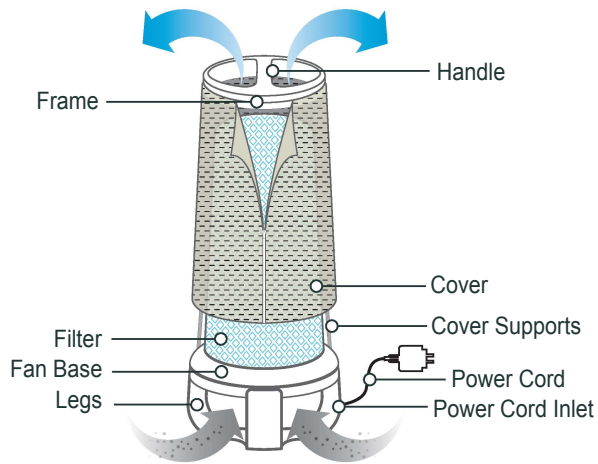

ASSEMBLY & INSTALLATION

1. Lay out all parts

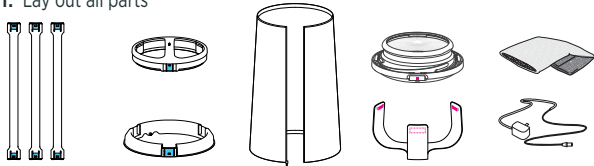

2. Discard internal packing material (plastic bags, rubber stops, cardboard, etc).
3. Match colors to assemble:

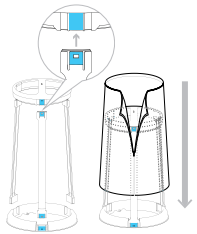

Cover

- a. Place bottom ring on flat surface and match blue markings to attach cover support. Repeat until all three cover supports are attached. Attach top ring to cover supports to complete cover frame.
- b. Zip cover 1/2 way and slide over frame until bottom ring is fully covered. Fully zip cover and set aside until Step 5.

Fan Base

- c. Attach legs to fan base by matching red markings. Press down firmly to lock in place.



Filter

- d. Attach filter by placing elastic band on the filter over the fan base to form a seal just around the edge of the fan. The top of the filter will remain loose until inflated.



4. Plug the power cord in to the power cord inlet underneath the fan base. Once inlet is secure, plug the power cord in to a power outlet. (refer to Important Safety Instructions).

Note: Fan will initially operate at a higher speed (~30 seconds) to aid filter inflation.

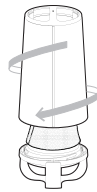

5. Lower cover over inflated filter and twist clockwise to lock in place. Cover must be in place for unit to work properly.

6. If filter does not fully inflate inside cover, tug gently until the filter height is just below top of cover.

CLEANING INSTRUCTIONS

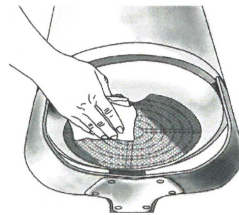

Dirt and hair may collect on the fan inlet over time. To clean, turn off Air Cleaner and wipe fan inlet gently with a clean dry cloth and/or clean gently with vacuum cleaner attachment.

USER MAINTENANCE

There are no user maintenance parts, do not open the device.

OPERATION INSTRUCTIONS

Simply plug in unit to turn on, and unplug to turn off. Your Swiffer Air Cleaning System works best when operated continuously.

FILTER REMOVAL AND REPLACEMENT

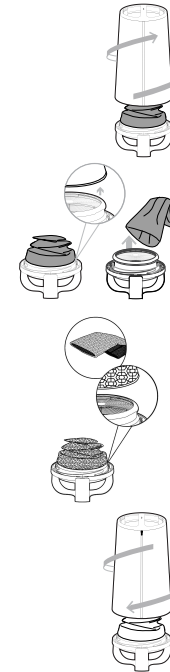

1. Unplug device.
2. Grab top handle and twist gently counter-clockwise to remove cover. Set aside.
3. Remove filter and discard in proper waste receptacle.
4. Check Air Inlet (below fan) and if necessary wipe with dry cloth or vacuum to remove soil.
5. Attach filter by placing elastic band on the filter over the fan base to form a seal just around the edge of the fan. The top of the filter will remain loose until inflated.
6. Plug device in to turn on. Allow filter to fully inflate.
7. Lower cover over inflated filter and twist clockwise to lock in place. Cover must be in place for the system to work properly.

TROUBLESHOOTING GUIDE

WARNING: TO REDUCE RISK OF PERSONAL INJURY — UNPLUG CLEANER BEFORE TROUBLESHOOTING

PROBLEM	POSSIBLE REASONS	POSSIBLE SOLUTIONS
Swiffer Air Cleaner won't run	a) Power adapter is not plugged in to wall. b) Power cord is not securely attached to fan base.	a) Ensure Power adapter is plugged into active outlet. b) Ensure power cord is secure in proper inlet.
Swiffer Air Cleaner is no longer removing pollutants	a) Filter is dirty.	a) Replace filter. Please note soil color can vary by household and filter may be dirty without appearing heavily soiled.