

IMPROVEMENTS<sup>®</sup>

DAZZLE

3-in-1 Jewelry Cleaner and Sanitizer

**SJC-1601**

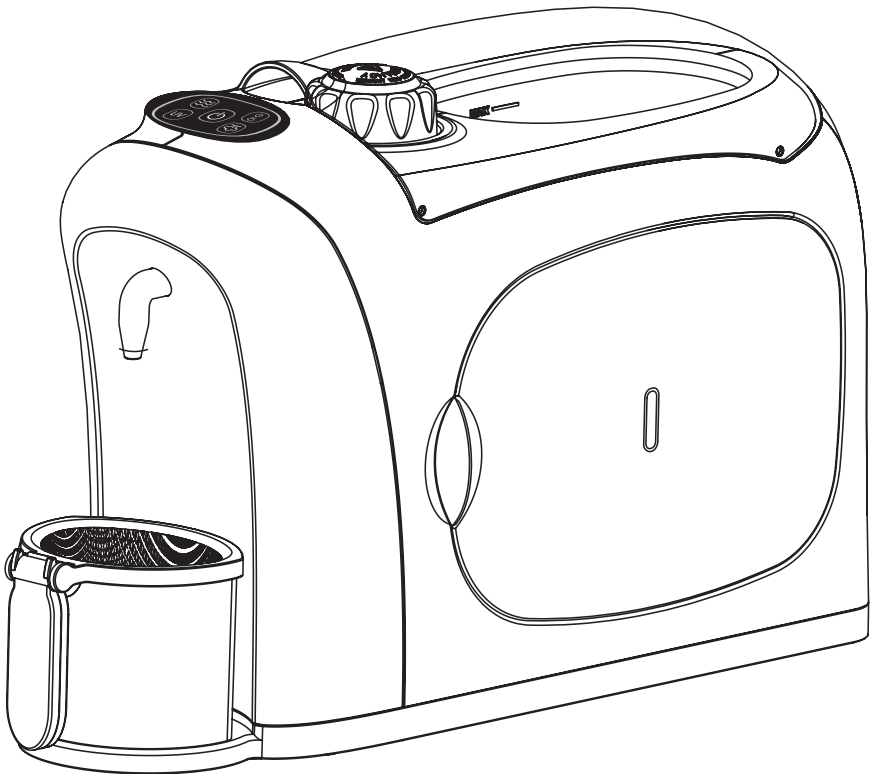

INSTRUCTION MANUAL

## INTRODUCTION

Thank you for choosing Improvements for all your jewelry and accessory cleaning needs. The Improvements Dazzle is the world's first jewelry cleaner and sanitizer combining ultrasonic cleaning, high pressure steam cleaning and UV sanitization for jewelry, glasses, watch bands, dentures, manicure/pedicure tools and more! There are no harsh chemicals needed, just add water. The ultrasonic sound waves vibrate to safely loosen dirt, oils, and make up in minutes at 43,000 vibrations per second. High pressure steam function blasts away any leftover residue like a professional jewelry cleaner. Allow the jewelry to dry and sanitize in the UV light chamber for dazzling 99.9% bacteria free jewelry.

## IMPORTANT – READ BEFORE CLEANING ANY TYPE OF JEWELRY

Prior to using the Improvements Dazzle 3-in-1 Jewelry Cleaner and Sanitizer, always confirm if the jewelry in question may be cleaned either in an ultrasonic cleaner, steam cleaner and/or exposed to UV light. Always inspect the setting for loose stones prior to cleaning. Stones that are insecurely set may fall out when cleaned by ultrasonic or steam cleaner.

While some general guidelines are noted below (see page 4) for what may or may not be cleaned in an ultrasonic cleaner, steam cleaner and/or exposed to UV light, the guidelines are not represented as being complete and are not meant to be used as your final determination as to whether or not the jewelry in question is suitable for being cleaned by the jewelry cleaner. **Before cleaning any piece of jewelry or gemstone, you should consult with a professional to correctly identify the item you desire to clean and confirm that it is suitable to be cleaned in and by an ultrasonic cleaner, steam cleaner and exposed to UV light. Improvements disclaims, to the maximum extent permissible, (a) any responsibility for damage to jewelry or any other items, and (b) any responsibility for direct, special, incidental or consequential damages under any legal theory.**

**For more information on jewelry care and cleaning, or assistance with finding qualified professionals with whom you may consult regarding the potential cleaning of your jewelry, visit the following jewelry industry websites:**

American Gem Society (AGS)  
Guide to Fine Jewelry Care  
<http://www.ags.org>

Gemological Institute of America (GIA)  
<http://www.gia.edu/>

Jewelers of America (JA)  
<http://www.jewelers.org>

The following types of jewelry should only be cleaned by a knowledgeable professional:

- Antique jewelry
- Enamel jewelry
- Paste jewelry (common with costume jewelry)
- Costume jewelry
- Jewelry containing stones that have been set with glue

## **SAFETY GUIDELINES**



**WARNING: Be sure to read and follow all safety instructions before using your jewelry cleaner. Proper care and maintenance will help expand the life of your jewelry cleaner.**

When using an electrical appliance, basic precautions should always be followed. To reduce the risk of fire, electric shock, or injury:

- Carefully read all instructions prior to use.
- USE CAUTION – do not touch hot surfaces. Use tweezers, and stainless steel basket as instructed in order to prevent injury.
- Be sure to unplug the electrical cord when appliance is not in use.
- The steamer is not intended for use by persons (including children) with reduced physical, sensory, mental capabilities or lack of experience and knowledge unless they have been instructed to do so by a person responsible for their safety.
- Do not leave the appliance unattended while plugged in.
- Children should be supervised at all times and cautioned that the steamer is not a toy and should not be played with.
- Only use tap water or distilled water. Never add cleaning solutions or agents to the ultrasonic reservoir and water tank.
- The jewelry cleaner is designed to operate with a maximum of 350ml/12 fl oz of water in its tank. To produce the driest steam, it should be operated with 325ml/ 11 fl oz of water. DO NOT over fill the water tank. If the water tank is overfilled, it will produce a hazardous splattering of water and wet steam.
- Always dry all excess water from within the funnel area before replacing the water tank cap. Any excess water within and around the water tank cap will boil out (appearing as though it is leaking). Never touch the boiling water or you may get burned.
- Never operate the jewelry cleaner without sufficient water in the ultrasonic reservoir and water tank.
- Never attempt to unscrew the water tank cap while it is still hot and under pressure.
- If the steamer runs out of steam during use, turn it off and unplug it. Allow 30 minutes for the steamer to cool before refilling the water tank.
- Do not unscrew water tank cap during or after use. Allow to completely cool down before refilling water tank. If cap is unscrewed under pressure, it may cause injury or burns.
- Be certain that the water tank cap is screwed on by hand prior to use. Do not over-tighten. Never operate the jewelry cleaner without the water tank cap properly installed.
- Do not immerse the cleaner in water or other liquids.
- Do not pull power cord to disconnect appliance from outlet or use cord as a handle.
- Do not use if cord or plug is damaged. If the power cord is damaged, it must be replaced by the manufacturer, its service agent, or similarly qualified persons in order to avoid hazard.
- Do not use extension cords or outlets with inadequate current carrying capacity.
- Be sure to keep cord away from heat, water and sharp edges.
- Do not disassemble unit or attempt to make any repairs yourself. Incorrect assembly or repair could result in a risk of fire, electric shock, or injury to persons when operating.
- Always allow your jewelry cleaner to cool down for at least 30 minutes before storing in a cool, dry place.
- For indoor use only. Do not use outdoors.
- Do not use appliance for other than the intended use. This appliance is for domestic use only. Any commercial use will void warranty. The manufacturer declines all responsibility for any damage caused by improper, incorrect or irresponsible use.

## GUIDELINE FOR GEMSTONE CLEANING

<u>Gemstone</u>	<u>Durability</u>	<u>Steam</u>	<u>Ultrasonic</u>	<u>UV light</u>
Agates	Moderate	Not Recommended*	Not Recommended*	Yes
Alexandrite	Strong	Yes	Yes**	Yes
Amazonite	Moderate	Not Recommended*	Not Recommended*	Not Recommended*
Amber	Fragile	Not Recommended*	Not Recommended*	Not Recommended*
Amethyst	Moderate	Not Recommended*	Yes**	Not Recommended*
Aquamarine	Strong	Yes**	Yes**	Yes
Carnelian	Moderate	Yes**	Yes**	Yes
Chalcedony	Moderate	Yes**	Yes**	Yes
Citrine	Moderate	Not Recommended*	Yes**	Not Recommended*
Coral	Fragile	Not Recommended*	Not Recommended*	Yes***
Diamond	Strong	Yes	Yes	Yes
Diamond Colored/Inclusion	Strong	Yes	Yes**	Yes
Emerald	Strong	Not Recommended*	Not Recommended*	Not Recommended*
Garnet (Malaya/Rhodolite)	Moderate	Not Recommended*	Yes**	Yes
Hematite	Moderate	Yes	Yes	Yes
Iolite	Moderate	Not Recommended*	Not Recommended*	Yes
Jade	Moderate	Yes**	Yes**	Yes
Lapis Lazuli	Moderate	Not Recommended*	Not Recommended*	Yes
Malachite	Fragile	Not Recommended*	Not Recommended*	Yes
Marcasite	Moderate	Not Recommended*	Not Recommended*	Not Recommended*
Onyx	Moderate	Yes**	Yes**	Yes
Opal	Moderate	Not Recommended*	Not Recommended*	Yes***
Pearl	Fragile	Not Recommended*	Not Recommended*	Yes
Peridot	Moderate	Not Recommended*	Not Recommended*	Yes
Ruby	Strong	Yes	Yes**	Yes***
Sapphire	Strong	Yes	Yes**	Yes
Spinel	Strong	Yes	Yes**	Yes
Tanzanite	Moderate	Not Recommended*	Not Recommended*	Yes
Topaz	Strong	Not Recommended*	Not Recommended*	Yes***
Tourmaline	Moderate	Not Recommended*	Not Recommended*	Yes
Turquoise	Moderate	Not Recommended*	Not Recommended*	Yes
Variscite	Fragile	Not Recommended*	Not Recommended*	Not Recommended*
Zircon	Moderate	Not Recommended*	Not Recommended*	Yes***

***Information used in Guideline for Gemstone cleaning is based on Essential Colored Stone Reference Guide from Gemological Institute of America (GIA).***

\* When Not Recommended, consult a jeweler prior to using the ultrasonic, steam and UV light features.

\*\* Hard natural gemstones can be put into an ultrasonic cleaner provided that they have few inclusions and have not been treated with heat or chemicals. Treated gemstones become more vulnerable with using the ultrasonic function. Consult your Jeweler.

\*\*\*UV light exposure is generally stable for most gemstones, but we recommend you consult your jeweler.

IMPORTANT NOTE: Many colored gemstones are routinely treated to improve the appearance of color and clarity. These treatments can be negatively affected by heat, solvents, steam and ultrasonic cleaners. Knowing whether your gem has been treated is the first step to knowing how to care for it.

Durability of Gemstones is based on the Mohs Scale

Mohs Scale: 1 – 10: 1 = weakest/ 10 = strongest

Mohs Scale	Durability Scale
1-4	Fragile
5- 7	Moderate
8-10	Strong

**GUIDELINE FOR PRECIOUS METAL CLEANING**

<u>Metal</u>	<u>Durability</u>	<u>Steam</u>	<u>Ultrasonic</u>	<u>UV light</u>
Gold	Strong	Yes	Yes	Yes
Platinum	Strong	Yes	Yes	Yes
Stainless Steel	Strong	Yes	Yes	Yes
Sterling Silver	Strong	Yes	Yes	Yes
Titanium	Strong	Yes	Yes	Yes
Tungsten Carbide	Strong	Yes	Not Recommended*	Yes

## KEY FEATURES

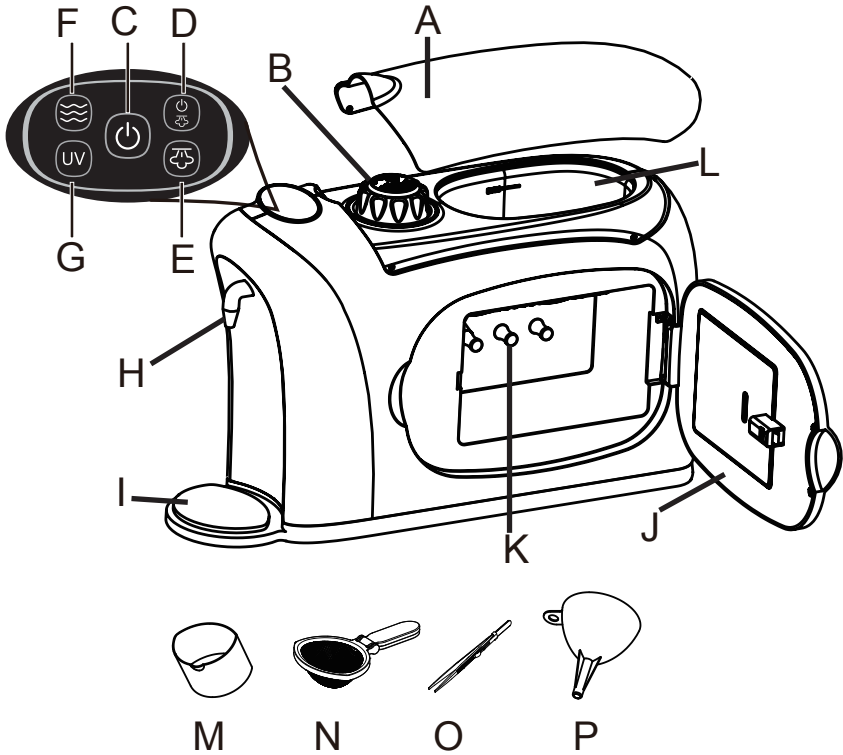

- |                        |                           |
|------------------------|---------------------------|
| A. Upper cover         | I. Base plate             |
| B. Water tank cap      | J. Side door              |
| C. Power on/off button | K. Hanger                 |
| D. Steam on/off button | L. Ultrasonic reservoir   |
| E. Steam-ready button  | M. Measuring cup          |
| F. Ultrasonic button   | N. Stainless steel basket |
| G. UV button           | O. Tweezers               |
| H. Steam Nozzle        | P. Funnel                 |

## ASSEMBLY AND USE

- 1) Set the jewelry cleaner on a flat, level surface. DO NOT plug in the electrical cord yet.
- 2) Remove the upper cover and take out the measuring cup and funnel from the ultrasonic reservoir.

**NOTE: Leave the upper cover off during use.**

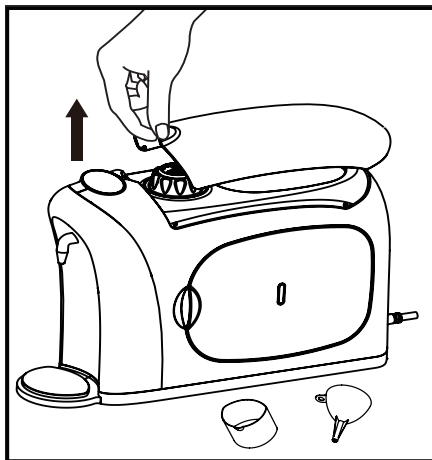

- 3) Open the side door and take out the stainless steel basket and tweezers from the UV chamber. Then close the side door.

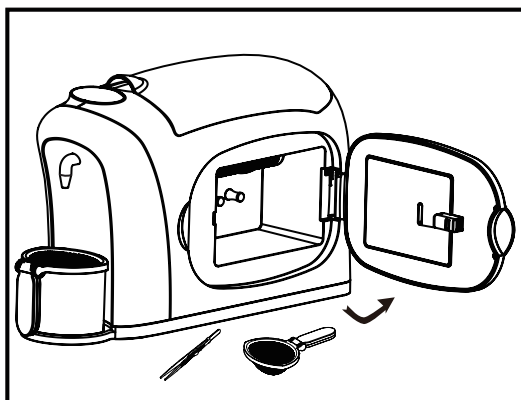

- 4) To fill the jewelry cleaner, unscrew water tank cap and fill the water tank with water by using the measuring cup, fill with water to the 250ml/9 fl oz mark. The water tank only requires 250ml/9 fl oz (one measuring cup) for the best steam pressure results. Replace water tank cap. Do not over tighten.

**! WARNING: Do not overfill the water tank. If the water tank is overfilled it will produce a hazardous spatter of wet steam. Never touch the boiling water or you may get burned.**

**NOTE: The maximum water tank capacity is 350ml/12 fl oz.**

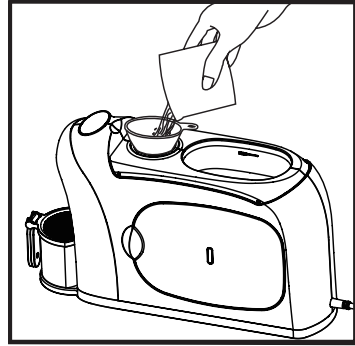
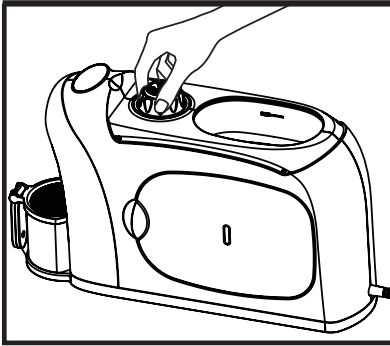

**NOTE: The jewelry cleaner does not require distilled water. Residents in areas with hard water should use distilled water for better performance. Fill water tank with water only. Do not add any type of chemicals or cleaning solutions.**

- 5) Using the measuring cup again, fill the ultrasonic tank with water to the MAX fill mark. The MAX fill requires 16 fl oz of water.

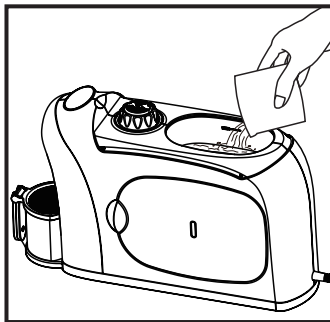



- Put the measuring cup on the base plate below the steam nozzle; put the stainless steel basket on the measuring cup. Make sure all loose parts are securely in place.

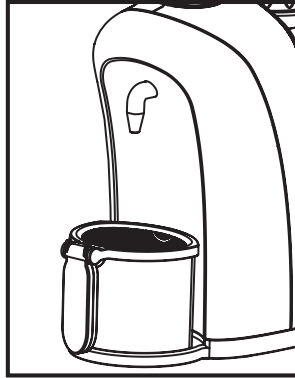

- Plug in unit. The power button will begin to flash. Press the power on/off button once to power on unit. The on/off button will stop flashing.

### **TO USE THE ULTRASONIC CLEANER**

**NOTE: It is recommended that another high wattage appliance is not operated on the same circuit to avoid a circuit overload.**



**WARNING: Never run the ultrasonic reservoir without water.**

- Place the jewelry or accessories into the ultrasonic reservoir.
- Press the ultrasonic button “” on the control panel to turn on.
- Ultrasonic will shut off after 5 minutes automatically with beep indicator. You can shut off the ultrasonic function if 5 minutes is not required by pressing the ultrasonic button a second time.
- Items that are very dirty should be cleaned first in the ultrasonic reservoir and then with the steamer.
- While waiting for the ultrasonic cleaning, press the steam on/off button for heating. After ultrasonic cleaning is done, using the tweezers, remove the jewelry from the ultrasonic reservoir and put them in the stainless steel basket. You may also hold the jewelry by using the tweezers during steam cleaning.

### **TO USE THE STEAMER**



**WARNING: Never run the steamer without water.**

- Press the steam on/off button “” allowing the steam pressure to build-up.
- The steamer may be used as soon as the steam-ready light has turned RED.

- 3) Double click the steam-ready button “” to generate continuous steam to clean the jewelry. Press the steam-ready button “” to stop steam.

**NOTE: The steam heating takes approximately 3.5 minutes after pressing the steam on/off button. The steam-ready button light will turn RED when the steam is ready to be dispersed.**

- 4) Using the tweezers, place the jewelry in the stainless steel basket. Double click the steam-ready button to turn on steam. Allow to steam for approximately 2 seconds, turn off steam by pressing the steam-ready button once. Using your tweezers, rotate or turn jewelry in basket, continue steaming for another 2 seconds. If more steam cleaning is required repeat the process as necessary.
- 5) You may also hold the jewelry by using the tweezers during steam cleaning. Hold jewelry approximately one inch beneath the steam nozzle. Using your tweezers, rotate or turn jewelry during steam process. Allow to steam for approximately 2 seconds. Repeat process as necessary.



**CAUTION: Jewelry will get hot during steam cleaning. Handle with care and allow to cool.**

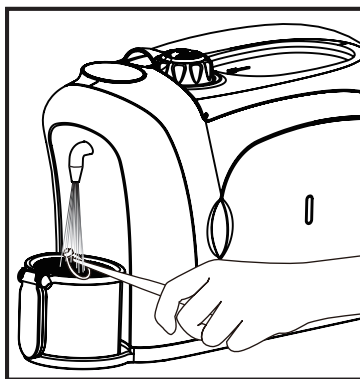

**NOTE: When steamer loses steam pressure, the steamer will automatically stop steaming and the steam-ready light will turn off. In approximately 5 seconds, the steam-ready light will turn back on, indicating that steam is available. We recommend that you wait an additional 60 seconds to allow the steam pressure to build up. You are ready to steam clean again. If the steam-ready light illuminates but no steam comes out when double clicking the steam-ready button that indicates the water tank is empty. Press Power on/off button to turn off and unplug from the outlet. Allow 30 minutes for the steamer to cool before refilling the water tank.**



**CAUTION: Never attempt to unscrew the water tank cap and refill the water tank while it is still hot and under pressure.**



**WARNING: The steam nozzle, water tank cap, and the surrounding areas will become hot after using the steam function. Do not touch.**

## **TO USE THE UV SANITIZER**

- 1) After steam cleaning, remove the jewelry from the stainless steel basket and open the side door to the UV chamber. There are 3 hangers inside to hang rings, earrings or other accessories. Close the side door. Press the UV button“  “. The UV light will operate for a 30-minute cycle and then automatically shut off with a beep indicator. You can shut off the UV light if 30 minutes is not required, by pressing the button a second time.

**NOTE: If your item is not designed to hang, you may place it on the base of the UV chamber. It is recommended that you rotate your item so light hits all sides of the item.**

**NOTE: In order to kill 99.9% of all bacteria such as *E. coli*, *Staphylococcus* and *Salmonella*, 30 minutes is required for full sanitization.**

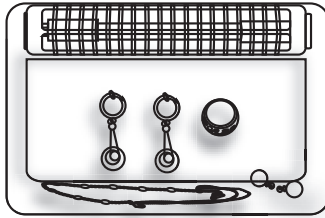

**NOTE: The UV Light will shut off automatically if you open the side door during the UV cycle to avoid UV leakage. Once the side door is closed, the UV light will turn back on to continue sanitizing for the remaining UV cycle.**

- 2) When finished sanitizing, press the power on/off button to shut the appliance off. Unplug power cord from outlet. Allow remaining water in the water tank to cool for approximately 30 minutes. Slowly unscrew the water tank cap to release any remaining pressure. Turn the unit upside down over a sink to drain the water tank and ultrasonic reservoir.

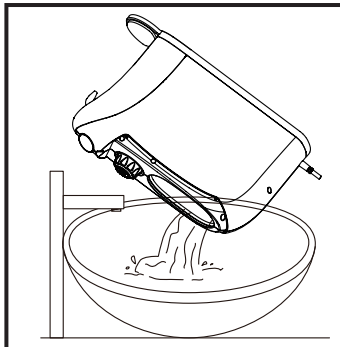

## **CLEANING AND MAINTENANCE**



**CAUTION:** Prior to cleaning your jewelry cleaner, isolate the unit by removing the cord from the power outlet and avoid immersing the unit in water.

- 1) Allow 30 minutes for the steamer to cool before storing and emptying water.
- 2) Unscrew the water tank cap slowly after the jewelry cleaner has cooled, allowing the water tank to gradually release its pressure until fully released.



**WARNING:** Never attempt to unscrew and refill the jewelry steam cleaner while still hot and under pressure.

- 3) Empty the water tank and the ultrasonic reservoir when storing the unit for a prolonged period.
- 4) Wipe the jewelry cleaner and accessories with a soft cloth when/if necessary.

## **CUSTOMER SUPPORT**

For problems with your Improvements Dazzle 3-in-1 Jewelry Cleaner and Sanitizer, please refer to Troubleshooting guide. Additional inquiries should be directed to our Customer Service department by calling 1-888-574-3662 or by e-mail to: [customerservice@anvidproducts.com](mailto:customerservice@anvidproducts.com).

### **Product Specs:**

Voltage supply: 120V, 60 Hz

Output: 1100 W

Water tank capacity: max. 350ml / 12 fl oz

Cord: 3.94 ft.

Weight: 7.9 lbs

Protection class: 2

## TROUBLESHOOTING

<b>Problem</b>	<b>Solution</b>
Jewelry cleaner not turning on; Touch panel has no illuminating lights	<ul style="list-style-type: none"> <li>● Ensure power cord is plugged into 120V AC power outlet only.</li> <li>● Ensure circuit breaker is operational.</li> <li>● Unplug the unit from the power outlet for 5 minutes then plug it back in.</li> <li>● Try operating jewelry cleaner from another power outlet.</li> <li>● If unit is still not working, call customer service 1-888-574-3662.</li> </ul>
Ultrasonic function not working	<ul style="list-style-type: none"> <li>● Ensure control panel lights are on.</li> <li>● Make sure ultrasonic button is pressed.</li> <li>● Ensure reservoir has water.</li> </ul>
Steamer not steaming	<ul style="list-style-type: none"> <li>● Ensure there is water in the tank.</li> <li>● Ensure cap is securely tightened.</li> <li>● Ensure control panel lights are on.</li> <li>● Make sure steam on/off button is pressed.</li> <li>● Make sure to wait 3-4 minutes for steam pressure to build-up.</li> <li>● Double click steam-ready button.</li> <li>● Calcium and mineral deposits can build-up and impact performance of your steamer, use distilled water if necessary.</li> </ul>
UV light not working	<ul style="list-style-type: none"> <li>● Ensure control panel lights are on.</li> <li>● Make sure to press the UV light button.</li> <li>● Ensure the UV Side door is completely closed.</li> <li>● Ensure UV light hasn't come loose during handling and shipping. Open UV side door, remove protective cover by pulling outwards firmly. Ensure UV light is installed in socket and securely locked in place.</li> <li>● To check if your UV light is locked into place, gently tap the UV light outward with your finger. If the UV light slides out of socket, it has loosened during transportation.</li> <li>● To re-install, line up its prongs with the slots on each side of socket. Push the UV light straight back into sockets and then rotate 90 degrees until you hear a click locking into place. You can give the UV light a gentle tug to ensure that it is firmly in place.</li> <li>● Re-install protective cover.</li> <li>● For additional assistance, call customer service at 1-888-574-3662</li> </ul>

## **ONE YEAR LIMITED WARRANTY**

Our Improvements product warranty extends only to the original customer purchaser of the product. It is warranted by the manufacturer to be free from all defects in materials or workmanship for a period of one year from the date of original purchase. This warranty is subject to the following conditions, exclusions and exceptions.

### **Exclusions:**

This warranty does not cover normal wear and tear of parts and does not apply to any product that has been tampered with or used for commercial purposes. This warranty does not cover damage cause by misuse, abuse or negligent handling or damage due to mishandling in transit or shipping. This warranty does not cover damage or defects caused by or resulting from repairs, service or alterations to the product or any of its parts, which have been performed by a repair person not authorized by the manufacturer. This warranty is effective only if the product is purchased and operated in the USA, and does not extend to any units which have been used in violation of written instructions furnished by the manufacturer, or to units which have had the serial number removed, altered, defaced or rendered illegible.

### **Performance:**

During the limited warranty period, the manufacturer will, at its option, repair or replace free of charge a defective product or part that is covered by this warranty. As a matter of warranty policy, the manufacturer will not refund the purchase price. A repaired or replacement product will be covered by this warranty for the balance of the initial one year warranty period.

To contact Customer Service:

Write: Anvid Products, Inc.  
1401-1499 Greenville Rd.  
Livermore, CA 94550

E-mail: [customerservice@anvidproducts.com](mailto:customerservice@anvidproducts.com)

Call: 1-888-5SIENNA (1-888-574-3662)

Please refer to your product name and model number when contacting Customer Service.

Customer Service will give you further instructions for returning a defective product for repair or replacement. When returning a defective product, carefully pack the item to avoid damage in shipping.

The manufacturer cannot assume responsibility for loss or damage during incoming shipment. We recommend that you insure the package, as shipping including the shipping cost is not covered under warranty. Be sure to include the following items with your product: any accessories related to the product, a completed warranty form, and a copy of your sales receipt or other proof of purchase to determine warranty status. C.O.D. shipments cannot be accepted.

Limitations of Remedies: No representative or person is authorized to assume for the manufacturer any other liability in connection with the sale of our products. This limited warranty is not transferable and any sale, transfer or other disposition of the product voids this limited warranty. There shall be no claims for defects or failure of performance or product failure under

any theory of tort, contract or commercial law including, but not limited to, negligence, gross negligence, strict liability, breach of warranty and breach of contract.

**ANY IMPLIED WARRANTIES, OBLIGATIONS, OR LIABILITIES, INCLUDING, BUT NOT LIMITED TO, THE IMPLIED WARRANTY OF MERCHANTABILITY AND FITNESS FOR A PARTICULAR PURPOSE, SHALL BE LIMITED TO THE DURATION OF THIS WARRANTY.** Some states do not allow limitations on how long an implied warranty lasts, so the above limitations may not apply to you.

**REPAIR OR REPLACEMENT SHALL BE THE SOLE REMEDY OF THE PURCHASER UNDER THIS LIMITED WARRANTY, AND IN NO EVENT SHALL THE MANUFACTURER BE LIABLE FOR ANY SPECIAL, INCIDENTAL, OR CONSEQUENTIAL DAMAGES, LOSSES OR EXPENSES YOU MAY INCUR IN CONNECTION WITH YOUR PURCHASE PRIOR TO USE OF THE PRODUCT OR FOR ANY BREACH OF THIS OR ANY OTHER WARRANTY, EXPRESS OR IMPLIED, WHATSOEVER.** Some states do not allow exclusion or limitation of special, incidental, or consequential damages, so the above limitation may not apply to you. This limited warranty gives you specific legal rights, and you may also have other rights which vary from state to state.

Correct Disposal of this Product	
	This marking indicates that this product should not be disposed with other household wastes throughout the US. To prevent possible harm to the environment or human health from uncontrolled waste disposal, we recommend recycling it responsibly to promote the sustainable reuse of material resources. To dispose of your used device, please contact your local city for proper disposal locations.

