



YOUR FIRST TEA CAN'T WAIT.

AVOURY ONE QUICKGUIDE

READY TO START THE REVOLUTION?

FIRST USE

Before using your Avoury One for the first time, you should clean it out. We'll show you how in 5 simple steps:

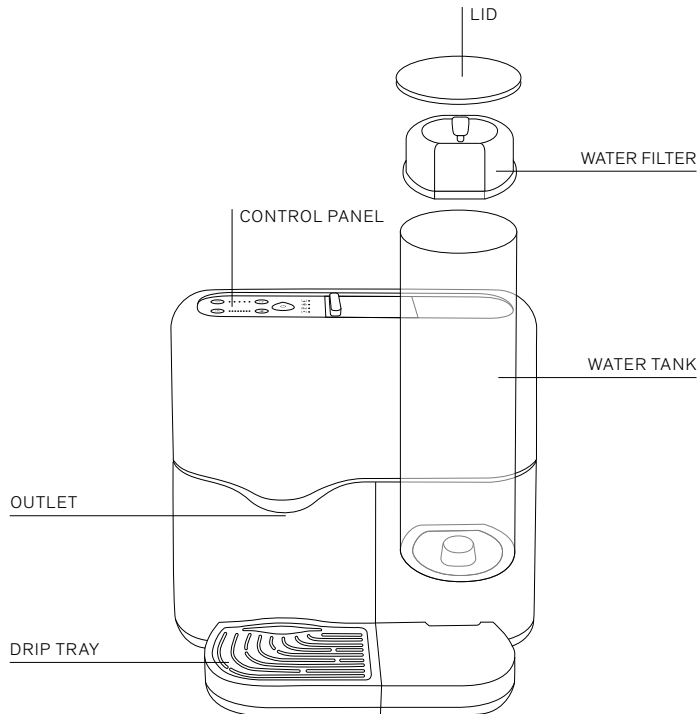

AVOURY ONE

01 Place your tea machine on a stable surface and remove all adhesive stripes. Remove the serial number sticker and keep it in a safe place.

02 Remove the water tank and rinse it with clear tap water. Fill the water tank with water up to a maximum level of two finger widths below the lid.



03 Switch on the tea machine by pressing the Start-Button. It will flash for a few seconds. When illuminated constantly, your tea machine is ready.

04 Place a vessel that holds at least 300 ml of liquid under the outlet. Press both filling capacity buttons simultaneously for about 3 seconds. Now the tea machine will rinse the brewing chamber and dispense the water into the vessel.

05 As soon as the Start-Button is continuously illuminated again, empty the vessel. Now the tea machine is ready to make the first tea.

Avoury One control panel

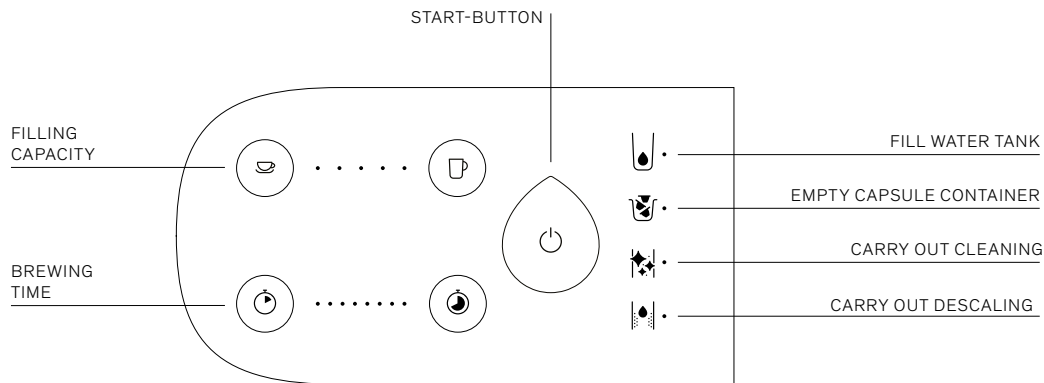

Setting the water hardness

Press the two brewing time buttons simultaneously and hold them until the LEDs on the right flash. The level of hardness is displayed by two LEDs. If you don't know the level of hardness of your water, select "hard". Confirm your settings by pressing the Start button.

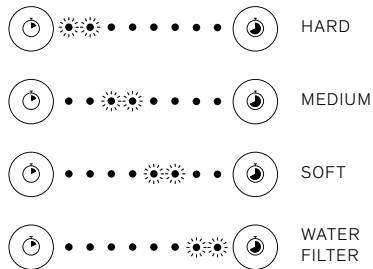

FIRST USE



Register your Avoury One machine on **Avoury.com** to benefit from all advantages and full service. The serial number is on the drip tray.



If you have any questions about your tea machine, first use or cleaning and care, the Avoury TEAm helps: **00800 7000 6000** (free of charge).

ALWAYS TIME FOR TEA.

DAILY USE

Can't wait for your perfect tea moment? Find out how to easily prepare your cup of Avoury tea here.

AVOURY ONE

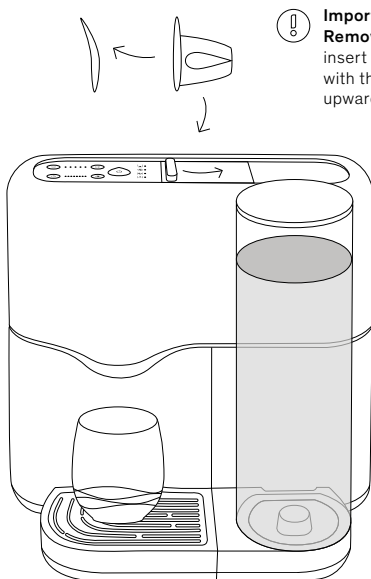

Important: Remove the lid foil and insert the tea capsule with the flap pointing upwards.



01 Switch on your tea machine by pressing the Start-Button and place a cup or a glass that holds at least 250 ml under the outlet. Wait until the Start-Button is illuminated constantly.



02 Important: Remove the lid foil from the capsule. Hold the capsule by the flap and let it slip into the open capsule compartment. Close it afterwards. Make sure you only open the capsule compartment once the Start-Button is continuously lit.



03 The brewing time and filling capacity can be adjusted individually. The brewing time changes by about 1 minute for each LED and the filling capacity by about 15 ml per LED. Brewing time can be adjusted from 1 to 8 minutes and the water capacity from 150 ml to 210 ml.

04 Press the Start-Button to brew your tea. It will take 1 to 5 minutes depending on the tea variety.



**GOOD TASTE IN
EVERY SENSE.**

EVERYTHING UNDER CONTROL.

The Avoury app allows you to control your tea machine, download the latest updates, customise brewing parameters or order new tea, all via your smartphone.

You can also manage your messages and account, as well as discover promotions, gift cards and recommendations that are individually chosen for you.



- 01** Download the Avoury app from the app store on your smartphone.
- 02** Switch on your tea machine and wait until the Start-Button is continuously lit up.
- 03** Activate Bluetooth on your mobile and connect your tea machine via the Avoury app.
- 04** When the Start-Button flashes, confirm the connection by pressing the flashing Start-Button. Once the Start-Button is illuminated constantly, the machine is ready again.



Always up to date.

To always make you have a perfect tea experience, we update the machine software regularly. Register your tea machine now on **Avoury.com** to download the latest updates for your machine automatically.



Still have questions?

You can find information on possible error codes on your machine in the user manual, on our app or on our website. Should you need any further help, simply call the Avoury TEAm on: **00800 7000 6000** (free of charge).



KEEP IT CLEAN AND SAVE THE TASTE.

CLEANING & CARE

To ensure unspoilt tea enjoyment, we recommend cleaning the machine regularly.



Empty capsule container / drip tray

When the capsule container is full, the corresponding LED will light up. Remove the drip drawer and empty the capsule container.

After each brewing process, the machine is rinsed automatically with a small amount of water. The water that runs through is discharged into the drip tray. This will be full if the red float gauge rises out of the drip grid and the corresponding LED lights up on the control panel.

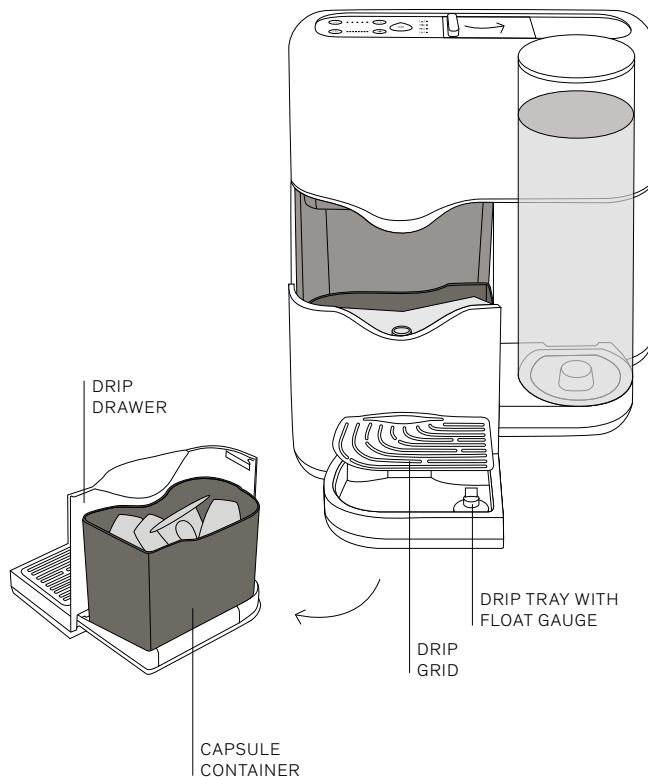



Important: Before putting in a capsule for cleaning or descaling the care mode must be activated.

Activate the care mode by pressing the filling capacity (-) and brewing time (+) buttons simultaneously and holding them down for about 3 seconds.



Cleaning (approx. 25 minutes)

The tea machine should be cleaned when the corresponding LED lights up.



01 Remove the lid foil from the cleaning capsule and put it in the capsule slot. Press the Start-Button as soon as it lights up continuously and the “Carry out Cleaning” LED starts to flash.



02 When the “Empty capsule container” LED lights up, empty the capsule container. After reinserting, the programme will continue automatically. If the “Fill water tank” LED lights up, refill the water tank.

03 Place a vessel with a volume of at least 300 ml below the outlet. After approx. 8 minutes, the cleaning liquid will be discharged into the vessel.

04 Empty the vessel, the drip tray and capsule container and reinsert the drip drawer. Place the vessel under the outlet again. Now the brewing chamber will be rinsed. This will be repeated once.

05 After the second rinsing cycle, the capsule will be ejected. Empty the drip tray, capsule container and the vessel.

06 The cleaning programme is finished when the LED goes out and the Start-Button lights up continuously.



Descaling (approx. 15 minutes)

When the “Carry out Descaling” LED lights up, the descaling programme should be started. **Important:** Remove the water filter before descaling!



01 Open the capsule compartment and insert a descaling capsule. As soon as the “Carry out Descaling” LED starts flashing and the Start-Button is lit up, press the Start-Button.



02 When the “Fill water tank” LED is lit up, empty it and pour 250 ml of Avoury liquid descaler and 250 ml of tap water into the water tank.

03 If necessary, empty the drip tray and the capsule container and place a collecting vessel with a volume of at least 300 ml under the outlet.

04 Descaling is carried out in two 250 ml cycles. The first cycle is finished when the Start-Button is continuously lit up. Empty the vessel and place it under the outlet again. Press the Start-Button to continue the programme.

05 When the second cycle is finished, empty the vessel and place it under the outlet again. Flush the water tank and fill it with 500 ml of tap water and put it back in again. Rinsing is carried out again in 2 cycles of 250 ml each.

06 When rinsing is finished, the descaling capsule is ejected and the “Fill water tank” LED will illuminate. Fill the water tank with fresh tap water. The system will briefly rinse once again.

07 When the programme is finished, the “Descaling” LED will go out and the Start-Button will light up continuously.

AVOURY®

THE TEA

LEGEND OF PAI MU TAN

6000432 | DE | 1/10/19



Avoury.com



00800 7000 6000



Join Avoury

AVOURY® | TOULOUSE ALLEE 23 A | 40211 DÜSSELDORF

