

NOZZLES

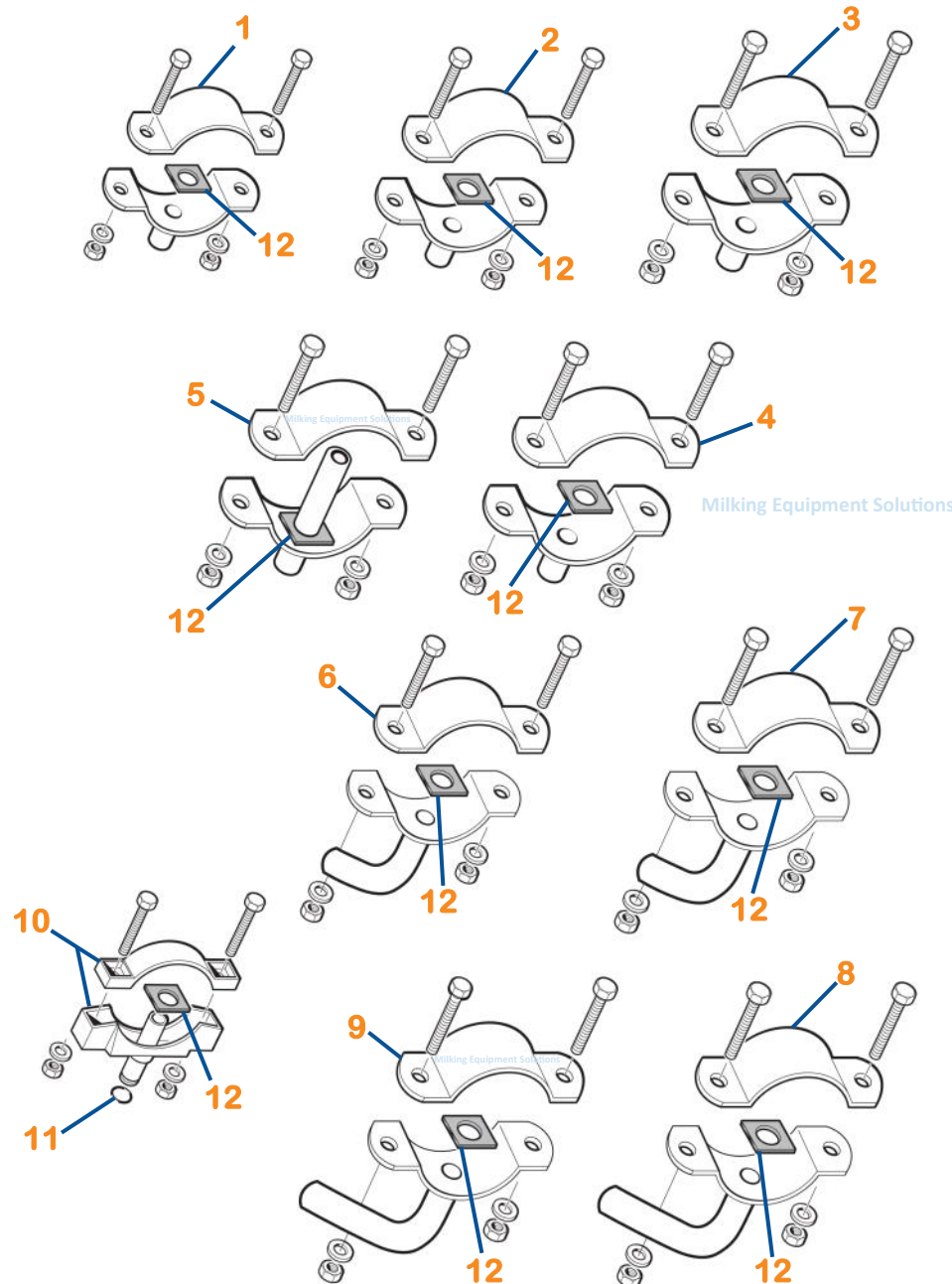

- 1 [608184](#) - Jubilee Style Nozzle Set Ø16mm for Ø32—52mm tube
- [608183](#) - Jubilee Style Nozzle Set Ø18mm for Ø32—52mm tube
- [614384](#) - Jubilee Style Nozzle Set Ø22mm for Ø32—52mm tube
Now available in Jubilee Style Only
- 2 [614606](#) - Jubilee Style Nozzle Set Ø16mm for Ø51—70mm tube
- [614608](#) - Jubilee Style Nozzle Set Ø18mm for Ø51—70mm tube
- [614393](#) - Jubilee Style Nozzle Set Ø22mm for Ø51—70mm tube
- [614604](#) - Jubilee Style Nozzle Set Ø26mm for Ø51—70mm tube
- [614657](#) - Clamp Style Nozzle Set Ø16mm for Ø51mm tube
- [613730](#) - Clamp Style Nozzle Set Ø18mm for Ø51mm tube
- 3 [614607](#) - Jubilee Style Nozzle Set Ø16mm for Ø62—83mm tube
- [614609](#) - Jubilee Style Nozzle Set Ø18mm for Ø62—83mm tube
- [614610](#) - Jubilee Style Nozzle Set Ø22mm for Ø62—83mm tube
- [614605](#) - Jubilee Style Nozzle Set Ø26mm for Ø62—83mm tube
- [613578](#) - Clamp Style Nozzle Set Ø16mm for Ø63mm tube
- [613727](#) - Clamp Style Nozzle Set Ø18mm for Ø63mm tube
- [614658](#) - Clamp Style Nozzle Set Ø22mm for Ø63mm tube
- 4 [614659](#) - Clamp Style Nozzle Set Ø16mm for Ø76mm tube
- [614660](#) - Clamp Style Nozzle Set Ø18mm for Ø76mm tube
- 5 [303054](#) - Clamp Style Air Injector Nozzle Ø16mm for Ø76mm tube
- 6 [614464](#) - Clamp Style Angled Nozzle Ø16mm for Ø40mm tube
- 7 [614465](#) - Clamp Style Angled Nozzle Ø16mm for Ø51mm tube
- 8 [614661](#) - Clamp Style Angled Nozzle Ø16mm for Ø63mm tube
- 9 [614662](#) - Clamp Style Angled Nozzle Ø16mm for Ø76mm tube
- 10 [608311](#) - Nozzle Set Ø17mm
- [613969](#) - Nozzle Ø17mm [612974](#) - Plastic Strap
- 11 [607760](#) - O-Ring
- 12 [613820](#) - 16mm Bottom Seal/Gasket (*also suitable for 18mm*)
- [607988](#) - Ø15mm Bottom Seal/Gasket [607815](#) - Bottom Seal x 30