

Step 1: Measure the opening height. Cut the column 1/8" shorter than your measurement. Cut the column FROM THE BOTTOM to the desired length with a fine-tooth carbide blade. DO NOT CUT THE COLUMN FROM THE TOP

Step 2: Place the L-Shape half of the column in position around the structural support

Step 3: Apply a continuous 1/4" bead of urethane adhesive caulk (included) along both mitered edges of the column half

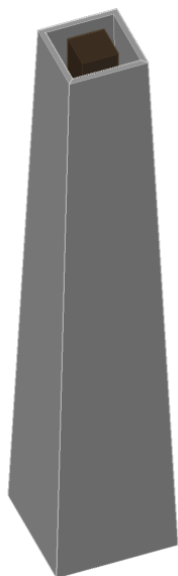
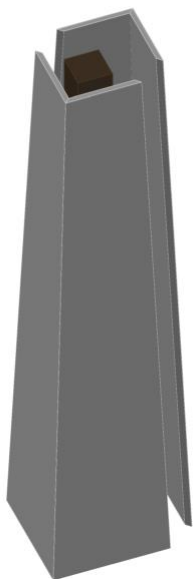

Step 4: Use a pneumatic finish nail gun to fasten the two halves every 6-8" along both sides of the column.

NOTE: Clean off any caulk squeeze-out with a clean, damp rag

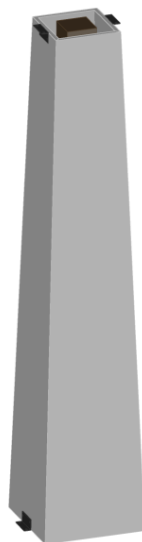

Step 5: Install the 4 mounting brackets, 2 brackets attach to the top of the column to the beam and 2 attach to the bottom of the column to the substrate.

NOTE: The brackets should be affixed apart at 180° (on opposite sides)

Step 6: Fit the cap and base moulding around the column. Measure and trim with a miter saw as necessary. Secure the cap with a finish nail gun or galvanized or stainless steel trim screws

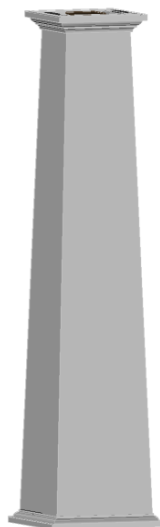
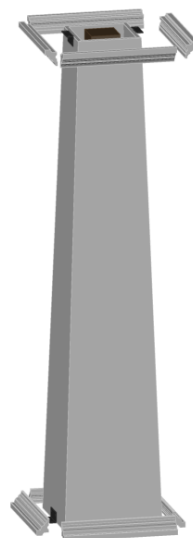

Step 7: If installation of the included neck moulding is desired, proceed by checking the fit and trim pieces as necessary. Fasten with a finish nail gun or galvanized or stainless steel trim screws

Step 8: Priming and Painting: Product must be primed/painted after installation is complete to ensure Warranty. Follow the paint manufacturer's coating recommendations and application instructions

Version: 04302024E