

Step 1: Measure the opening height. Cut the column 1/8" shorter than your measurement. Cut the column to the desired length with a fine-tooth carbide blade

Step 2: Use galvanized or stainless steel fasteners to secure the squaring blocks to the structural support. Blocking will accommodate a number of installations such as the center of the column, inside corner and inside face of one side

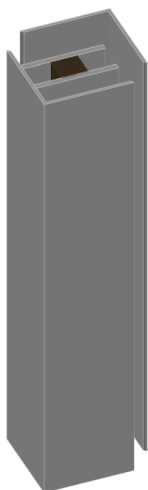

Step 3: Place one L-Shape half of the column in position around the structure support. Secure that half of the column to the squaring blocks with galvanized or stainless steel screws or finish nails (screws are recommended because the column shaft can be repositioned if necessary)

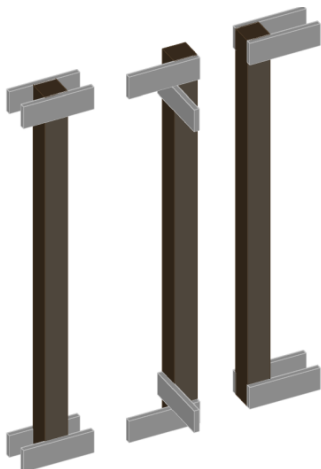
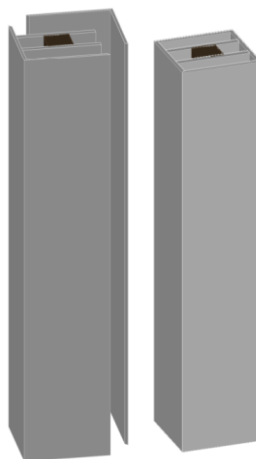

Step 4: Apply a continuous 1/4" bead of urethane adhesive caulk (included) along both mitered edges of the column half. Use a pneumatic finish nail gun to fasten the two halves every 6-8" along both sides of the column.

NOTE: Clean off any caulk squeeze-out with a clean, damp rag



Step 5: Fit the L-Shape cap and base around the column. Secure the cap and base with a finish nail gun or galvanized or stainless steel trim screws

Step 6: If installation of the included neck moulding is desired, proceed by checking the fit and trim pieces as necessary. Fasten with a finish nail gun or galvanized or stainless steel trim screws

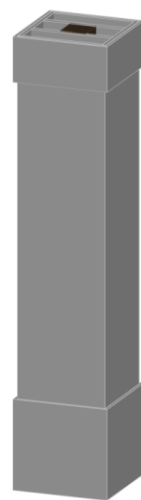

Step 7: Priming and Painting: Product must be primed/painted after installation is complete to ensure Warranty. Follow the paint manufacturer's coating recommendations and application instructions

Version: 04292024E