

# Island Cabinet

## Open Apertures Island End (Solid Top, 5 Legs) - Fitting Guide

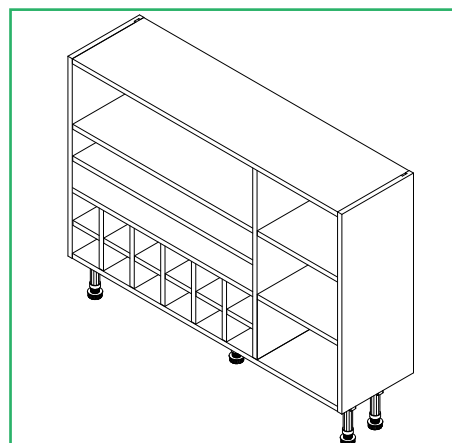

### Cabinet Parts



32x  
15mm Screws

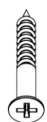

8x  
30mm Screws



5x  
Legs



5x  
Leg Brackets

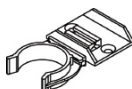

2x  
Plinth Clips



4x  
Large L brackets



8x  
Screw Head  
Cover Stickers



8x  
Shelf Pegs



Shelves

### Tools Required

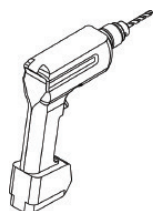

Drill



Stud Finder



Mallet



Screwdriver

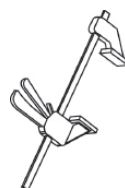

Clamp



Spirit Level



Tape Measure

Remember to take care when unpacking. Please keep your workspace clean, clear, and tidy when working. This will help keep all items safe from damage. Any unneeded cardboard or plastic should be flattened down and placed in the bin.

A minimum of two people will be needed to lift the cabinet.

## Removing the fixtures and fittings

Remove all fixtures and fittings from the cabinet and keep them on a clean, level surface.

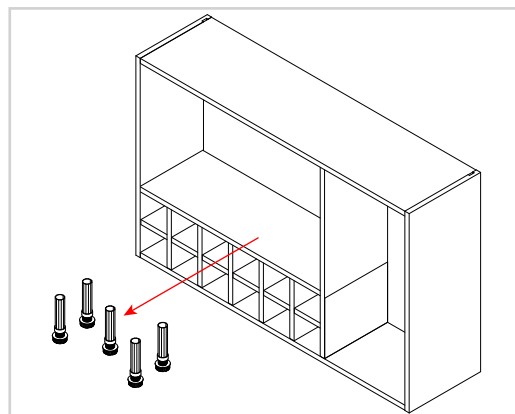

## Positioning the leg brackets

Locate the leg brackets and position, as shown in the diagram. Ensure the leg brackets are rotated so the flange covers the outer edge, as this provides support for the edge of the cabinet.

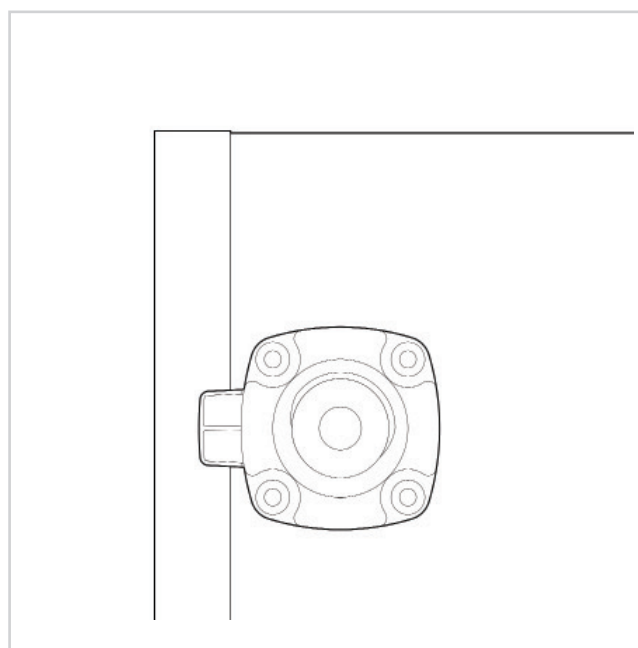
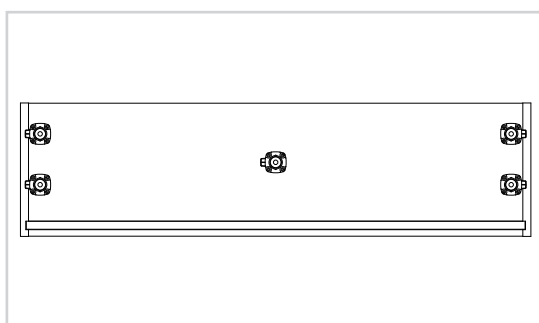

## Fixing the leg bases

Secure each of the leg brackets into place with **4x15mm** screws per bracket.

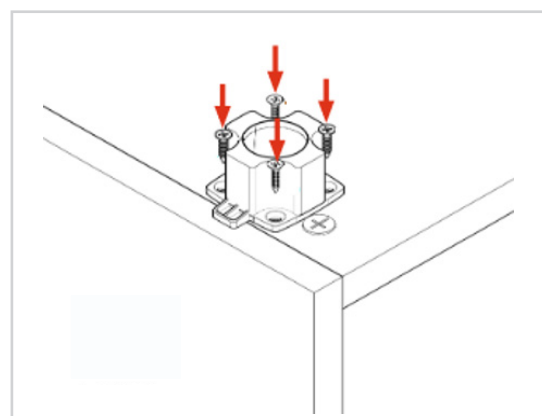

## Inserting the legs

Push each leg firmly down into the leg bracket. Adjusting each leg to **155mm**.

Adjust the legs to the correct height by turning clockwise or anti-clockwise.

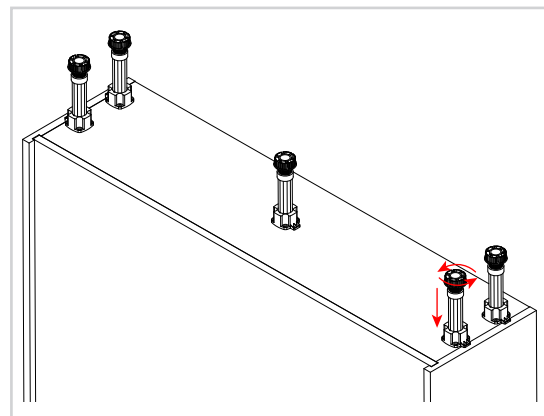

## Lifting the cabinet into place

When lifting the cabinet into place, do **not** tilt, as this can damage the legs.

Position the cabinet where it will be installed.

Use a spirit level to ensure the cabinet is level from front to back, left to right, and diagonally. Adjust the legs if required.

The leg height can be adjusted by turning the foot of the leg clockwise or anti-clockwise.

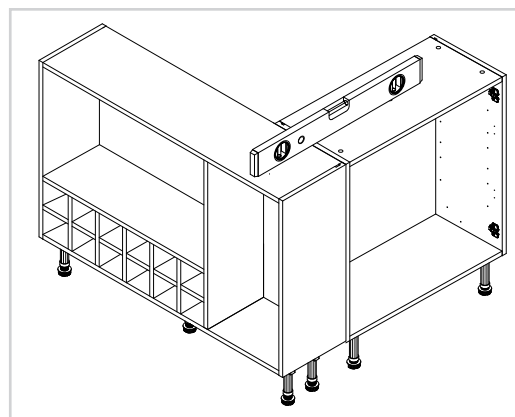

## Fitting the shelf pegs

Position the shelf pegs into the pre-drilled holes.

The shelves for this cabinet can only be positioned in set places.

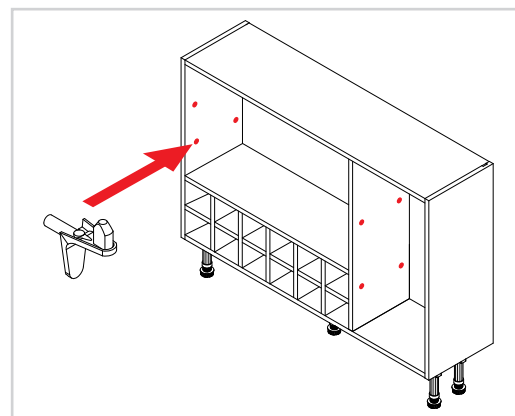

No screws are provided to secure the cabinet to the adjacent cabinets, as these are provided with the adjoining cabinets.

### Securing adjacent cabinets

Clamp together the cabinets, checking the adjacent cabinets front edges are flushed and level with the cabinets side panels.

Using the screws provided from the island cabinets, **1x30mm** screw should be fixed from the inside of the island base cabinets going into the island end cabinet at the top and bottom. Screws should be fixed so each corner of the island end is secured to the adjacent cabinets using the end panels or top rail as fixing points.

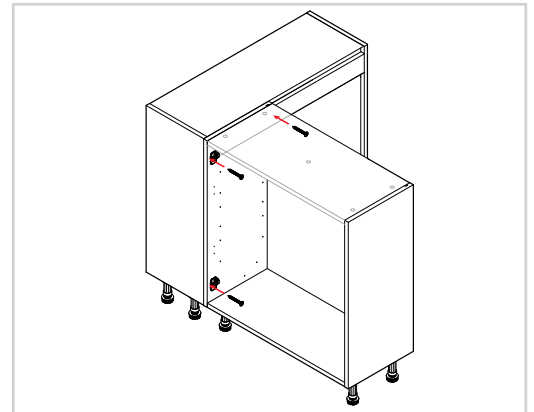

### Inserting the shelves into position

To insert the shelves into position. The shelves will touch the back panel when installed, if there is a gap between the back panel of the cabinet and shelves then they have been installed back to front, and the shelves need to be rotated.

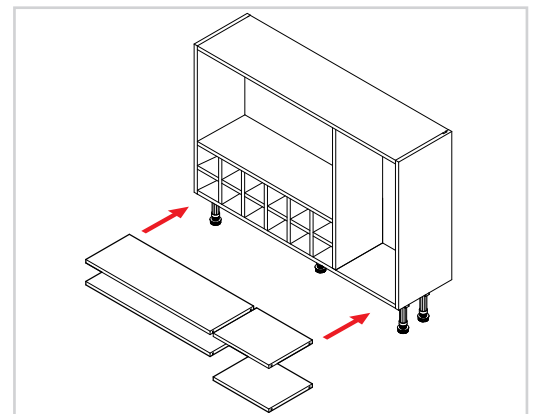

### Cleaning the cabinet

Finally, the cabinet should be thoroughly cleaned to remove any debris that may have accumulated during the installation.

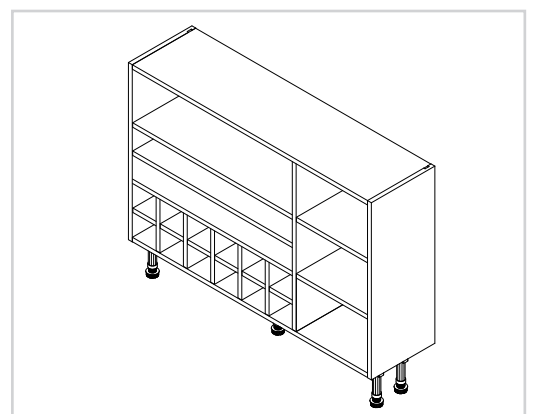

Store the plinth clips and the remaining 15mm screws.  
These will be used later when attaching the plinth.