

BASE UNIT

500-1000, Sink Hob 1-2 Door / 1-2 Door + Dummy Drw Assembly Guide

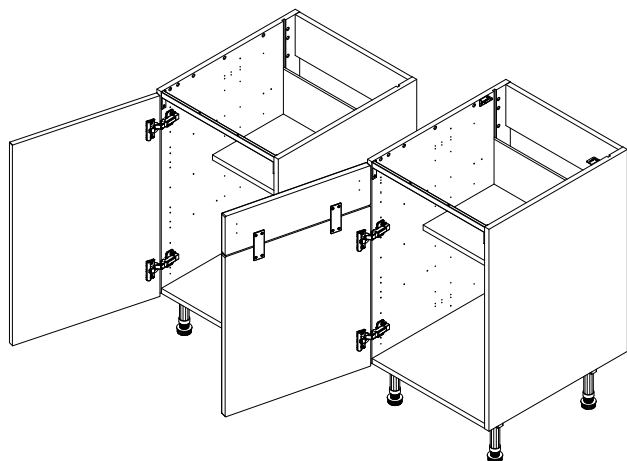

500 1 Dr/ 1Dr + Dummy Drw

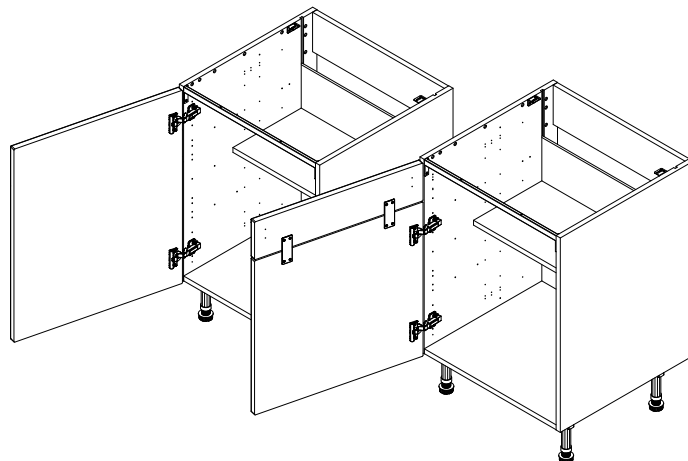

600 1 Dr/ 1Dr + Dummy Drw

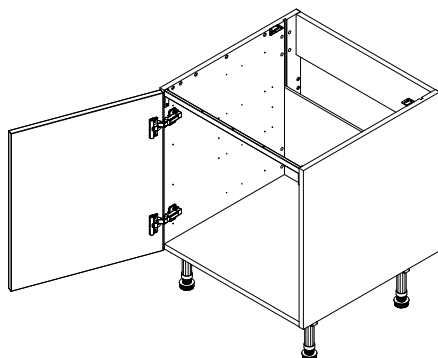

**600 1 Door Overmount
Belfast**

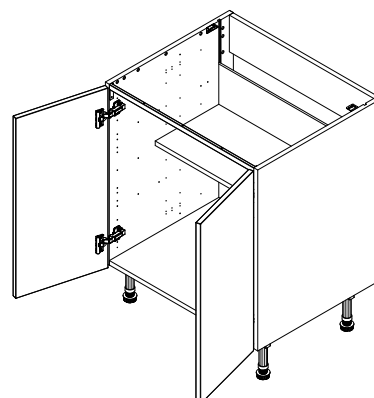

700 2 Door

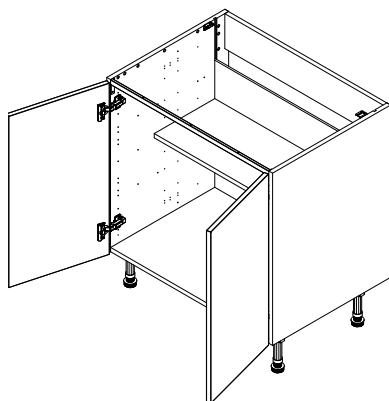

800 2 Door

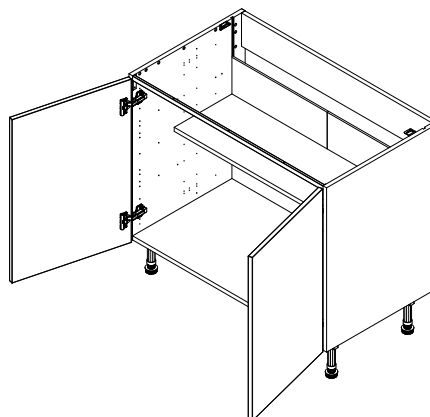

1000 2 Door

BASE UNIT

500-1000, Sink Hob 1-2 Door / 1-2 Door + Dummy Drw Assembly Guide



BEFORE YOU START

INSTALLATION SHOULD BE PERFORMED BY A COMPETENT PERSON ONLY.

THIS PRODUCT COULD BE DANGEROUS IF INCORRECTLY INSTALLED

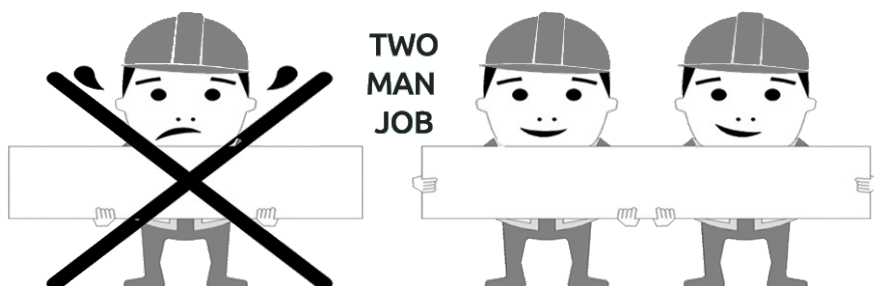

NOT to be used with
CAM LOCK

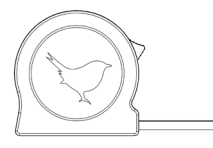
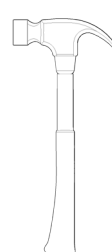

BASE UNIT

500-1000, Sink Hob 1-2 Door / 1-2 Door + Dummy Drw Assembly Guide

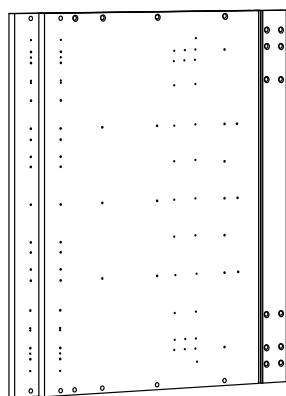

Panel A
x2 End Panel

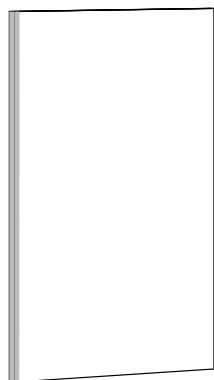

Panel B
x1 Back Panel
(800-1000 Folded)

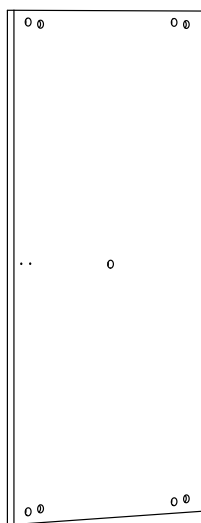

Panel C
x1 Fixed Shelf

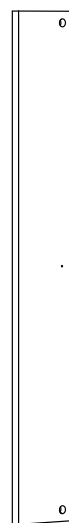

Panel D
x1 Rail



Shelf
x1 Loose Shelf

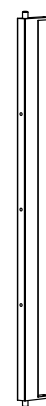

Rail
x1 Metal Rail

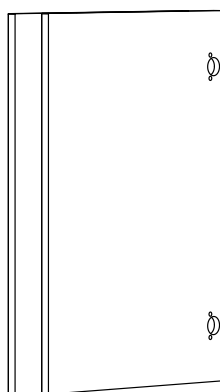

Frontal
x1 or 2 as req'd
(Packed Separately)

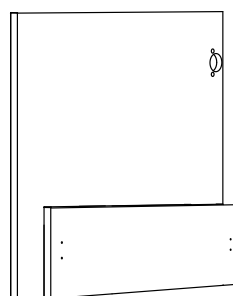

Frontal + Dummy Drawer
(Frontal + Dummy Drw Option)
x1 or 2 as req'd
(Packed Separately)

BASE UNIT

500-1000, Sink Hob 1-2 Door / 1-2 Door + Dummy Drw Assembly Guide

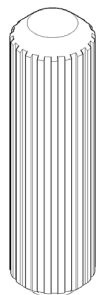

(F) x8
Wooden Dowel

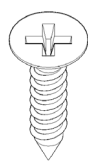

(L) x26
15mm Screw

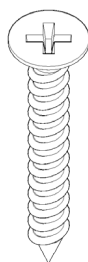

(K) x8
30mm Screw

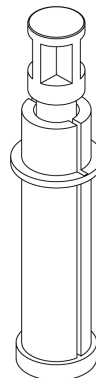

(G) x6
Cam Dowel (Expanding)

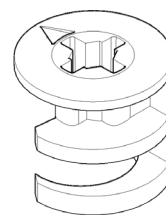

(H) x6
Cam Lock

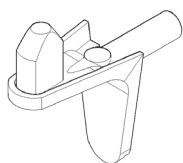

(Z) x4
Shelf Peg Metal



(M) x4
Cover Sticker

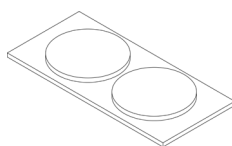

(N) x2
Door Buffer

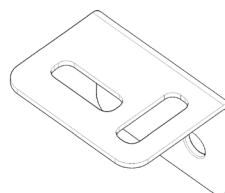

L Bracket
x2

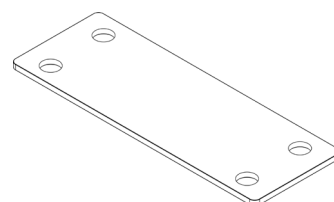

(U) x2
Fixing Plate Inc Screws

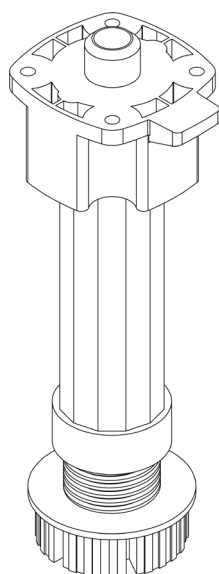

Leg

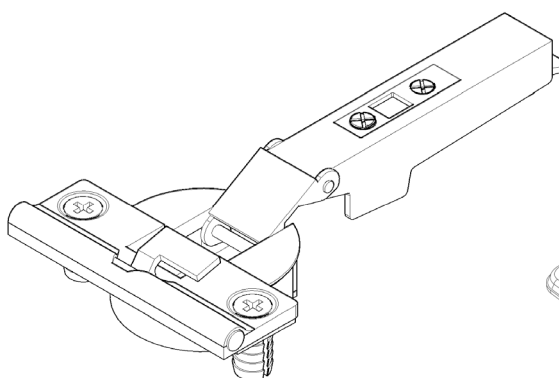

Hinge
Inc Screws & Cover Plate

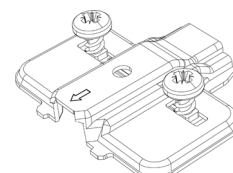

Hinge Mounting Plate
Inc Screws

BASE UNIT

500-1000, Sink Hob 1-2 Door / 1-2 Door + Dummy Drw Assembly Guide

Step 1.

Seat dowels (F) into holes in both end panels (A) as shown.

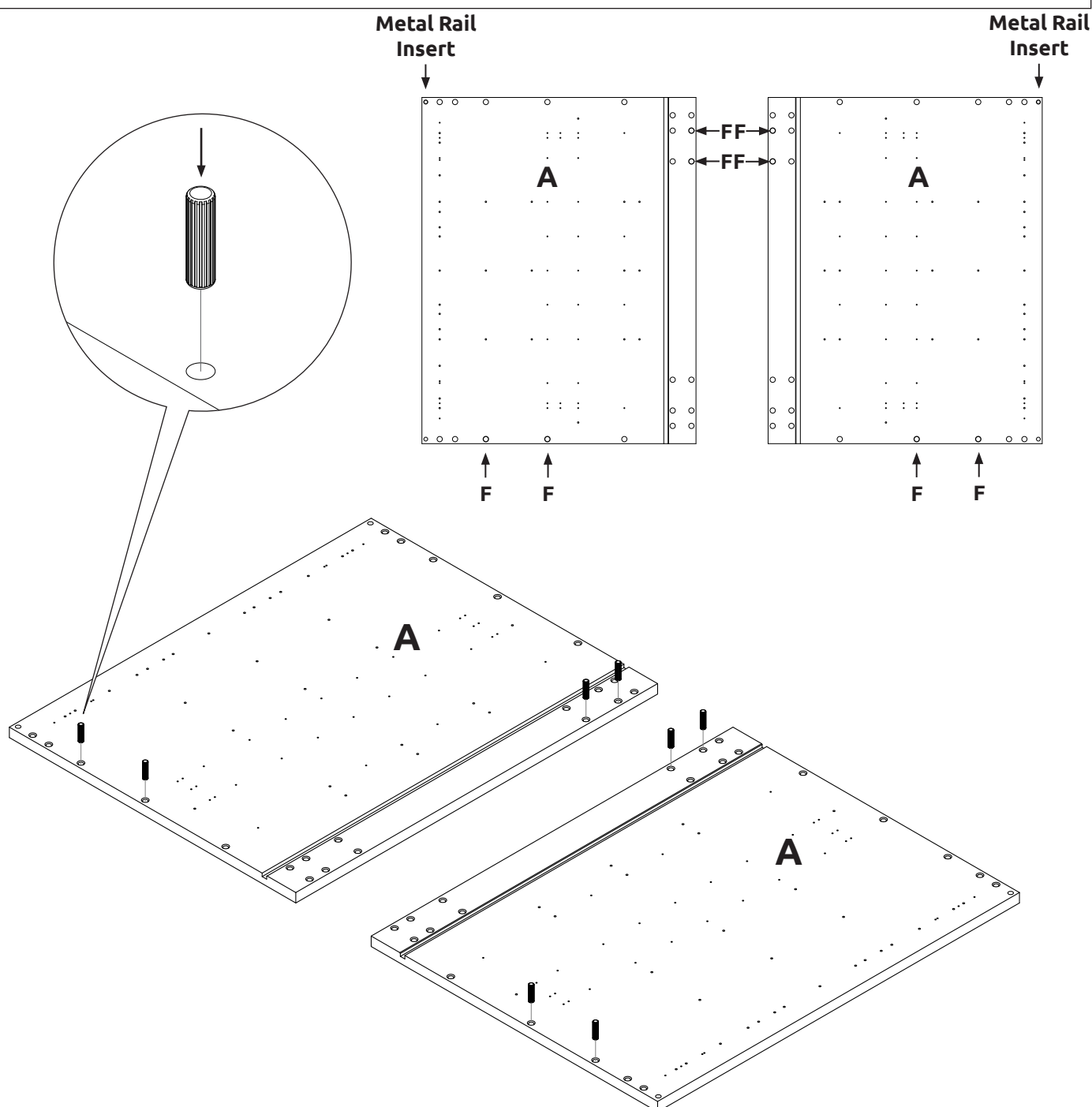
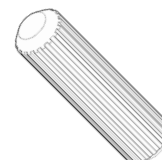

BASE UNIT

500-1000, Sink Hob 1-2 Door / 1-2 Door + Dummy Drw Assembly Guide

Step 2.

Seat expanding cam dowels (**G**) into holes in both end panels (**A**) as shown.

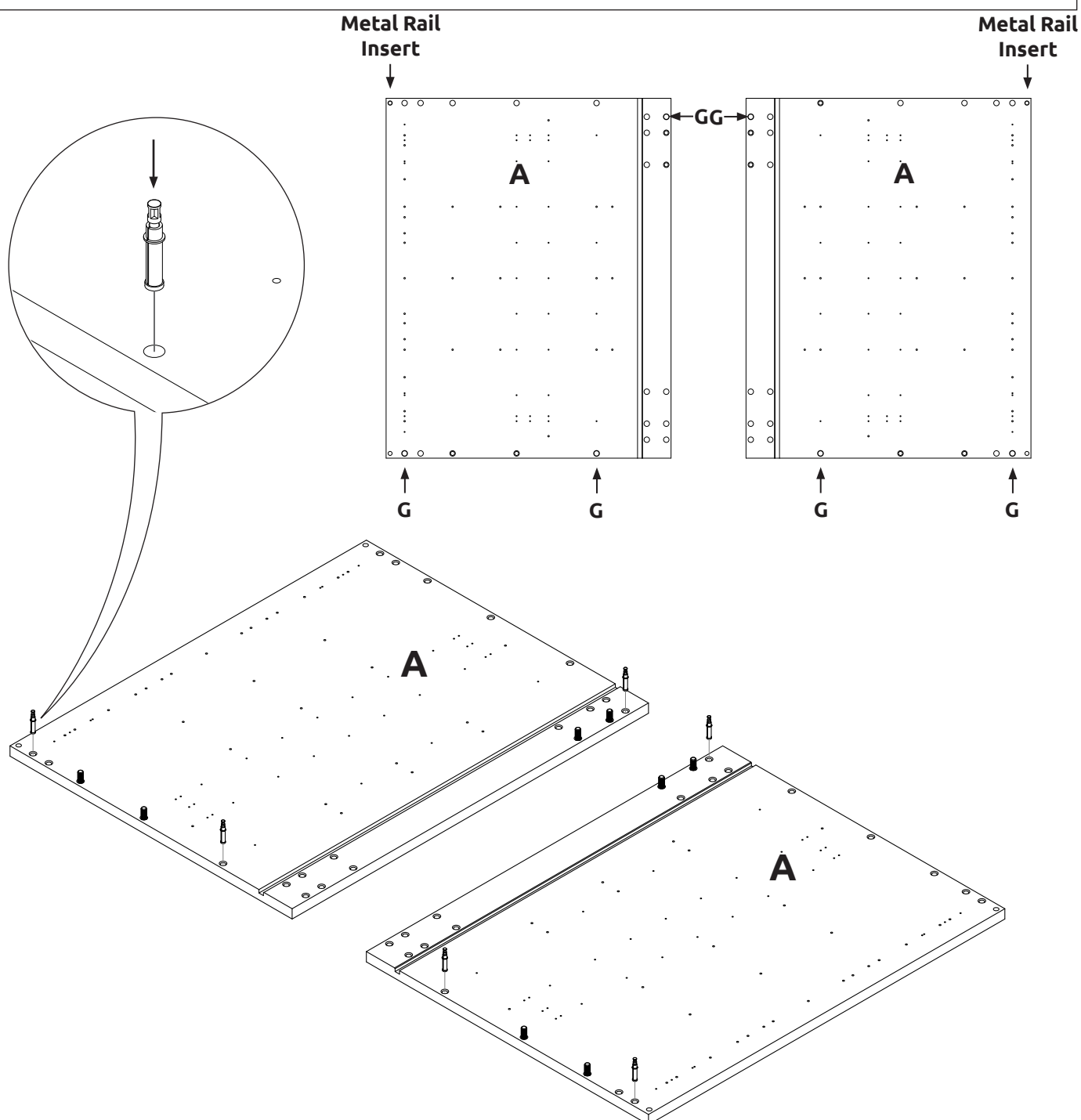
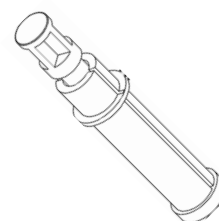

BASE UNIT

500-1000, Sink Hob 1-2 Door / 1-2 Door + Dummy Drw Assembly Guide

Step 3.

Attach panel **(C)** & metal rail to panels **(A)** using expanding cam dowels **(G)**, and wooden dowels **(F)** in positions as shown. Secure metal rail with 2 x 15mm screws **(L)** into panels **(A)**.



All cam lock **(H)** holes are to be positioned facing the outside of the unit carcass, for ease of tightening.

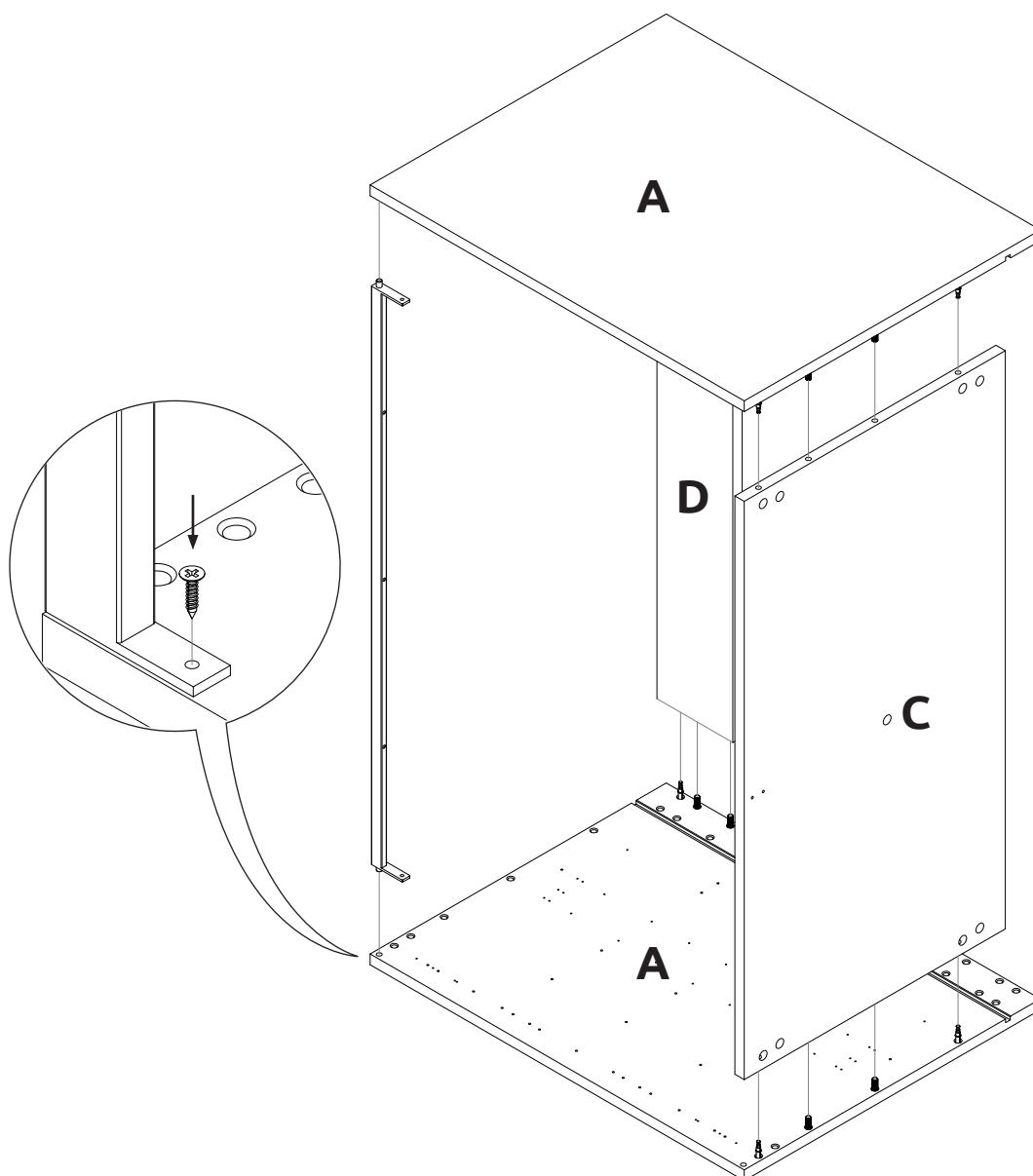

BASE UNIT

500-1000, Sink Hob 1-2 Door / 1-2 Door + Dummy Drw Assembly Guide

Step 4.

Slide back panel **(B)** into groove of end panels **(A)**. Once back panel **(B)** is in position, ensure the panel is flush & square with bottom of end panels.

The back panel **(B)** is to be modified accordingly to suit customer requirements, prior to inserting into unit.

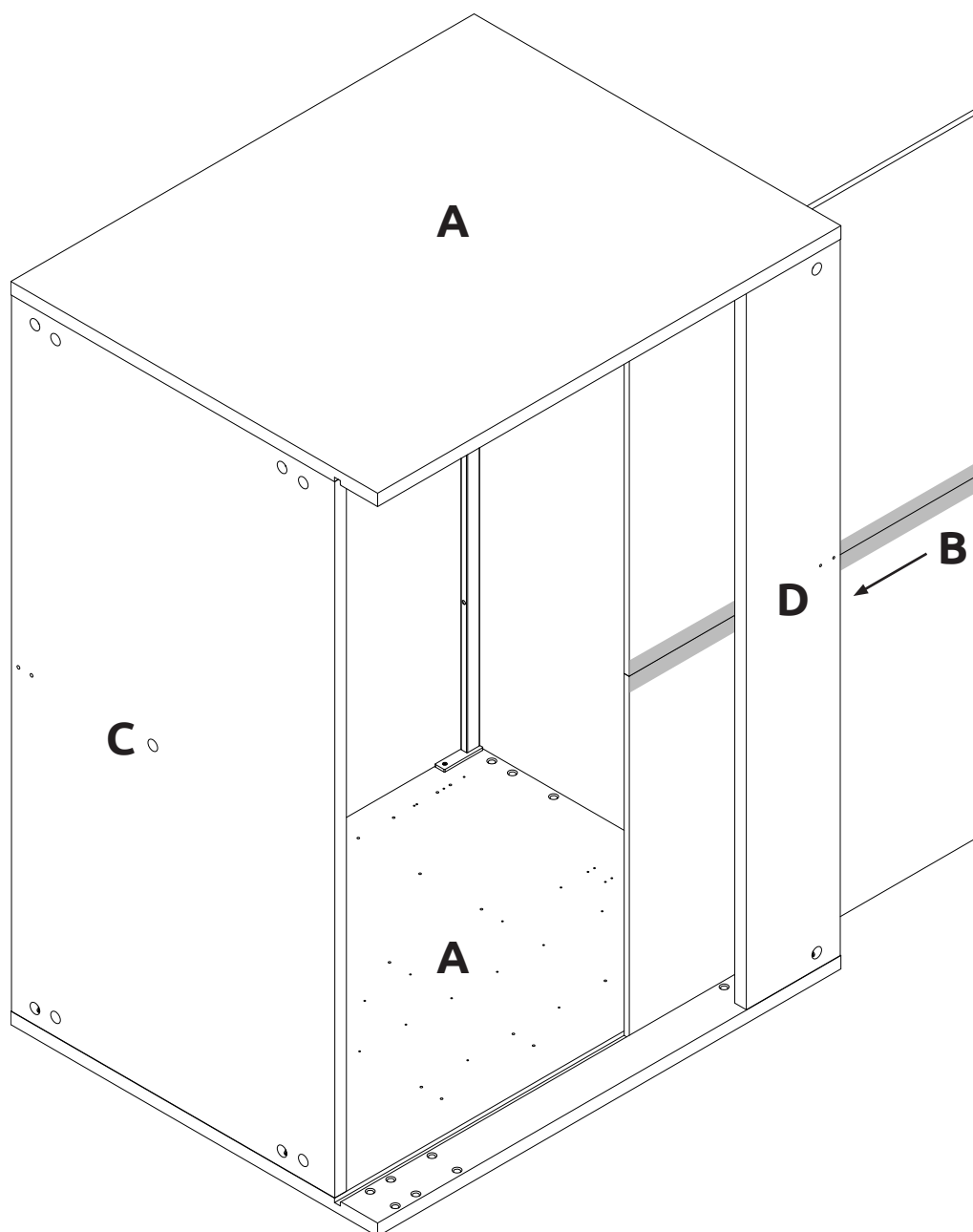

BASE UNIT

500-1000, Sink Hob 1-2 Door / 1-2 Door + Dummy Drw Assembly Guide

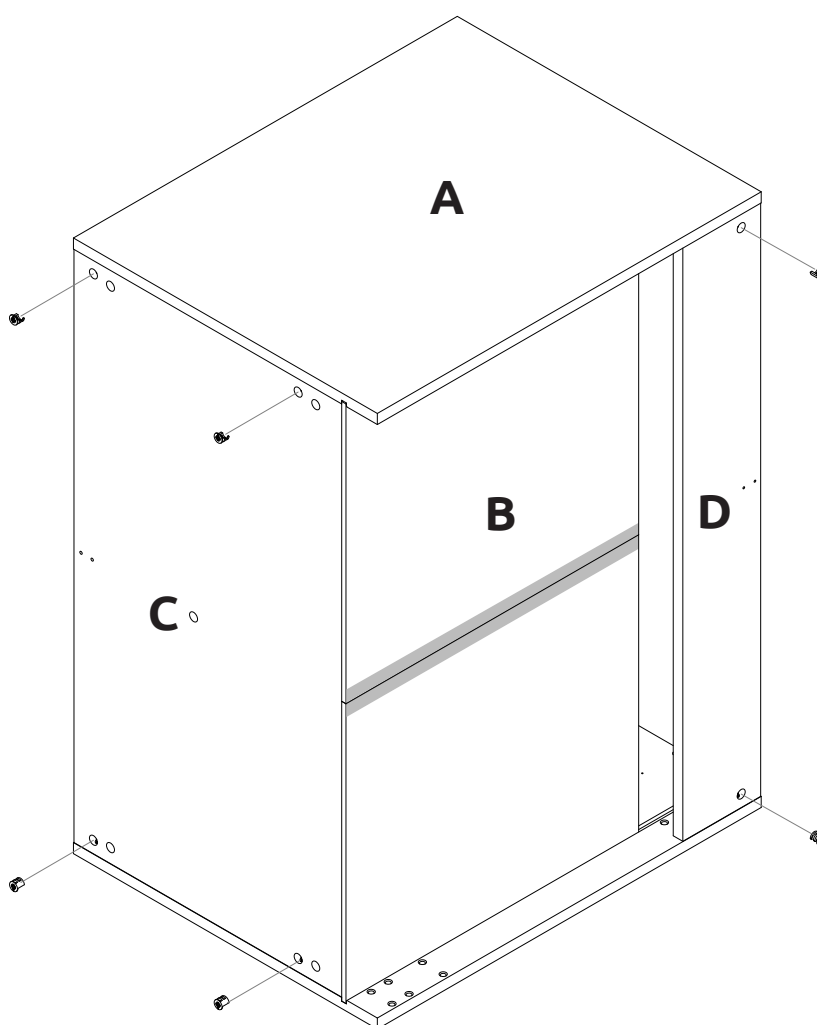
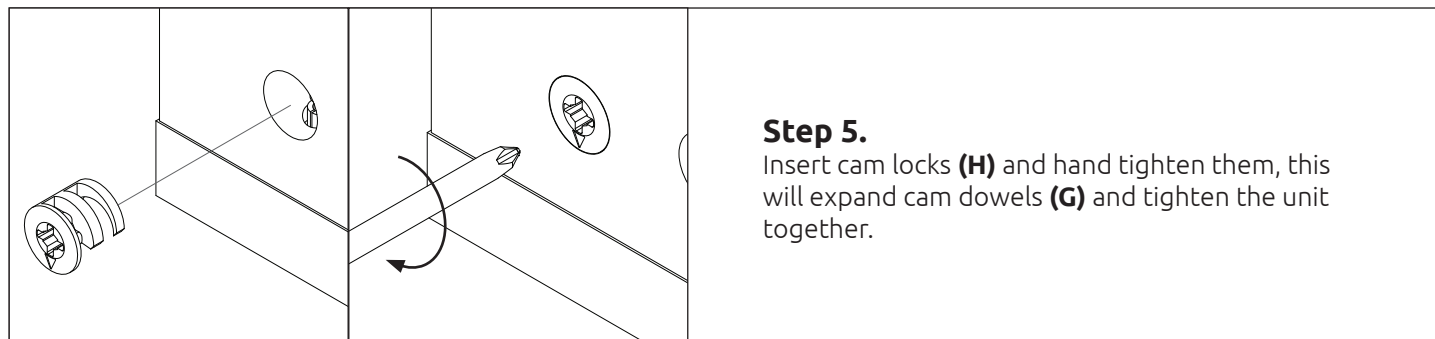

Do **not** use power tools with cam lock **(H)**

BASE UNIT

500-1000, Sink Hob 1-2 Door / 1-2 Door + Dummy Drw Assembly Guide

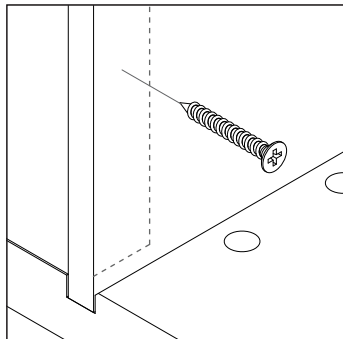

Step 6.

Ensure the unit is square. Secure back panel **(B)** with 4 x 30mm screws **(K)** equally spaced at the bottom of back panel **(B)** into base panel **(C)**, as shown. Ensure you screw into the centre of the base panel **(C)** (9mm from the edge).

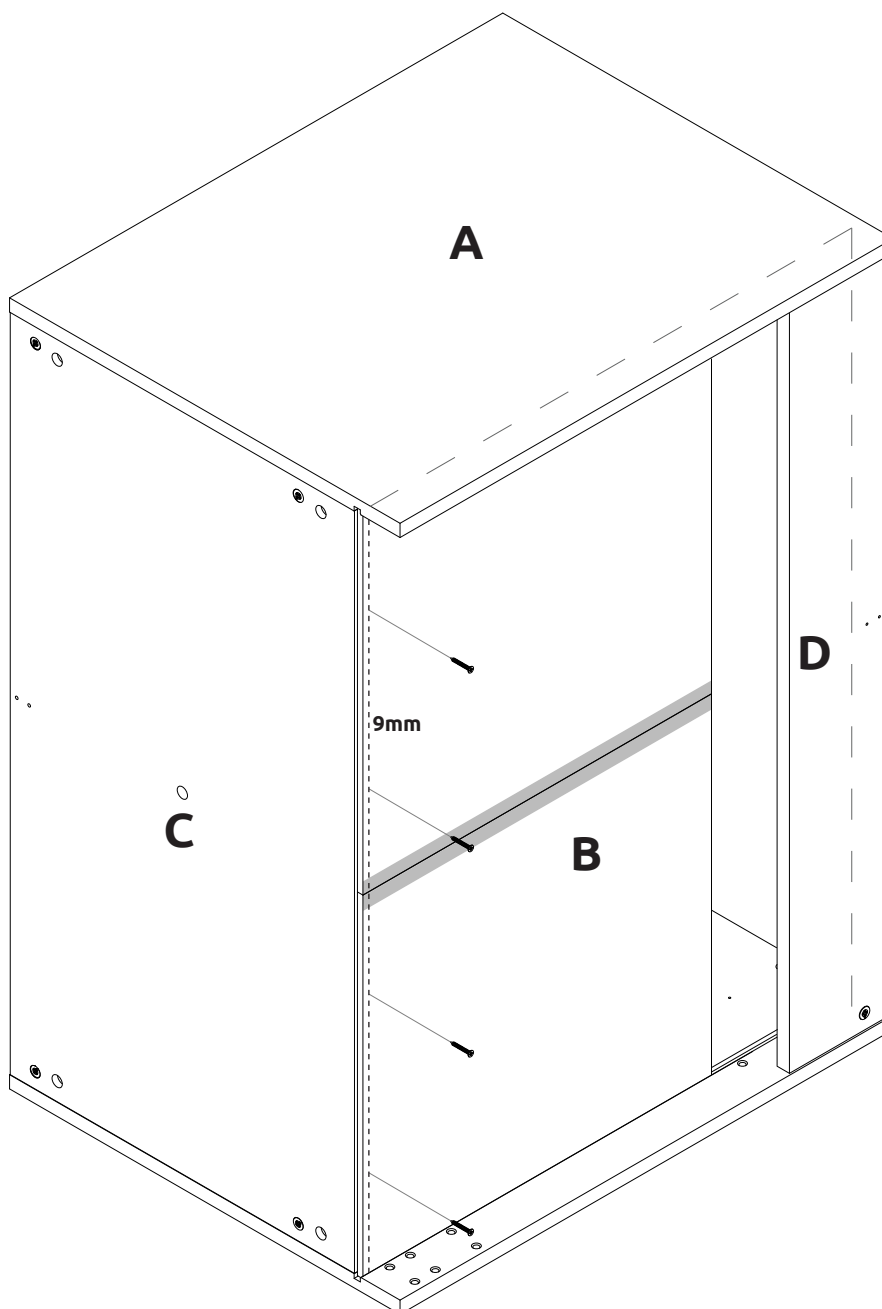

BASE UNIT

500-1000, Sink Hob 1-2 Door / 1-2 Door + Dummy Drw Assembly Guide

Step 7.

Position legs as shown on the diagram below. Ensure legs are rotated to also provide support to the end panels (**A**). Once positioned, secure each of the legs into place with 4 x 15mm screws (**L**) per leg. Push leg firmly down into leg base. Adjust legs to **155mm** before turning unit upright. Once in situ level accordingly.

500-600 width = 4x leg

700-1000 width = 5x leg

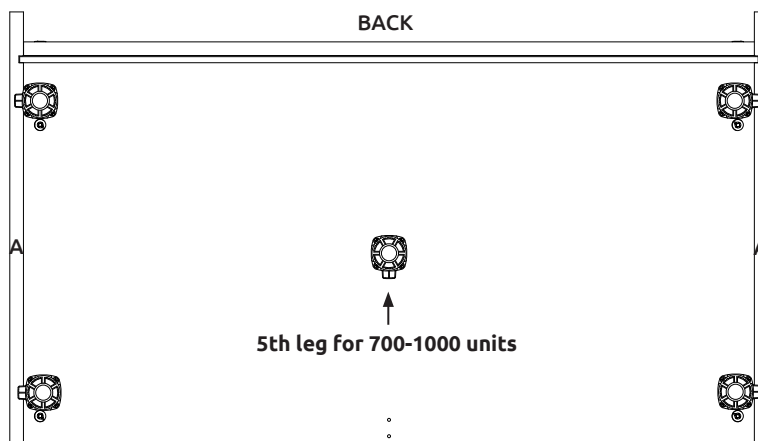
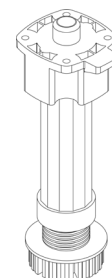

LEG POSITIONS - UNDERSIDE VIEW

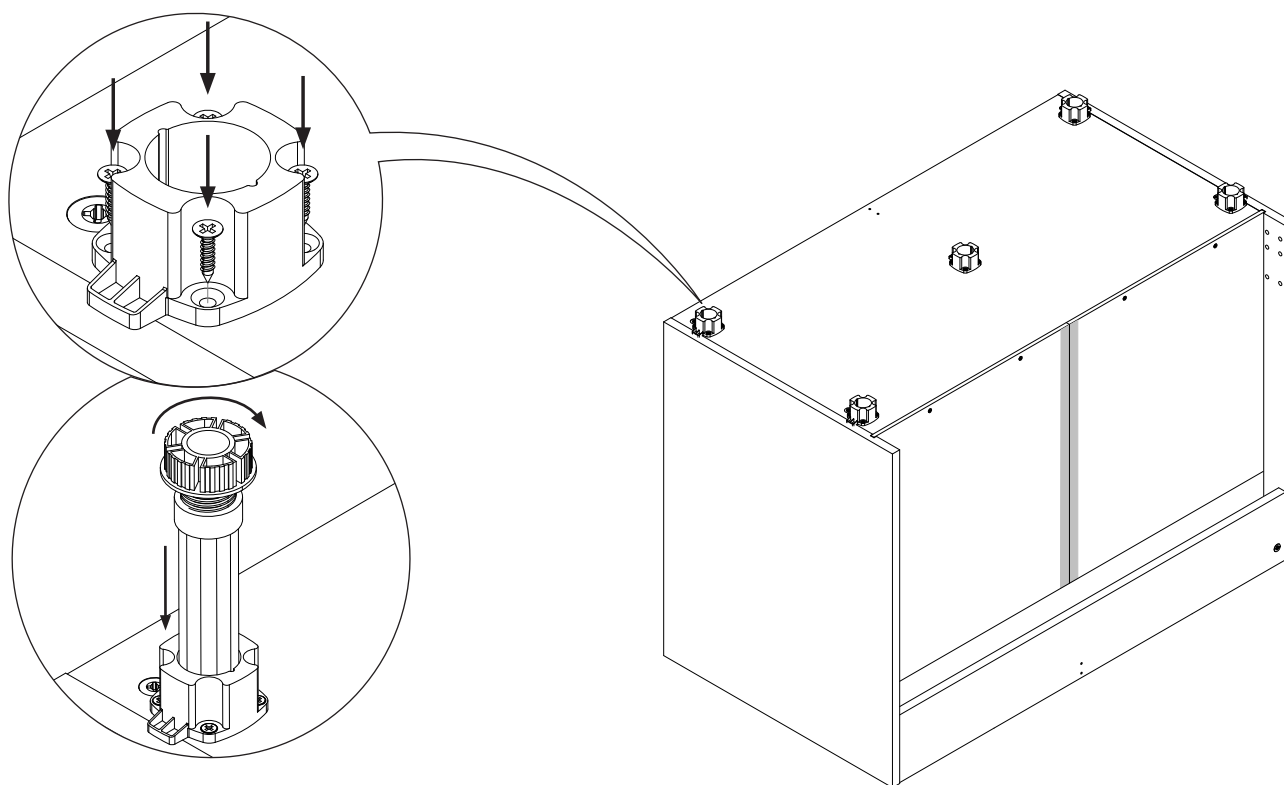

BASE UNIT

500-1000, Sink Hob 1-2 Door / 1-2 Door + Dummy Drw Assembly Guide

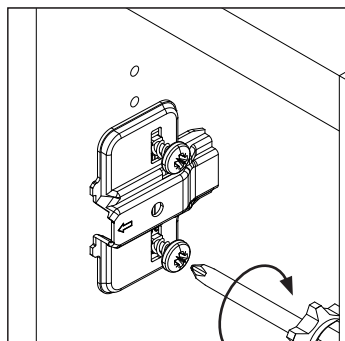

Step 8.

Attach hinge plates onto both end panels **(A)** as shown, using 2 screws already located in hinge plates.

Hinge to be mounted in accordance to customer specific kitchen plan.

DUMMY DRAWER SPECIFIC

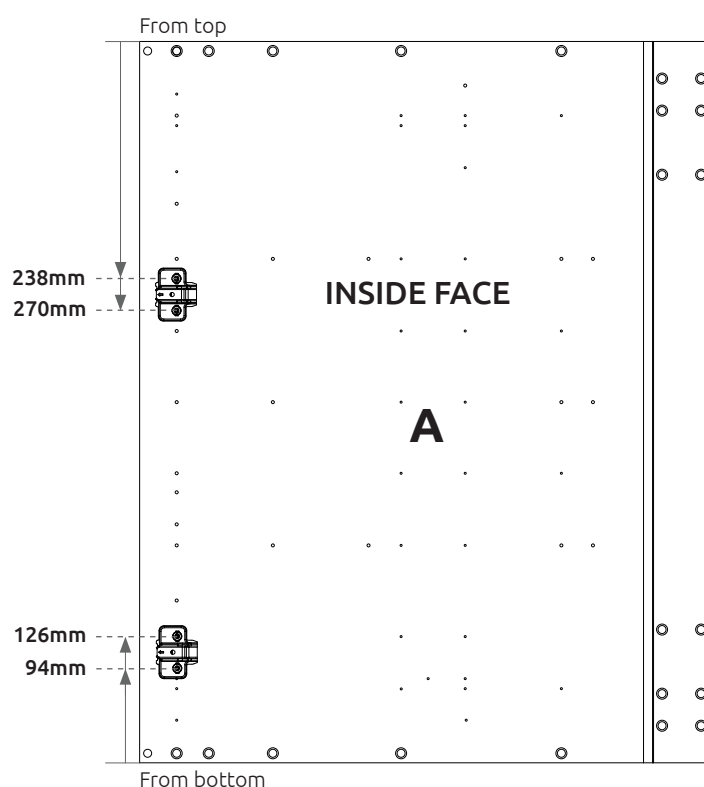
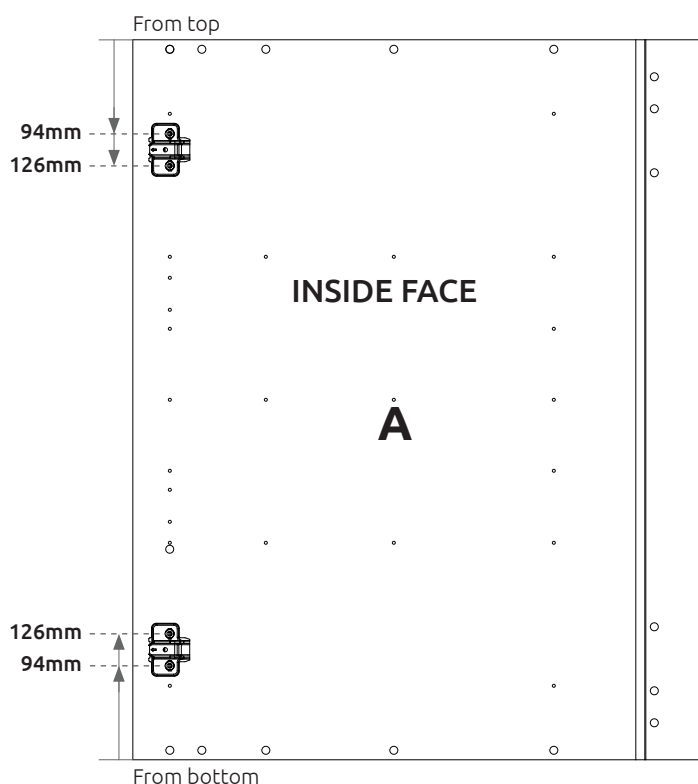

BASE UNIT

500-1000, Sink Hob 1-2 Door / 1-2 Door + Dummy Drw Assembly Guide



Screws for attaching to walls and worktops are **not provided** as these vary depending on materials, thickness and construction. Ensure appropriate fixings for wall and worktop construction are used. Please refer to the specialist worktop supplier if these are required for solid surface worktops.

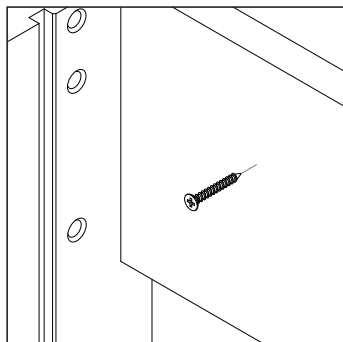

Step 9.

Ensure the unit is positioned correctly and level. Screw through the back rail into the wall to secure the unit in place.

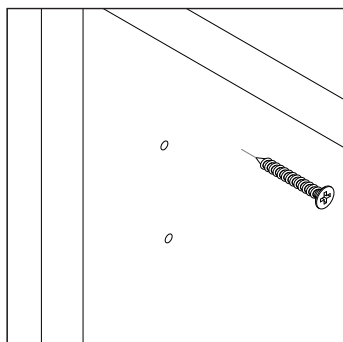

Step 10.

Screw into any side units using 30mm screws **(K)** provided to secure to unit. Screw at the top and bottom of both sides of the unit, place cover stickers **(M)** on the heads to conceal them.

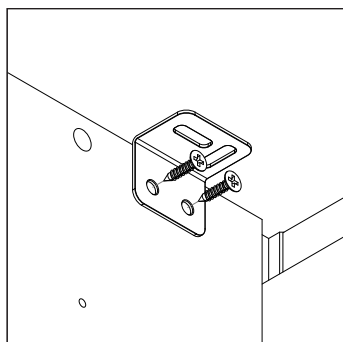

Step 11.

Use 2 x 15mm screws **(L)** to secure each of the L brackets to the top rear of the unit on both sides.

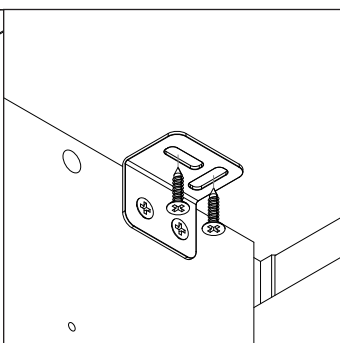
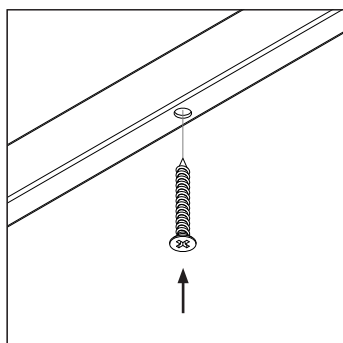

Step 12.

Screw up through the front metal rail and the L brackets into the worktop to secure it in place.

BASE UNIT

500-1000, Sink Hob 1-2 Door / 1-2 Door + Dummy Drw Assembly Guide

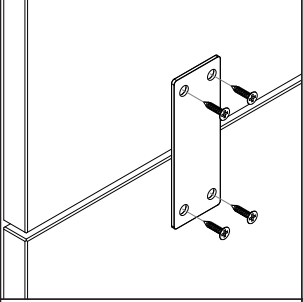
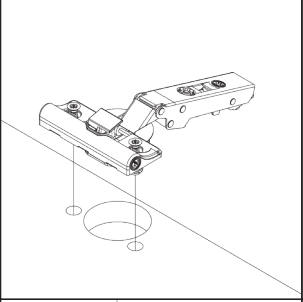
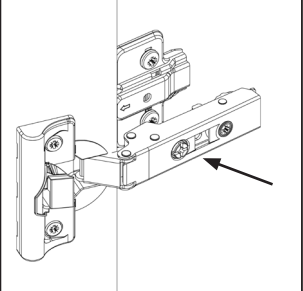
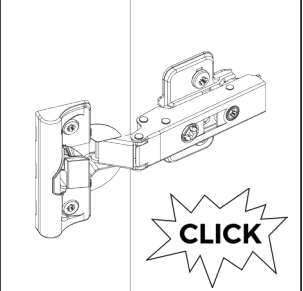
	FRONTAL AND HINGE ATTACHMENT Dummy Drawer Attachment Only Align doors to join together using 2 x fixing plates (U) to the back of both frontals. Ensure a 4mm gap is maintained between each frontal once fixed together. Screw in place using 4 x 15mm screws (L) per fixing plate. Continue to Step 1 for door frontal attachment.	
	Step 1. Insert hinges into frontal hinge holes provided, secure hinges with the 2 x screws already located in the hinges.	
		Step 2. Attach the door to unit, clip hinges onto hinge plates and click to secure.

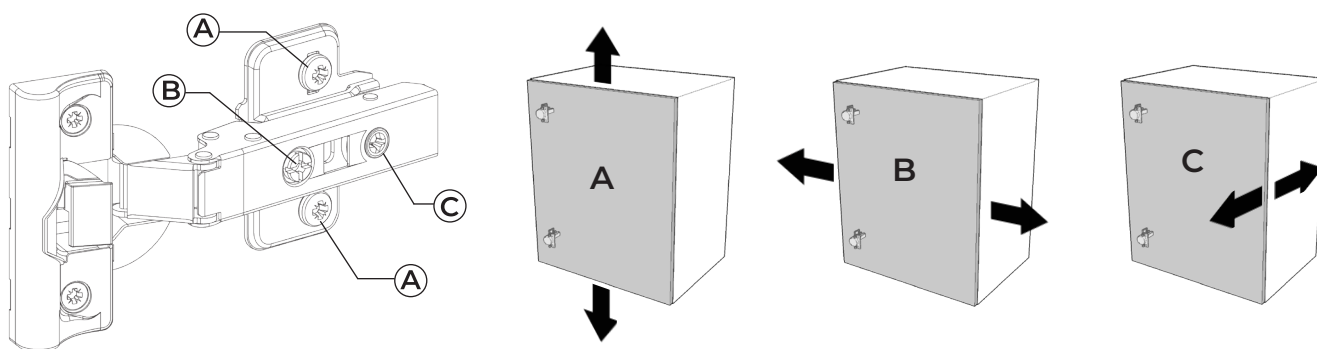

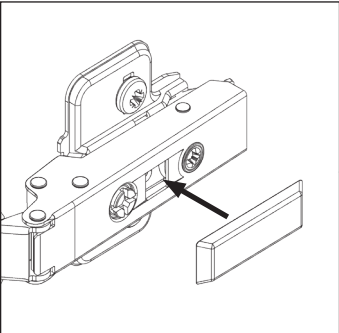
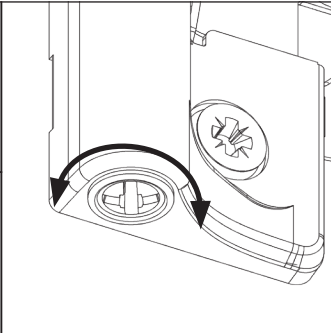
	Step 3. Adjust hinges to suit, using the highlighted screw(s) shown.	
	Step 4. Fit cover caps to hinges and adjust soft-close to suit.	



The top and bottom hinges **MUST** be adjusted to the **SAME STRENGTH**.



wren

BASE UNIT

500-1000, Sink Hob 1-2 Door / 1-2 Door + Dummy Drw Assembly Guide

wren