

# BASE UNIT

## 300-600, 1 Door / 1 Door + 1 Drw Assembly Guide

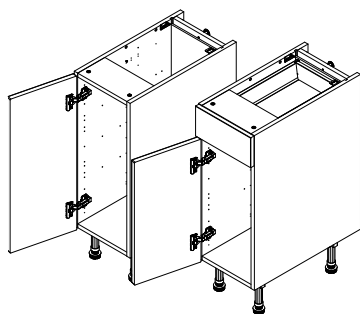

**300 1 Dr / 1Dr + 1 Drw**

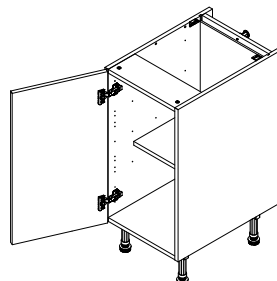

**400 1 Dr**

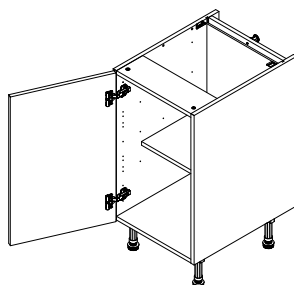

**450 1 Dr**

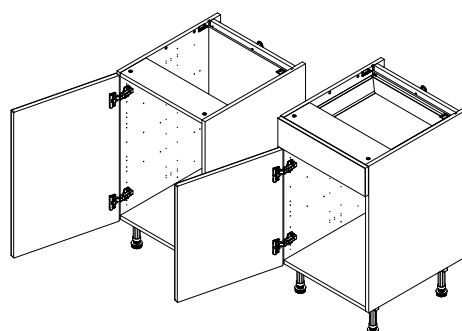

**500 1 Dr / 1Dr + 1 Drw**

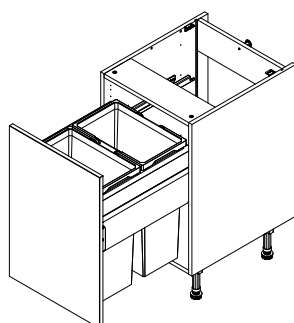

**500 Bin Base Unit**  
(with lids)

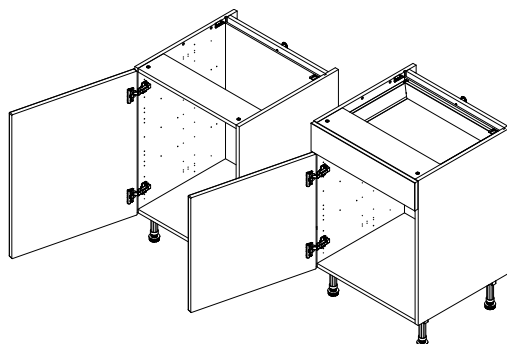

**600 1 Dr / 1Dr + 1 Drw**

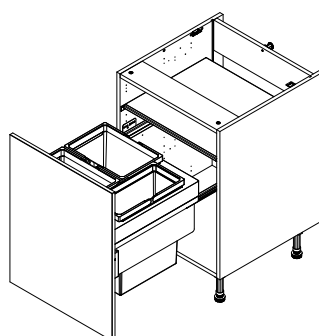

**600 Bin Base Unit**  
(with metal shelf)



NON-DRAWER OPTION SHOWN THROUGHOUT FOR ILLUSTRATION PURPOSES

# BASE UNIT

300-600, 1 Door / 1 Door + 1 Drw Assembly Guide



## BEFORE YOU START

INSTALLATION SHOULD BE PERFORMED BY A COMPETENT PERSON ONLY.

THIS PRODUCT COULD BE DANGEROUS IF INCORRECTLY INSTALLED

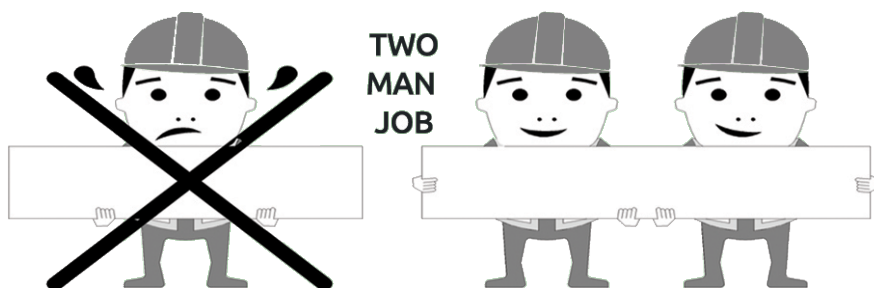

TWO  
MAN  
JOB



PROTECT  
AGAINST  
DAMAGE



NOT to be used with  
CAM LOCK

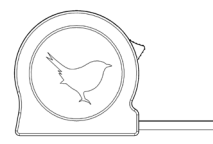
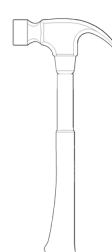

# BASE UNIT

300-600, 1 Door / 1 Door + 1 Drw Assembly Guide

## DRAWER LINE SPECIFIC

### Standard Drawer (Packed Separately)

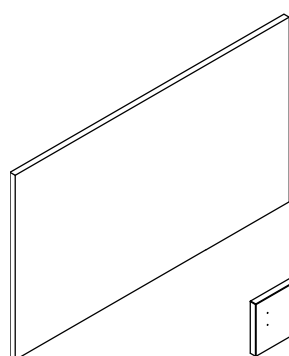

**Drawer Base**  
x1 Drawer Base Panel

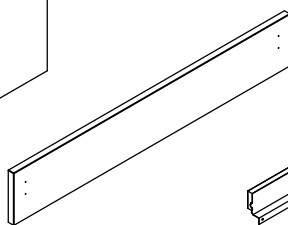

**Frontal**  
x1 Front Panel  
(Packed Separately)

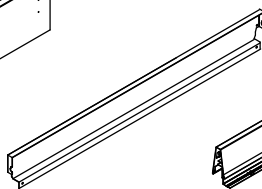

**Back Panel**  
x1 Metal Back Panel  
(Small)

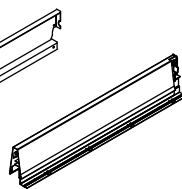

**Drawer Side**  
x1 Left Hand

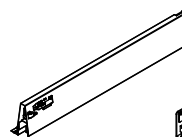

**Drawer Side**  
x1 Right Hand

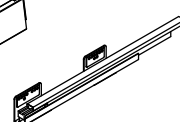

**Drawer Runner**  
x1 Left Hand

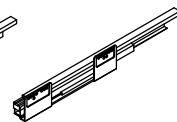

**Drawer Runner**  
x1 Right Hand



**(J) x16**  
16mm  
Screw

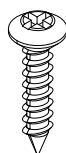

**(Q) x4**  
21mm  
Screw

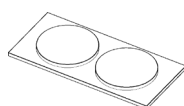

**(N) x1**  
Door Buffer

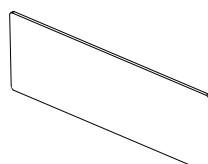

**Drawer Cover Cap**  
x2

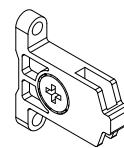

**Drawer Front Fixing**  
x2

# BASE UNIT

## 300-600, 1 Door / 1 Door + 1 Drw Assembly Guide

### DRAWER LINE SPECIFIC

#### Step 1.

Seat the edge of drawer base tight into the corner of the drawer side, as shown. The decorative face of drawer base to be positioned at the front of the drawer. Secure drawer base to drawer side using 4 x 16mm screws (J) in holes provided. Repeat on both sides of the drawer.

Decorative face

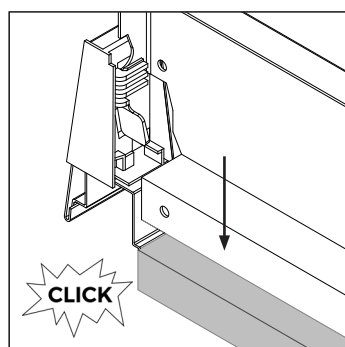
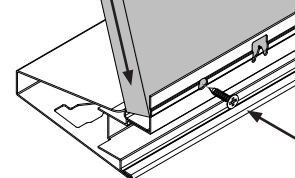

#### Step 2.

Clip metal back panel into the rear of the drawer sides and secure in position using 2 x 16mm screws (J) into drawer base in holes provided.

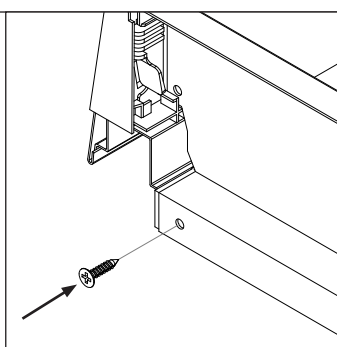

#### Step 3.

Secure **drawer side fixing clips** using 2 x 21mm screws (Q) in pilot holes provided on the frontal, as shown. Attach drawer frontal to drawer box by pushing drawer side fixing clips into drawer sides.

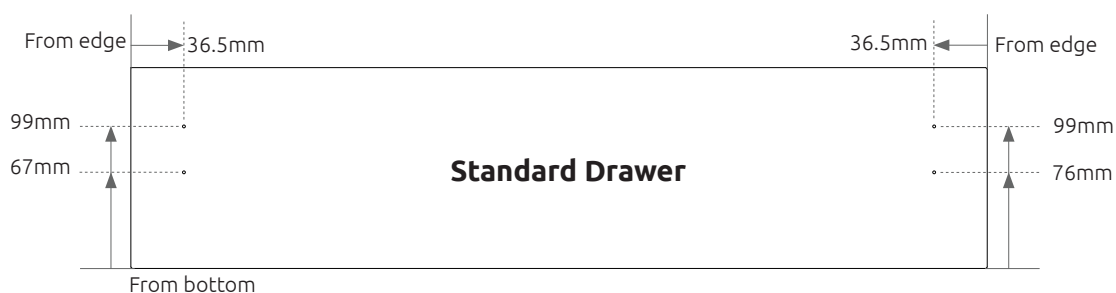
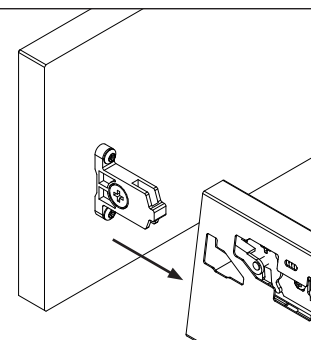
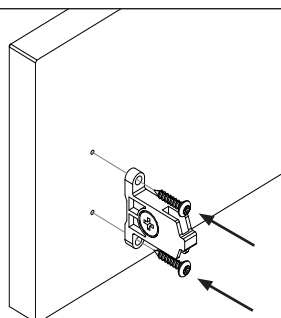

# BASE UNIT

## 300-600, 1 Door / 1 Door + 1 Drw Assembly Guide

### DRAWER ADJUSTMENT

#### Left and Right Adjustment

Turn screw shown to **adjust** drawer frontal **left & right**.



Drawer adjustments to be done on both sides.

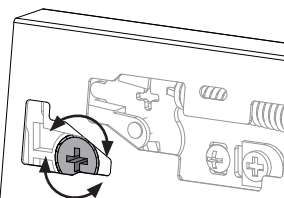

#### Up & Down Adjustment

Turn screw shown to **adjust** drawer frontal **up & down**.

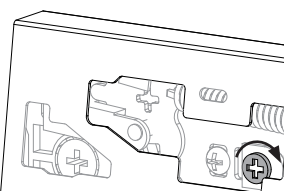

#### Lock Position

Tighten screw shown to lock in position.

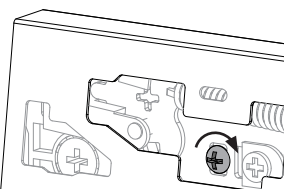

#### Remove Frontal

To remove the frontal, release the fixing clip by turning the locking plate screw shown.

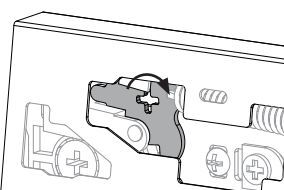

#### Cover Caps

Fit drawer cover caps over drawer side adjustment.

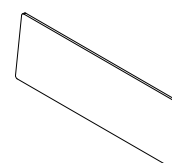

# BASE UNIT

## 300-600, 1 Door / 1 Door + 1 Drw Assembly Guide

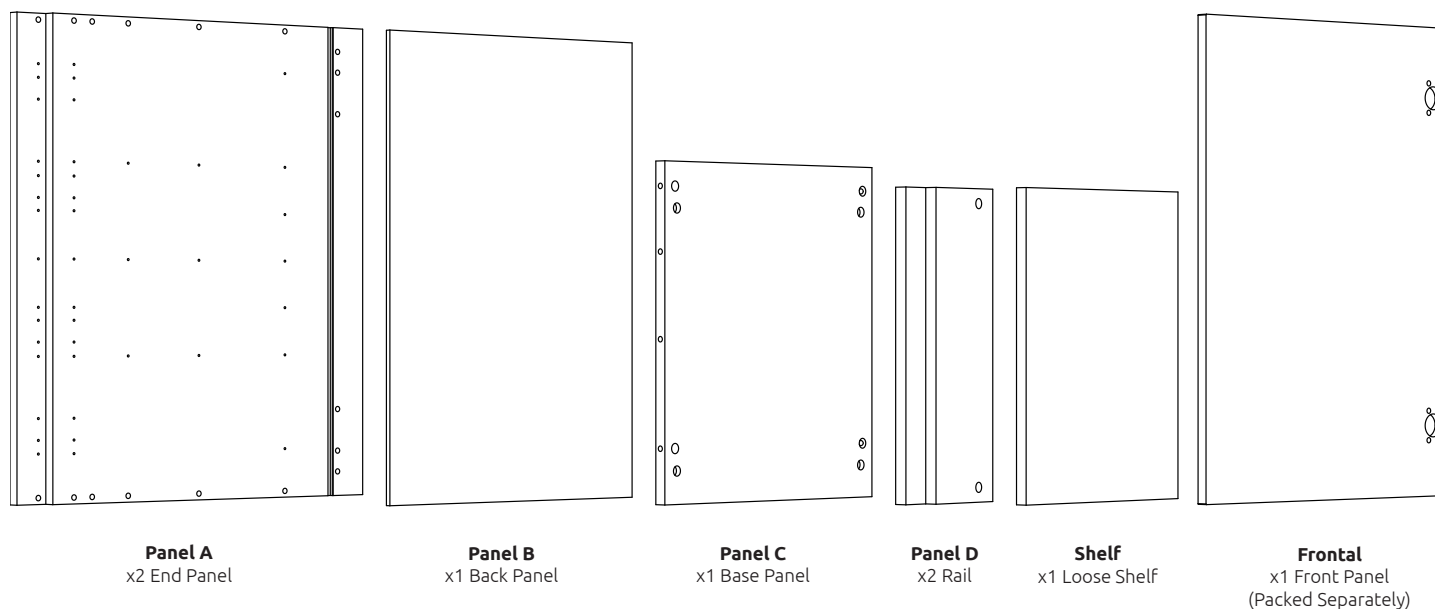

# BASE UNIT

## 300-600, 1 Door / 1 Door + 1 Drw Assembly Guide

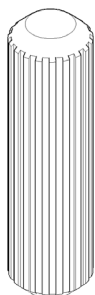

**(F) x12**  
Wooden  
Dowel

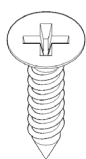

**(L) x28**  
15mm  
Screw

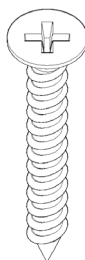

**(K) x7**  
30mm  
Screw

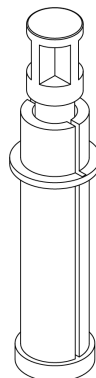

**(G) x8**  
Cam Dowel  
(Expanding)

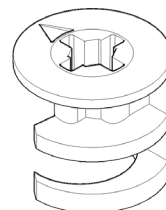

**(H) x8**  
Cam Lock

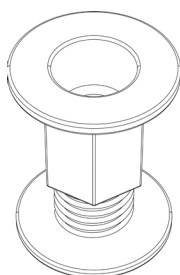

**Space Plug**  
x1

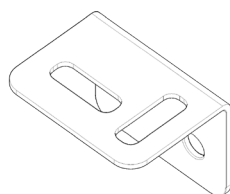

**L Bracket**  
x2

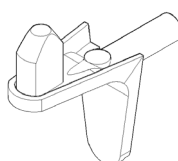

**(Z) x4**  
Shelf Peg Metal



**(M) x4**  
Cover Sticker

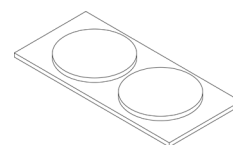

**(N) x1**  
Door Buffer

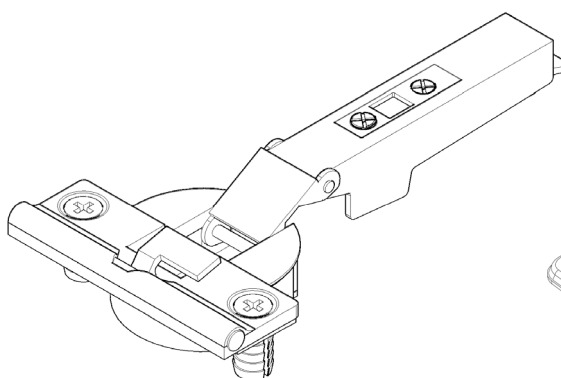
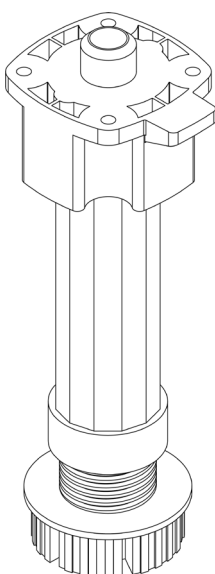

**Hinge**  
Inc Screws & Cover Plate

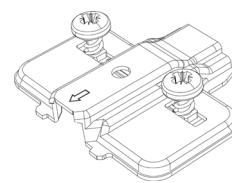

**Hinge Mounting Plate**  
Inc Screws

# BASE UNIT

## 300-600, 1 Door / 1 Door + 1 Drw Assembly Guide

### Step 1. DRAWER LINE SPECIFIC (Skip to Step 2 for non- drawer line option assembly)

To attach drawer runner, screw into end panels **(A)** using 2 x 16mm screws **(J)** (provided with drawer box pack) per drawer rail, into holes provided, as shown.

Repeat **Step 1** for the other end panel **(A)**.

### Drawer runner bracket screw position

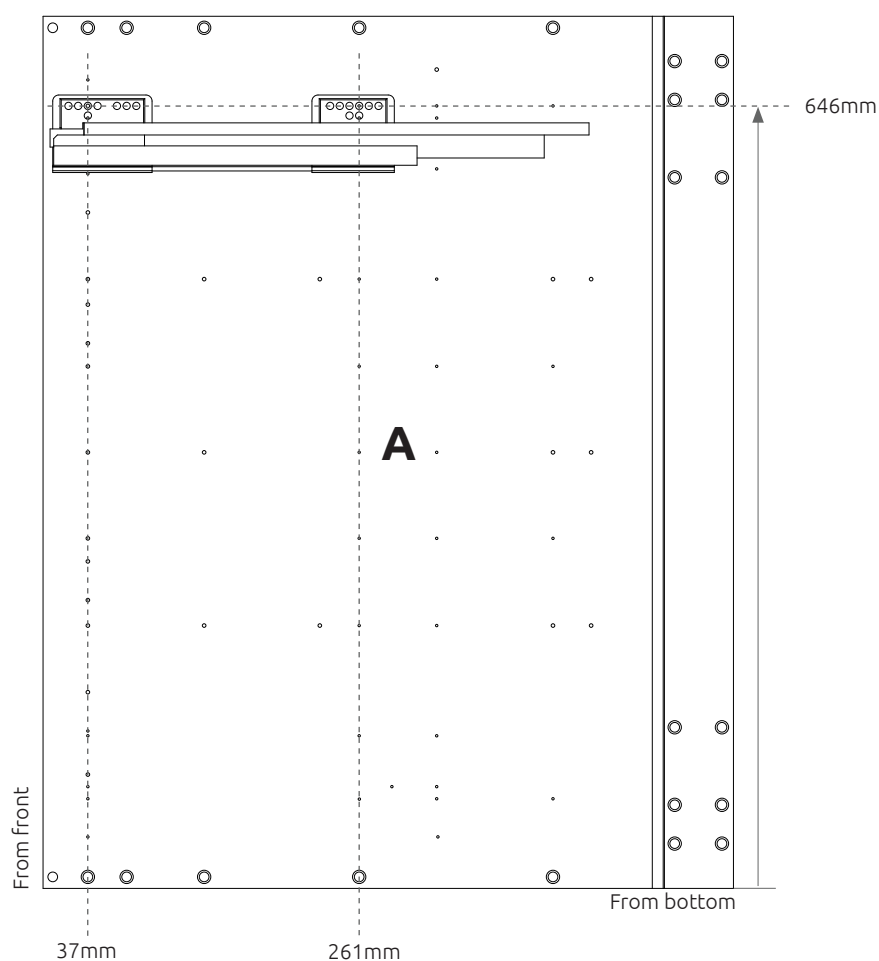
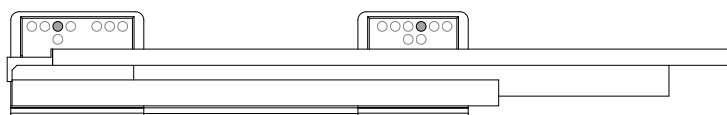



# BASE UNIT

300-600, 1 Door / 1 Door + 1 Drw Assembly Guide

## Step 2.

Seat dowels (F) into holes in both end panels (A) as shown.

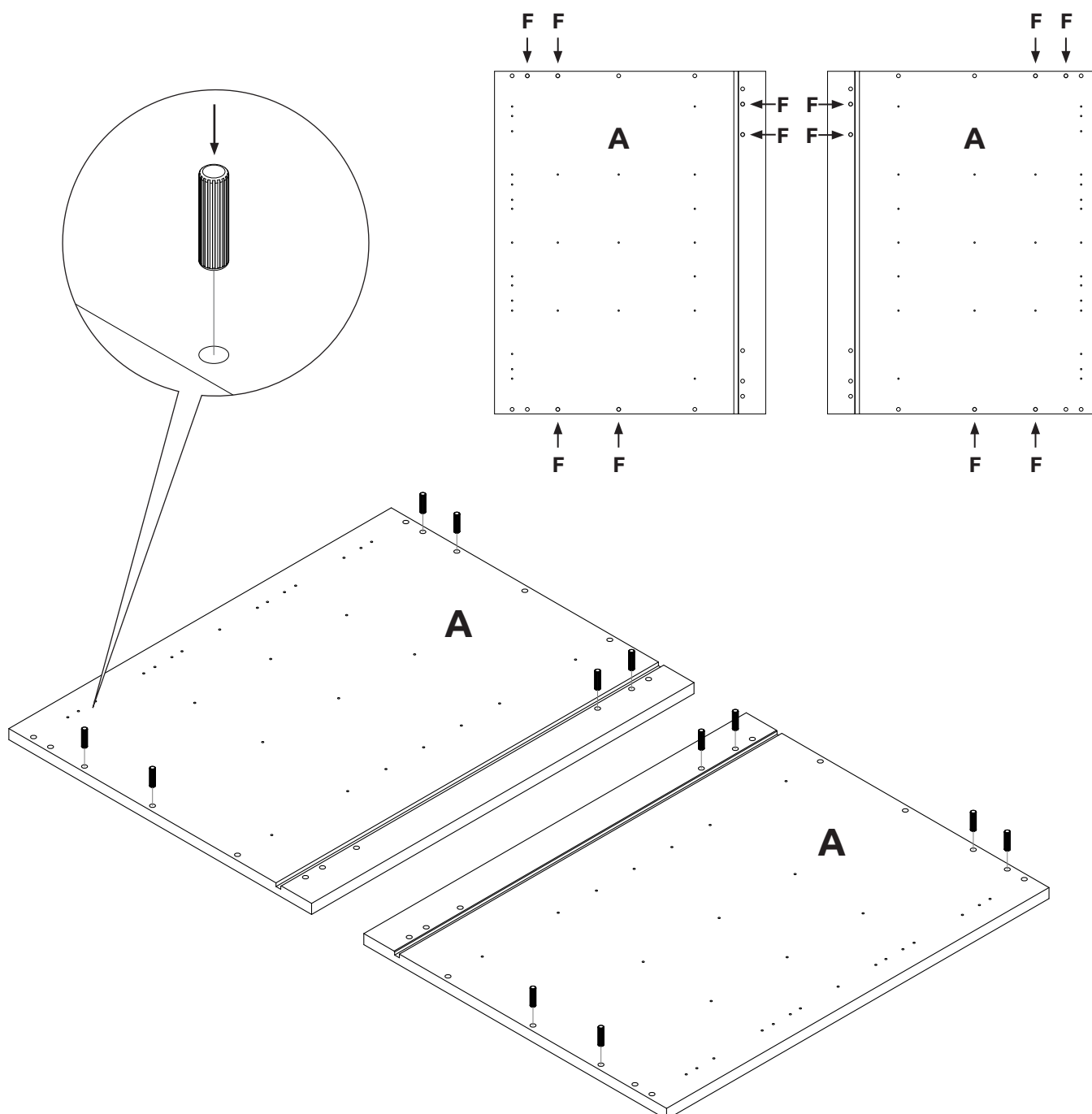
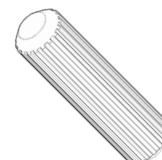

# BASE UNIT

## 300-600, 1 Door / 1 Door + 1 Drw Assembly Guide

### Step 3.

Seat expanding cam dowels **(G)** into holes in both end panels **(A)** as shown.

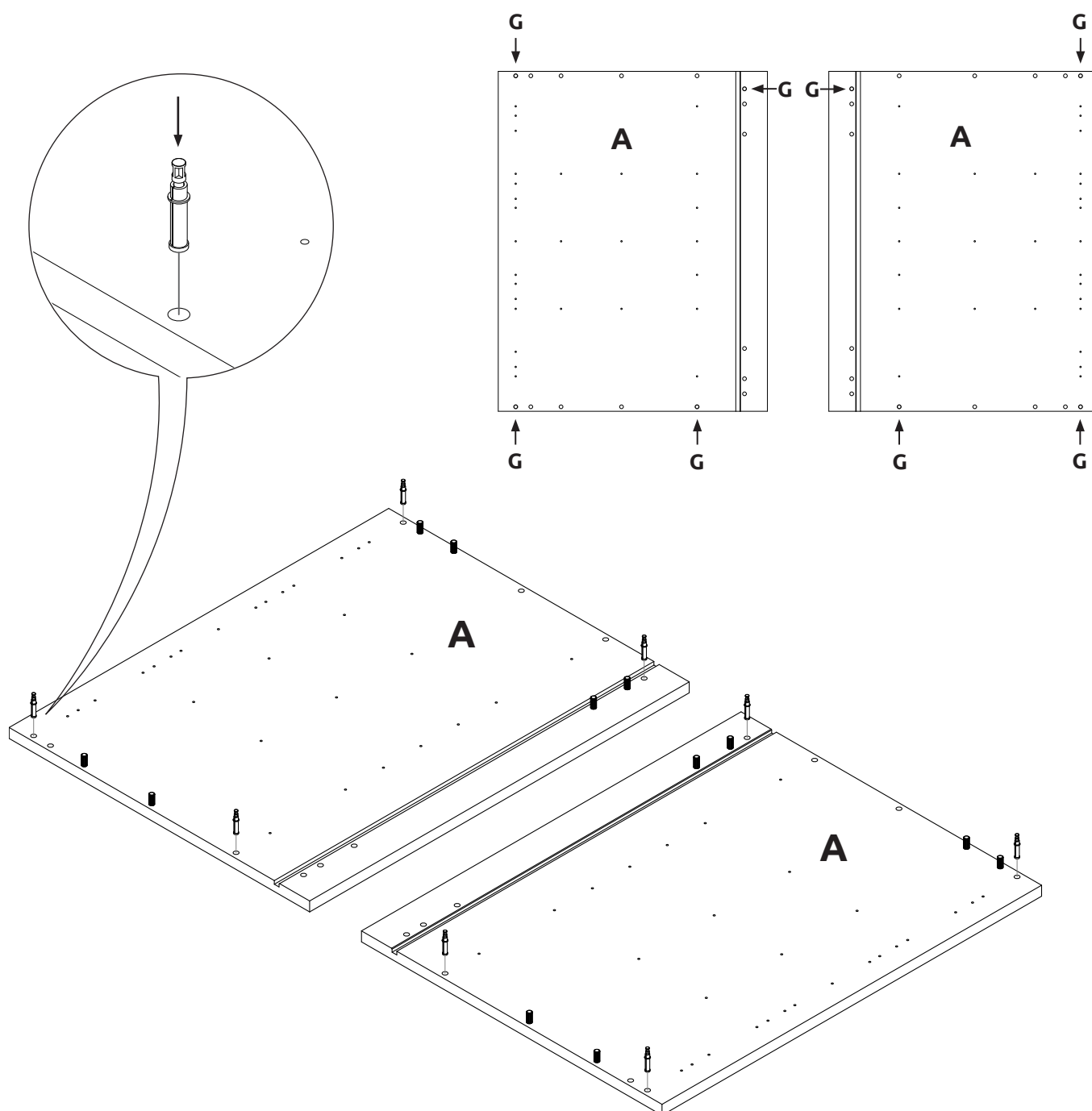
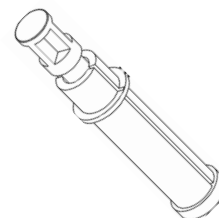

# BASE UNIT

## 300-600, 1 Door / 1 Door + 1 Drw Assembly Guide

### Step 4.

Attach panels **(C)** & **(D)** to panels **(A)**, using expanding cam dowels **(G)**, and wooden dowels **(F)** in positions as shown.



All cam lock **(H)** holes are to be positioned facing the outside of the unit carcass, for ease of tightening.

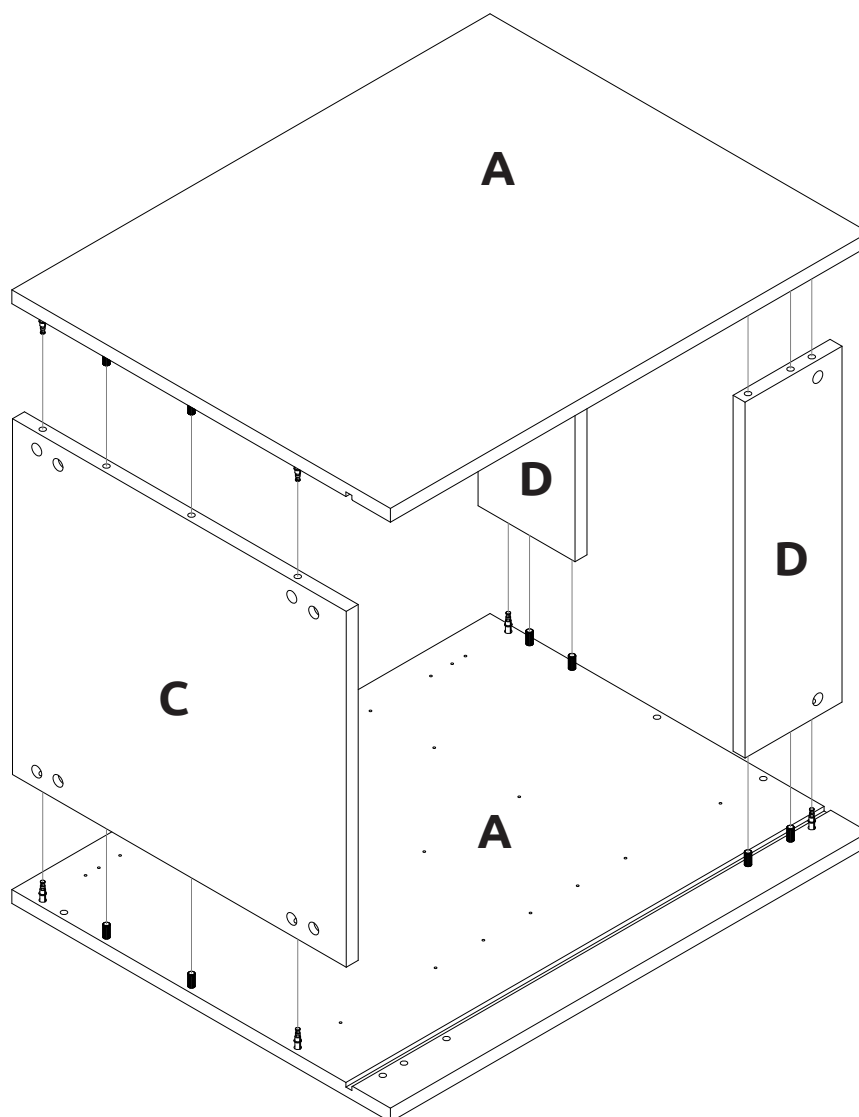

# BASE UNIT

## 300-600, 1 Door / 1 Door + 1 Drw Assembly Guide

### Step 5.

Slide back panel **(B)** into groove of end panels **(A)**. Once back panel **(B)** is in position, ensure the panel is flush & square with bottom of end panels.



### For the bin installation.

Back Panel **(B)** should not be installed (Skip Steps 5 & 7).

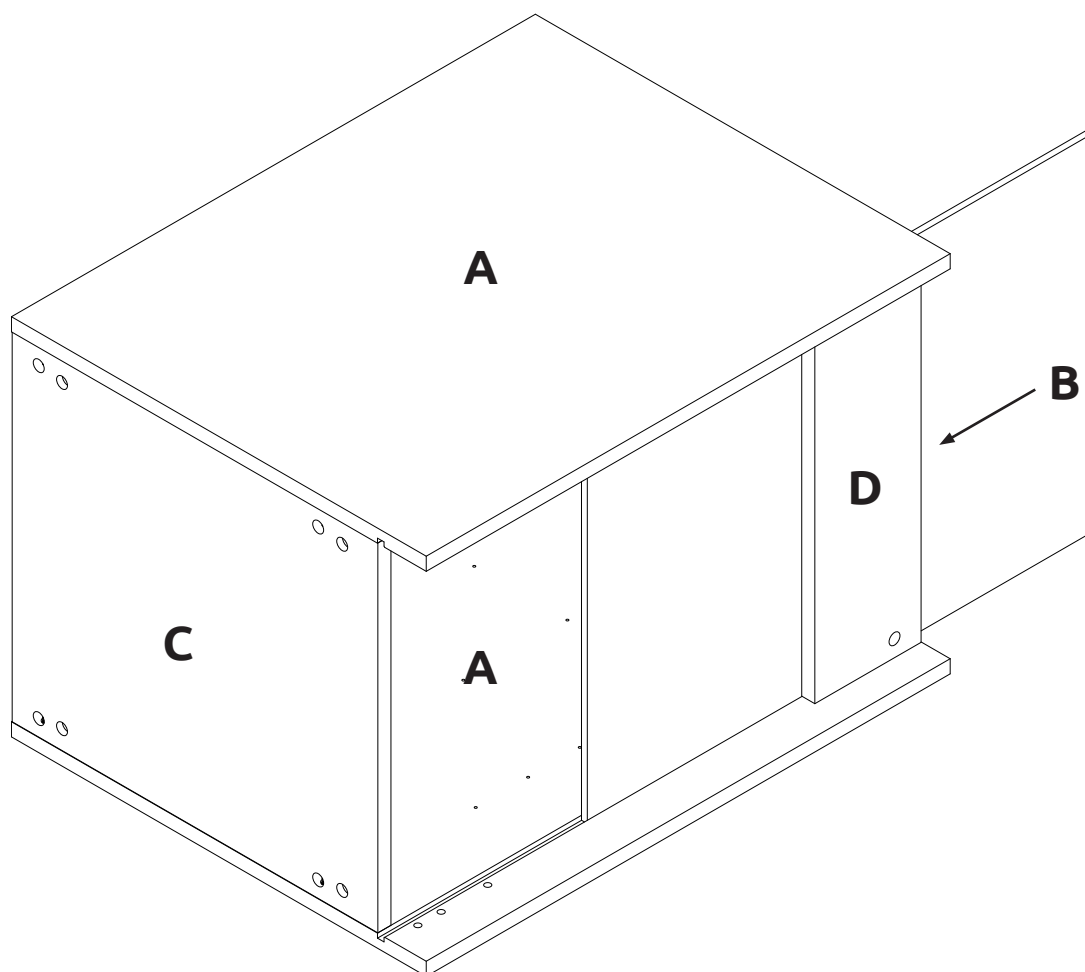

# BASE UNIT

300-600, 1 Door / 1 Door + 1 Drw Assembly Guide

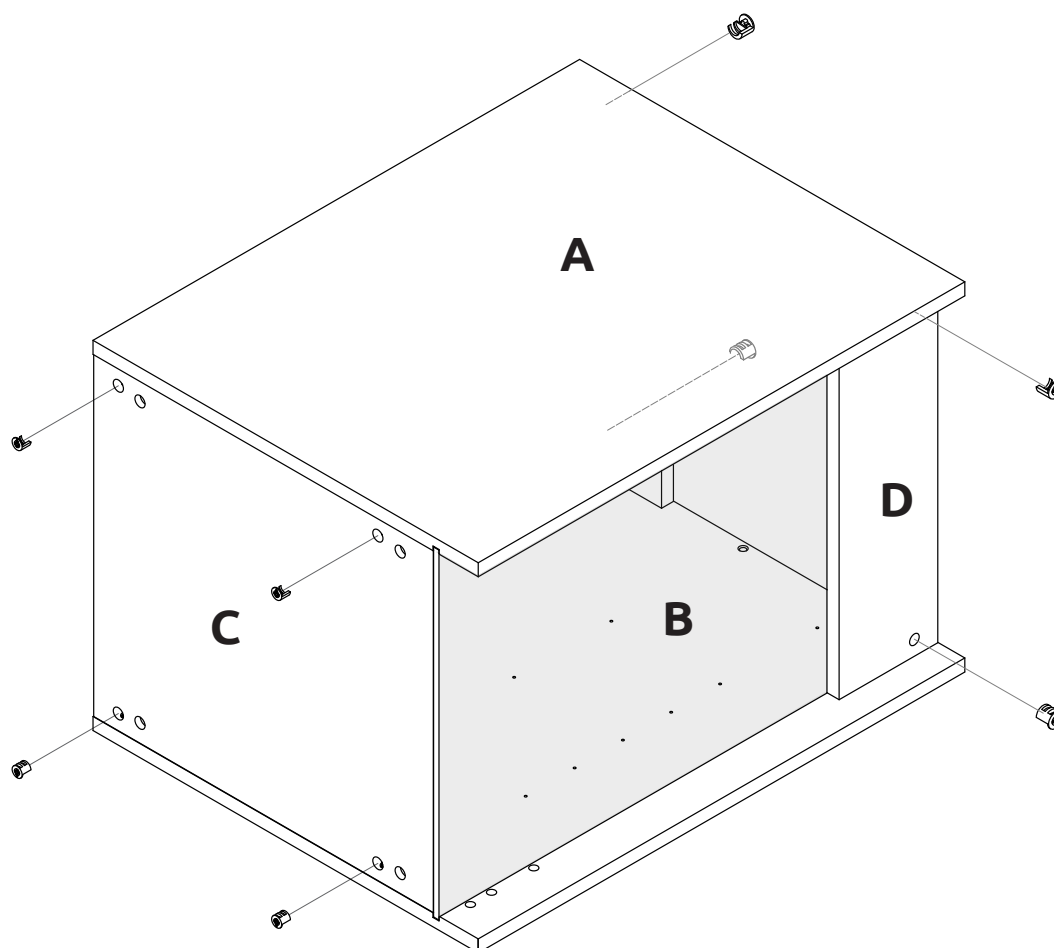
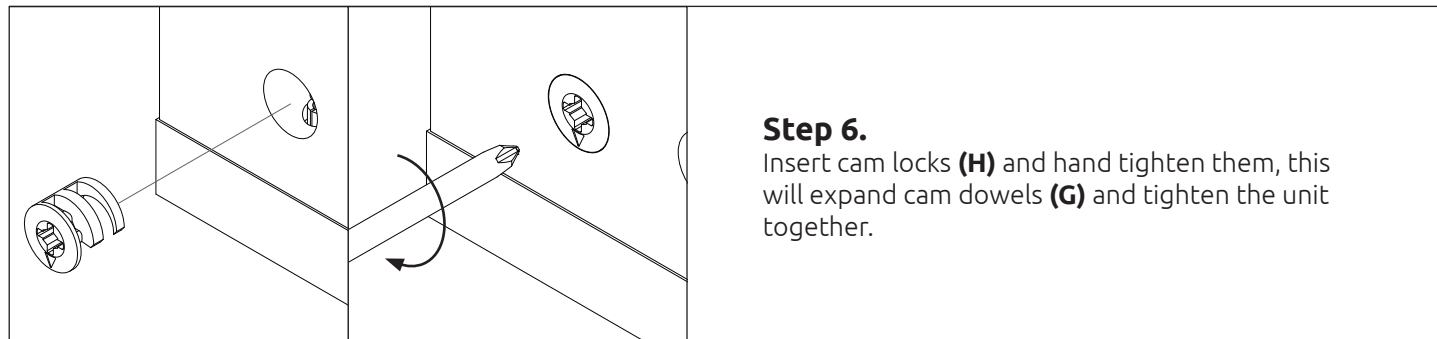

Do **not** use power tools with cam lock **(H)**

# BASE UNIT

## 300-600, 1 Door / 1 Door + 1 Drw Assembly Guide

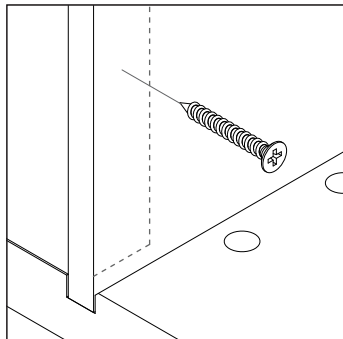

### Step 7.

Ensure the unit is square. Secure back panel **(B)** with 3 x 30mm screws **(K)** equally spaced at the bottom of back panel **(B)** into base panel **(C)**, as shown. Ensure you screw into the centre of the base panel **(C)** (9mm from the edge).

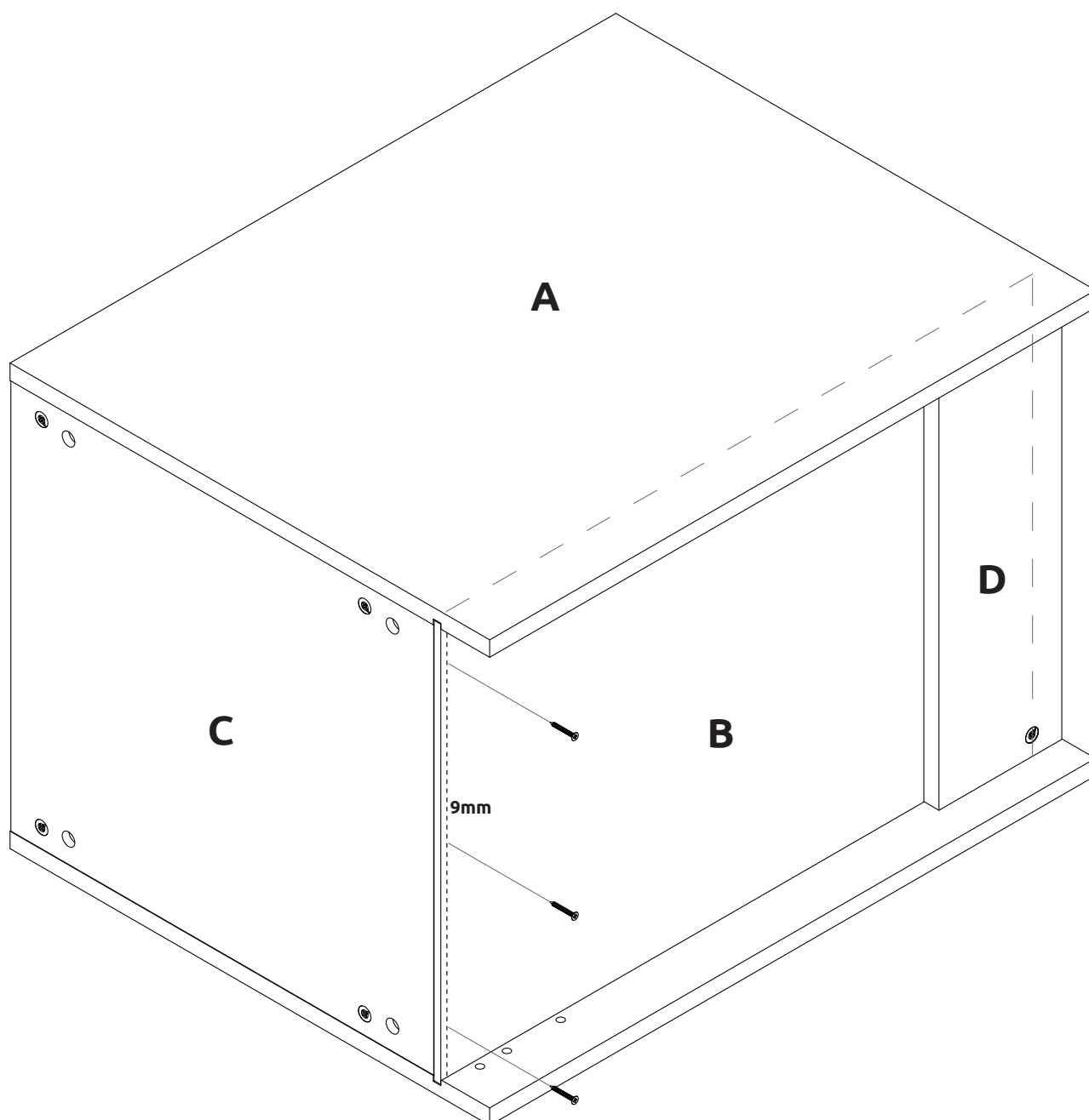

# BASE UNIT

## 300-600, 1 Door / 1 Door + 1 Drw Assembly Guide

### Step 8.

Position legs as shown on the diagram below. Ensure legs are rotated to also provide support to the end panels (**A**). Once positioned, secure each of the legs into place with 4 x 15mm screws (**L**) per leg. Push leg firmly down into leg base. Adjust legs to **155mm** before turning unit upright. Once in situ level accordingly.

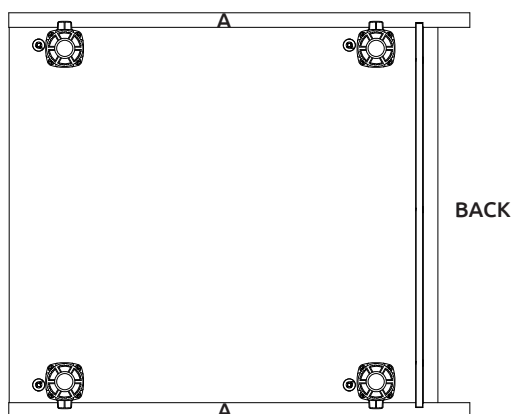
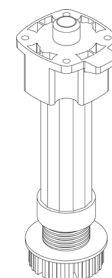

LEG POSITIONS - UNDERSIDE VIEW

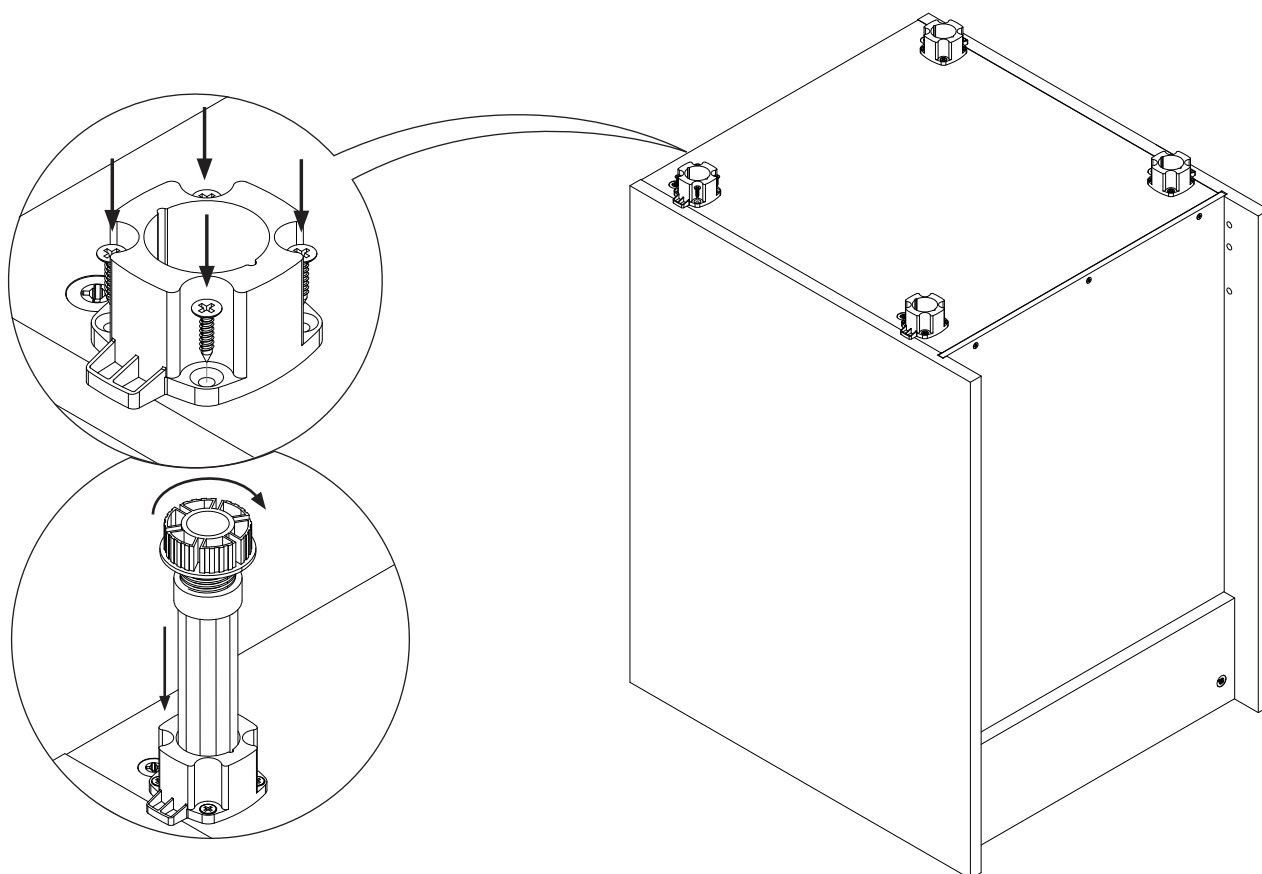

# BASE UNIT

## 300-600, 1 Door / 1 Door + 1 Drw Assembly Guide

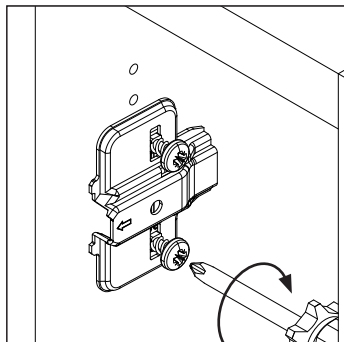

### Step 9.

Attach hinge plates onto end panel **(A)** as shown, using 2 screws already located in hinge plates.

**Hinge side to be mounted in accordance to customer specific kitchen plan.**

### DRAWER LINE SPECIFIC

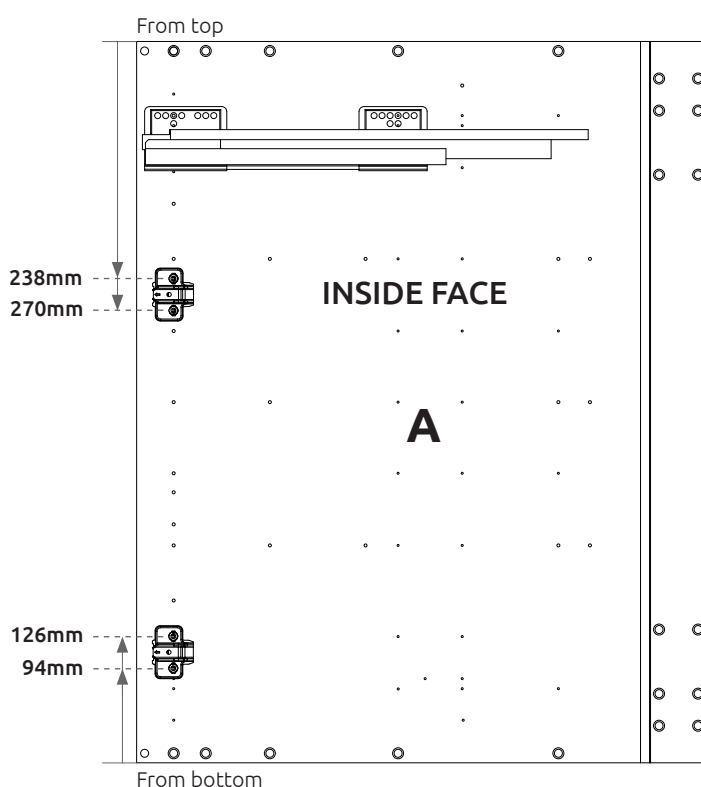
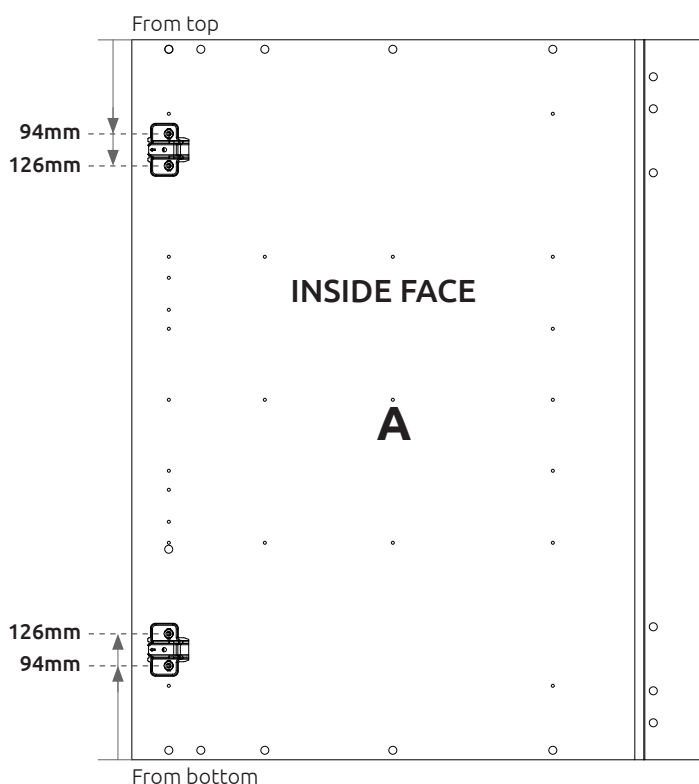



# BASE UNIT

## 300-600, 1 Door / 1 Door + 1 Drw Assembly Guide



### 500 & 600 Bin Base Unit

Please refer to separate instruction included with your bin.

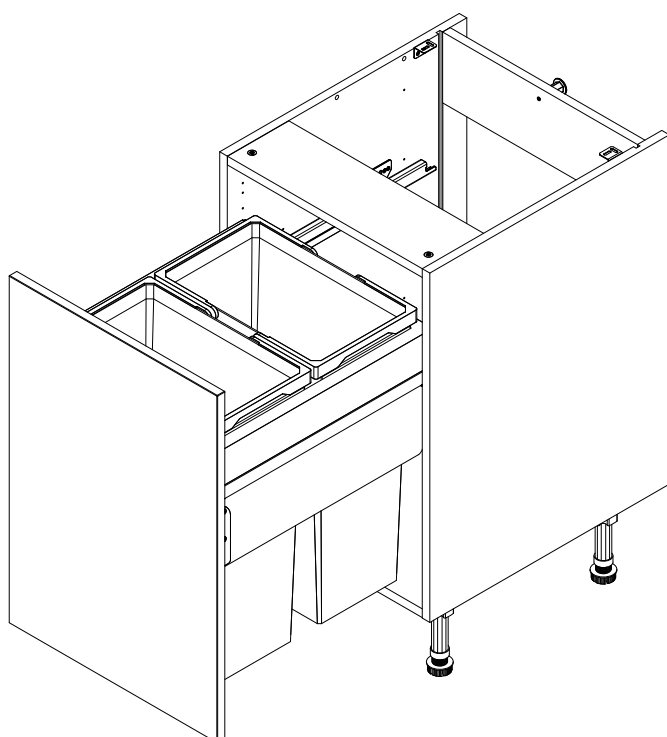

500 Bin Base Unit

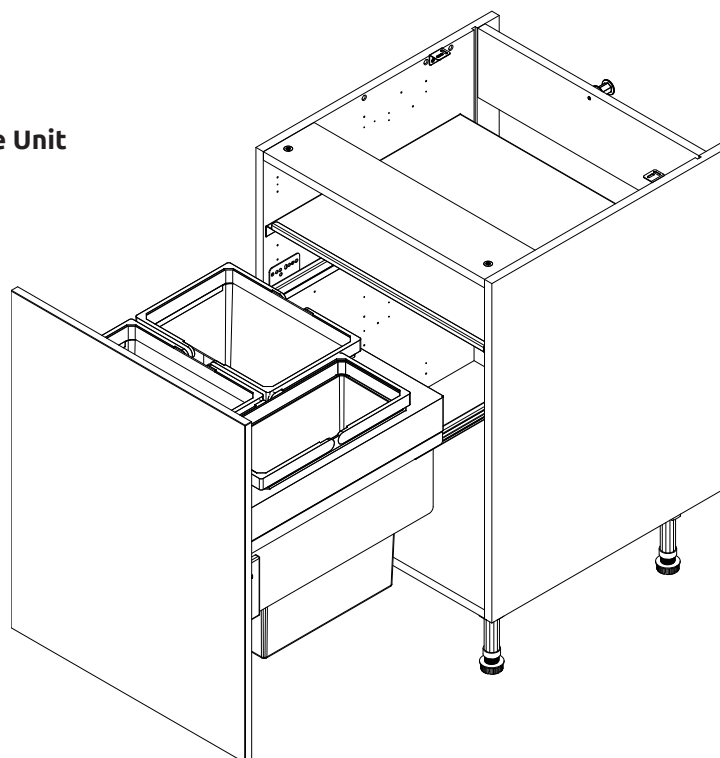

600 Bin Base Unit

# BASE UNIT

## 300-600, 1 Door / 1 Door + 1 Drw Assembly Guide



Screws for attaching to walls and worktops are **not provided** as these vary depending on materials, thickness and construction. Ensure appropriate fixings for wall and worktop construction are used. Please refer to the specialist worktop supplier if these are required for solid surface worktops.

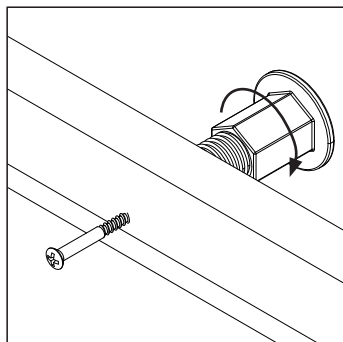

### Step 10.

Ensure the unit is positioned correctly and level. Drill a pilot hole through the back rail into the wall. Unwind a space plug until it contacts both surfaces. Finally, secure to the wall using an appropriate screw.

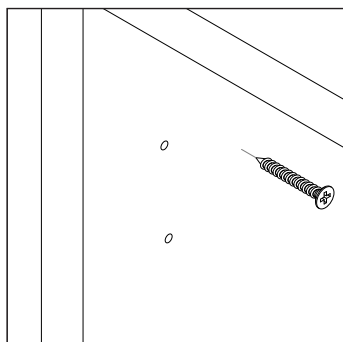

### Step 11.

Screw into any adjacent units using 30mm screws (**K**) provided to secure to unit. Screw at the top and bottom of both sides of the unit, place cover stickers (**M**) on the heads to conceal them.

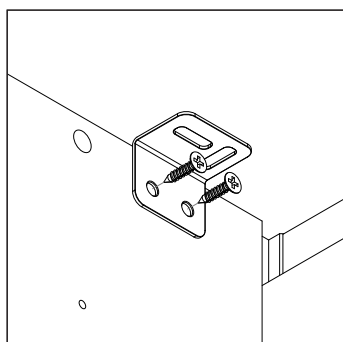

### Step 12.

Use 2 x 15mm screws (**L**) to secure each of the L brackets to the top rear of the unit on both sides.

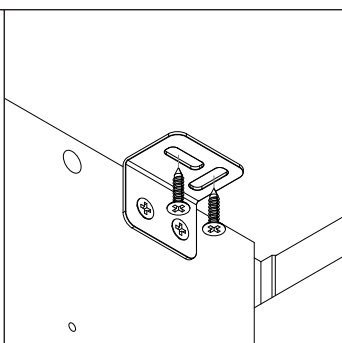
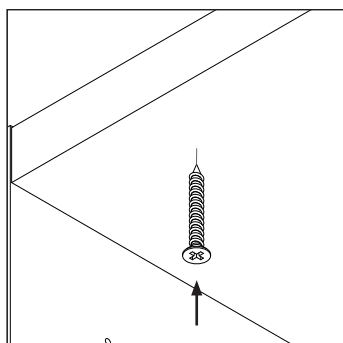

### Step 13.

Screw up through the front rail and the L brackets into the worktop to secure it in place.

# BASE UNIT

## 300-600, 1 Door / 1 Door + 1 Drw Assembly Guide

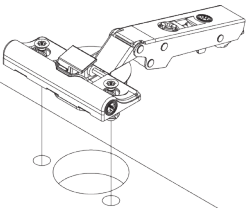
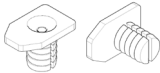
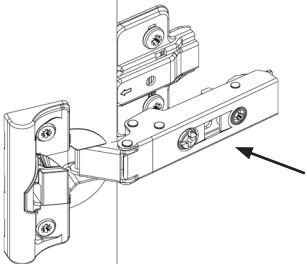
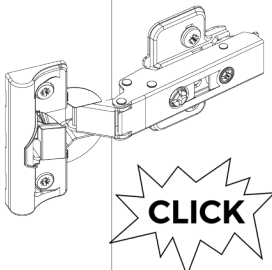
	<p><b>HINGE ATTACHMENT AND ADJUSTMENT</b></p> <p><b>Step 1.</b> Insert hinges into frontal hinge holes provided, secure hinges with the 2 x screws and hinge dowels already located in the hinges.</p>  <p><i>Hinge dowels</i></p>	
	 <p><b>CLICK</b></p>	<p><b>Step 2.</b> Attach the door to unit, clip hinges onto hinge plates and click to secure.</p>
<p><b>Step 3.</b> Adjust hinges to suit, using the highlighted screw(s) shown.</p>		

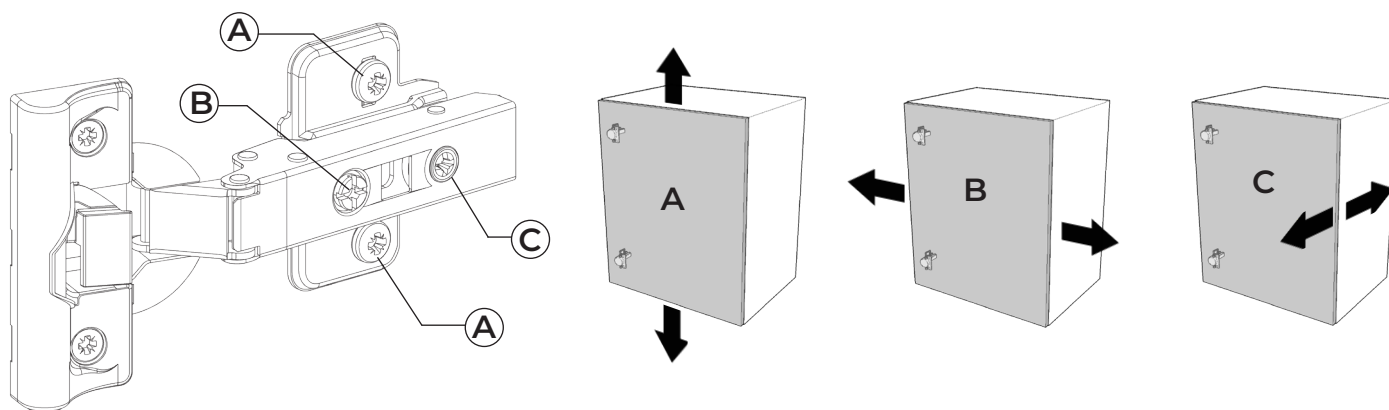

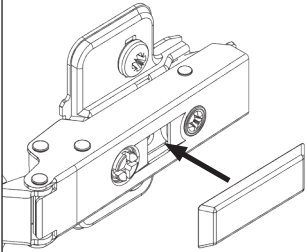
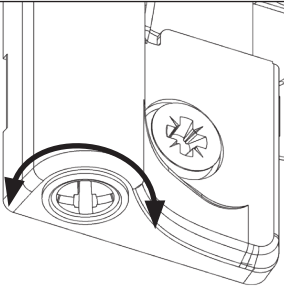
	<p><b>Step 4.</b> Fit cover caps to hinges and adjust soft-close to suit.</p>	
--	---	---



The top and bottom hinges **MUST** be adjusted to the **SAME STRENGTH**.

**wren**