

BASE UNIT

300 - 1000 1 Drawer Shallow Base Unit (Drawer, Solid Top) Fitting Guide

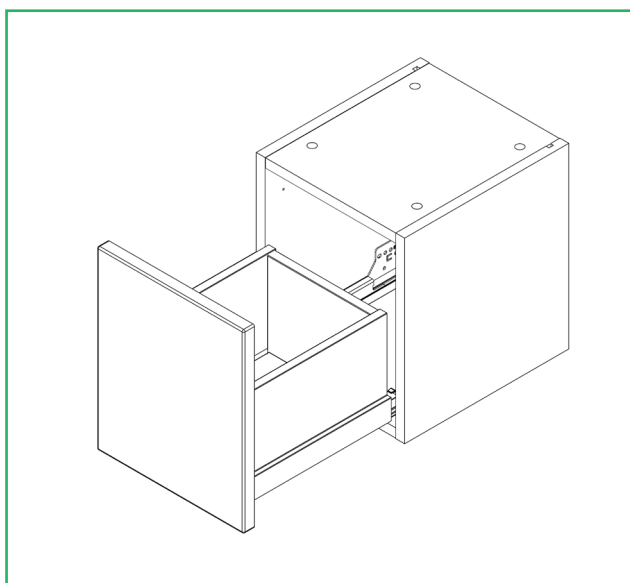

Unit Parts



8x
15mm Screws



4x
20mm Screws



6x
30mm Screws



12x
Cover Caps

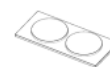

2x
Drawer Buffers



2x
Wall Hanging
Brackets

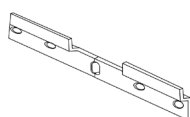

1x
Wall Hanging
Plate Snap
Off (x2)



2x
Corner Gusset
Plates



2x
Hanging Bracket
Cover Caps

Tools Required



Drill



Screwdriver



Clamp



Spirit Level



Tape Measure

Remember to take care when unpacking. Please keep your workspace clean, clear and tidy when working. This will help keep all items safe from any damage. Any un-needed cardboard or plastic should be flattened down and placed in the bin.

A minimum of two people will be needed to lift the unit.

Removing the drawer, fixtures and fittings

Remove all fixtures and fittings from the drawer and keep on a clean and level surface and grouped by product.

Before installing the unit, remove the drawer. This is done by pulling the drawer all the way out, and then pulling the front upwards.

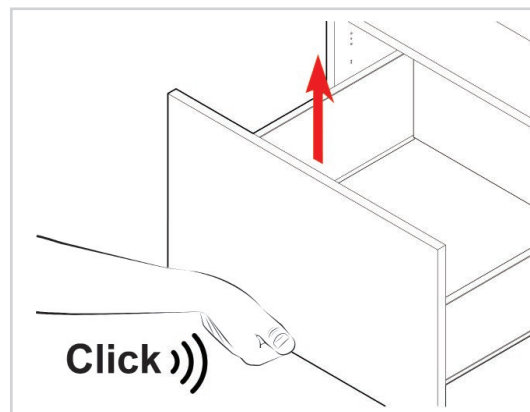

Place the drawers on top of a piece of leftover cardboard to protect them from damage.

The next few steps will take place on the back of the unit.

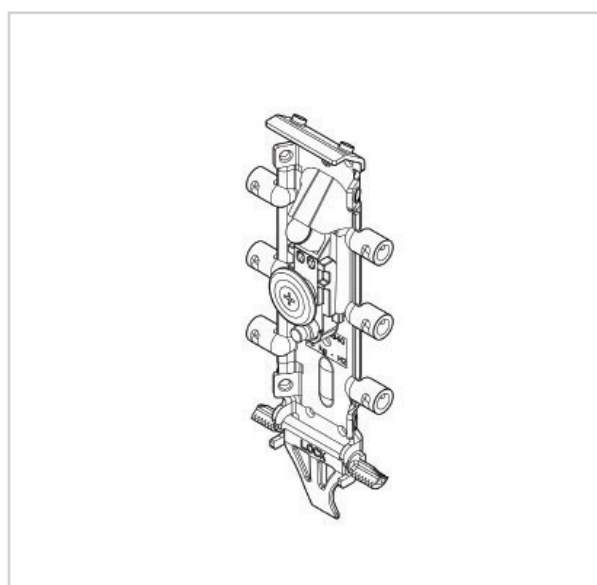
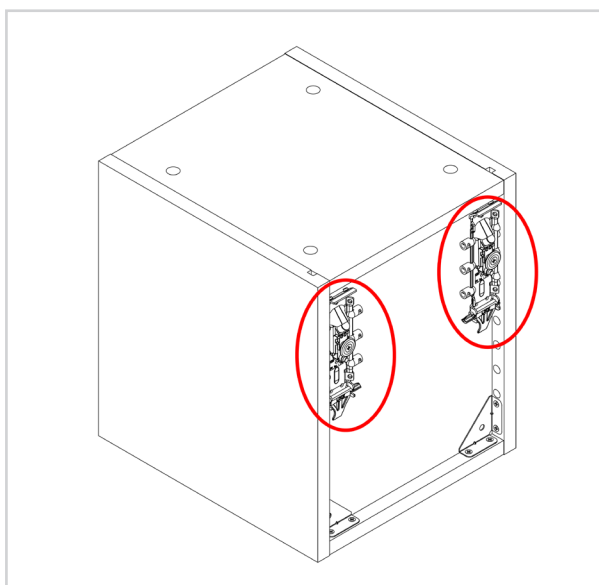

Installing the wall hanging bracket

Insert the hanging bracket into pre-drilled holes.

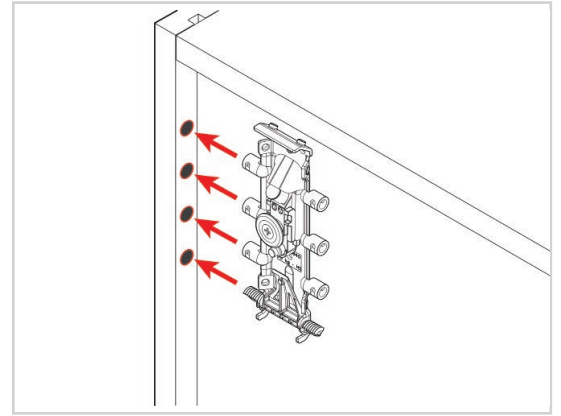

Rotate the locking lever down **180 degrees**.

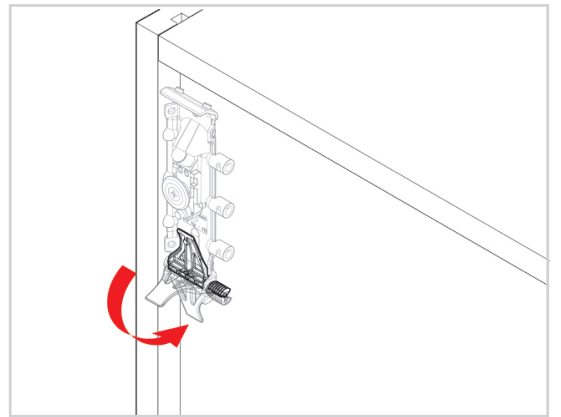

Secure with provided **2x20mm** screws per bracket.

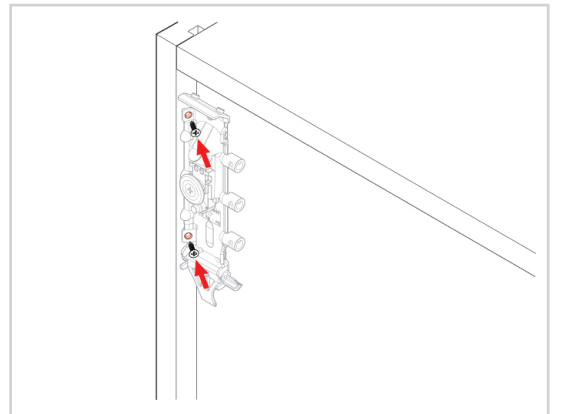

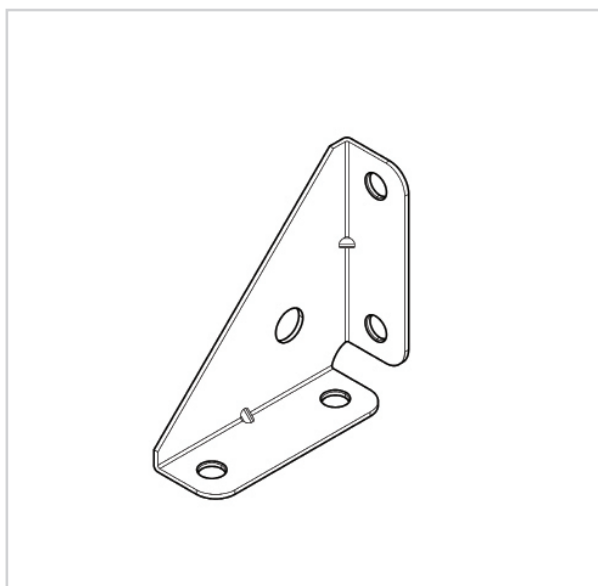
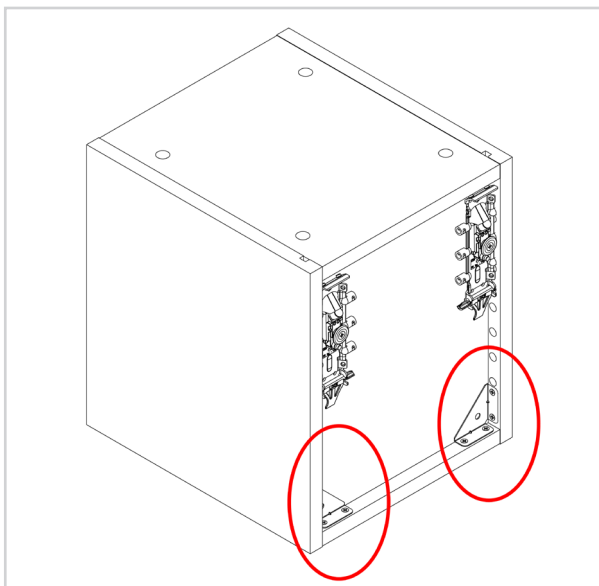

Installing the corner gussets

Secure the corner gussets to both the bottom corners of the wall unit using **4x15mm** screws per gusset.

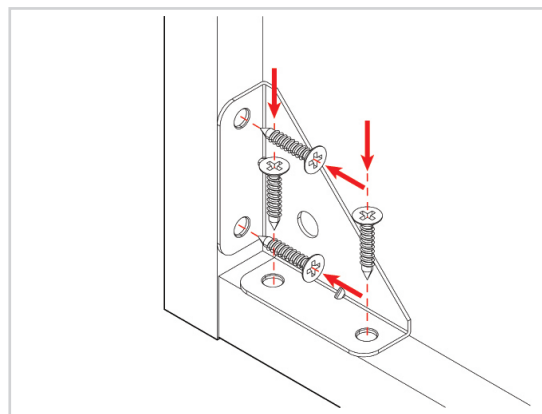

Creating the pilot holes

Drill small pilot hole through the back panel of the unit through the gusset.

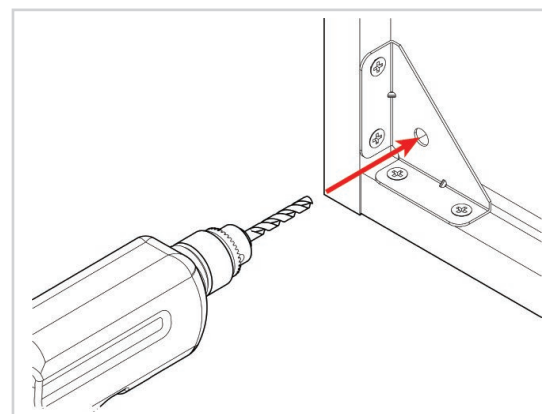

Finding the fixing point for the wall brackets

The fixing point for the wall hanging brackets are **125mm** below the top of the units.

Draw a line on the wall **125mm** below the top line of the unit (Already marked).

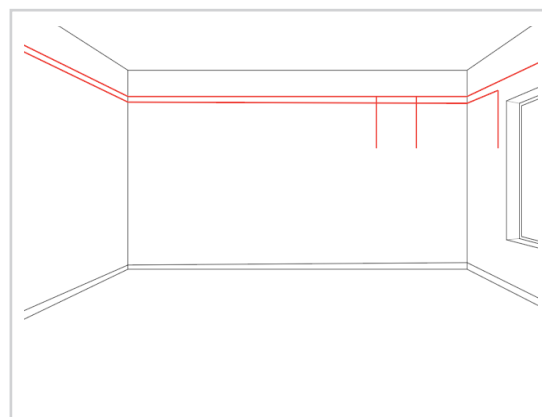

Draw a vertical line **20mm** inside either side of the pre marked wall unit positions.

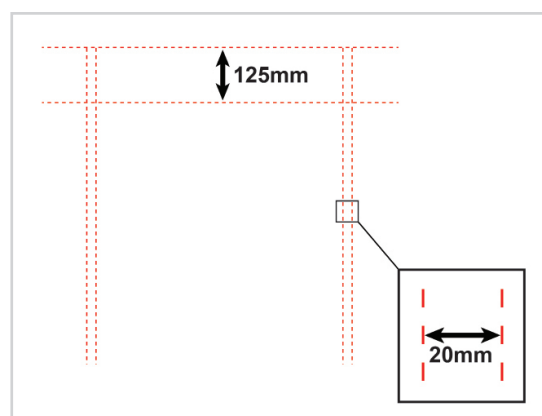

Snapping the wall hanging plate

Bend the wall hanging plate down the middle until it snaps into two pieces.

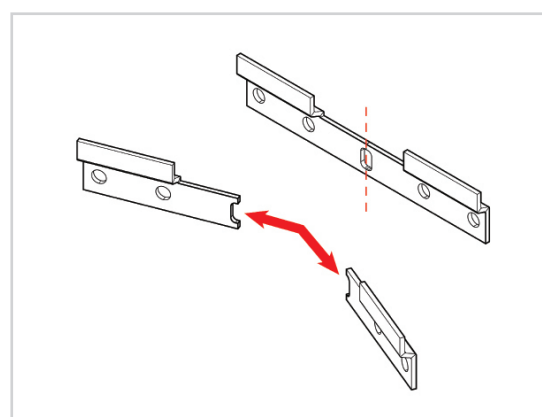

No screws or wall plugs are provided for attaching the unit to the wall.
This is due to variations in wall construction.

Before drilling into the wall you **MUST** check for any hidden services or pipework within the walls.

Attaching the wall hanging bracket to the wall

Position the **2x** hanging brackets as shown and mark the holes onto the wall.

Remove the hanging bracket, then drill holes into the wall of an appropriate size for the screws required

Attach the hanging bracket onto the wall by screwing through the holes on the hanging bracket into the holes on the wall.

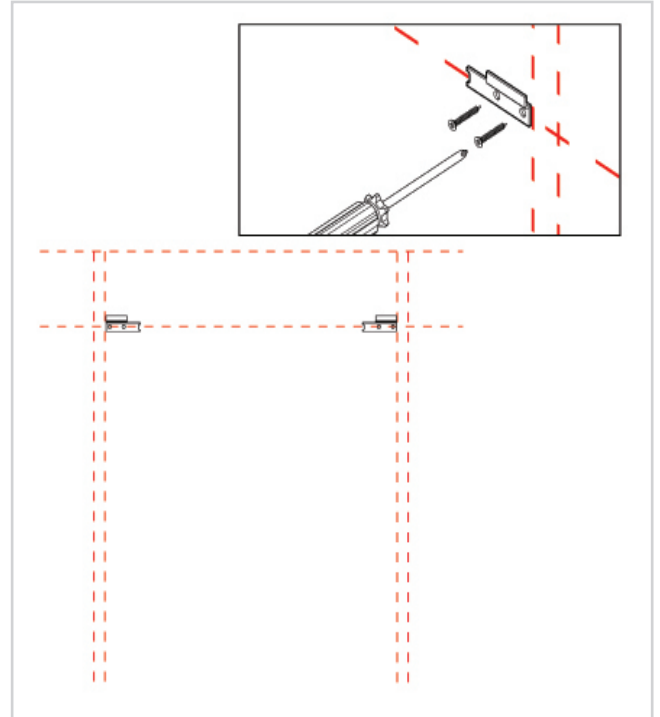

In order for to complete the steps below the red screw found on the wall unit on the hanging bracket will need to be screwed all the way out.

Lifting the unit into place

Lift the unit against the wall slightly higher than its finished height. Lower the unit down onto the wall hanging bracket.

Before releasing the unit, gently tug it to ensure it is securely supported by the hanging brackets.

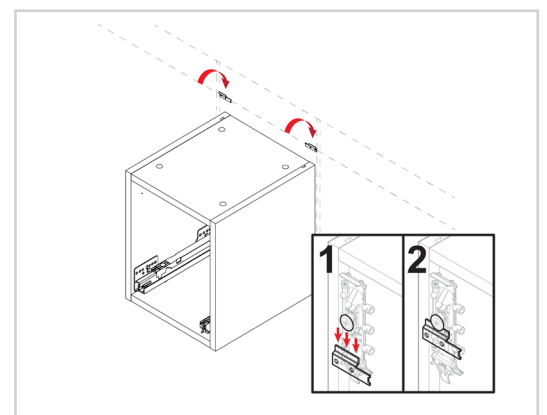

Adjusting the wall brackets

Using the points below to adjust the unit to suit.

Place the cover cap once adjustment has taken place.

A- Rotate the screw clockwise to move the unit up. Anti-clockwise for down.

B- Adjust the depth using centre screw.

C- Screw the red screw until it touches the plate to lock in position.

Place cover caps over the wall brackets.

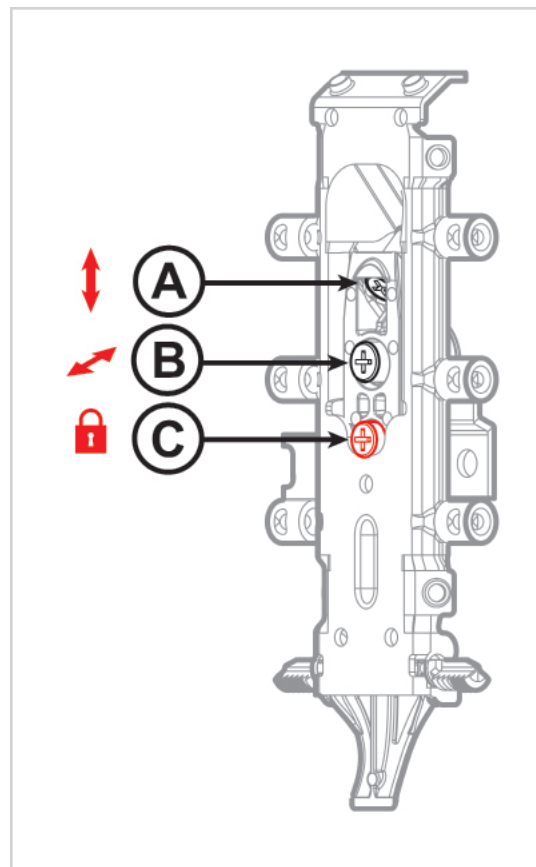

Double check units are level after adjustments.
Use a spirit level to ensure the units are level front to back, left to right and diagonally.

No screws or wall plugs are provided for attaching the unit to the wall.
This is due to variations in wall construction.

Before drilling into the wall you **MUST** check for any hidden services or pipework within the walls.

Fixing the wall unit to the wall

Fix the unit to the wall through the gussets using the appropriate screws to attach to the wall.

Use cover caps to conceal the screws.

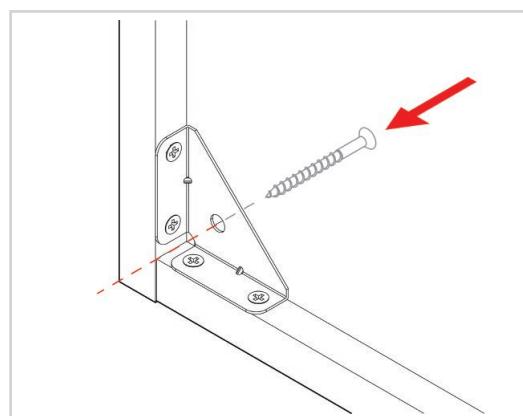

Securing to adjacent units

Clamp together the two units, checking the front edges are level and flush.

Using the screws provided, **1x30mm** screw should be fixed into each corner of the unit side.

The screws can be concealed by placing them behind the shelf or behind the hinge plates. The cover caps can be used to hide any visible screw heads that remain.

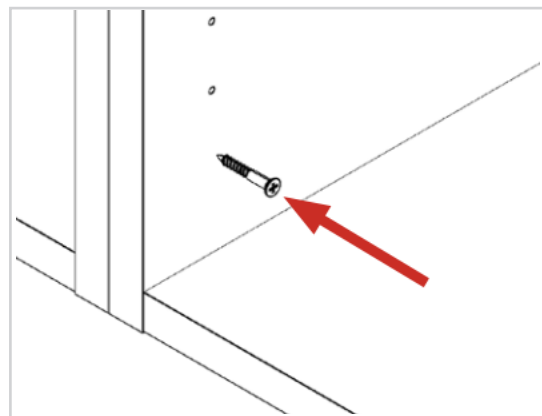

Inserting the drawers

Slide the drawer onto the runner, making sure the runner mechanism and the drawer side grooves line up.

Once positioned on the runners, push the drawer back into the unit. You will hear a click when it is inserted correctly.

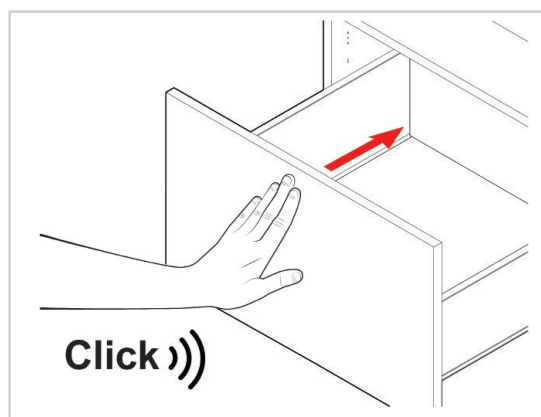

Adding the drawer buffers

Add **1x** drawer buffer to each corner of the unit, as shown in the image.

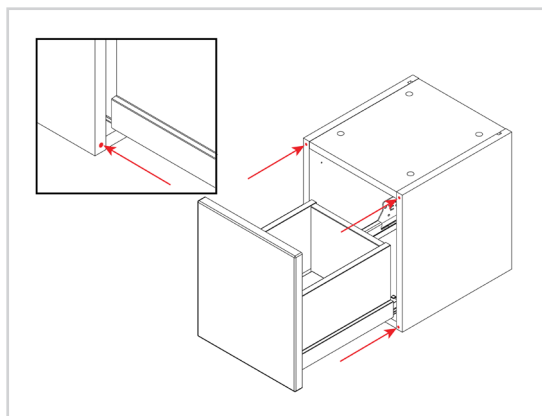

Removing the drawer cover caps (Infinity)

Place a flathead screwdriver in the small groove between the cover cap and the drawer side and carefully twist. Keep the cap in a safe place until it is needed again.

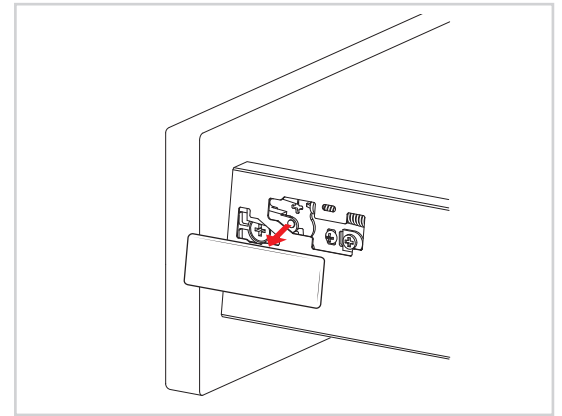

Adjusting the frontal (Infinity)

Adjust the frontal to suit, as shown in the image.

Point 1 - Will adjust the frontal left and right.

Point 2a - Will lock/unlock point 2b.

Point 2b - Will adjust the frontal up and down.

Point 3 - Will adjust the frontal releasing fixing clip. Screw while applying downward pressure to release.

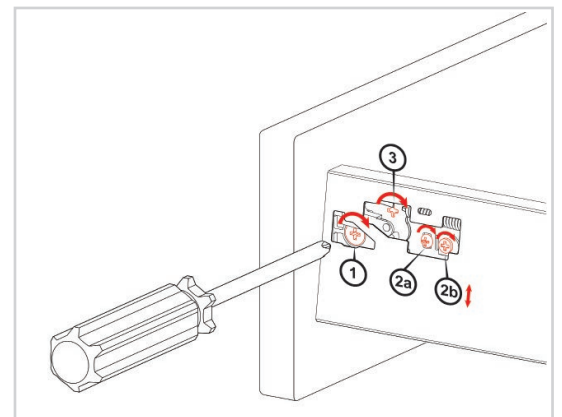

Fitting the drawer cover cap (Infinity)

Position the cover cap over the mechanism, aligning the clips on the cap with the cut-out on the drawer side, and apply pressure.

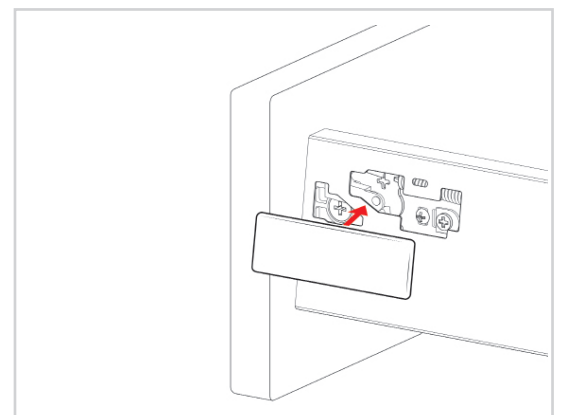

Adjusting the frontal horizontally (Infinity Plus)

Use the fixing clips, which are found under the drawer's front, to adjust the drawers.

Step 1 - Press the fixing clips half way to meet the runners on the underside of the drawer.

Step 2 - Slide the drawer to the left or right to adjust.

Step 3 - To lock the frontal in place, release the fastening clips on both sides of the drawer.

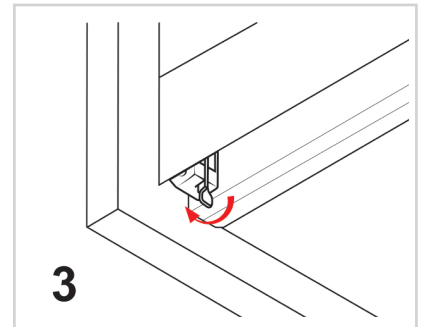
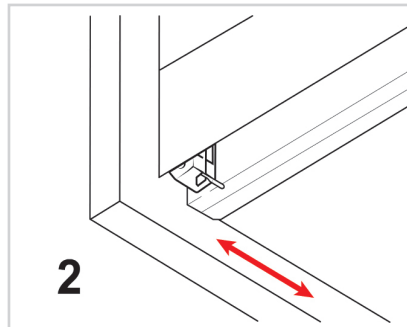
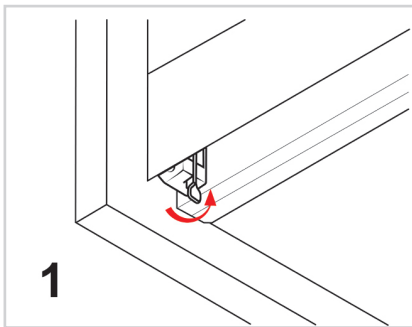
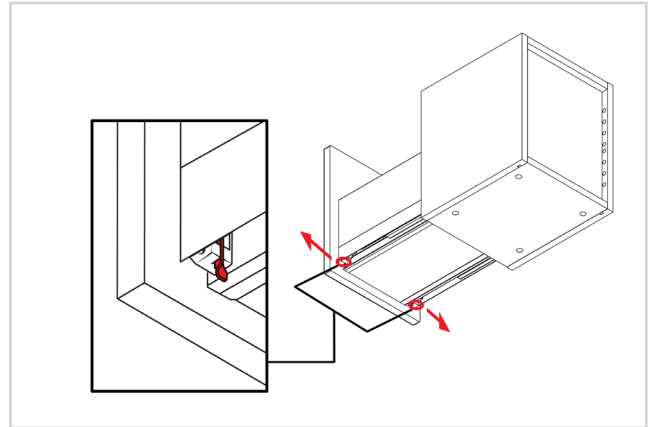

Adjusting the frontal height (Infinity Plus)

To adjust the height of the frontal, use a screwdriver as required at **points 1** and **2**.

Step 1 - Loosen both of the screws at **point 1**.

Step 2 - Turn the screw at **point 2** to adjust the frontal's height.

Step 3 - Once in the desired position re-tighten the screws at **point 1**.

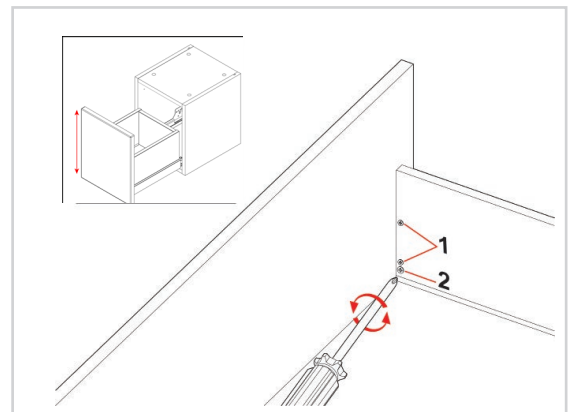

Cleaning the unit

Finally, the unit should be thoroughly cleaned to remove any debris that may have accumulated during the installation.

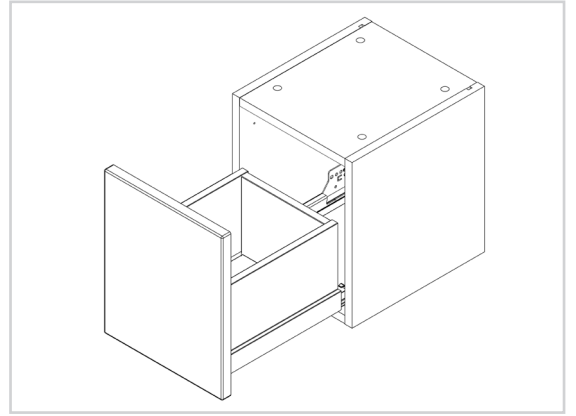

Store the L-brackets.
These will be used later when installing the countertop (laminated or timber).