

EASY-FIT

# Base Unit

**wren**  
KITCHENS

## 700 - 1000 Venting Hob Base (Door, Open Top, 5 Legs) - Fitting Guide

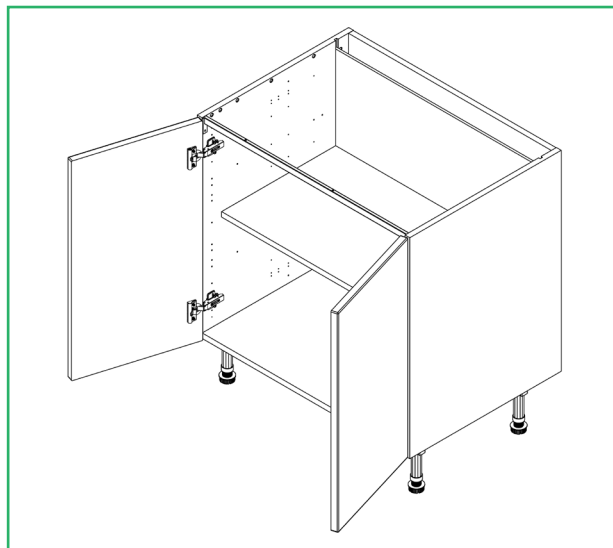

### Unit Parts

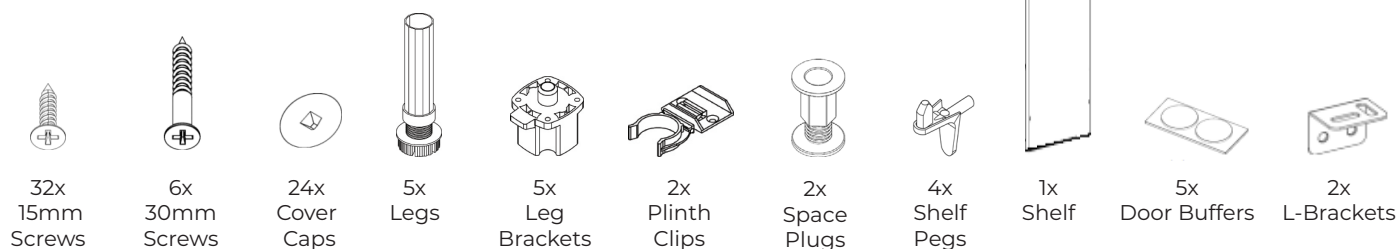

### Tools Required



Remember to take care when unpacking. Please keep your workspace clean, clear and tidy when working. This will help keep all items safe from any damages. Any un-needed cardboard or plastic should be flattened down and placed in the bin.

A minimum of two people will be needed to lift the unit.

### Removing the frontals

Before installing the unit, remove the frontals by pulling the release catch.

Place the frontals in the door safe along their longest length.

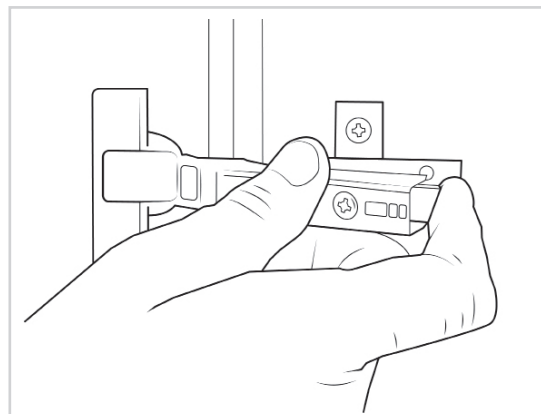

### Removing the fittings

Remove all content so the unit is empty.

All fittings should be kept on a clean and level surface and the shelf placed in the door safe along its longest length.

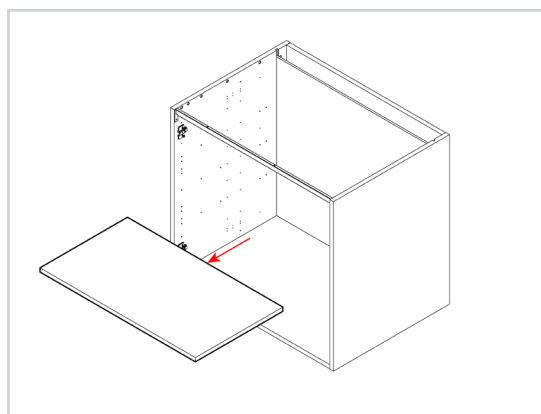

### Positioning the unit

The positioning of the unit will depend on where the ducting is being installed, refer to the installation manual for the positioning.

**1. Ducting through the bottom of the unit –**  
Position the unit upside down and ensure it is fully supported before cutting.

**2. Ducting through the back of the unit –**  
Lay the unit flat on a protected surface with the back panel facing up.

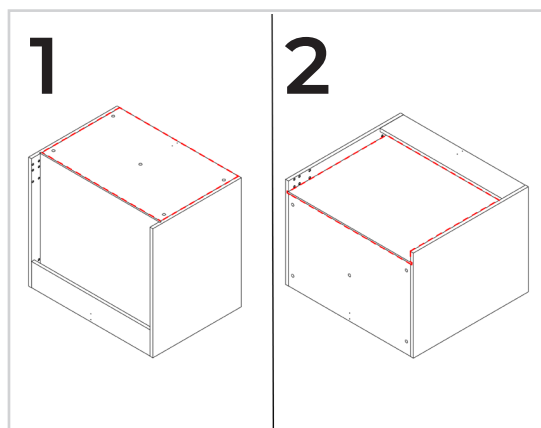

## Marking the ducting cutout

Use the ducting template provided with the venting hob to mark the back panel or unit base, depending on where the ducting will be installed.

Refer to the installation manual for the positioning.

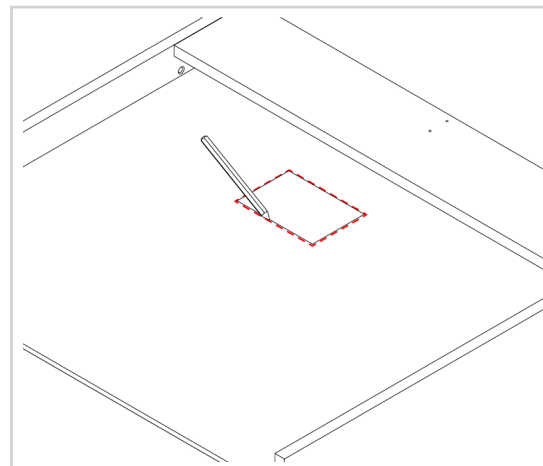

## Cutting for the ducting method 1

### Drilling the ducting cutout

Drill into the corners of the ducting template, ensuring to stay within the marking.

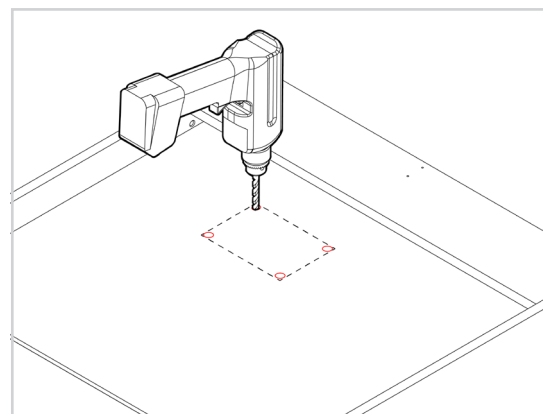

### Cutting the ducting cutout

Starting in the drilled corner, use a jigsaw to carefully cut along the marking.

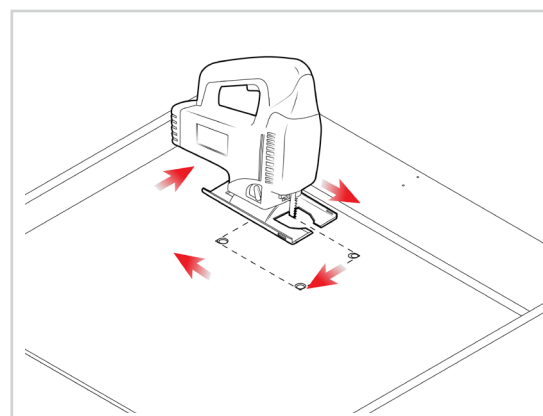

### Removing the back staples

Using a flat-headed screwdriver, carefully remove the staples located at the bottom of the unit.

Any minor damage to the back panel will be concealed once the unit is positioned against the wall.

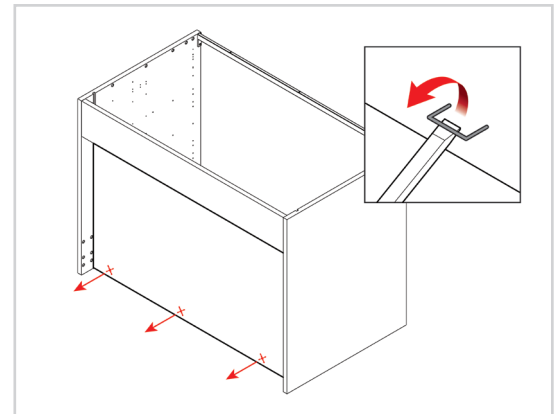

### Cutting the groove

Use a stanley knife to make a small square cut at the top of the groove near the back of the unit.

This is to allow for the back panel to slide out.

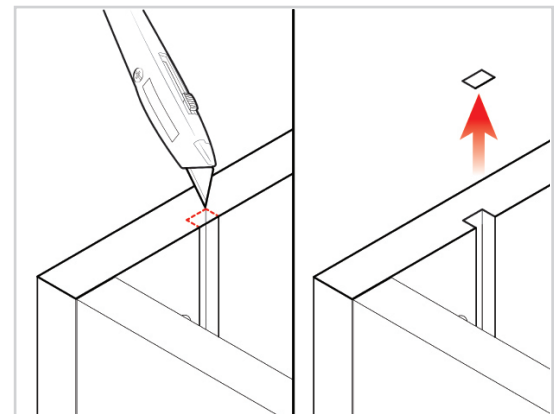

### Removing the back panel

Slide the back panel up and out of the unit and place the panel on a supported surface.

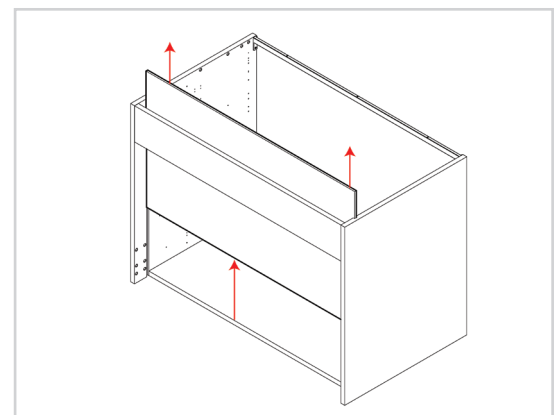

### Drilling the ducting cutout

Drill into the corners of the ducting template, ensuring to stay within the marking.

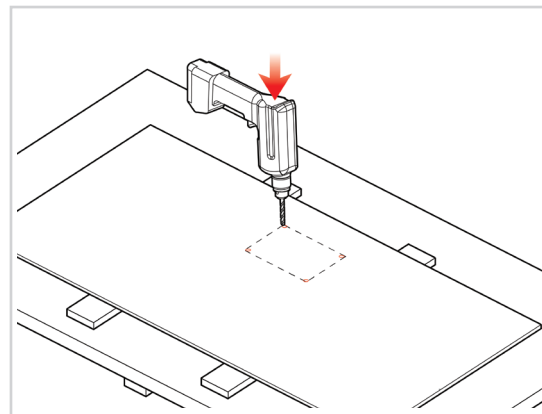

### Cutting the ducting cutout

Starting in the drilled corner, use a jigsaw to carefully cut along the marking.

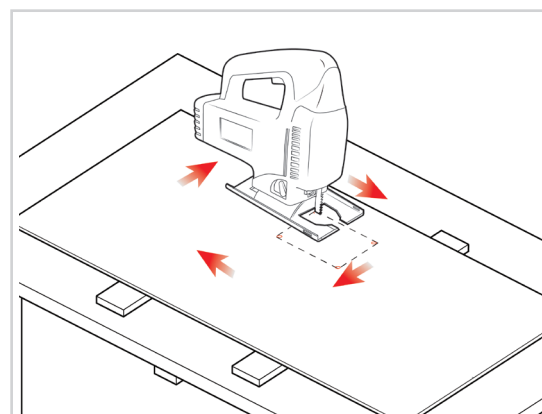

### Sliding the back panel into place

After drilling the holes for the ducting, slide the back panel into the grooves at the rear of the unit.

Once the back panel is in position secure it by using **3 small** tacks along the base panel. Ensure the tacks are placed in different locations than the original staples, to avoid weakening the material.

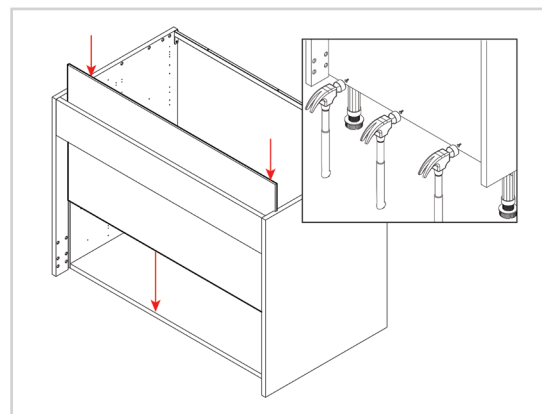

## Positioning the leg brackets

Locate the leg brackets and position, as shown in the diagram. Ensure the leg brackets are rotated so the flange covers the outer edge, as this provides support for the edge of the unit.

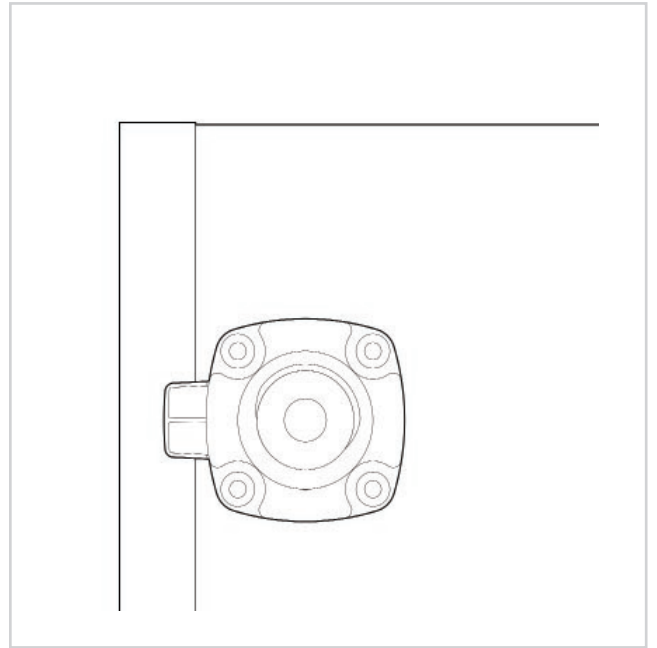
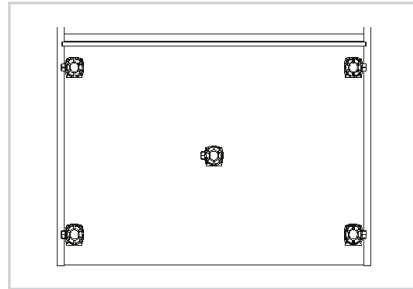

## Fixing the leg bases

Secure each of the leg brackets into place with **4x15mm** screws per bracket.

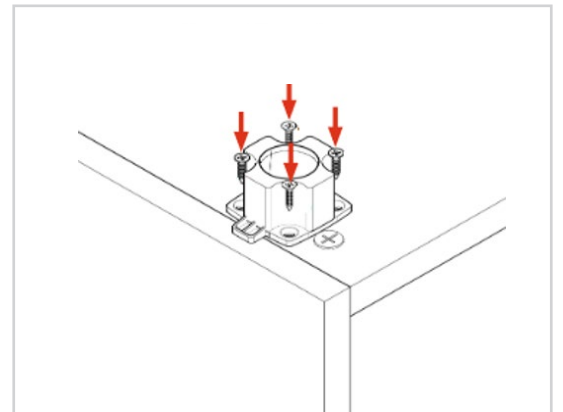

## Inserting the legs

Push each leg firmly down into the leg bracket. Adjusting each leg to **155mm**.

Adjust the legs to the correct height by turning clockwise or anti-clockwise.

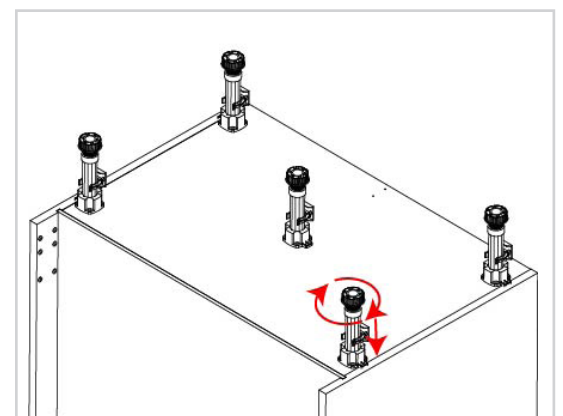

## Lifting the unit into place

When lifting the unit into place do **not** tilt as this can damage the legs.

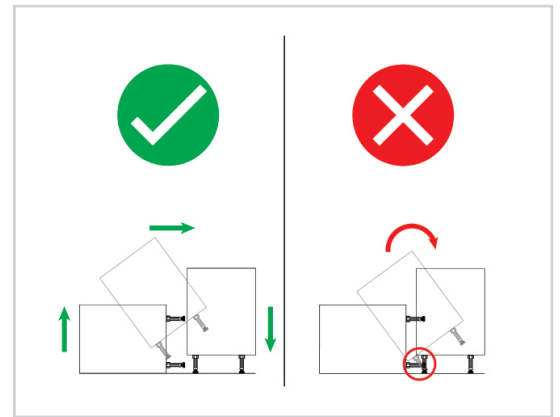

## Notching out the end panels (when required)

In order to allow for any horizontal pipework running behind the unit, some units will require the back of unit's side to be notched out.

Create a notch for the horizontal pipes at the back of the end panels using a jigsaw.

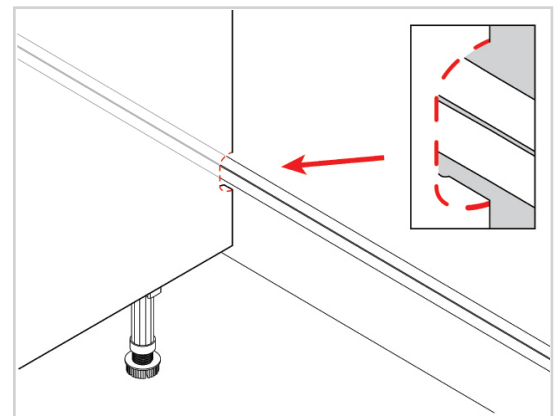

## Sliding the unit into place

Slide the unit against the wall and align it with the wall markings and the services.

Use a spirit level to ensure the unit is level from front to back, left to right, and diagonally. Adjust the legs if required.

The leg height can be adjusted by turning the foot of the leg clockwise or anti-clockwise.

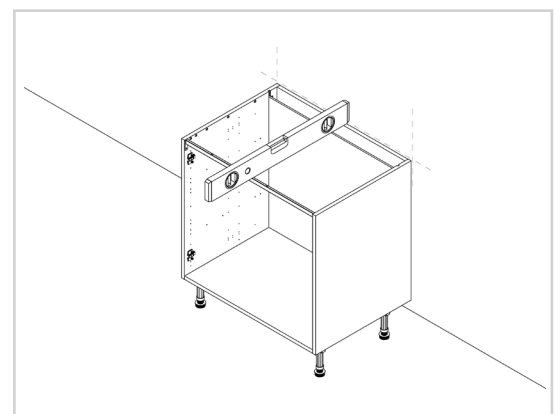

Before drilling into the wall you **MUST** check for any hidden services or pipework within the walls.

### Finding the centre point

Find the centre point measurement of the rear top rail and lightly mark this position.

Transfer the measurement onto the wall at the unit markings, which were drawn at the room preparation stage.

This will be the position of the wall fixings.

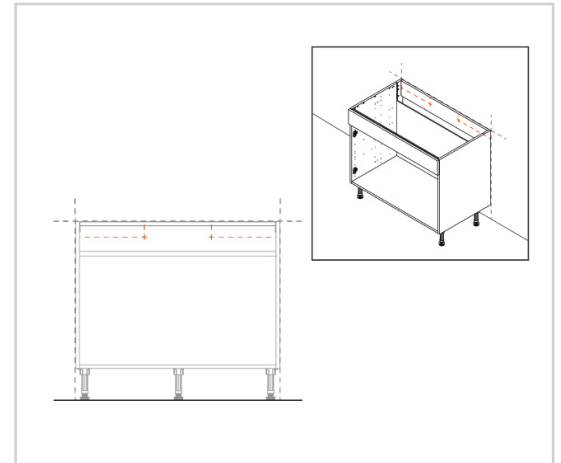

### Drilling the unit and wall

Drill **2** holes through both the rear top rail and the wall at the marked locations. The size of the holes will be determined by the size of wall fixing required.

For guidance on the appropriate wall fixing for each wall type, please consult the “**Room Preparation Guide.**”

Place the wall fixing within the holes in the wall.

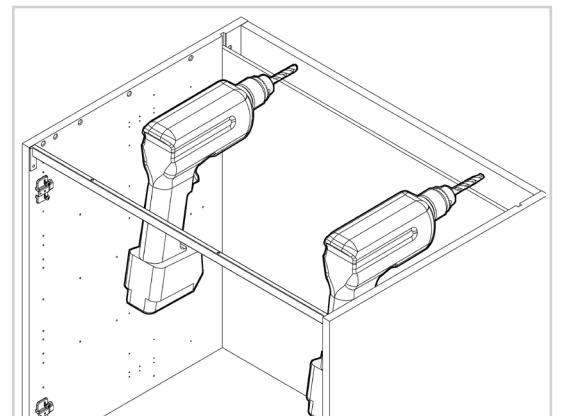

No screws are provided for attaching the unit to the wall.  
This is due to variations in wall construction.

### Inserting the screws

Insert the screws into the drilled holes and tighten to the wall.

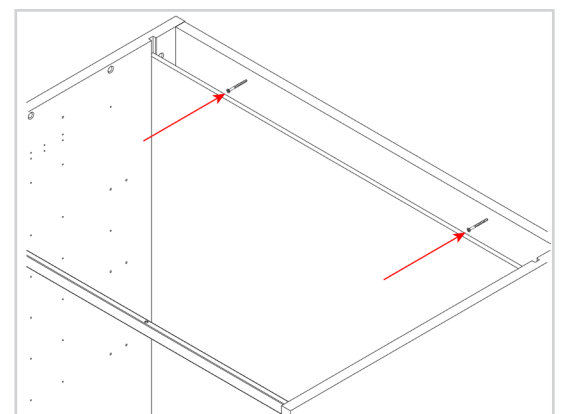



## Securing to adjacent units

Clamp together the two units, checking the front edges are level and flush.

Using the screws provided, **1x30mm** screw should be fixed into each corner of the carcass side.

The screws can be concealed by placing them behind the shelf or behind the hinge plates. The cover caps can be used to hide any visible screw heads that remain.

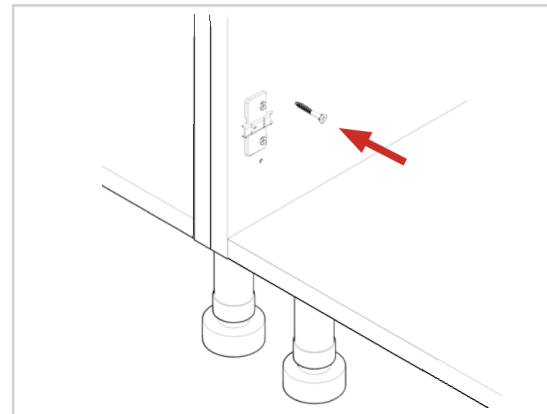

## Finding the shelf height

Position the shelf pegs into the pre-drilled holes. The shelf can be positioned at **3** different heights, as shown in the diagram.

Place the shelf into position so the pin of the shelf peg is inserted into the pre-drilled holes.

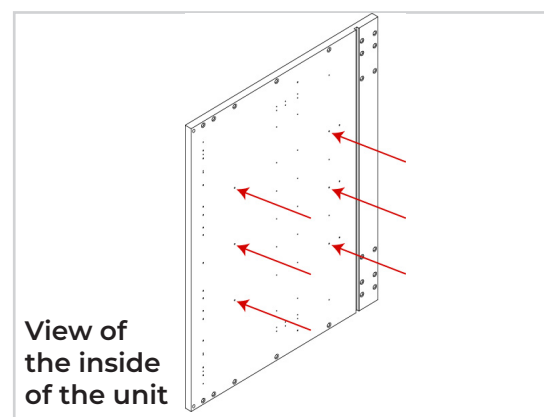

The shelf may require cutting to fit around the ducting tube.

## Inserting the shelf into position

The shelf touches the back panel when installed, if there is a gap between the back panel and shelf then the shelf has been installed back to front and the shelf needs to be rotated.

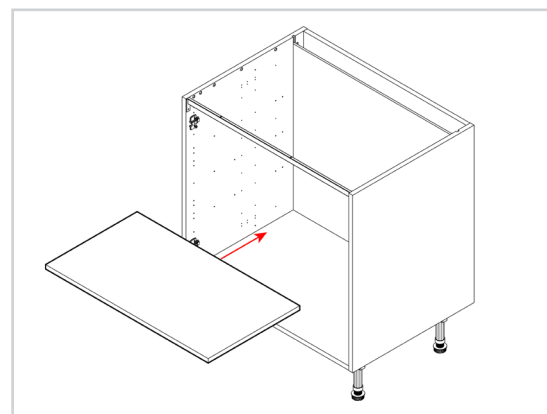

## Attaching the frontal

The frontal should be re-attached to the unit by clipping the hinges onto the hinge plates. The bar of the hinge needs to be positioned into the hooks on the hinge plate. Then the rear of the hinge pushed to the hinge plate until it clicks.

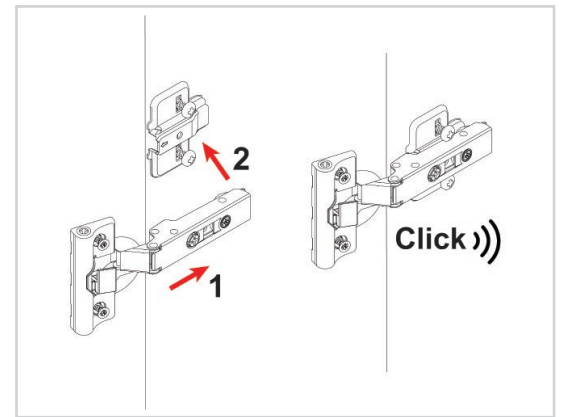

## Adding the door buffers

Position **2x** door buffers at the top and bottom where the frontal's corners meet the unit, as illustrated in the image.

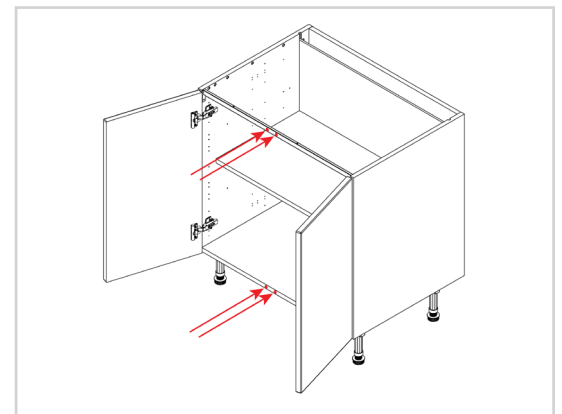

## Removing the hinge cover cap (Easy-Fit)

Use a flathead screwdriver to remove the hinge cover cap by inserting it into the slot of the cover cap and twisting.

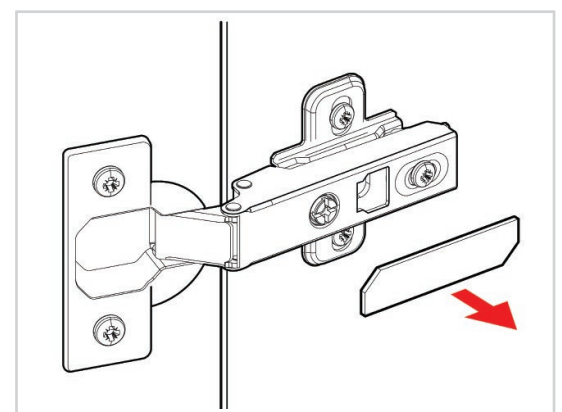

## Adjusting the hinge (Easy-Fit)

To adjust the hinges, use a screwdriver as required at points 1 and 2.

**Point 1** - Will adjust the frontals left and right.

**Point 2** - Will adjust the frontals in and out.

**Point 3** - Will adjust the height of the frontal.  
Re-tighten the screw.

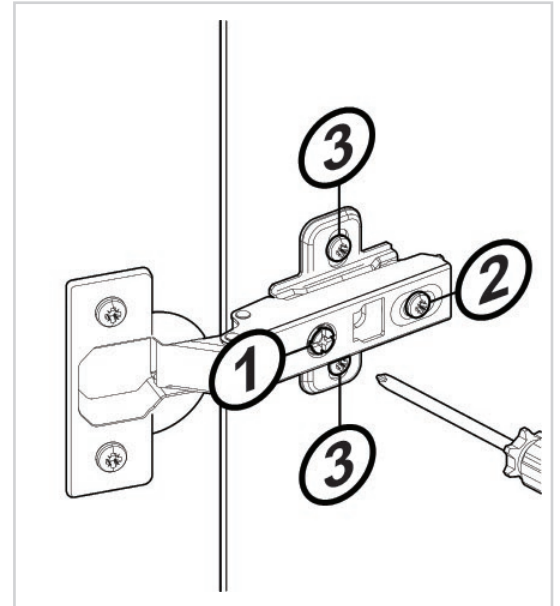

## Fitting the hinge cover cap (Easy-Fit)

Fit the hinge cover caps to the hinges by pressing down to secure.

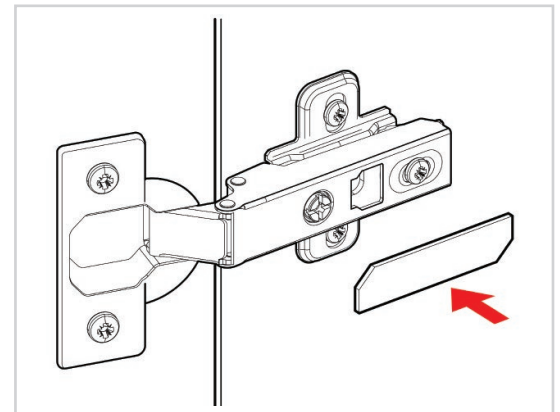

## Removing the hinge cover cap (Easy-Fit Soft-Close)

Use a flathead screwdriver to remove the hinge cover cap by inserting it into the slot of the cover cap and twisting.

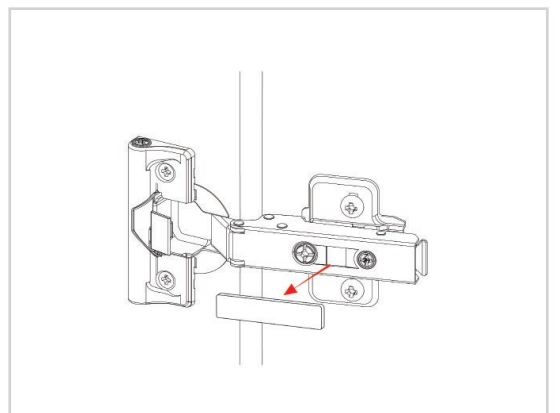

## Adjusting the hinge (Easy-Fit Soft-Close)

To adjust the hinges, use a screwdriver as required at points 1 and 2.

**Point 1** - Will adjust the frontals left and right.

**Point 2** - Will adjust the frontals in and out.

To move the hinges up or down, loosen the screws A and B. Manoeuvre the door, then re-tighten the screws.

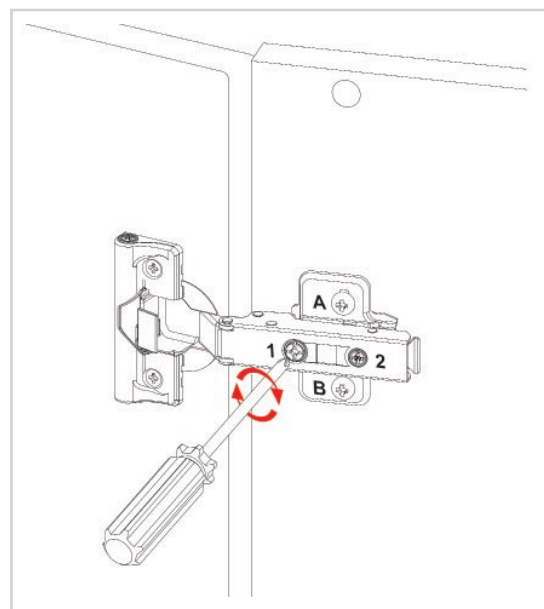

## Altering the soft-close (Easy-Fit Soft-Close)

Fit the hinge cover caps to the hinges by pressing down to secure.

Adjust the soft-close to suit (if required).

The soft-close is adjusted by turning the screw at the top of the hinge clockwise or anti-clockwise.

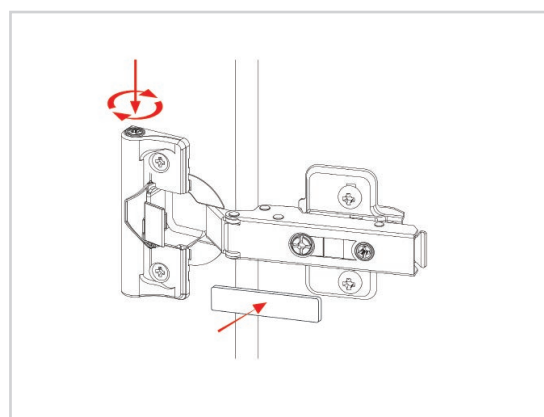

## Cleaning the unit

Finally, the unit should be thoroughly cleaned to remove any debris that may have accumulated during the installation.

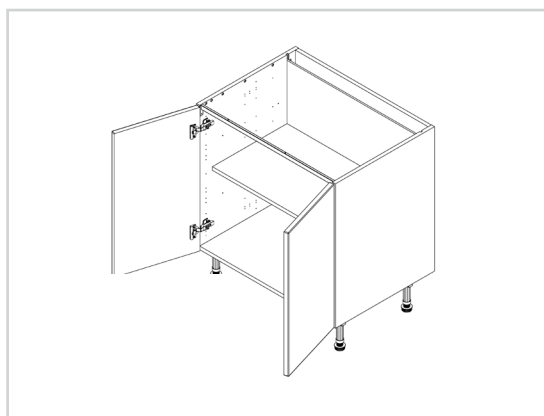

Store the plinth clips, plinth vent and the remaining 15mm screws.  
These will be used later when attaching the plinth.

Store the L-brackets.  
These will be used later when installing the worktop (laminated or timber).