

Page 1 1000mm, 2 Door Downdraft Unit

Page 12 1000mm, 2 Door Downdraft 182mm Unit

1000mm, 2 Door Downdraft Unit (Door, Solid Top) - Fitting Guide (Flatpack)

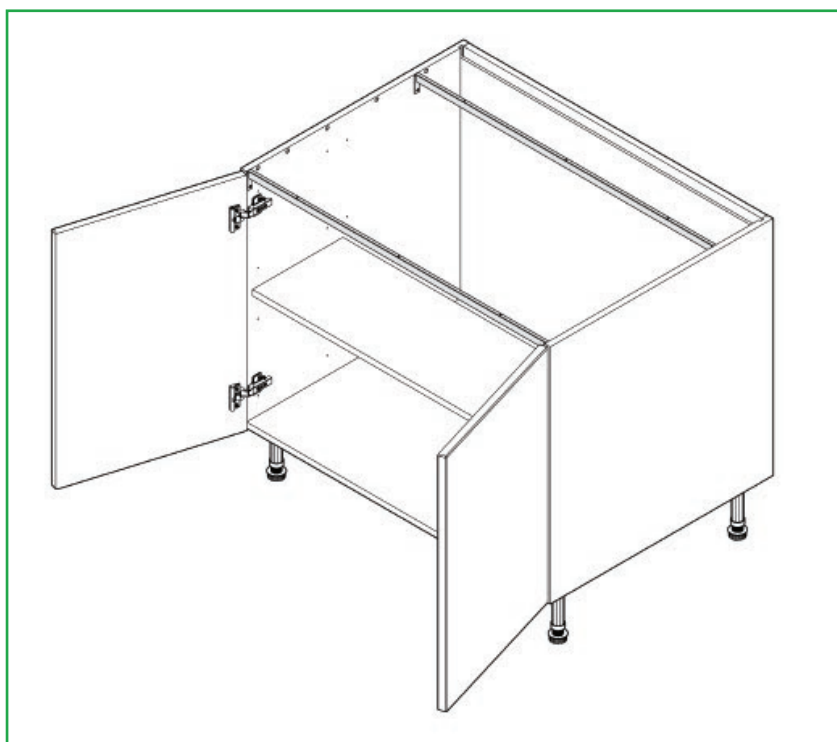

Tools Required



Drill



Screwdriver



Mallet

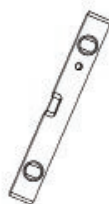

Spirit Level



Pencil



Making Tape



Tape Measure

Unit Parts

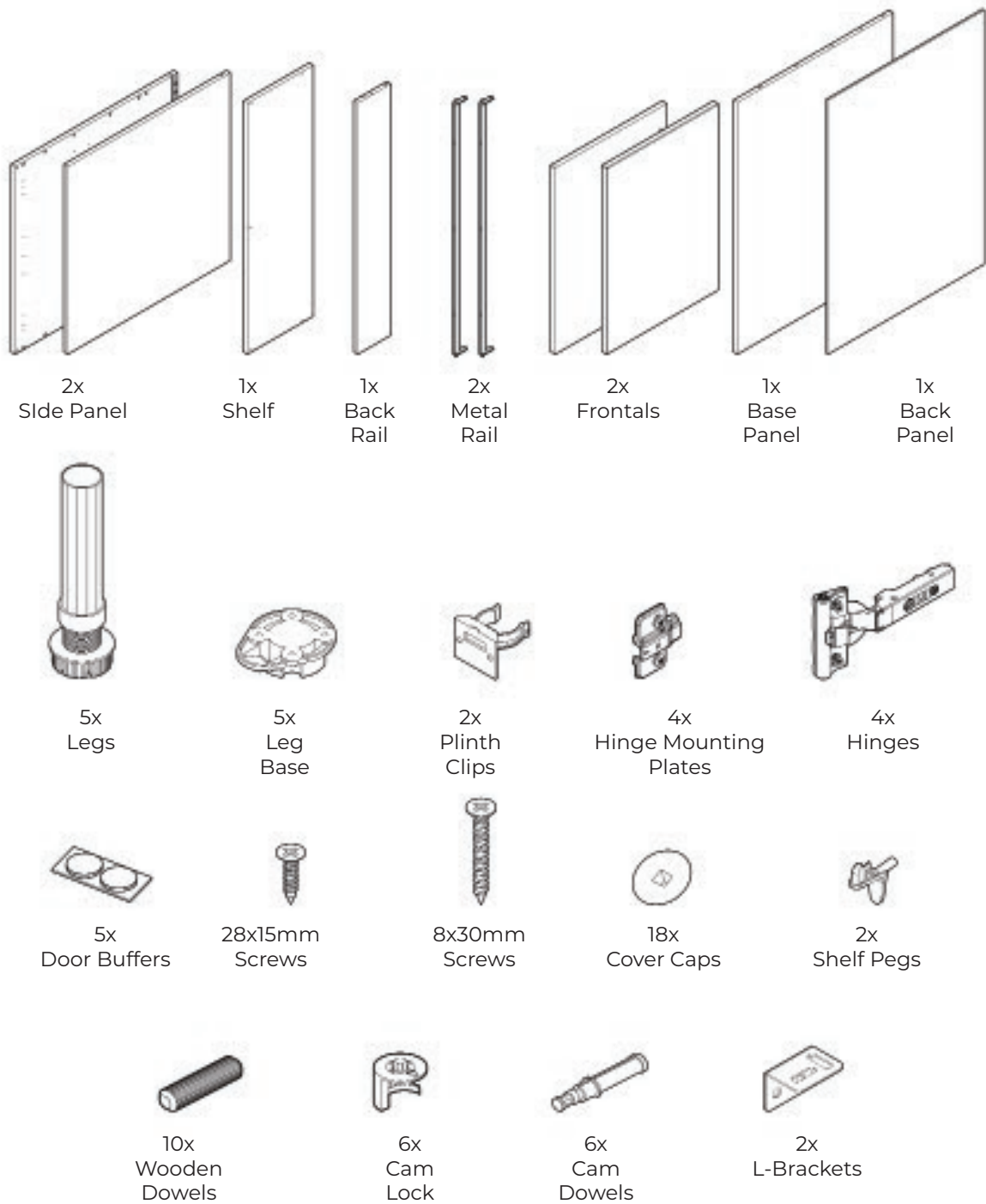

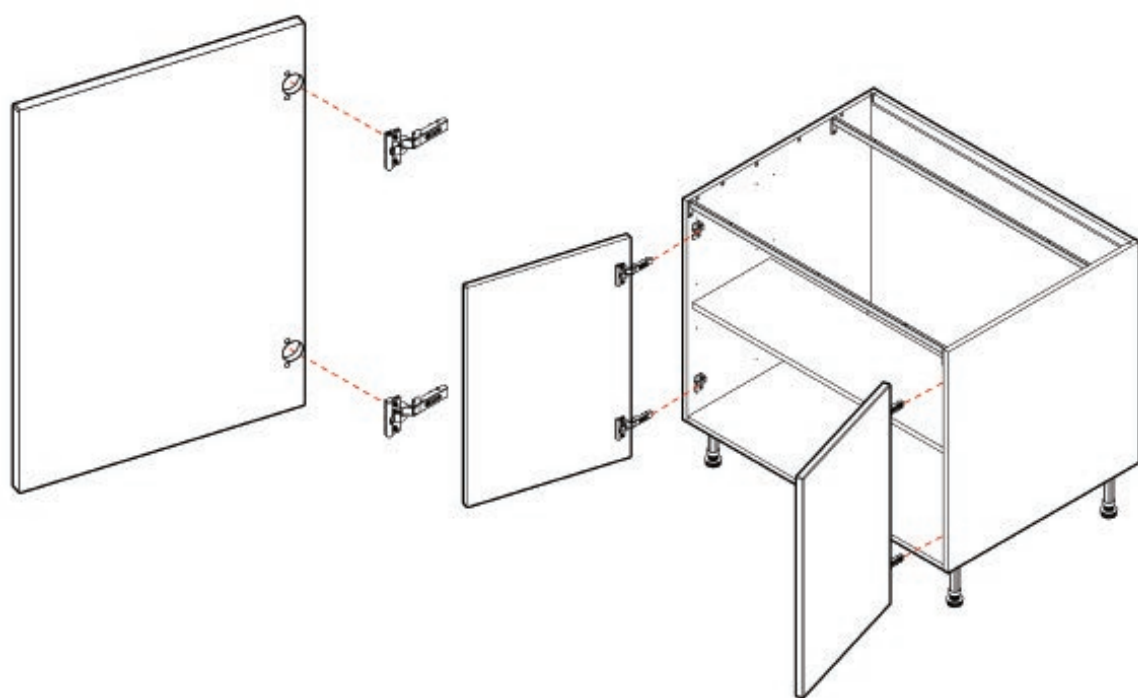
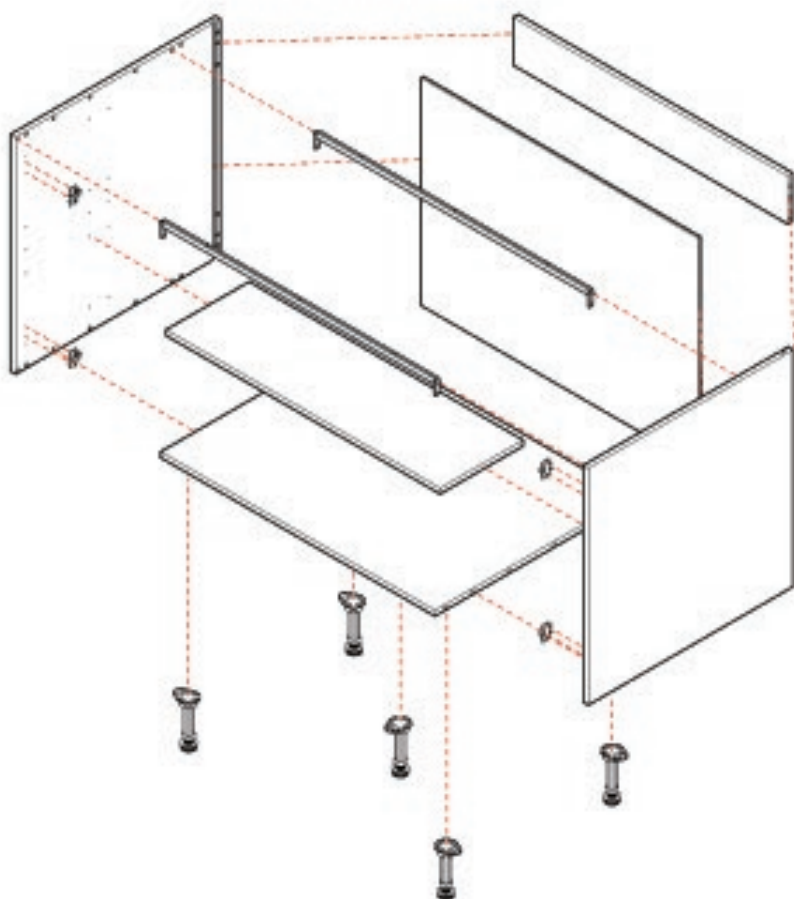

Remember to take care when unpacking. Please keep your workspace clean, clear and tidy when working. This will help keep all items safe from any damages. Any un-needed cardboard or plastic should be flattened down and placed in the bin.

Unpacking the parts and fittings

Remove all content from the packaging and ensure to familiarise yourself with all unit parts and fittings.

All parts and fittings should be kept on a clean and level surface and the frontal and shelf placed in the door safe along their longest length.

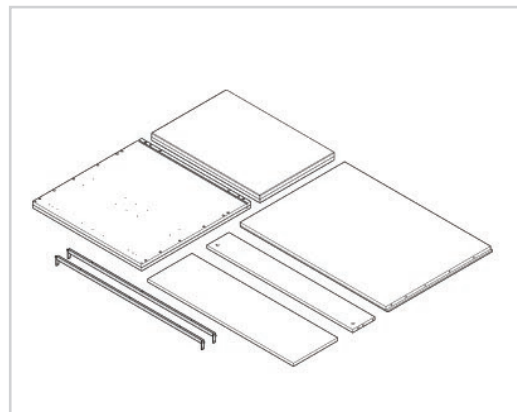

Locating the side panels

Locate the **2** side panels and place them on a soft, clean surface.

Arrange them next to each other with the holes upwards and the grooves facing each other. The hole patterns will be mirrored. See diagram.

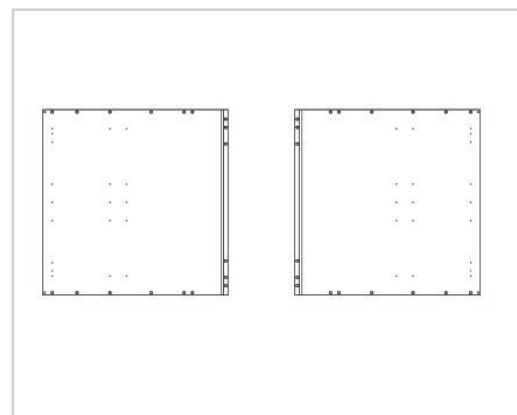

Tapping the wooden dowels into position

Place the **10x** wooden dowels into the holes highlighted in the diagram.

Using a mallet, gently tap the wooden dowels into the holes.

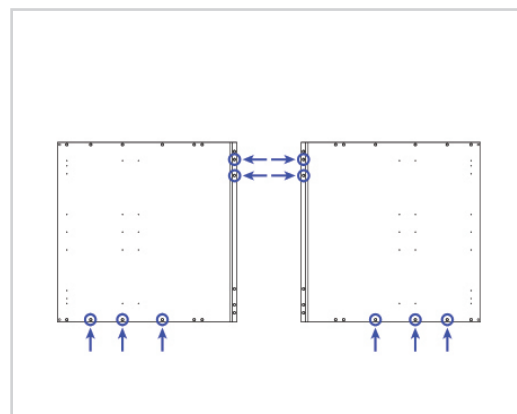
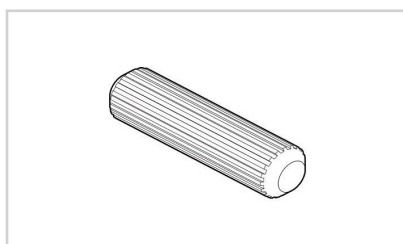

Positioning the cam dowels

Place the **6x** cam dowels in the holes shown, pressing them in by hand.

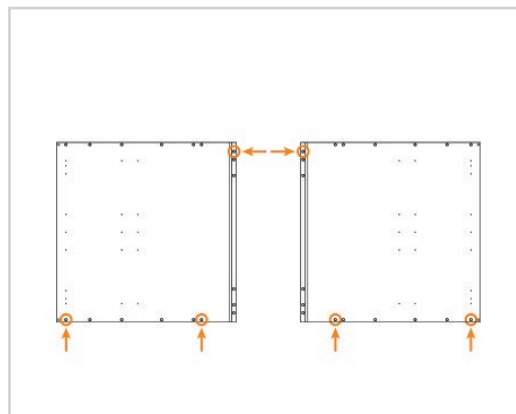
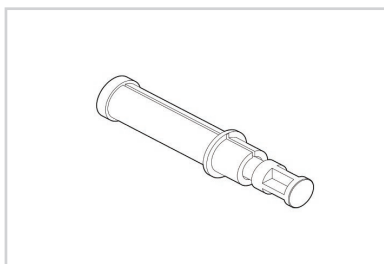

Inserting the metal rail

Insert the metal front rail into the hole shown in the diagram.

If you are fitting a hob with a separate downdraft extractor, fit the additional metal rail near the back of the unit in the hole shown on the diagram

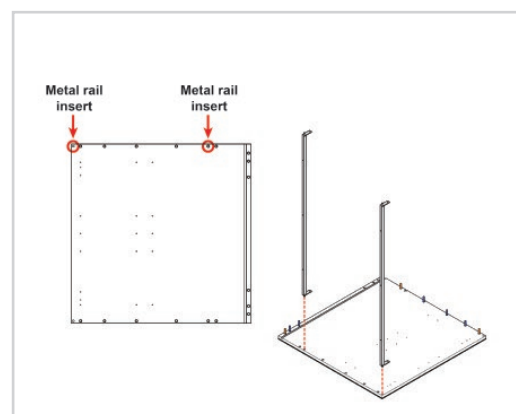

Inserting the cam locks

Insert all the **6x** cam locks into the cam holes on the base panel and back rail, as shown in the diagram.

Ensure the arrow on each cam lock points towards the nearest edge of the panel.

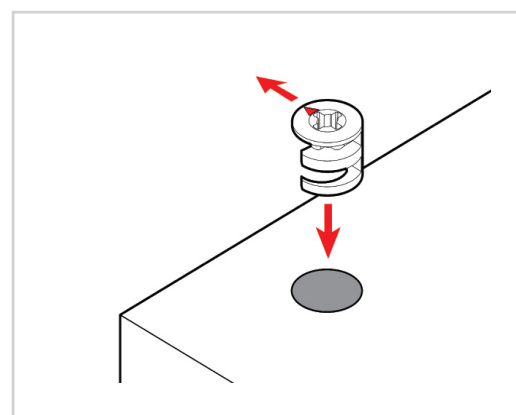

Attaching the base panel

Fit the base panel onto the left side panel, ensuring the holes for the legs are on the outside.

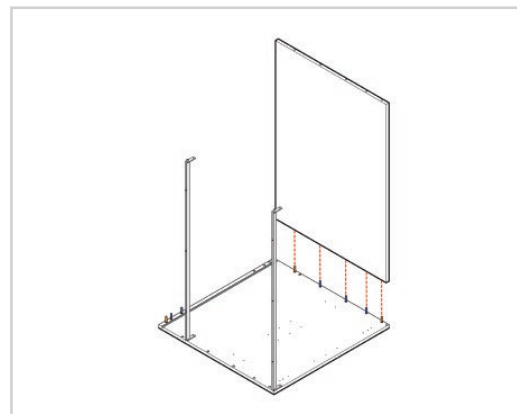

Attaching the back rail

Fit the top rail onto the left side panel.

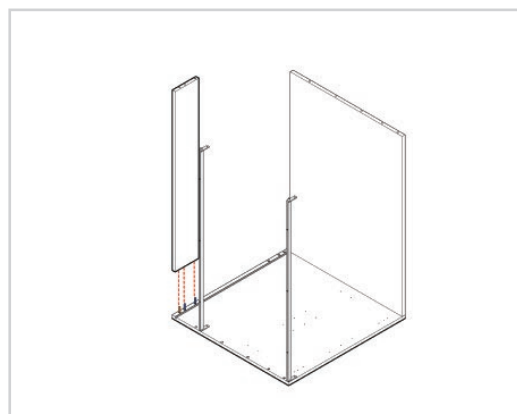

Placing the side panel into position

Place the right side panel onto the unit, taking care to align the cam and dowel holes and the metal rail.

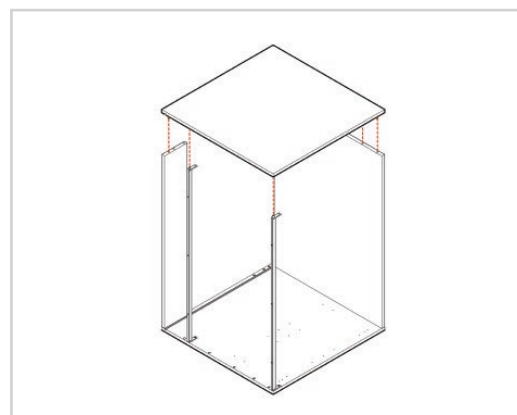

Sliding the back panel into position

At the rear of the unit, slide the back panel into the side panel grooves.

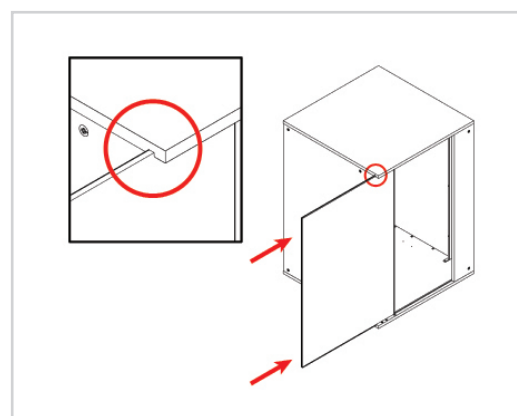

Ensure the white side of the back panel is visible from the inside of the unit.

Tightening the cam locks

All the cam locks should be manually tightened using a flathead screwdriver, the cam locks will tighten around the cam dowels.

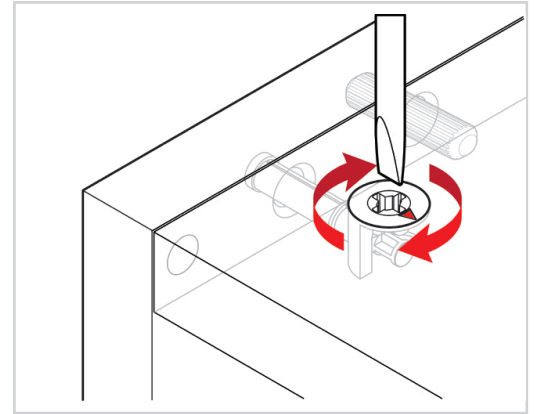

Securing the metal rails

Using a drill, secure the metal rails in place with **2x15mm** screws.

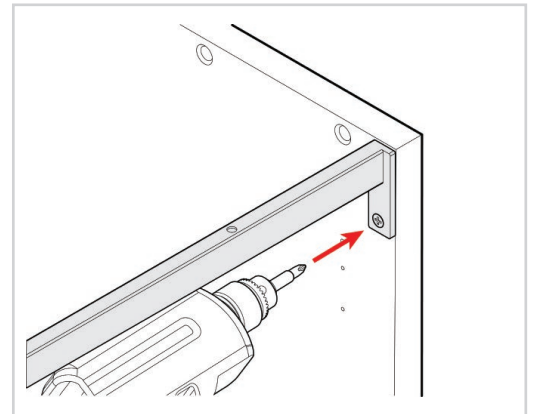

Marking the unit

Place a strip of masking tape on the bottom of the back panel.

Mark onto the masking tape four locations **9mm** from the bottom edge, ensuring the markings are distanced equally.

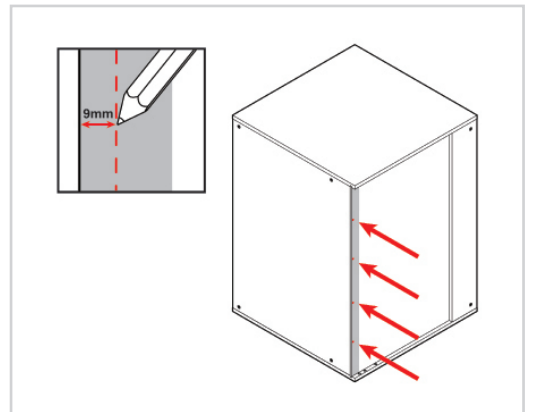

Fixing the back panel

At the **4x** marked locations, pilot drill **4x** holes.

Use **4x30mm** screws to secure the back panel to the unit.

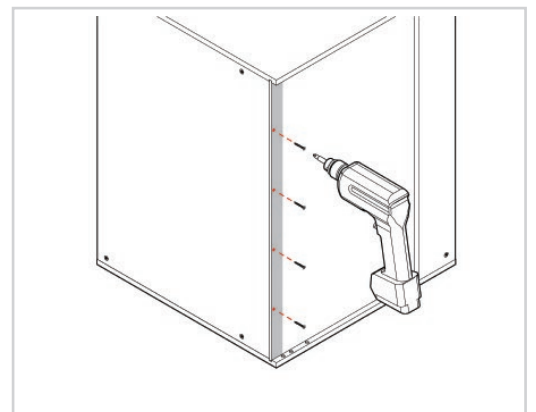

Positioning the leg bases

Mark a straight line on the underside of the unit **40mm** from the front edge.

Position two front leg bases using this line as shown. Ensure that the centre points of the leg bases are approx **55mm** from the sides of the unit. The leg bases should be rotated so that the flanges will support the side panels of the unit.

Mark a straight line on the underside of the unit **40mm** from the rear edge.

Position two rear leg bases using this line as shown. Ensure that the centre points of the leg bases are approx 55mm from the sides of the unit. The leg bases should be rotated so that the flanges will support the side panels of the unit.

The final leg base is to be positioned in the centre of the unit.

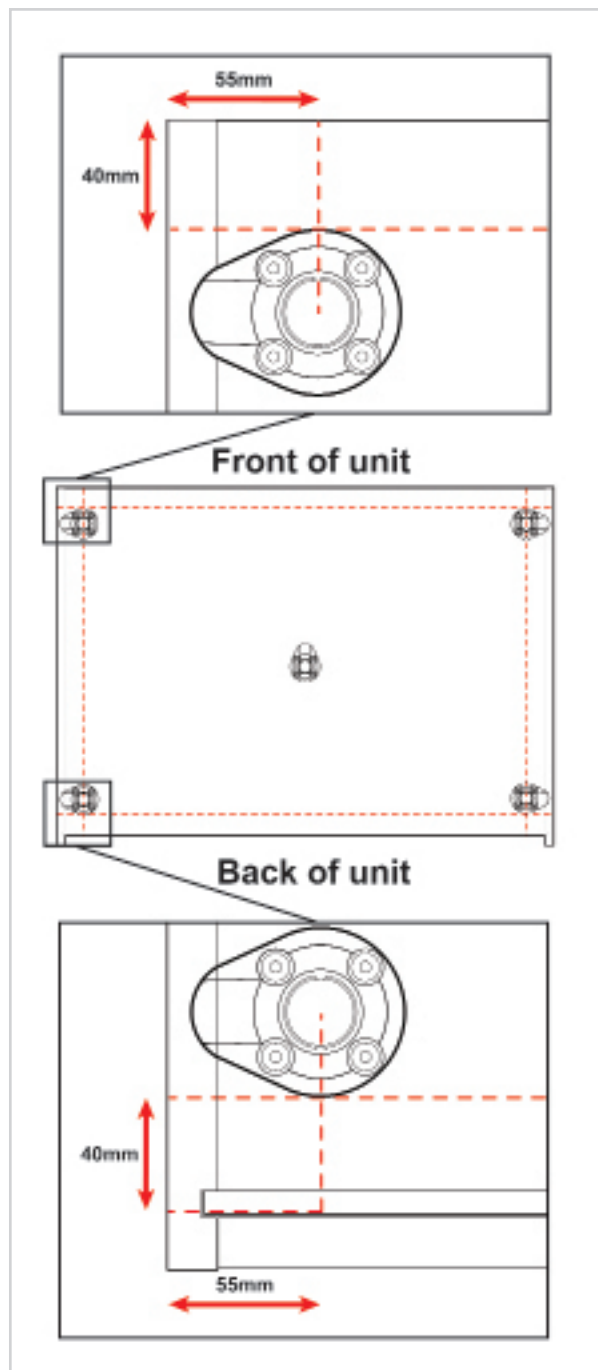

Fixing the leg bases

Secure each of the leg bases into place with **4x15mm** screws per bracket.

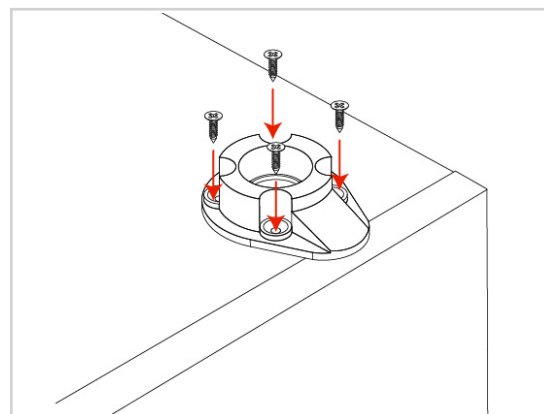

Inserting the legs

Push each leg firmly down into the leg bracket. Adjusting each leg to **165mm**.

Adjust the legs to the correct height by turning clockwise or anti-clockwise.

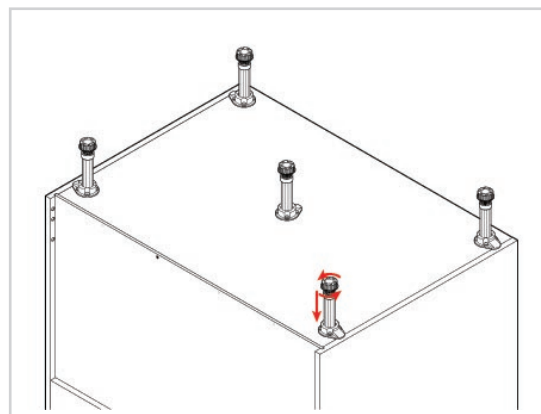

Lifting the unit into place

When lifting the unit into place do not tilt as this can damage the legs.

Place the unit in position, ensuring it aligns with the floor markings made during the room preparation stage.

Use a spirit level to ensure the unit is level from front to back, left to right, and diagonally. Adjust the legs if required.

The leg height can be adjusted by turning the foot of the leg clockwise or anti-clockwise.

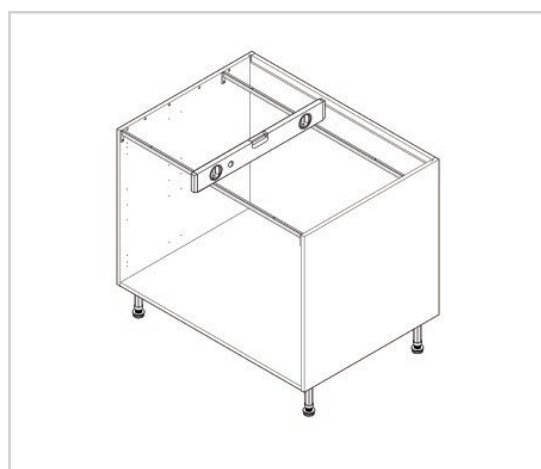

Attaching the hinge mounting plates

Attach the hinge mounting plates onto both of the end panels in the locations shown, using the screws which are already positioned within the hinge plates.

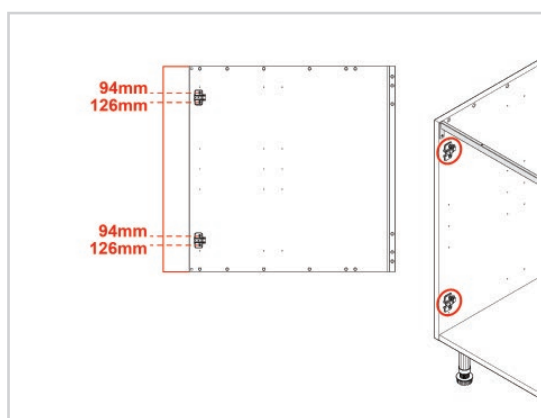

Before attaching the units together, ensure that the milano/linea profile cutouts of both units

Securing to adjacent units

Clamp together the two units, checking the front edges are level and flush.

Using the screws provided, **1x30mm** screw should be fixed into each corner of the unit side.

The screws can be concealed by placing them behind the shelf or behind the hinge plates. The cover caps can be used to hide any visible screw heads that remain.

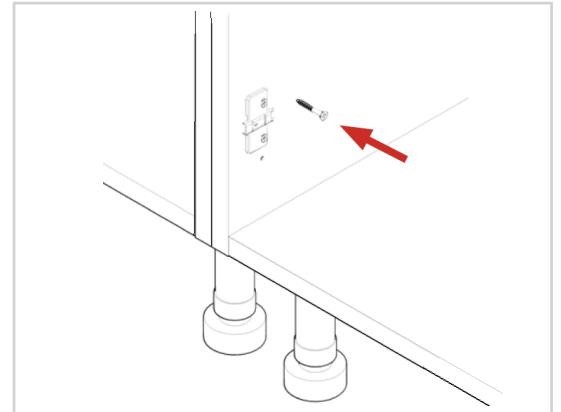

Placing the shelf into position

Position the shelf pegs into the pre-drilled holes.

Place the shelf into position so the pins of the shelf pegs are inserted into the pre-drilled holes.

The shelf should be positioned towards the front of the unit.

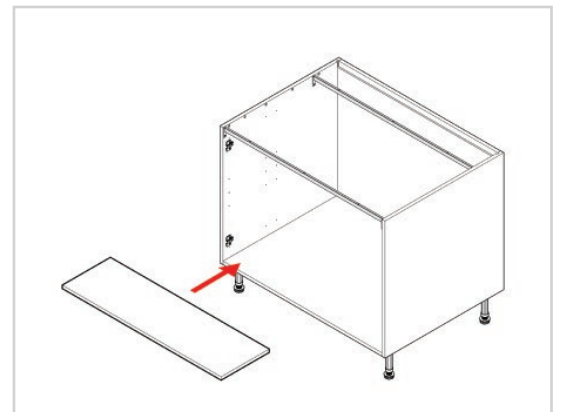

Attaching the hinges to the door

Insert hinges into the hinge holes provided. Secure the hinges with the **2x** screws already located in the hinges.

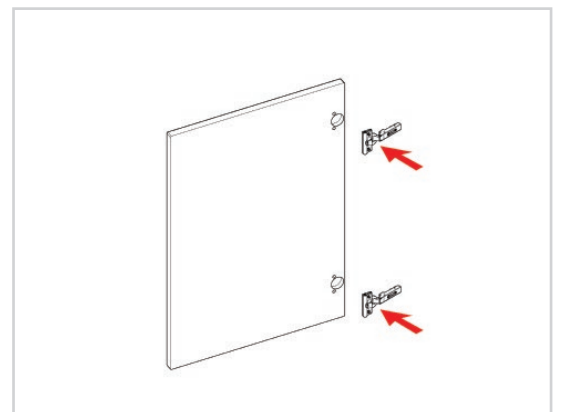

Attaching the frontal

The frontal should be attached to the unit by clipping the hinges onto the hinge plates. The bar of the hinge needs to be positioned into the hooks on the hinge plate. Then the rear of the hinge pushed to the hinge plate until it clicks.

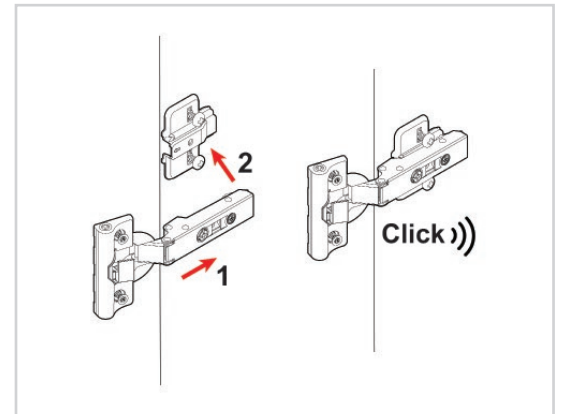

Adding the door buffers

Position **2x** door buffer at the top and bottom corners of the frontal on the unit, as illustrated in the image.

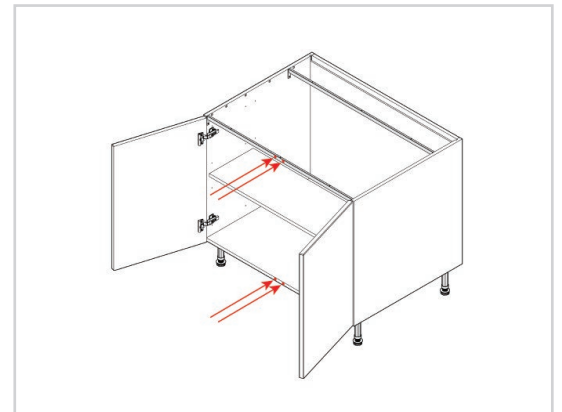

Cleaning the unit

Finally, the unit should be thoroughly cleaned to remove any debris that may have accumulated during the installation.



Store the plinth clips and the remaining 15mm screws.
These will be used later when attaching the plinth.

Store the L-brackets.
These will be used later when installing the worktop (laminate or timber).

For door alignment please review the following installation guide:
Door - Door Frontal Hinge Adjustment

Base Unit

1000mm, 2 Door Downdraft 182mm Unit (Door, Solid Top) - Fitting Guide (Flatpack)



Tools Required



Tape Measure



Mallet



Set Square

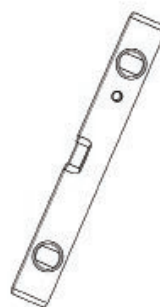

Spirit Level



Screwdriver



Drill

Unit Parts

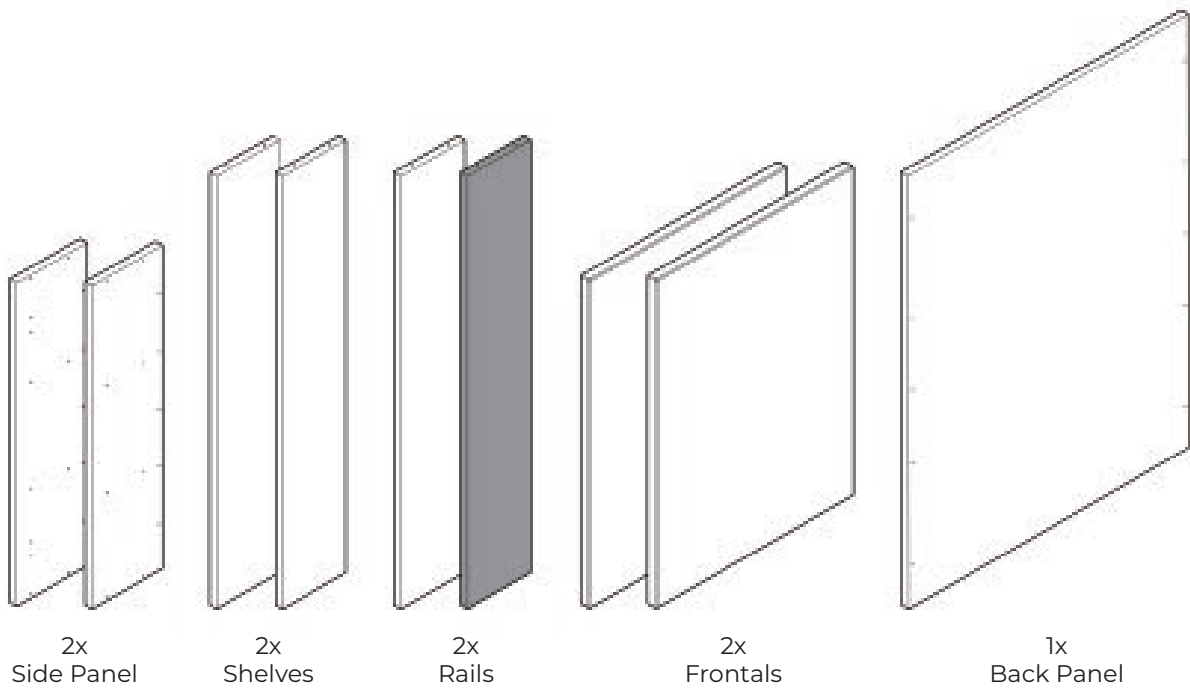

5x
Legs



5x
Leg Brackets



2x
Plinth Clips



4x
Hinge Mounting
Plates

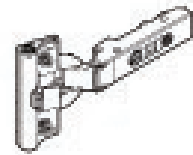

4x
Hinge



5x
Door
Buffers



20x15mm
Countsunk
Screws



4x30mm
Countsunk
Screws

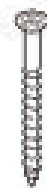

36x45mm
Countsunk
Screws



18x
Cover Caps

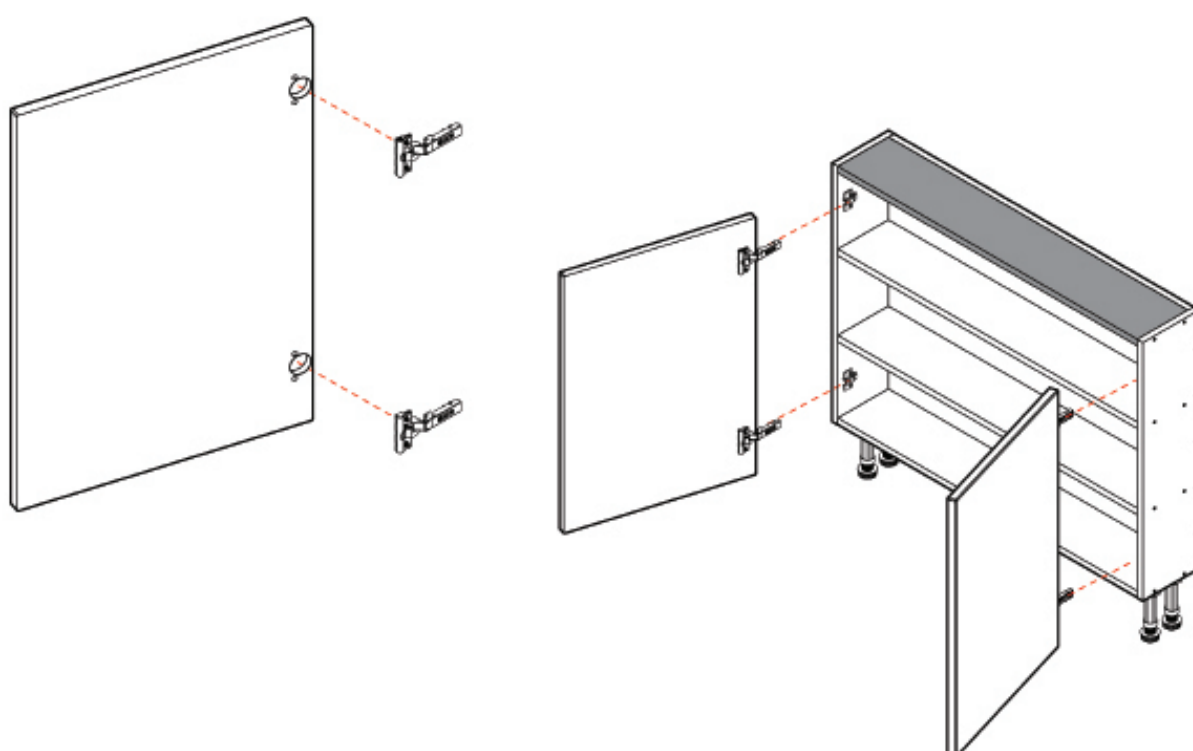
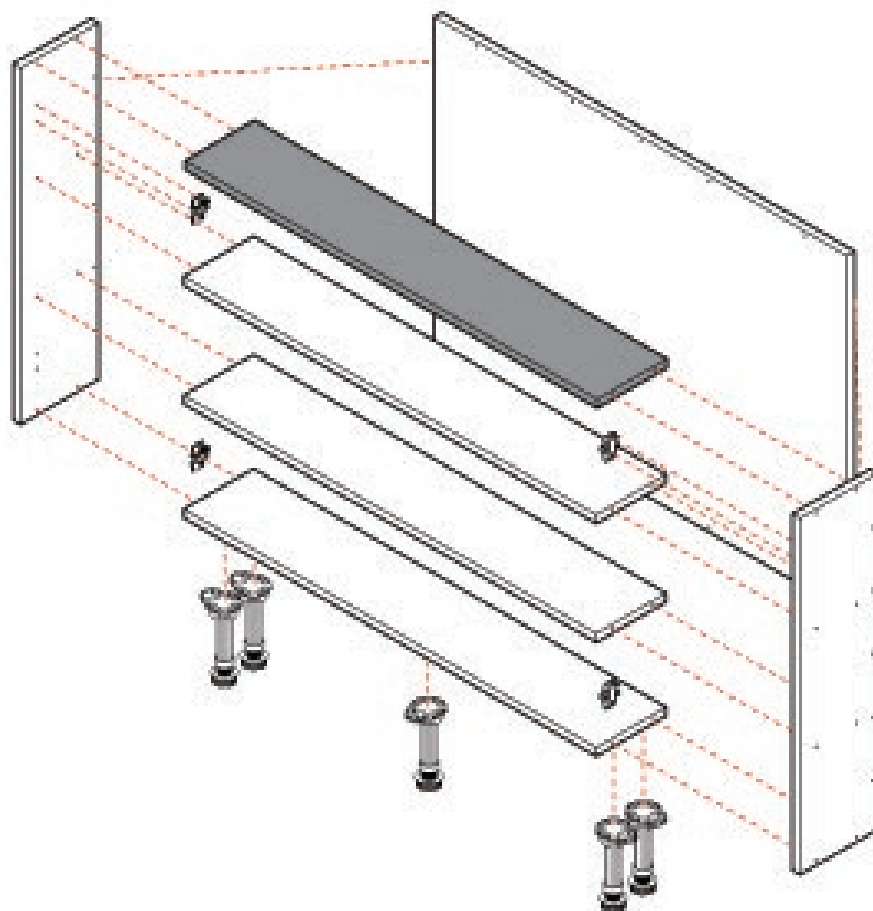

Remember to take care when unpacking. Please keep your workspace clean, clear and tidy when working. This will help keep all items safe from any damages. Any un-needed cardboard or plastic should be flattened down and placed in the bin.

Unpacking the parts and fittings

Remove all content from the packaging and ensure to familiarise yourself with all unit parts and fittings.

All parts and fittings should be kept on a clean and level surface and the frontal and shelf placed in the door safe along their longest length.

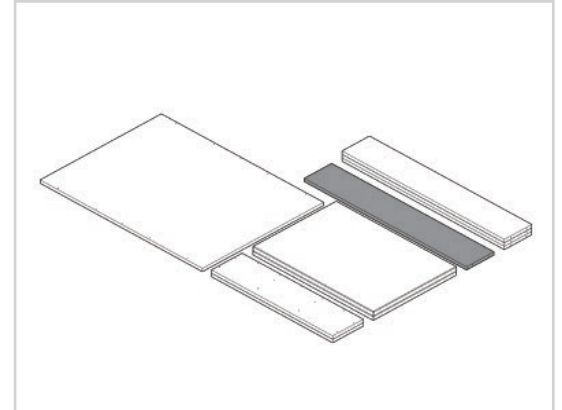

Attaching the side panels to the shelves

Attach both side panels to the shelves using **2x45mm** screws per shelf as shown. The screws should be tightened all the way in so that they allow adjacent units to be fitted.

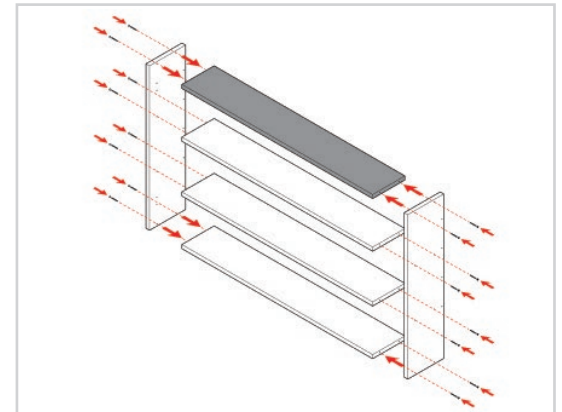

Ensure that the holes for hinge mounting plates are positioned on the inside of the unit.

The grey shelf panel is to be positioned at the top of the unit, and if you have a coloured unit edge the shelf panel with the coloured edge is to be placed at the bottom of the unit.

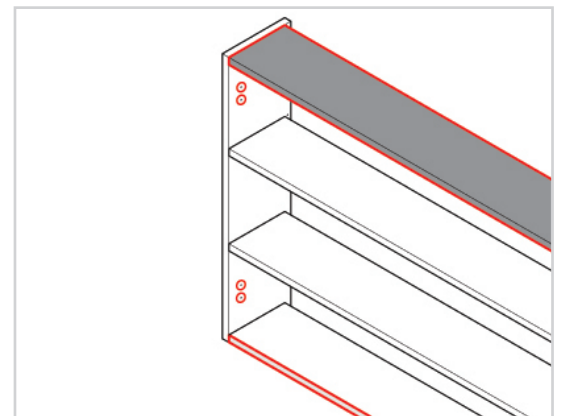

Fitting the back panel

Ensure the unit is square, then attach the back panel to the top & bottom shelves and side panels using **20x45mm** screws as shown.

If required loosen the screws holding the side panels to allow the back panel to slot into place. Once in position, re tighten the side panels.

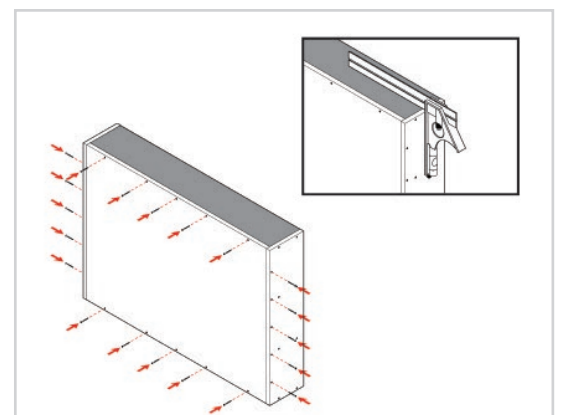

If you have a white or pebble carcass, the grey panel is the top of the unit.
The legs are to be installed in the white base panel.

Positioning the leg bases

Mark a straight line on the underside of the unit **40mm** from the front edge.

Position the two front leg bases behind this line, as shown. Ensure that the centre points of the leg bases are approx **55mm** from the sides of the unit.

The leg bases should be rotated so that the flanges will support the side panels of the unit.

Position the rear leg bases so that their centre points are **44mm** from the back of the unit and **55mm** from the sides of the unit.

Ensure that the flanges are positioned to provide extra support to the side panels.

The final leg base is to be positioned in the centre of the unit.

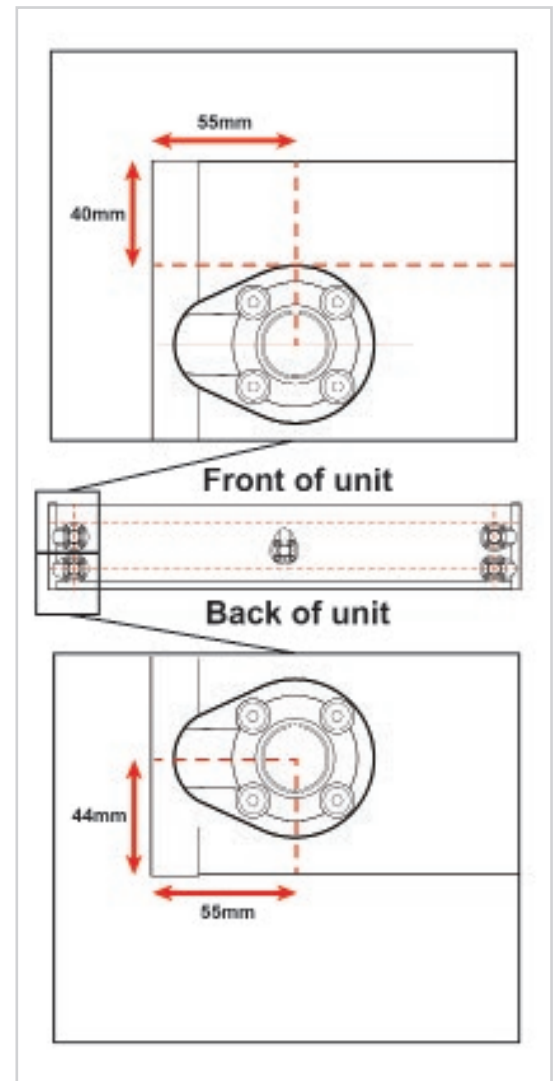

Fixing the leg bases

Secure each of the leg brackets into place with **4x15mm** screws per bracket.

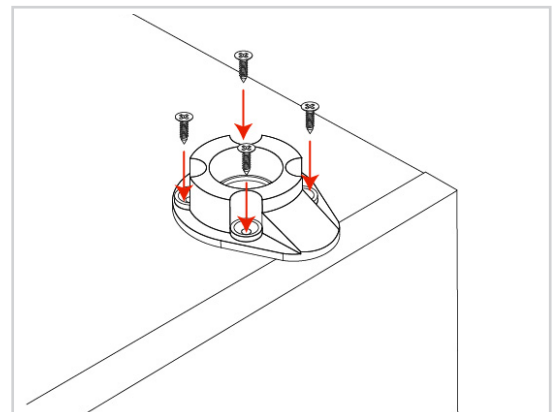

Inserting the legs

Push each leg firmly down into the leg bracket. Adjusting each leg to **165mm**.

Adjust the legs to the correct height by turning clockwise or anti-clockwise.

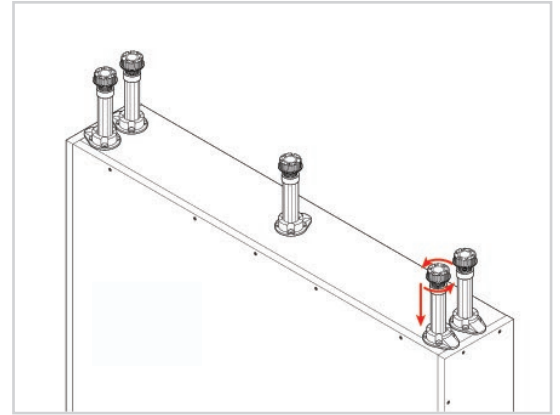

Lifting the unit into place

When lifting the unit into place do not tilt as this can damage the legs.

Place the unit against the back of the main downdraft base unit, ensuring it aligns with the floor markings made during the room preparation stage.

Use a spirit level to ensure the unit is level from front to back, left to right, and diagonally. Adjust the legs if required.

The leg height can be adjusted by turning the foot of the leg clockwise or anti-clockwise.



Fitting the hinge mounting plates

Attach the hinge mounting plates onto both of the end panels in the locations shown, using the screws which are already positioned within the hinge plates.

Ensure the arrows on the hinge plates point towards the front of the unit.

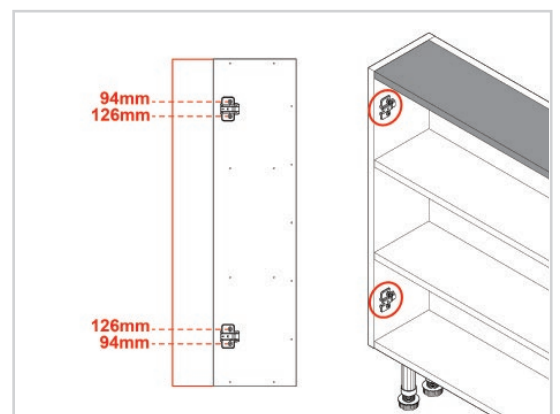

Before attaching the units together, ensure that the linea/milano profile cutouts of both units

Securing to adjacent units

Clamp together the two units, checking the front edges are level and flush.

Using the screws provided, **1x30mm** screw should be fixed into each corner of the carcase side.

The screws can be concealed by placing them behind the shelf or behind the hinge plates. The cover caps can be used to hide any visible screw heads that remain.

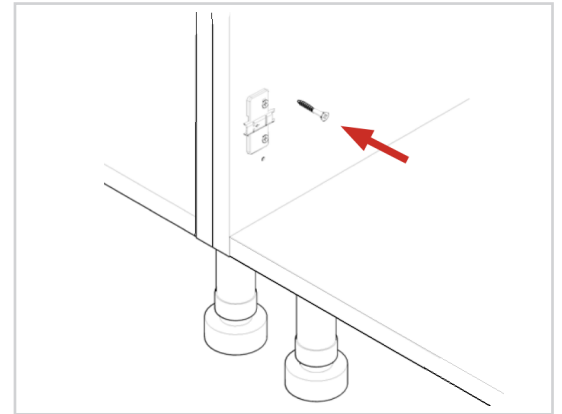

Attaching the hinges to the door

Insert the hinges into the hinge holes provided.

Secure the hinges with the **2x** screws already located in the hinges.

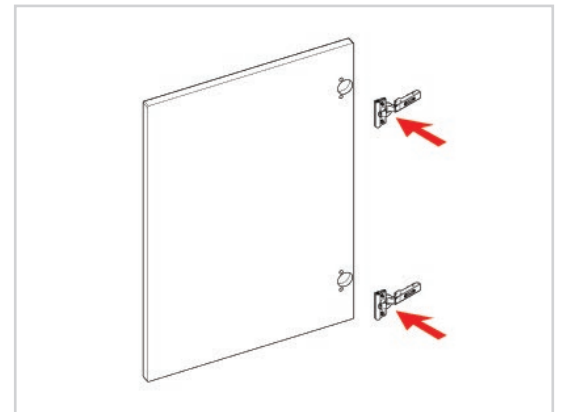

Attaching the frontal

The frontal should be attached to the unit by clipping the hinges onto the hinge plates. The bar of the hinge needs to be positioned into the hooks on the hinge plate. Then the rear of the hinge pushed to the hinge plate until it clicks.

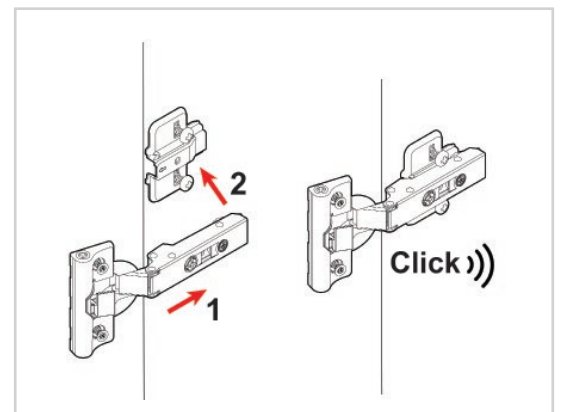

Adding the door buffers

Position **1x** door buffer at the top and bottom corners of the frontal on the unit, as illustrated in the image.

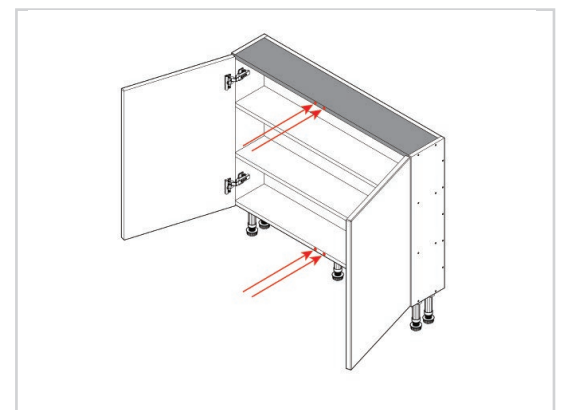

Cleaning the unit

Finally, the unit should be thoroughly cleaned to remove any debris that may have accumulated during the installation.

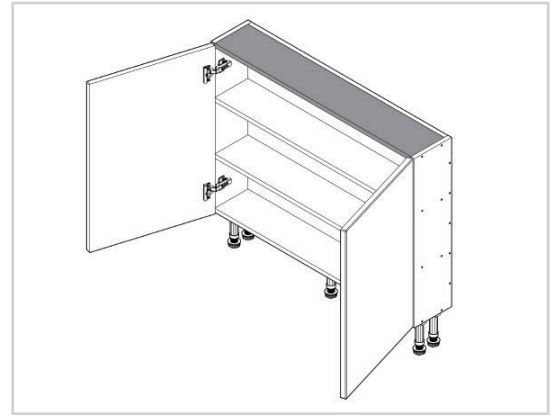

Store the plinth clips and the remaining 15mm screws.
These will be used later when attaching the plinth.

For door alignment please review the following installation guide:
Door - Door Frontal Hinge Adjustment