

# INFINITY / INFINITY PLUS

## Base Unit

### 300 - 600, Base (Drawer, Solid Top, 4 Legs) - Fitting Guide

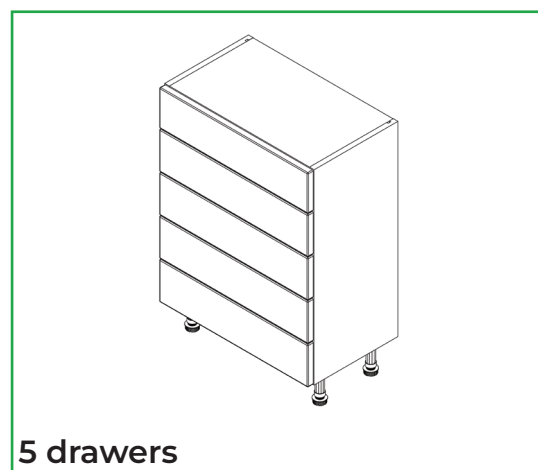
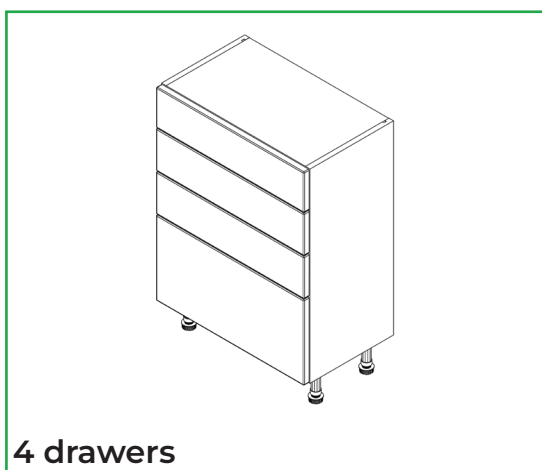
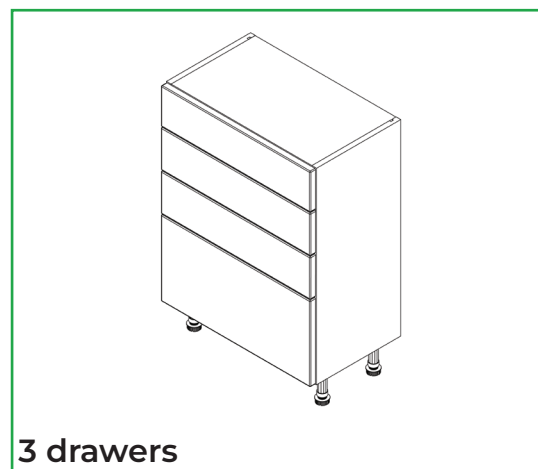
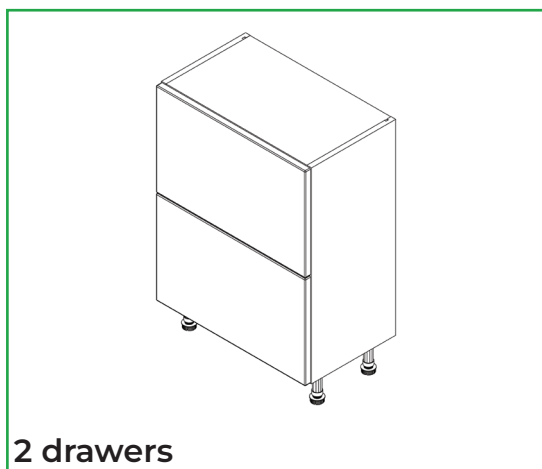

#### Unit Parts

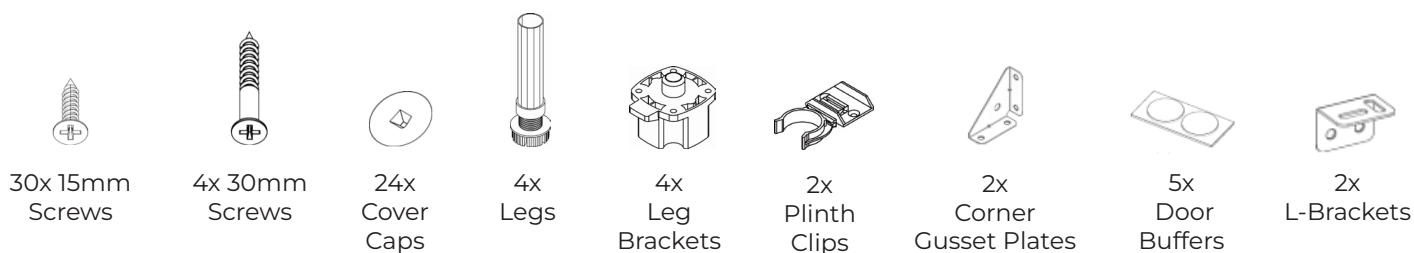

#### Tools Required



**Remember to take care when unpacking. Please keep your workspace clean, clear and tidy when working. This will help keep all items safe from any damage. Any un-needed cardboard or plastic should be flattened down and placed in the bin.**

**A minimum of two people will be needed to lift the unit.**

### **Removing the drawer, fixtures and fittings**

Remove all fixtures and fittings from the drawer and keep on a clean and level surface and grouped by product.

Before installing the unit, remove all drawers. This is done by pulling the drawer all the way out, and then pulling the front of the drawer upwards.

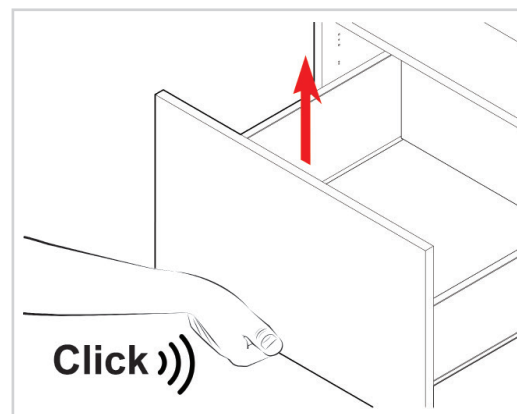

**Place the drawers on top of a piece of leftover cardboard to protect them from damage.**

### **Positioning the leg brackets**

Locate the leg brackets and position, as shown in the diagram. Ensure the leg brackets are rotated so the flange covers the outer edge, as this provides support for the edge of the unit.

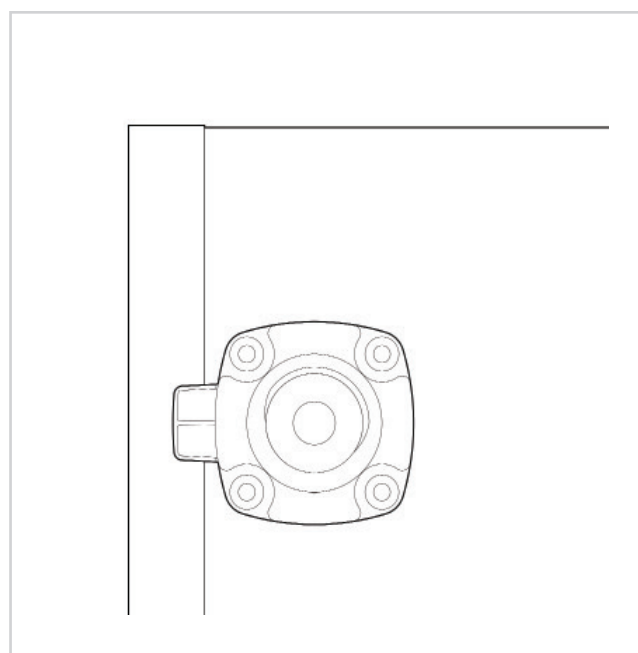
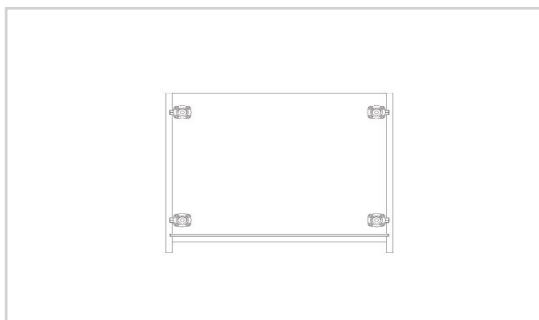

## Fixing the leg bases

Secure each of the leg brackets into place with **4x15mm** screws per bracket.

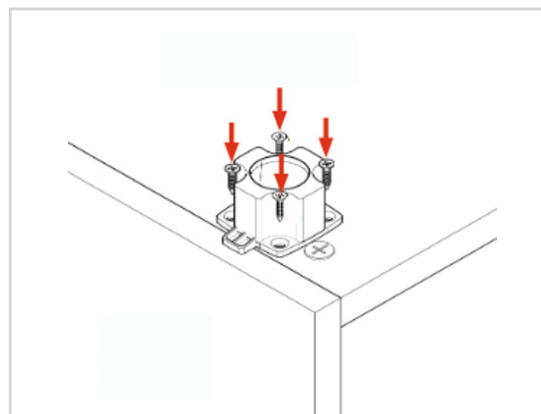

## Inserting the legs

Push each leg firmly down into the leg bracket. Adjusting each leg to **155mm**.

Adjust the legs to the correct height by turning clockwise or anti-clockwise.

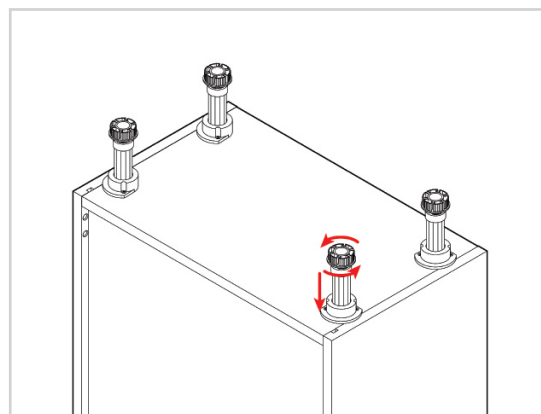

## Notching out the side panel (if required)

In order to allow for any horizontal pipework running behind the unit, some units will require the back of unit's side to be notched out.

Create a notch for the horizontal pipes at the back of the end panels using a jigsaw.

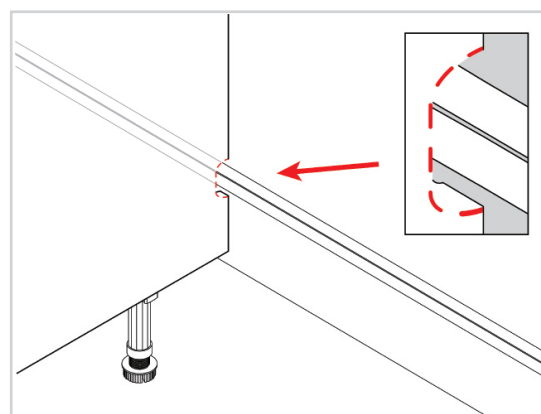

## Installing the corner gussets

Secure the corner gussets to both top corners at the back of the unit using **4x15mm** screws per gusset.

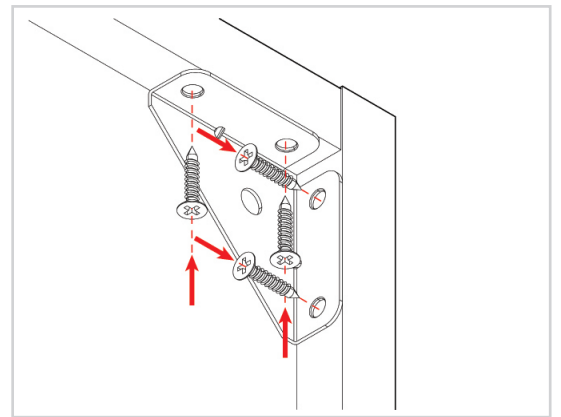
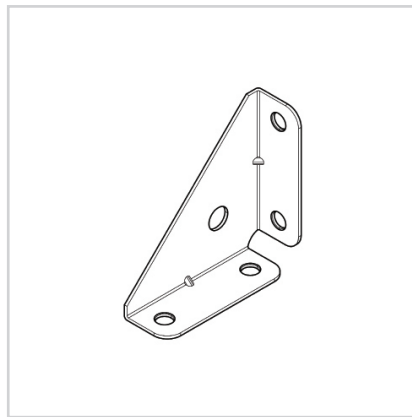
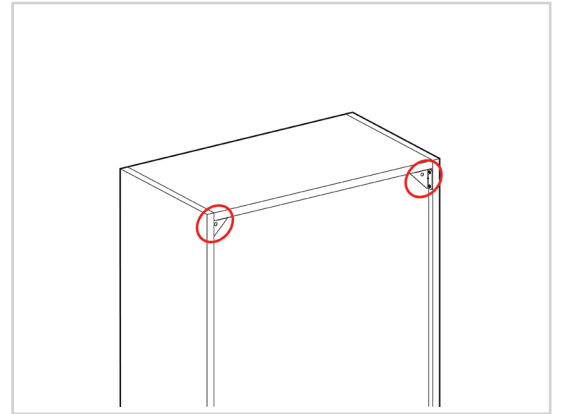

## Creating the pilot holes

Drill small pilot holes through the back panel of the unit through each gusset.

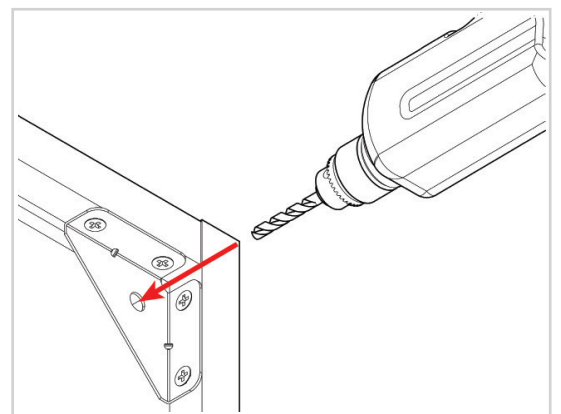

## Lifting the unit into place

When lifting the unit into place do **not** tilt as this can damage the legs.

Place the unit against the wall and align it with the wall markings that will have been drawn during the room preparation stage.

Use a spirit level to ensure the unit is level from front to back, left to right, and diagonally. Adjust the legs if required.

The leg height can be adjusted by turning the foot of the leg clockwise or anti-clockwise.

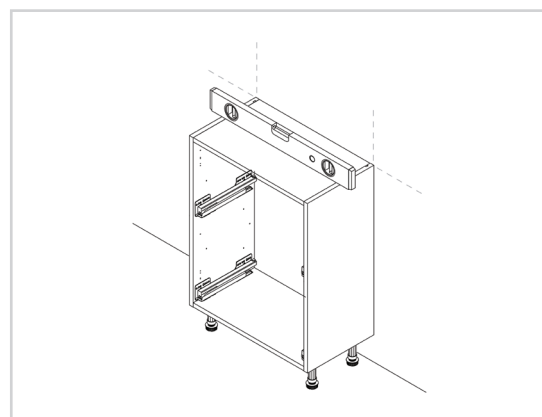

**No screws or wall plugs are provided for attaching the unit to the wall.  
This is due to variations in wall construction.**

**Before drilling into the wall you MUST check for any hidden services or pipework within the walls.**

## Drilling the wall

Once the unit is in place drill through the pilot holes and into the wall.

For guidance on the appropriate wall fixing/screws for each wall type, please consult the **"Room Preparation Guide."**

Once complete, lift and move the unit away from the wall, drill pilot holes at the marked positions.

Insert the appropriate wall plugs then lift and reposition the unit, ensuring it is level and in line with the wall markings.

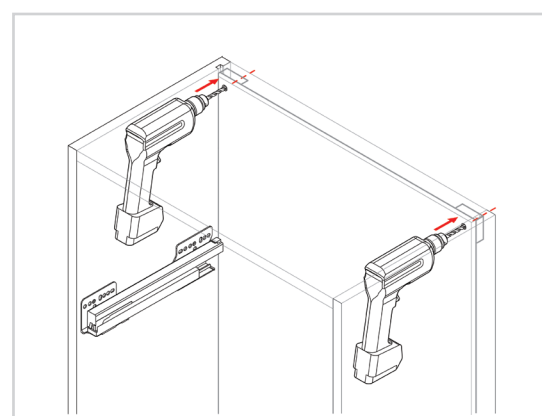

## Fixing the unit to the wall

Fix the unit to the wall using the appropriate screws.

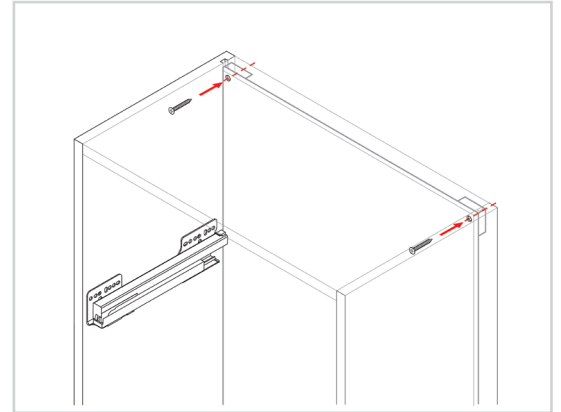

## Securing to adjacent units

Clamp together the two units, checking the front edges are level and flush.

Using the screws provided, **1x30mm** screw should be fixed into each corner of the carcass side.

The screws can be concealed by placing them behind the hinge plates. The cover caps can be used to hide any visible screw heads that remain.

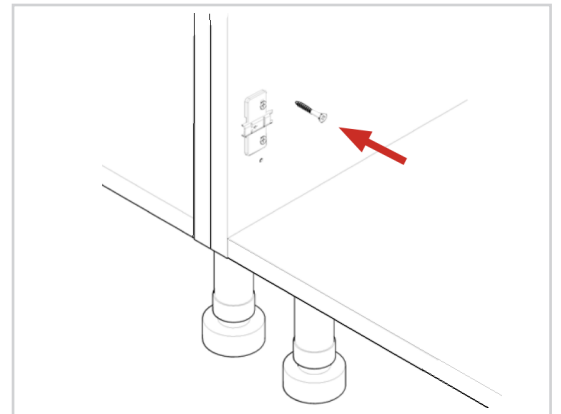

## Inserting the drawers

Slide the drawer onto the runners, make sure the runner mechanism and the drawer sides' groove line up.

Push the drawer back into the unit after it has been positioned on the runners; you should hear a click.

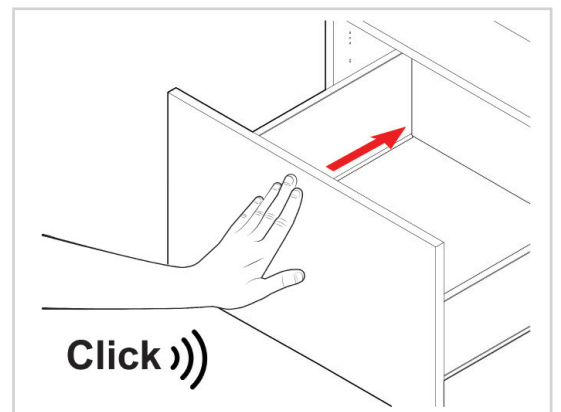

## Adding the drawer buffers

Add **1x** door buffer to each side of each drawer along the carcass edge, as shown in the diagram.

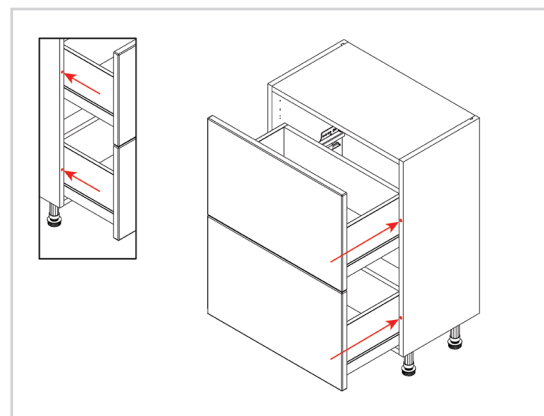

## Cleaning the unit

Finally, the unit should be thoroughly cleaned to remove any debris that may have accumulated during the installation.

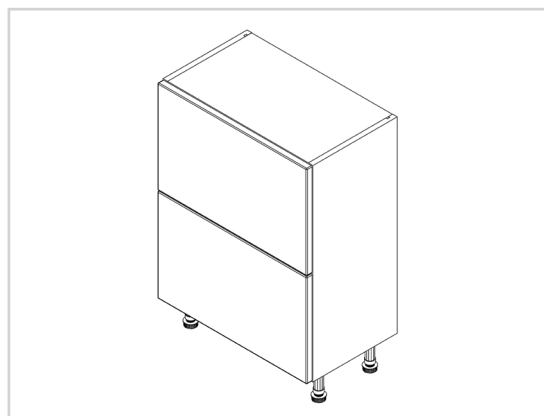

Store the plinth clips and the remaining 15mm screws.  
These will be used later when attaching the plinth.

Store the L-brackets.  
These will be used later when installing the worktop (laminated or timber).

For drawer alignment please review the following installation guide:  
**Drawer - Drawer Adjustment**