

INFINITY / INFINITY PLUS**Wall Unit****500 - 600 Dresser Unit (Door, Solid Top) - Fitting Guide****Unit Parts**32x 15mm
Screws6x 30mm
Screws18x
Cover Caps5x
Door Buffers16x
Shelf Pegs2x
L-Brackets**Tools Required**

Drill

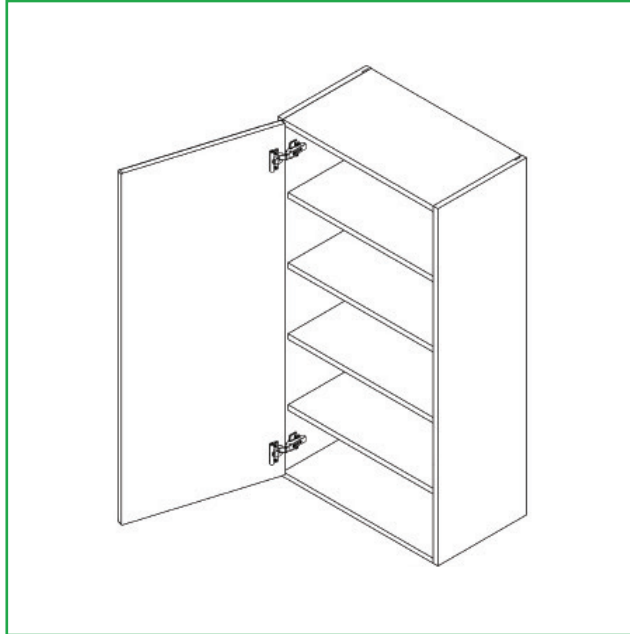

Screwdriver

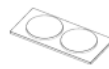

Clamp

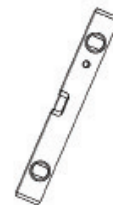

Spirit Level



Tape Measure



Before installing any wall cabinets, ensure the wall construction is strong enough to support the weight of the fully loaded unit and that appropriate fixings are used. Wall cabinets must be fully secured using all supplied hanging brackets and corner gussets, as specified in the installation guide.

If you are unsure, seek professional advice before proceeding.

Remember to take care when unpacking. Please keep your workspace clean, clear and tidy when working. This will help keep all items safe from any damage. Any un-needed cardboard or plastic should be flattened down and placed in the bin.

A minimum of two people will be needed to lift the unit.

Before lifting the dresser into position, the worktop needs to be in place.

Removing the frontal

Before installing the unit, remove the frontal by pulling the release catch.

Place the frontal in the door safe along its longest length.

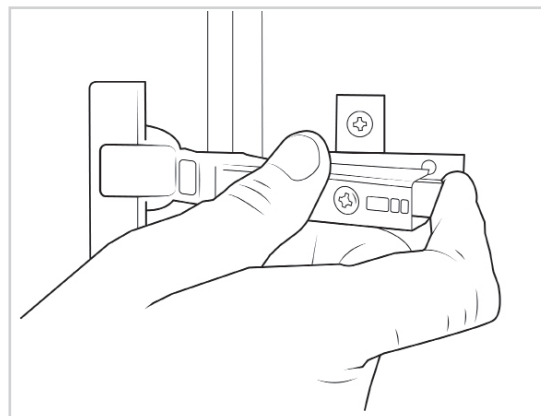

Removing the fittings

Remove all content so the unit is empty.

All fittings should be kept on a clean and level surface and the shelves placed in the door safe along their longest lengths.

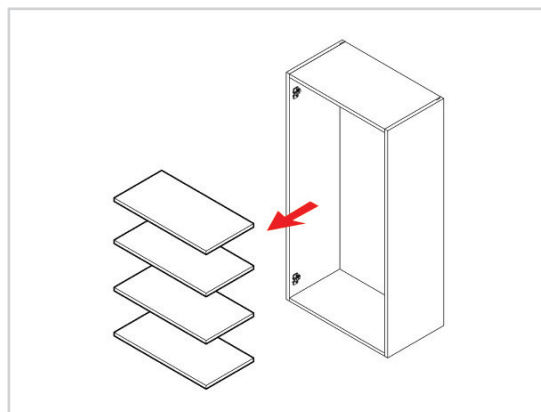

Securing the L brackets to the unit

Secure the L-brackets on top and to the rear of the unit using **2x15mm** screws at each side.

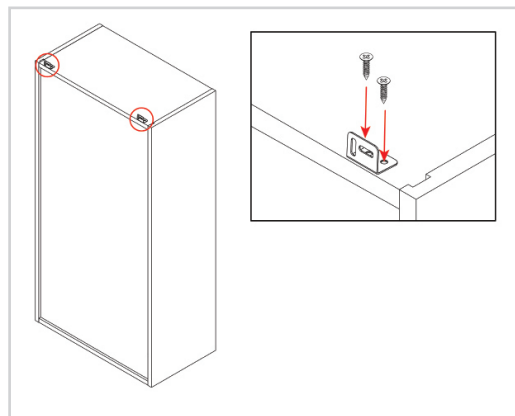

Lifting the unit into place

Lift the unit into place against the wall and align it with the wall markings that will have been drawn during the room preparation stage.

Use a spirit level to ensure the unit is level from front to back, left to right, and diagonally.

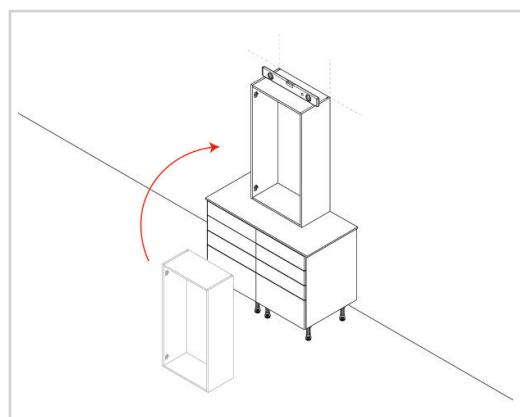

No screws or wall plugs are provided for attaching the unit to the wall. This is due to variations in wall construction.

Before drilling into the wall you MUST check for any hidden services or pipework within the walls.

Securing the unit to the wall

Fix the unit to the wall through the L-brackets as shown in the image (these fixings are not provided).

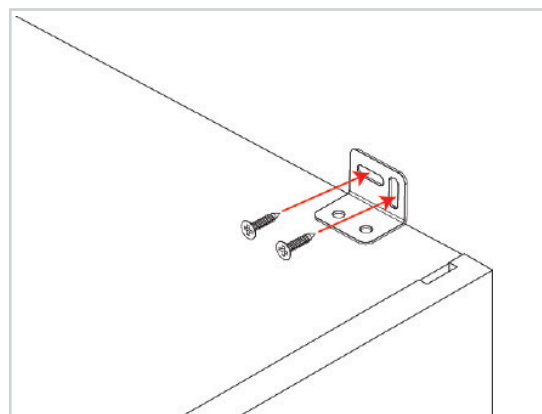

Securing to adjacent unit

Clamp together the two units, checking the front edges are level and flush.

Using the screws provided, **1x30mm** screw should be fixed into each corner of the carcass side.

The screws can be concealed by placing them behind the shelf. The **cover caps** can be used to hide any visible screw heads that remain.

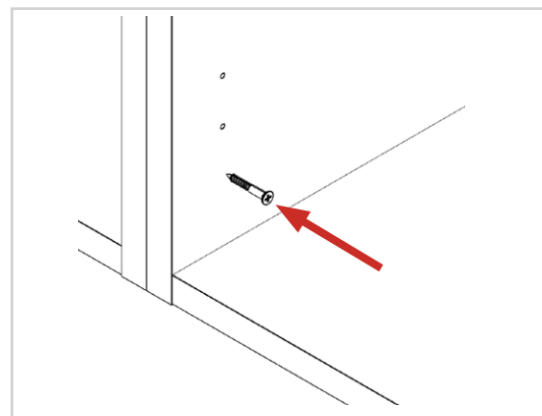

Inserting the shelves into position

The shelf touches the back panel when installed, if there is a gap between the back panel and shelf then the shelf has been installed back to front and the shelf needs to be rotated.

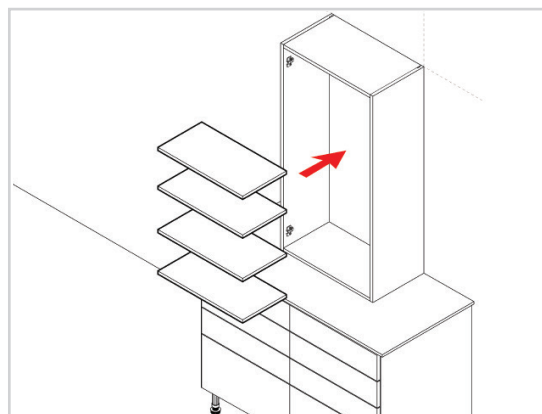

Attaching the frontal

The frontal should be re- attached to the unit by clipping the hinges onto the hinge plates. The bar of the hinge needs to be positioned into the hooks on the hinge plate. Then the rear of the hinge pushed to the hinge plate until it clicks.

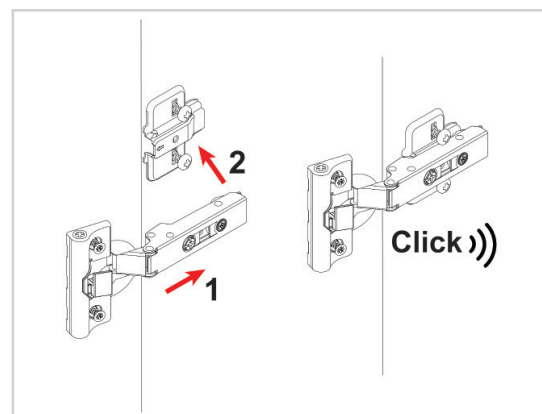

Adding the door buffers

Position **1x** door buffer at the top and bottom corners of the carcass, as illustrated in the image.

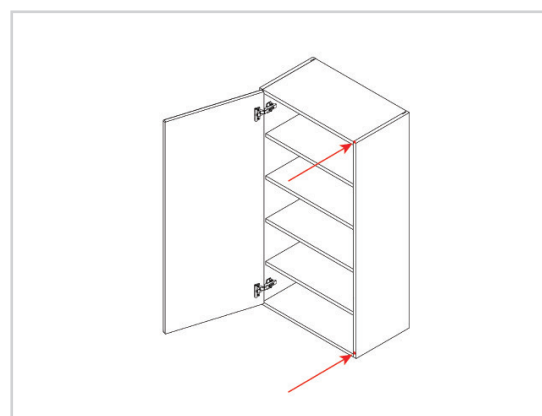

Cleaning the unit

Finally, the unit should be thoroughly cleaned to remove any debris that may have accumulated during the installation.

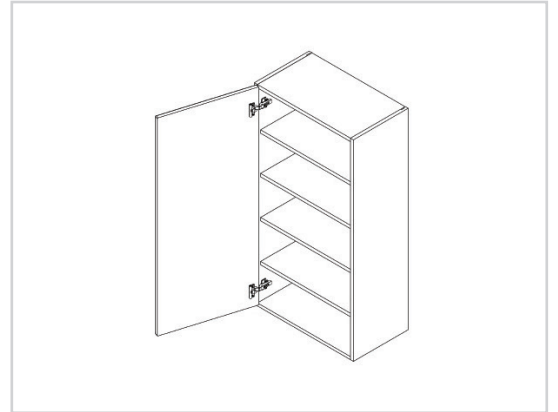

For door alignment please review the following installation guide:
Door - Door Frontal Hinge Adjustment