

EASY-FIT SOFT CLOSE

**wren**  
KITCHENS

# BASE UNIT

## 600mm Microwave Base (Drawer, Open Top, 4 Legs) - Fitting Guide

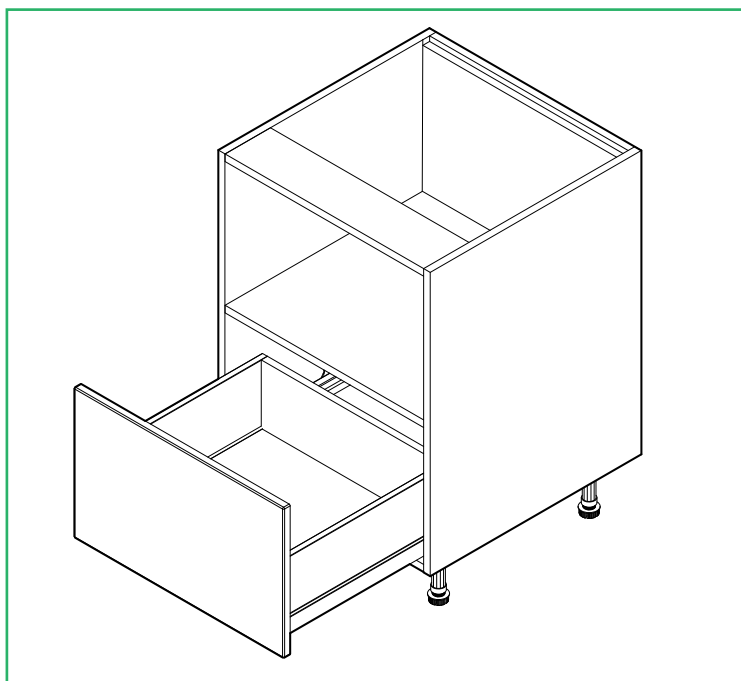

### Unit Parts



32x  
15mm  
Screws



6x  
30mm  
Screws

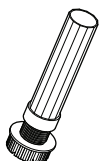

4x  
Legs

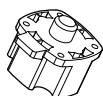

4x  
Leg  
Brackets

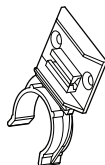

2x  
Plinth  
Clips



5x  
Drawer  
Buffers



32x  
Cover  
Caps

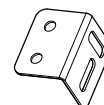

2x  
L-Brackets

### Tools Required

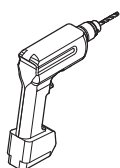

Drill

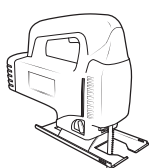

Jigsaw



Mallet

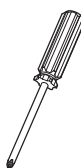

Screwdriver

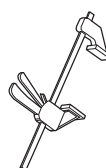

Clamp



Spirit Level

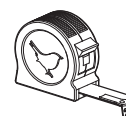

Tape Measure

Remember to take care when unpacking. Please keep your workspace clean, clear, and tidy when working. This will help keep all items safe from damage. Any waste cardboard or plastic should be flattened down and placed in the trash can.

A minimum of two people will be needed to lift the cabinet.

### Removing the drawer, fixtures and fittings

Remove all fixtures and fittings from the drawer and keep on a clean and level surface and grouped by product.

Before installing the unit, remove all drawers. This is done by pulling the drawer all the way out, and then pulling the front of the drawer upwards.

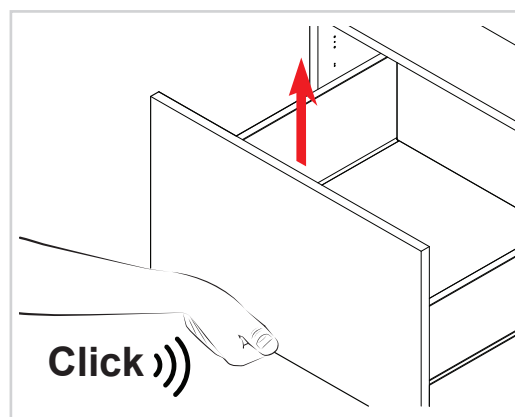

Place the drawers on top of a piece of leftover cardboard to protect them from damage.

### Positioning the leg brackets

Locate the leg brackets and position, as shown in the diagram. Ensure the leg brackets are rotated so the flange covers the outer edge, as this provides support for the edge of the unit.

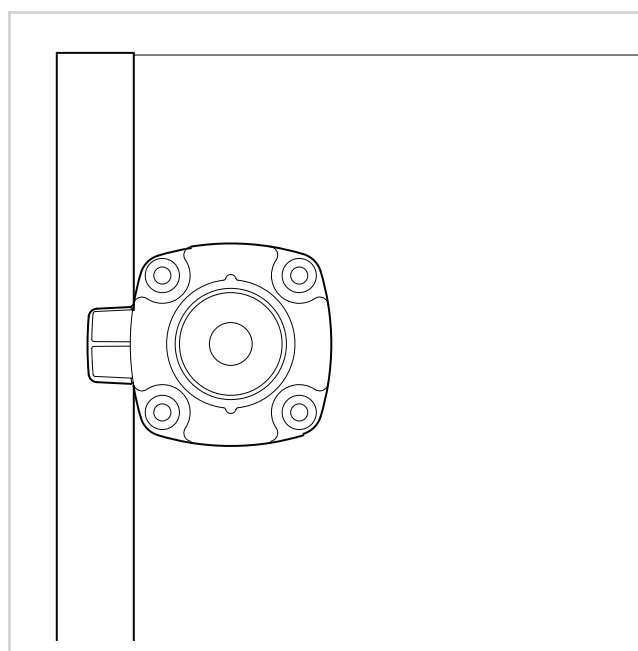
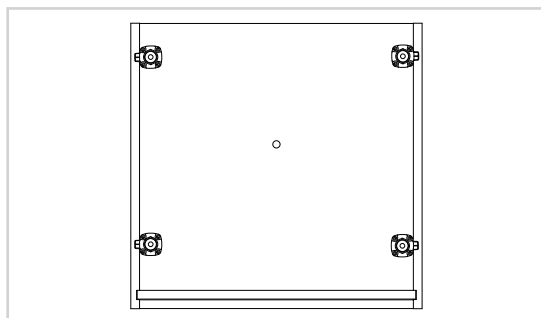

## Fixing the leg brackets

Secure each of the leg brackets into place with **4x15mm** screws per bracket.

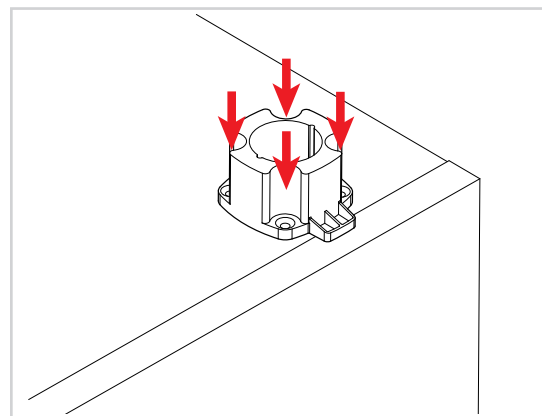
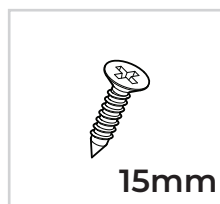

## Inserting the legs

Push each leg firmly down into the leg bracket. Adjusting each leg to **155mm**.

Adjust the legs to the correct height by turning clockwise or anti-clockwise.

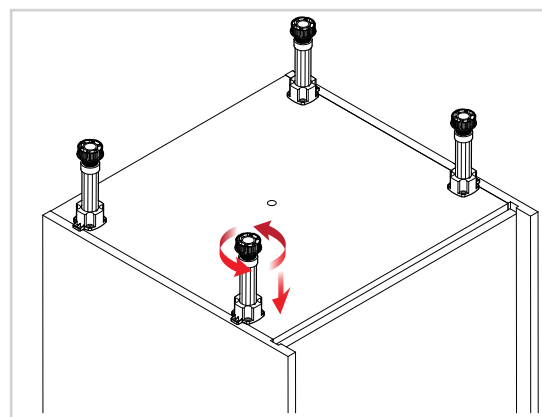

## Notching out the side panels (when required)

In order to allow for any horizontal pipework running behind the unit, some units will require the back of unit's side to be notched out.

Create a notch for the horizontal pipes at the back of the end panels using a jigsaw.

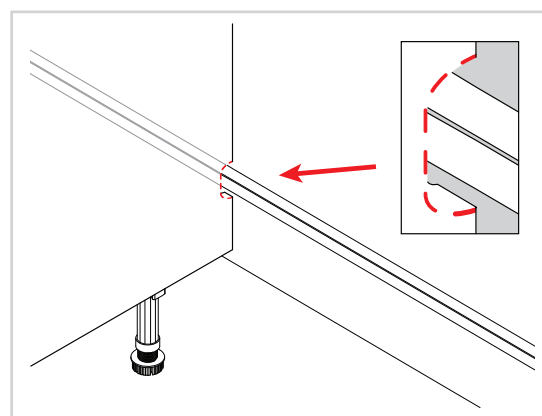

## Lifting the unit into place

When lifting the unit into place do **not** tilt as this can damage the legs.

Place the unit against the wall and align it with the wall markings that will have been drawn during the room preparation stage.

Use a spirit level to ensure the unit is level from front to back, left to right, and diagonally. Adjust the legs if required.

The leg height can be adjusted by turning the foot of the leg clockwise or anti-clockwise.

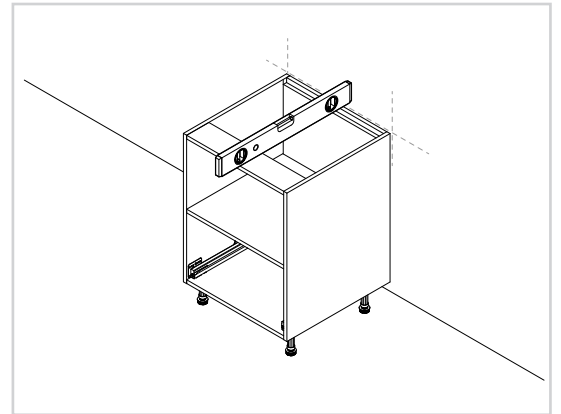

**Before drilling into the wall, you MUST check for any hidden services or pipework within the walls.**

## Drilling the cabinet and wall

Drill a hole through both the rear top rail and the wall at the marked locations.

For guidance on the appropriate wall fixing/screws for each wall type, please consult the **“Room Preparation Guide.”**

Once complete, lift and move the cabinet away from the wall, then drill a pilot hole at the marked position.

Lift and reposition the unit, ensuring it is level and in line with the wall markings.

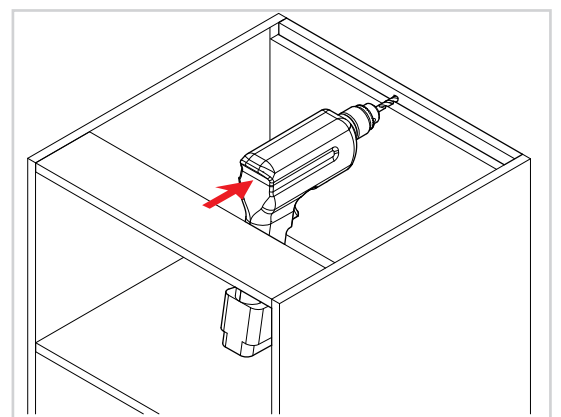

No screws are provided for attaching the cabinet to the wall.  
This is due to variations in wall construction.

### Inserting the screw

Insert the screw into the drilled hole and tighten it to the wall.

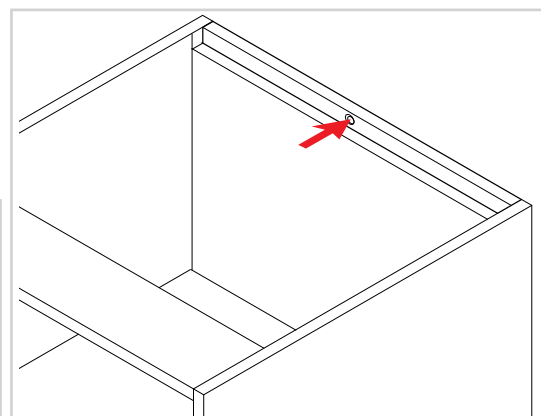

### Securing to adjacent units

Clamp together the two units, checking the front edges are level and flush.

Using the screws provided, **1x30mm** screw should be fixed into each corner of the carcass side.

The screws can be concealed by placing them behind the shelf or behind the hinge plates. The cover caps can be used to hide any visible screw heads that remain.

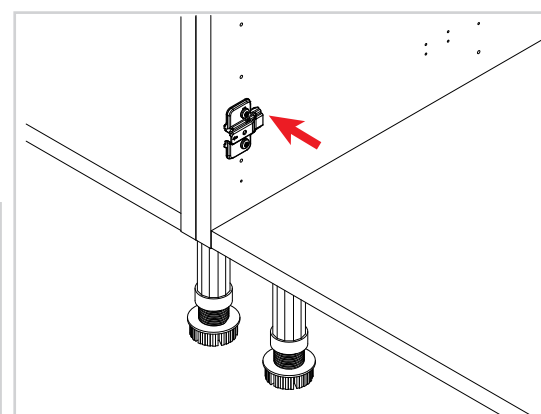

### Inserting the drawer

Slide the drawer onto the runner, making sure the runner mechanism and the drawer side grooves line up.

Once positioned on the runners, push the drawer back into the cabinet. You will hear a click when it is inserted correctly.

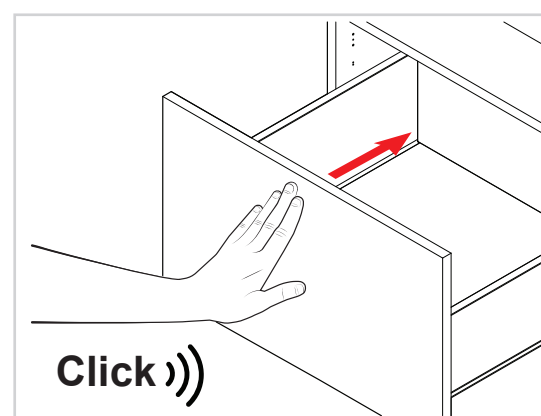

## Adjusting the frontal horizontally

In order to adjust the drawer, you must use the fixing clips, these can be found underneath the drawer, attached to the frontal.

**Step 1** - Press and hold both fixing clips level with the runners on the underside of the drawer.

**Step 2** - Slide the drawer left or right to adjust to the desired position.

**Step 3** - When positioned correctly, lock the drawer in place by releasing the fastening clips back into position on both sides of the drawer.

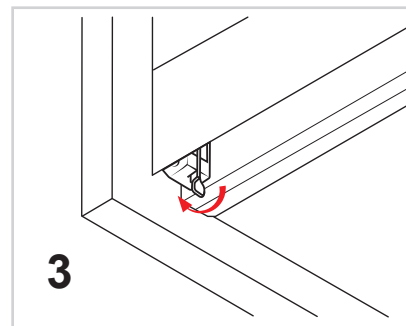
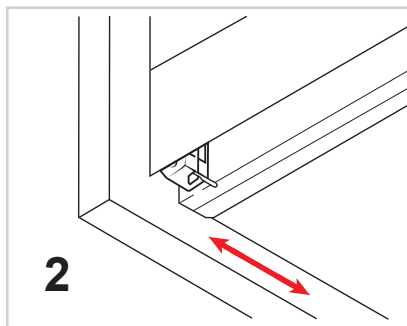
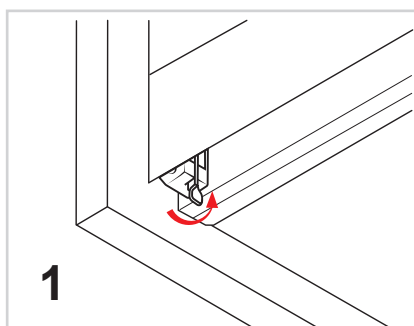
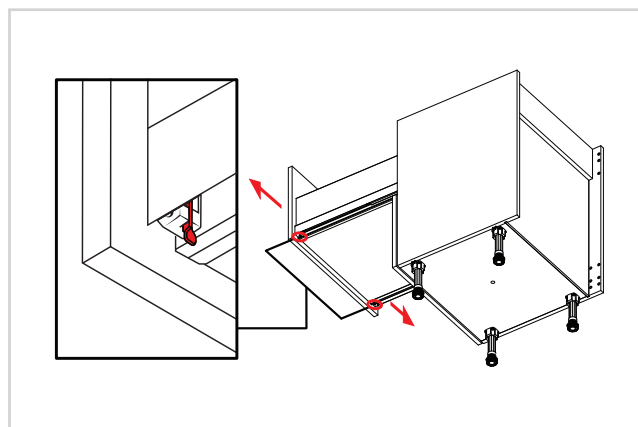

## Adjusting the frontal height

To adjust the height of the frontal, use a Phillips screwdriver as required at **points 1** and **2**.

**Step 1** - Loosen both of the screws at **point 1**.

**Step 2** - Turn the screw at **point 2** to adjust the frontal's height. For the frontal to move up, turn the screw right and for the frontal to move down, turn the screw left.

**Step 3** - Once in the desired position re-tighten the screws at **point 1**.

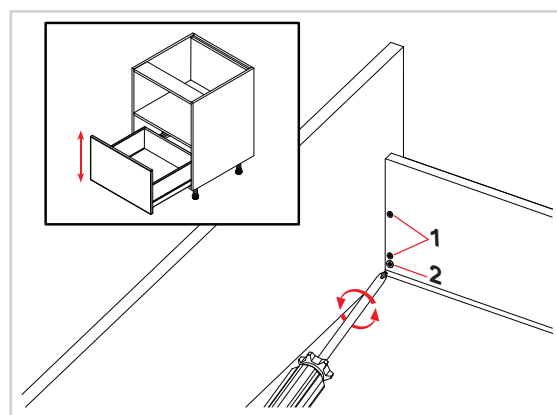

## Adjusting the rear drawer

To adjust the rear elevation of the drawer, use a Phillips screwdriver to turn the screw located at the back of the drawer.

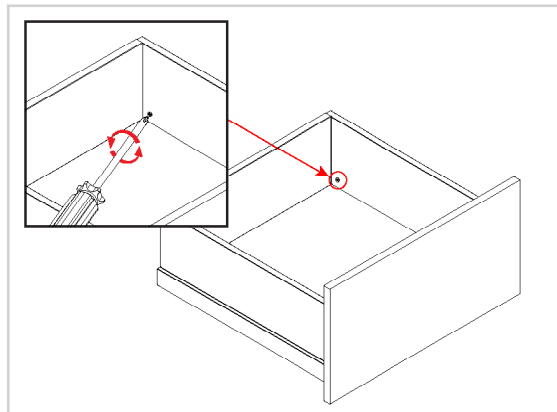

## Adding the drawer buffers

Add **1x** door buffer to each side of the drawer along the cabinet edge, as shown in the image.

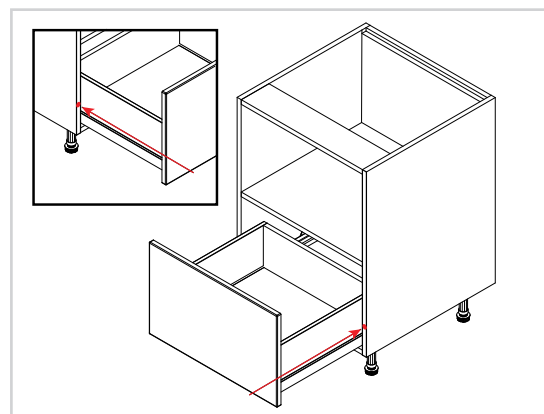

## Cleaning the cabinet

Finally, the cabinet should be thoroughly cleaned to remove any debris that may have accumulated during the installation.

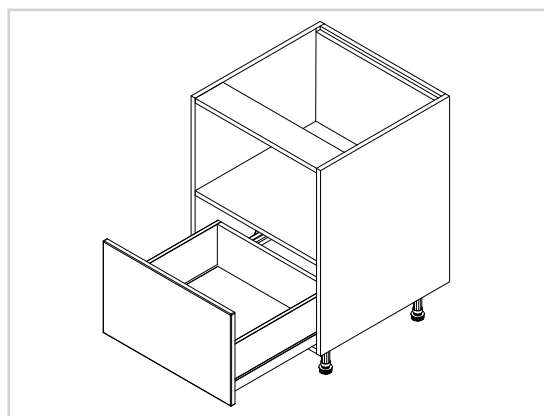

To install the microwave, please refer to the manufacturer's guides.

Store the plinth clips and the remaining 15mm screws.  
These will be used later when attaching the plinth